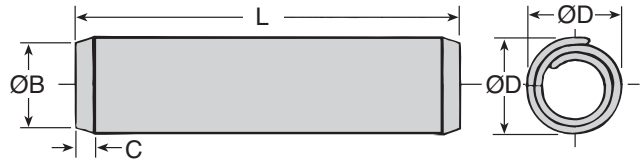
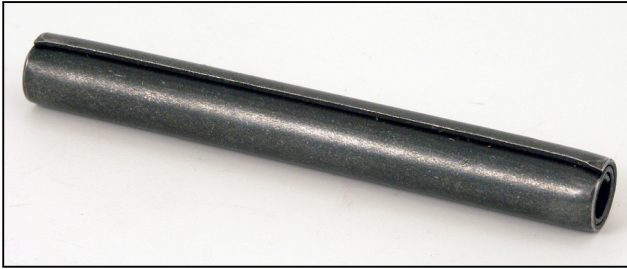

SEP

MECHANICAL

Carbon Steel Coiled Spring Pins

ISO 8750 : 1.5 - 5mm Dia.

**Discounts:** 31+ -15% 50+ -30% 100+ -50% 200+ -60% 1000+ -65% 2000+ -70%

Part Number	Diameter (ØD)			L	Chamfer		Hole		Price Each 1 - 30	Part Number	Diameter (ØD)			L	Chamfer		Hole		Price Each 1 - 30
	Nom	Min	Max		ØB	C	Min	Max			Nom	Min	Max		ØB	C	Min	Max	
SEP1.5-5	1.5	1.62	1.73	5	1.40	0.50	1.50	1.60	£0.10	SEP3-28	3.0	3.15	3.30	28	2.90	0.90	2.99	3.10	£0.27
SEP1.5-6	1.5	1.62	1.73	6	1.40	0.50	1.50	1.60	£0.10	SEP3-30	3.0	3.15	3.30	30	2.90	0.90	2.99	3.10	£0.27
SEP1.5-8	1.5	1.62	1.73	8	1.40	0.50	1.50	1.60	£0.11	SEP3-35	3.0	3.15	3.30	35	2.90	0.90	2.99	3.10	£0.27
SEP1.5-10	1.5	1.62	1.73	10	1.40	0.50	1.50	1.60	£0.11	SEP3-40	3.0	3.15	3.30	40	2.90	0.90	2.99	3.10	£0.27
SEP1.5-12	1.5	1.62	1.73	12	1.40	0.50	1.50	1.60	£0.11	SEP3.5-12	3.5	3.64	3.79	12	3.40	1.00	3.48	3.62	£0.32
SEP1.5-14	1.5	1.62	1.73	14	1.40	0.50	1.50	1.60	£0.11	SEP3.5-14	3.5	3.64	3.79	14	3.40	1.00	3.48	3.62	£0.34
SEP1.5-16	1.5	1.62	1.73	16	1.40	0.50	1.50	1.60	£0.12	SEP3.5-16	3.5	3.64	3.79	16	3.40	1.00	3.48	3.62	£0.35
SEP2-6	2.0	2.13	2.25	6	1.90	0.70	1.99	2.10	£0.12	SEP3.5-18	3.5	3.64	3.79	18	3.40	1.00	3.48	3.62	£0.37
SEP2-8	2.0	2.13	2.25	8	1.90	0.70	1.99	2.10	£0.12	SEP3.5-20	3.5	3.64	3.79	20	3.40	1.00	3.48	3.62	£0.39
SEP2-10	2.0	2.13	2.25	10	1.90	0.70	1.99	2.10	£0.12	SEP3.5-22	3.5	3.64	3.79	22	3.40	1.00	3.98	3.62	£0.40
SEP2-12	2.0	2.13	2.25	12	1.90	0.70	1.99	2.10	£0.13	SEP3.5-24	3.5	3.64	3.79	24	3.40	1.00	3.48	3.62	£0.44
SEP2-14	2.0	2.13	2.25	14	1.90	0.70	1.99	2.10	£0.13	SEP3.5-26	3.5	3.64	3.79	26	3.40	1.00	3.48	3.62	£0.48
SEP2-16	2.0	2.13	2.25	16	1.90	0.70	1.99	2.10	£0.13	SEP3.5-28	3.5	3.64	3.79	28	3.40	1.00	3.48	3.62	£0.50
SEP2-18	2.0	2.13	2.25	18	1.90	0.70	1.99	2.10	£0.13	SEP3.5-30	3.5	3.64	3.79	30	3.40	1.00	3.48	3.62	£0.50
SEP2-20	2.0	2.13	2.25	20	1.90	0.70	1.99	2.10	£0.14	SEP3.5-35	3.5	3.64	3.79	35	3.40	1.00	3.48	3.62	£0.51
SEP2-26	2.0	2.13	2.25	26	1.90	0.70	1.99	2.10	£0.14	SEP4-10	4.0	4.20	4.40	10	3.90	1.10	3.98	4.12	£0.37
SEP2-35	2.0	2.13	2.25	35	1.90	0.70	1.99	2.10	£0.14	SEP4-12	4.0	4.20	4.40	12	3.90	1.10	3.98	4.12	£0.37
SEP2.5-8	2.5	2.62	2.79	8	2.40	0.70	2.49	2.60	£0.13	SEP4-14	4.0	4.20	4.40	14	3.90	1.10	3.98	4.12	£0.40
SEP2.5-10	2.5	2.62	2.79	10	2.40	0.70	2.49	2.60	£0.14	SEP4-16	4.0	4.20	4.40	16	3.90	1.10	3.98	4.12	£0.43
SEP2.5-12	2.5	2.62	2.79	12	2.40	0.70	2.49	2.60	£0.14	SEP4-18	4.0	4.20	4.40	18	3.90	1.10	3.98	4.12	£0.45
SEP2.5-14	2.5	2.62	2.79	14	2.40	0.70	2.49	2.60	£0.15	SEP4-20	4.0	4.20	4.40	20	3.90	1.10	3.98	4.12	£0.46
SEP2.5-16	2.5	2.62	2.79	16	2.40	0.70	2.49	2.60	£0.15	SEP4-22	4.0	4.20	4.40	22	3.90	1.10	3.98	4.12	£0.50
SEP2.5-18	2.5	2.62	2.79	18	2.40	0.70	2.49	2.60	£0.15	SEP4-24	4.0	4.20	4.40	24	3.90	1.10	3.98	4.12	£0.51
SEP2.5-20	2.5	2.62	2.79	20	2.40	0.70	2.49	2.60	£0.16	SEP4-26	4.0	4.20	4.40	26	3.90	1.10	3.98	4.12	£0.53
SEP2.5-22	2.5	2.62	2.79	22	2.40	0.70	2.49	2.60	£0.16	SEP4-28	4.0	4.20	4.40	28	3.90	1.10	3.98	4.12	£0.56
SEP2.5-24	2.5	2.62	2.79	24	2.40	0.70	2.49	2.60	£0.19	SEP4-30	4.0	4.20	4.40	30	3.90	1.10	3.98	4.12	£0.58
SEP3-10	3.0	3.15	3.30	10	2.90	0.90	2.99	3.10	£0.15	SEP4-35	4.0	4.20	4.40	35	3.90	1.10	3.98	4.12	£0.63
SEP3-12	3.0	3.15	3.30	12	2.90	0.90	2.99	3.10	£0.15	SEP4-40	4.0	4.20	4.40	40	3.90	1.10	3.98	4.12	£0.67
SEP3-14	3.0	3.15	3.30	14	2.90	0.90	2.99	3.10	£0.16	SEP4-45	4.0	4.20	4.40	45	3.90	1.10	3.98	4.12	£0.69
SEP3-16	3.0	3.15	3.30	16	2.90	0.90	2.99	3.10	£0.19	SEP5-14	5.0	5.25	5.50	14	4.85	1.30	4.95	5.12	£0.58
SEP3-18	3.0	3.15	3.30	18	2.90	0.90	2.99	3.10	£0.21	SEP5-16	5.0	5.25	5.50	16	4.85	1.30	4.95	5.12	£0.60
SEP3-20	3.0	3.15	3.30	20	2.90	0.90	2.99	3.10	£0.22	SEP5-18	5.0	5.25	5.50	18	4.85	1.30	4.95	5.12	£0.63
SEP3-22	3.0	3.15	3.30	22	2.90	0.90	2.99	3.10	£0.22	SEP5-20	5.0	5.25	5.50	20	4.85	1.30	4.95	5.12	£0.66
SEP3-24	3.0	3.15	3.30	24	2.90	0.90	2.99	3.10	£0.25	SEP5-22	5.0	5.25	5.50	22	4.85	1.30	4.95	5.12	£0.68
SEP3-26	3.0	3.15	3.30	26	2.90	0.90	2.99	3.10	£0.26										

Material

Carbon Steel (CS70)

Performance

Uniform strength and flexibility. Absorbs shock and vibration. Closer diameter tolerances. Equal stress distribution

Wider hole tolerance. Conforms to hole. Swaged chamfers. Low insertion pressure - radial tension

Standard type: ISO 8750**Heavy Duty:** ISO 8748 (available depending on size)**Light Duty:** ISO 8751 (available depending on size)

Other Info.

Prices are listed per individual pin.

+44 (0)1246 455500

+44 (0)1246 455522

ondrives

sales@ondrives.com

www.ondrives.com

Product information updated 1st April 2011 and subject to change. Please contact Sales for the latest prices and availability.

MECHANICAL

Carbon Steel Coiled Spring Pins

ISO 8750 : 5 - 12mm Dia.

SEP

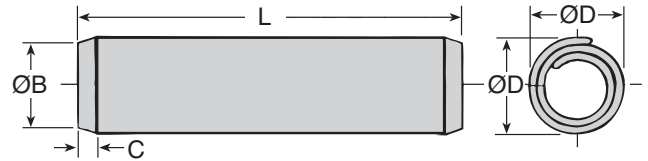
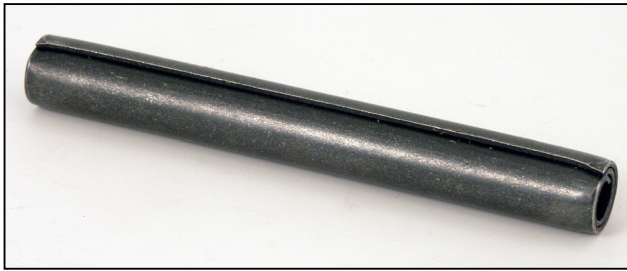

Discounts: 31+ -15% 50+ -30% 100+ -50% 200+ -60% 1000+ -65% 2000+ -70%

Part Number	Diameter (ØD)			L	Chamfer		Hole		Price Each 1 - 30	Part Number	Diameter (ØD)			L	Chamfer		Hole		Price Each 1 - 30
	Nom	Min	Max		ØB	C	Min	Max			Nom	Min	Max		ØB	C	Min	Max	
SEP5-24	5	5.25	5.50	24	4.85	1.30	4.95	5.12	£0.70	SEP8-60	8	8.30	8.63	60	7.80	2.00	7.93	8.17	£2.44
SEP5-26	5	5.25	5.50	26	4.85	1.30	4.95	5.12	£0.74	SEP8-65	8	8.30	8.63	65	7.80	2.00	7.93	8.17	£2.65
SEP5-28	5	5.25	5.50	28	4.85	1.30	4.95	5.12	£0.79	SEP8-70	8	8.30	8.63	70	7.80	2.00	7.93	8.17	£2.81
SEP5-30	5	5.25	5.50	30	4.85	1.30	4.95	5.12	£0.81	SEP8-75	8	8.30	8.63	75	7.80	2.00	7.93	8.17	£3.01
SEP5-35	5	5.25	5.50	35	4.85	1.30	4.95	5.12	£0.89	SEP10-24	10	10.30	10.65	24	9.75	2.50	9.93	10.20	£1.61
SEP5-40	5	5.25	5.50	40	4.85	1.30	4.95	5.12	£0.95	SEP10-26	10	10.30	10.65	26	9.75	2.50	9.93	10.20	£1.73
SEP5-45	5	5.25	5.50	45	4.85	1.30	4.95	5.12	£1.05	SEP10-28	10	10.30	10.65	28	9.75	2.50	9.93	10.20	£1.87
SEP5-50	5	5.25	5.50	50	4.85	1.30	4.95	5.12	£1.05	SEP10-30	10	10.30	10.65	30	9.75	2.50	9.93	10.20	£3.37
SEP6-16	6	6.25	6.50	16	5.85	1.50	5.95	6.13	£1.00	SEP10-35	10	10.30	10.65	35	9.75	2.50	9.93	10.20	£2.32
SEP6-18	6	6.25	6.50	18	5.85	1.50	5.95	6.13	£0.82	SEP10-40	10	10.30	10.65	40	9.75	2.50	9.93	10.20	£2.60
SEP6-20	6	6.25	6.50	20	5.85	1.50	5.95	6.13	£0.88	SEP10-45	10	10.30	10.65	45	9.75	2.50	9.93	10.20	£2.88
SEP6-22	6	6.25	6.50	22	5.85	1.50	5.95	6.13	£0.90	SEP10-50	10	10.30	10.65	50	9.75	2.50	9.93	10.20	£3.18
SEP6-24	6	6.25	6.50	24	5.85	1.50	5.95	6.13	£0.98	SEP10-55	10	10.30	10.65	55	9.75	2.50	9.93	10.20	£3.48
SEP6-26	6	6.25	6.50	26	5.85	1.50	5.95	6.13	£1.00	SEP10-60	10	10.30	10.65	60	9.75	2.50	9.93	10.20	£3.80
SEP6-28	6	6.25	6.50	28	5.85	1.50	5.95	6.13	£1.05	SEP10-65	10	10.30	10.65	65	9.75	2.50	9.93	10.20	£4.10
SEP6-30	6	6.25	6.50	30	5.85	1.50	5.95	6.13	£1.09	SEP10-70	10	10.30	10.65	70	9.75	2.50	9.93	10.20	£4.39
SEP6-35	6	6.25	6.50	35	5.85	1.50	5.95	6.13	£1.19	SEP10-75	10	10.30	10.65	75	9.75	2.50	9.93	10.20	£4.72
SEP6-40	6	6.25	6.50	40	5.85	1.50	5.95	6.13	£1.32	SEP10-80	10	10.30	10.65	80	9.75	2.50	9.93	10.20	£5.01
SEP6-45	6	6.25	6.50	45	5.85	1.50	5.95	6.13	£1.40	SEP10-85	10	10.30	10.65	85	9.75	2.50	9.93	10.20	£5.15
SEP6-50	6	6.25	6.50	50	5.85	1.50	5.95	6.13	£1.50	SEP12-30	12	12.35	12.75	30	11.70	3.00	11.90	12.22	£2.12
SEP6-55	6	6.25	6.50	55	5.85	1.50	5.95	6.13	£1.61	SEP12-35	12	12.35	12.75	35	11.70	3.00	11.90	12.22	£2.61
SEP6-60	6	6.25	6.50	60	5.85	1.50	5.95	6.13	£1.51	SEP12-40	12	12.35	12.75	40	11.70	3.00	11.90	12.22	£3.11
SEP8-16	8	8.30	8.63	16	7.80	2.00	7.93	8.17	£0.99	SEP12-45	12	12.35	12.75	45	11.70	3.00	11.90	12.22	£3.60
SEP8-20	8	8.30	8.63	20	7.80	2.00	7.93	8.17	£0.99	SEP12-50	12	12.35	12.75	50	11.70	3.00	11.90	12.22	£4.08
SEP8-22	8	8.30	8.63	22	7.80	2.00	7.93	8.17	£1.06	SEP12-55	12	12.35	12.75	55	11.70	3.00	11.90	12.22	£4.58
SEP8-24	8	8.30	8.63	24	7.80	2.00	7.93	8.17	£1.13	SEP12-60	12	12.35	12.75	60	11.70	3.00	11.90	12.22	£5.07
SEP8-26	8	8.30	8.63	26	7.80	2.00	7.93	8.17	£1.19	SEP12-65	12	12.35	12.75	65	11.70	3.00	11.90	12.22	£5.58
SEP8-28	8	8.30	8.63	28	7.80	2.00	7.93	8.17	£1.26	SEP12-70	12	12.35	12.75	70	11.70	3.00	11.90	12.22	£6.06
SEP8-30	8	8.30	8.63	30	7.80	2.00	7.93	8.17	£1.35	SEP12-75	12	12.35	12.75	75	11.70	3.00	11.90	12.22	£6.57
SEP8-35	8	8.30	8.63	35	7.80	2.00	7.93	8.17	£1.54	SEP12-80	12	12.35	12.75	80	11.70	3.00	11.90	12.22	£6.81
SEP8-40	8	8.30	8.63	40	7.80	2.00	7.93	8.17	£1.70	SEP12-85	12	12.35	12.75	85	11.70	3.00	11.90	12.22	£7.42
SEP8-45	8	8.30	8.63	45	7.80	2.00	7.93	8.17	£1.90	SEP12-90	12	12.35	12.75	90	11.70	3.00	11.90	12.22	£8.06
SEP8-50	8	8.30	8.63	50	7.80	2.00	7.93	8.17	£2.07	SEP12-95	12	12.35	12.75	95	11.70	3.00	11.90	12.22	£8.53
SEP8-55	8	8.30	8.63	55	7.80	2.00	7.93	8.17	£2.26	SEP12-100	12	12.35	12.75	100	11.70	3.00	11.90	12.22	£9.01

Material

Carbon Steel (CS70)

Performance

Uniform strength and flexibility. Absorbs shock and vibration. Closer diameter tolerances. Equal stress distribution
Wider hole tolerance. Conforms to hole. Swaged chamfers. Low insertion pressure - radial tension

Standard type: ISO 8750

Heavy Duty: ISO 8748 (available depending on size)

Light Duty: ISO 8751 (available depending on size)

Other Info.

Prices are listed per individual pin.

+44 (0)1246 455500

+44 (0)1246 455522

ondrives

sales@ondrives.com

www.ondrives.com

Product information updated 1st April 2011 and subject to change. Please contact Sales for the latest prices and availability.

EP

MECHANICAL

302 Nickel Stainless Coiled Spring Pins

ISO 8750 : 0.8 - 4mm Dia.

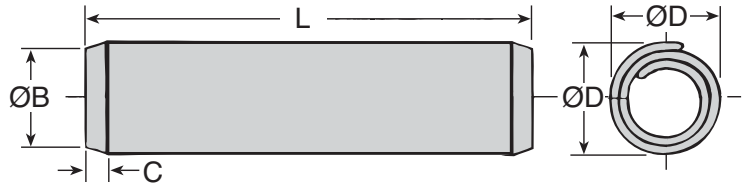
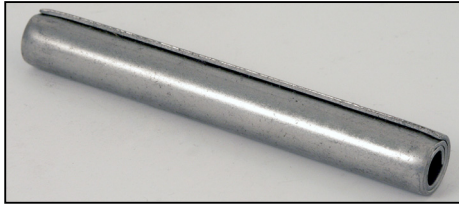

Discounts: 31+ -15% | 50+ -30% | 100+ -50% | 200+ -60% | 1000+ -65% | 2000+ -70%

Part Number	Diameter (ØD)			L	Chamfer		Hole		Price Each 1 - 30	Part Number	Diameter (ØD)			L	Chamfer		Hole		Price Each 1 - 30
	Nom	Min	Max		ØB	C	Min	Max			Nom	Min	Max		ØB	C	Min	Max	
EP0.8-4	0.8	0.85	0.91	4	0.75	0.30	0.80	0.84	£2.25	EP2.5-8	2.5	2.62	2.79	8	2.40	0.70	2.49	2.60	£0.19
EP0.8-5	0.8	0.85	0.91	5	0.75	0.30	0.80	0.84	£P.O.A	EP2.5-10	2.5	2.62	2.79	10	2.40	0.70	2.49	2.60	£0.21
EP0.8-6	0.8	0.85	0.91	6	0.75	0.30	0.80	0.84	£0.21	EP2.5-12	2.5	2.62	2.79	12	2.40	0.70	2.49	2.60	£0.21
EP0.8-8	0.8	0.85	0.91	8	0.75	0.30	0.80	0.84	£0.21	EP2.5-14	2.5	2.62	2.79	14	2.40	0.70	2.49	2.60	£0.22
EP0.8-10	0.8	0.85	0.91	10	0.75	0.30	0.80	0.84	£0.21	EP2.5-16	2.5	2.62	2.79	16	2.40	0.70	2.49	2.60	£0.22
EP0.8-12	0.8	0.85	0.91	12	0.75	0.30	0.80	0.84	£0.22	EP2.5-18	2.5	2.62	2.79	18	2.40	0.70	2.49	2.60	£0.25
EP1-4	1.0	1.05	1.15	4	0.95	0.30	1.00	1.04	£0.16	EP2.5-20	2.5	2.62	2.79	20	2.40	0.70	2.49	2.60	£0.25
EP1-5	1.0	1.05	1.15	5	0.95	0.30	1.00	1.04	£0.19	EP2.5-22	2.5	2.62	2.79	22	2.40	0.70	2.49	2.60	£0.26
EP1-6	1.0	1.05	1.15	6	0.95	0.30	1.00	1.04	£0.21	EP2.5-24	2.5	2.62	2.79	24	2.40	0.70	2.49	2.60	£0.26
EP1-8	1.0	1.05	1.15	8	0.95	0.30	1.00	1.04	£0.21	EP3-10	3.0	3.15	3.30	10	2.90	0.90	2.99	3.10	£0.22
EP1-10	1.0	1.05	1.15	10	0.95	0.30	1.00	1.04	£0.21	EP3-12	3.0	3.15	3.30	12	2.90	0.90	2.99	3.10	£0.25
EP1-12	1.0	1.05	1.15	12	0.95	0.30	1.00	1.04	£0.21	EP3-14	3.0	3.15	3.30	14	2.90	0.90	2.99	3.10	£0.26
EP1-14	1.0	1.05	1.15	14	0.95	0.30	1.00	1.04	£0.21	EP3-16	3.0	3.15	3.30	16	2.90	0.90	2.99	3.10	£0.27
EP1-16	1.0	1.05	1.15	16	0.95	0.30	1.00	1.04	£0.26	EP3-18	3.0	3.15	3.30	18	2.90	0.90	2.99	3.10	£0.28
EP1.2-4	1.2	1.25	1.35	4	1.15	0.40	1.20	1.24	£0.19	EP3-20	3.0	3.15	3.30	20	2.90	0.90	2.99	3.10	£0.29
EP1.2-6	1.2	1.25	1.35	6	1.15	0.40	1.20	1.24	£P.O.A	EP3-22	3.0	3.15	3.30	22	2.90	0.90	2.99	3.10	£0.30
EP1.2-8	1.2	1.25	1.35	8	1.15	0.40	1.20	1.24	£0.21	EP3-24	3.0	3.15	3.30	24	2.90	0.90	2.99	3.10	£0.31
EP1.2-10	1.2	1.25	1.35	10	1.15	0.40	1.20	1.24	£0.21	EP3-26	3.0	3.15	3.30	26	2.90	0.90	2.99	3.10	£0.32
EP1.2-12	1.2	1.25	1.35	12	1.15	0.40	1.20	1.24	£0.21	EP3-28	3.0	3.15	3.30	28	2.90	0.90	2.99	3.10	£0.33
EP1.5-5	1.5	1.62	1.73	5	1.40	0.50	1.50	1.60	£0.13	EP3-30	3.0	3.15	3.30	30	2.90	0.90	2.99	3.10	£0.34
EP1.5-6	1.5	1.62	1.73	6	1.40	0.50	1.50	1.60	£0.14	EP3-35	3.0	3.15	3.30	35	2.90	0.90	2.99	3.10	£0.34
EP1.5-8	1.5	1.62	1.73	8	1.40	0.50	1.50	1.60	£0.14	EP3-40	3.0	3.15	3.30	40	2.90	0.90	2.99	3.10	£0.34
EP1.5-10	1.5	1.62	1.73	10	1.40	0.50	1.50	1.60	£0.14	EP3.5-12	3.5	3.64	3.79	12	3.40	1.00	3.48	3.62	£0.44
EP1.5-12	1.5	1.62	1.73	12	1.40	0.50	1.50	1.60	£0.15	EP3.5-16	3.5	3.64	3.79	16	3.40	1.00	3.48	3.62	£0.48
EP1.5-14	1.5	1.62	1.73	14	1.40	0.50	1.50	1.60	£0.15	EP3.5-18	3.5	3.64	3.79	18	3.40	1.00	3.48	3.62	£0.51
EP1.5-16	1.5	1.62	1.73	16	1.40	0.50	1.50	1.60	£0.15	EP3.5-20	3.5	3.64	3.79	20	3.40	1.00	3.48	3.62	£0.51
EP1.5-20	1.5	1.62	1.73	20	1.40	0.50	1.50	1.60	£0.16	EP3.5-22	3.5	3.64	3.79	22	3.40	1.00	3.48	3.62	£0.53
EP1.5-24	1.5	1.62	1.73	24	1.40	0.50	1.50	1.60	£0.19	EP3.5-24	3.5	3.64	3.79	24	3.40	1.00	3.48	3.62	£0.58
EP2-6	2.0	2.13	2.25	6	1.90	0.70	1.99	2.10	£0.15	EP3.5-28	3.5	3.64	3.79	28	3.40	1.00	3.48	3.62	£0.63
EP2-8	2.0	2.13	2.25	8	1.90	0.70	1.99	2.10	£0.15	EP3.5-30	3.5	3.64	3.79	30	3.40	1.00	3.48	3.62	£0.64
EP2-10	2.0	2.13	2.25	10	1.90	0.70	1.99	2.10	£0.15	EP3.5-35	3.5	3.64	3.79	35	3.40	1.00	3.48	3.62	£P.O.A
EP2-12	2.0	2.13	2.25	12	1.90	0.70	1.99	2.10	£0.16	EP4-12	4.0	4.20	4.40	12	3.90	1.10	3.98	4.12	£0.51
EP2-14	2.0	2.13	2.25	14	1.90	0.70	1.99	2.10	£0.16	EP4-14	4.0	4.20	4.40	14	3.90	1.10	3.98	4.12	£0.53
EP2-16	2.0	2.13	2.25	16	1.90	0.70	1.99	2.10	£0.19	EP4-16	4.0	4.20	4.40	16	3.90	1.10	3.98	4.12	£0.56
EP2-18	2.0	2.13	2.25	18	1.90	0.70	1.99	2.10	£0.19	EP4-18	4.0	4.20	4.40	18	3.90	1.10	3.98	4.12	£0.59
EP2-20	2.0	2.13	2.25	20	1.90	0.70	1.99	2.10	£0.21	EP4-20	4.0	4.20	4.40	20	3.90	1.10	3.98	4.12	£0.61
EP2-30	2.0	2.13	2.25	30	1.90	0.70	1.99	2.10	£0.32	EP4-22	4.0	4.20	4.40	22	3.90	1.10	3.98	4.12	£0.64
										EP4-24	4.0	4.20	4.40	24	3.90	1.10	3.98	4.12	£0.66

Material

Nickel Stainless Steel (AISI.302)

Performance

Uniform strength and flexibility. Absorbs shock and vibration. Closer diameter tolerances. Equal stress distribution

Wider hole tolerance. Conforms to hole. Swaged chamfers. Low insertion pressure - radial tension

Standard type: ISO 8750, **Heavy Duty:** ISO 8748 (available depending on size), **Light Duty:** ISO 8751 (available depending on size)

Other Info.

Prices are listed per individual pin.

+44 (0)1246 455500

+44 (0)1246 455522

ondrives

sales@ondrives.com

www.ondrives.com

Product information updated 1st April 2011 and subject to change. Please contact Sales for the latest prices and availability.

MECHANICAL

EP

302 Nickel Stainless Coiled Spring Pins

ISO 8750 : 4 - 12mm Dia.

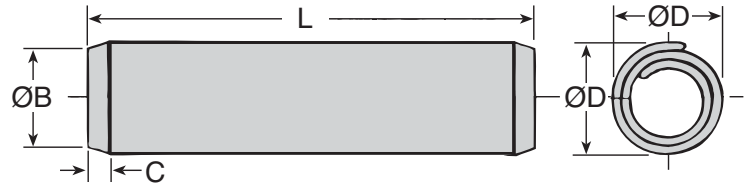
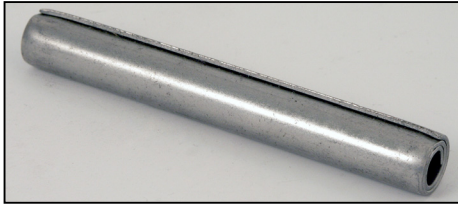

Discounts: 31+ -15% 50+ -30% 100+ -50% 200+ -60% 1000+ -65% 2000+ -70%

Part Number	Diameter (ØD)			L	Chamfer		Hole		Price Each 1 - 30	Part Number	Diameter (ØD)			L	Chamfer		Hole		Price Each 1 - 30
	Nom	Min	Max		ØB	C	Min	Max			Nom	Min	Max		ØB	C	Min	Max	
EP4-26	4	4.20	4.40	26	3.90	1.10	3.98	4.12	£0.68	EP8-30	8	8.30	8.63	30	7.80	2.00	7.93	8.17	£2.08
EP4-28	4	4.20	4.40	28	3.90	1.10	3.98	4.12	£0.70	EP8-35	8	8.30	8.63	35	7.80	2.00	7.93	8.17	£2.25
EP4-30	4	4.20	4.40	30	3.90	1.10	3.98	4.12	£0.74	EP8-40	8	8.30	8.63	40	7.80	2.00	7.93	8.17	£2.47
EP4-35	4	4.20	4.40	35	3.90	1.10	3.98	4.12	£0.80	EP8-45	8	8.30	8.63	45	7.80	2.00	7.93	8.17	£2.73
EP4-40	4	4.20	4.40	40	3.90	1.10	3.98	4.12	£0.87	EP8-50	8	8.30	8.63	50	7.80	2.00	7.93	8.17	£3.01
EP4-45	4	4.20	4.40	45	3.90	1.10	3.98	4.12	£0.90	EP8-60	8	8.30	8.63	60	7.80	2.00	7.93	8.17	£3.65
EP4-50	4	4.20	4.40	50	3.90	1.10	3.98	4.12	£0.90	EP8-65	8	8.30	8.63	65	7.80	2.00	7.93	8.17	£4.03
EP5-14	5	5.25	5.50	14	4.85	1.30	4.95	5.12	£0.72	EP8-70	8	8.30	8.63	70	7.80	2.00	7.93	8.17	£4.15
EP5-16	5	5.25	5.50	16	4.85	1.30	4.95	5.12	£0.78	EP8-75	8	8.30	8.63	75	7.80	2.00	7.93	8.17	£4.57
EP5-18	5	5.25	5.50	18	4.85	1.30	4.95	5.12	£0.81	EP10-24	10	10.30	10.65	24	9.75	2.50	9.96	10.20	£3.49
EP5-20	5	5.25	5.50	20	4.85	1.30	4.95	5.12	£0.85	EP10-26	10	10.30	10.65	26	9.75	2.50	9.96	10.20	£3.78
EP5-22	5	5.25	5.50	22	4.85	1.30	4.95	5.12	£0.89	EP10-28	10	10.30	10.65	28	9.75	2.50	9.96	10.20	£4.03
EP5-24	5	5.25	5.50	24	4.85	1.30	4.95	5.12	£0.93	EP10-30	10	10.30	10.65	30	9.75	2.50	9.96	10.20	£4.28
EP5-26	5	5.25	5.50	26	4.85	1.30	4.95	5.12	£0.95	EP10-35	10	10.30	10.65	35	9.75	2.50	9.96	10.20	£4.94
EP5-28	5	5.25	5.50	28	4.85	1.30	4.95	5.12	£1.00	EP10-40	10	10.30	10.65	40	9.75	2.50	9.96	10.20	£5.57
EP5-30	5	5.25	5.50	30	4.85	1.30	4.95	5.12	£1.05	EP10-45	10	10.30	10.65	45	9.75	2.50	9.96	10.20	£6.20
EP5-35	5	5.25	5.50	35	4.85	1.30	4.95	5.12	£1.14	EP10-50	10	10.30	10.65	50	9.75	2.50	9.96	10.20	£6.80
EP5-40	5	5.25	5.50	40	4.85	1.30	4.95	5.12	£1.23	EP10-55	10	10.30	10.65	55	9.75	2.50	9.96	10.20	£7.49
EP5-45	5	5.25	5.50	45	4.85	1.30	4.95	5.12	£1.34	EP10-60	10	10.30	10.65	60	9.75	2.50	9.96	10.20	£8.13
EP5-50	5	5.25	5.50	50	4.85	1.30	4.95	5.12	£1.34	EP10-65	10	10.30	10.65	65	9.75	2.50	9.96	10.20	£8.77
EP6-16	6	6.25	6.50	16	5.85	1.50	5.95	6.13	£0.98	EP10-70	10	10.30	10.65	70	9.75	2.50	9.96	10.20	£9.42
EP6-18	6	6.25	6.50	18	5.85	1.50	5.95	6.13	£0.98	EP10-75	10	10.30	10.65	75	9.75	2.50	9.96	10.20	£10.05
EP6-20	6	6.25	6.50	20	5.85	1.50	5.95	6.13	£1.02	EP10-80	10	10.30	10.65	80	9.75	2.50	9.96	10.20	£10.71
EP6-22	6	6.25	6.50	22	5.85	1.50	5.95	6.13	£1.08	EP10-85	10	10.30	10.65	85	9.75	2.50	9.96	10.20	£11.02
EP6-24	6	6.25	6.50	24	5.85	1.50	5.95	6.13	£1.12	EP12-30	12	12.35	12.75	30	11.70	3.00	11.90	12.22	£4.56
EP6-26	6	6.25	6.50	26	5.85	1.50	5.95	6.13	£1.18	EP12-35	12	12.35	12.75	35	11.70	3.00	11.90	12.22	£5.61
EP6-28	6	6.25	6.50	28	5.85	1.50	5.95	6.13	£1.24	EP12-40	12	12.35	12.75	40	11.70	3.00	11.90	12.22	£6.68
EP6-30	6	6.25	6.50	30	5.85	1.50	5.95	6.13	£1.49	EP12-45	12	12.35	12.75	45	11.70	3.00	11.90	12.22	£7.71
EP6-35	6	6.25	6.50	35	5.85	1.50	5.95	6.13	£1.59	EP12-50	12	12.35	12.75	50	11.70	3.00	11.90	12.22	£8.75
EP6-40	6	6.25	6.50	40	5.85	1.50	5.95	6.13	£1.74	EP12-55	12	12.35	12.75	55	11.70	3.00	11.90	12.22	£9.79
EP6-45	6	6.25	6.50	45	5.85	1.50	5.95	6.13	£1.90	EP12-60	12	12.35	12.75	60	11.70	3.00	11.90	12.22	£10.84
EP6-50	6	6.25	6.50	50	5.85	1.50	5.95	6.13	£2.06	EP12-65	12	12.35	12.75	65	11.70	3.00	11.90	12.22	£11.90
EP6-55	6	6.25	6.50	55	5.85	1.50	5.95	6.13	£2.24	EP12-70	12	12.35	12.75	70	11.70	3.00	11.90	12.22	£12.94
EP6-60	6	6.25	6.50	60	5.85	1.50	5.95	6.13	£2.43	EP12-75	12	12.35	12.75	75	11.70	3.00	11.90	12.22	£13.99
EP8-20	8	8.30	8.63	20	7.80	2.00	7.93	8.17	£1.59	EP12-80	12	12.35	12.75	80	11.70	3.00	11.90	12.22	£14.51
EP8-22	8	8.30	8.63	22	7.80	2.00	7.93	8.17	£1.66	EP12-85	12	12.35	12.75	85	11.70	3.00	11.90	12.22	£15.82
EP8-24	8	8.30	8.63	24	7.80	2.00	7.93	8.17	£1.77	EP12-90	12	12.35	12.75	90	11.70	3.00	11.90	12.22	£17.13
EP8-26	8	8.30	8.63	26	7.80	2.00	7.93	8.17	£1.86	EP12-95	12	12.35	12.75	95	11.70	3.00	11.90	12.22	£18.19
EP8-28	8	8.30	8.63	28	7.80	2.00	7.93	8.17	£1.94	EP12-100	12	12.35	12.75	100	11.70	3.00	11.90	12.22	£P.O.A

Material

Nickel Stainless Steel (AISI.302)

Performance

Uniform strength and flexibility. Absorbs shock and vibration. Closer diameter tolerances. Equal stress distribution

Wider hole tolerance. Conforms to hole. Swaged chamfers. Low insertion pressure - radial tension

Standard type: ISO 8750, **Heavy Duty:** ISO 8748 (available depending on size), **Light Duty:** ISO 8751 (available depending on size)

Other Info.

Prices are listed per individual pin.

+44 (0)1246 455500

+44 (0)1246 455522

ondrives

sales@ondrives.com

www.ondrives.com

Product information updated 1st April 2011 and subject to change. Please contact Sales for the latest prices and availability.

SAP

MECHANICAL

Carbon Steel Slotted Spring Pins

ISO 8752 : 1.5 - 5mm Dia.

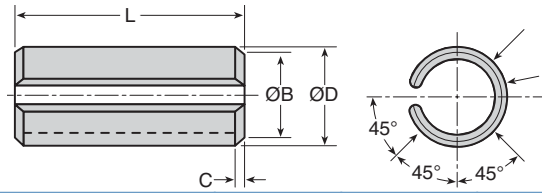
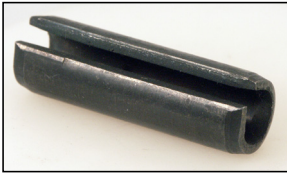

Discounts: 31+ -15% 50+ -30% 100+ -50% 200+ -60% 1000+ -65%

Part Number	Diameter (ØD)			L	Chamfer		Hole		Price Each 1 - 30	Part Number	Diameter (ØD)			L	Chamfer		Hole		Price Each 1 - 30
	Nom	Min	Max		ØB	C	Min	Max			Nom	Min	Max		ØB	C	Min	Max	
SAP1.5-4	1.5	1.70	1.80	4	1.40	0.50	1.50	1.60	£0.06	SAP3-10	3	3.30	3.50	10	2.90	0.90	3.00	3.10	£0.08
SAP1.5-5	1.5	1.70	1.80	5	1.40	0.50	1.50	1.60	£0.06	SAP3-12	3	3.30	3.50	12	2.90	0.90	3.00	3.10	£0.09
SAP1.5-6	1.5	1.70	1.80	6	1.40	0.50	1.50	1.60	£0.07	SAP3-14	3	3.30	3.50	14	2.90	0.90	3.00	3.10	£0.09
SAP1.5-8	1.5	1.70	1.80	8	1.40	0.50	1.50	1.60	£0.07	SAP3-16	3	3.30	3.50	16	2.90	0.90	3.00	3.10	£0.09
SAP1.5-10	1.5	1.70	1.80	10	1.40	0.50	1.50	1.60	£0.07	SAP3-18	3	3.30	3.50	18	2.90	0.90	3.00	3.10	£0.10
SAP1.5-12	1.5	1.70	1.80	12	1.40	0.50	1.50	1.60	£0.07	SAP3-20	3	3.30	3.50	20	2.90	0.90	3.00	3.10	£0.10
SAP1.5-14	1.5	1.70	1.80	14	1.40	0.50	1.50	1.60	£0.07	SAP3-22	3	3.30	3.50	22	2.90	0.90	3.00	3.10	£0.12
SAP1.5-16	1.5	1.70	1.80	16	1.40	0.50	1.50	1.60	£0.08	SAP3-24	3	3.30	3.50	24	2.90	0.90	3.00	3.10	£0.12
SAP1.5-18	1.5	1.70	1.80	18	1.40	0.50	1.50	1.60	£0.08	SAP3-26	3	3.30	3.50	26	2.90	0.90	3.00	3.10	£0.13
SAP1.5-20	1.5	1.70	1.80	20	1.40	0.50	1.50	1.60	£0.08	SAP3-28	3	3.30	3.50	28	2.90	0.90	3.00	3.10	£0.13
SAP2-4	2.0	2.30	2.40	4	1.90	0.70	2.00	2.10	£0.07	SAP3-30	3	3.30	3.50	30	2.90	0.90	3.00	3.10	£0.13
SAP2-5	2.0	2.30	2.40	5	1.90	0.70	2.00	2.10	£0.07	SAP3-32	3	3.30	3.50	32	2.90	0.90	3.00	3.10	£0.14
SAP2-6	2.0	2.30	2.40	6	1.90	0.70	2.00	2.10	£0.08	SAP3-35	3	3.30	3.50	35	2.90	0.90	3.00	3.10	£0.14
SAP2-8	2.0	2.30	2.40	8	1.90	0.70	2.00	2.10	£0.08	SAP3-40	3	3.30	3.50	40	2.90	0.90	3.00	3.10	£0.15
SAP2-10	2.0	2.30	2.40	10	1.90	0.70	2.00	2.10	£0.09	SAP3-45	3	3.30	3.50	45	2.90	0.90	3.00	3.10	£0.15
SAP2-12	2.0	2.30	2.40	12	1.90	0.70	2.00	2.10	£0.09	SAP3-50	3	3.30	3.50	50	2.90	0.90	3.00	3.10	£0.15
SAP2-14	2.0	2.30	2.40	14	1.90	0.70	2.00	2.10	£0.09	SAP4-6	4	4.40	4.60	6	3.90	1.10	4.00	4.12	£0.08
SAP2-16	2.0	2.30	2.40	16	1.90	0.70	2.00	2.10	£0.10	SAP4-8	4	4.40	4.60	8	3.90	1.10	4.00	4.12	£0.08
SAP2-18	2.0	2.30	2.40	18	1.90	0.70	2.00	2.10	£0.10	SAP4-10	4	4.40	4.60	10	3.90	1.10	4.00	4.12	£0.08
SAP2-20	2.0	2.30	2.40	20	1.90	0.70	2.00	2.10	£0.11	SAP4-12	4	4.40	4.60	12	3.90	1.10	4.00	4.12	£0.09
SAP2-22	2.0	2.30	2.40	22	1.90	0.70	2.00	2.10	£0.11	SAP4-14	4	4.40	4.60	14	3.90	1.10	4.00	4.12	£0.10
SAP2-24	2.0	2.30	2.40	24	1.90	0.70	2.00	2.10	£0.11	SAP4-16	4	4.40	4.60	16	3.90	1.10	4.00	4.12	£0.10
SAP2-26	2.0	2.30	2.40	26	1.90	0.70	2.00	2.10	£0.12	SAP4-18	4	4.40	4.60	18	3.90	1.10	4.00	4.12	£0.12
SAP2-28	2.0	2.30	2.40	28	1.90	0.70	2.00	2.10	£0.12	SAP4-20	4	4.40	4.60	20	3.90	1.10	4.00	4.12	£0.12
SAP2-30	2.0	2.30	2.40	30	1.90	0.70	2.00	2.10	£0.13	SAP4-22	4	4.40	4.60	22	3.90	1.10	4.00	4.12	£0.12
SAP2.5-4	2.5	2.80	2.90	4	2.40	0.70	2.50	2.60	£0.07	SAP4-24	4	4.40	4.60	24	3.90	1.10	4.00	4.12	£0.13
SAP2.5-5	2.5	2.80	2.90	5	2.40	0.70	2.50	2.60	£0.08	SAP4-26	4	4.40	4.60	26	3.90	1.10	4.00	4.12	£0.13
SAP2.5-6	2.5	2.80	2.90	6	2.40	0.70	2.50	2.60	£0.08	SAP4-28	4	4.40	4.60	28	3.90	1.10	4.00	4.12	£0.13
SAP2.5-8	2.5	2.80	2.90	8	2.40	0.70	2.50	2.60	£0.09	SAP4-30	4	4.40	4.60	30	3.90	1.10	4.00	4.12	£0.14
SAP2.5-10	2.5	2.80	2.90	10	2.40	0.70	2.50	2.60	£0.10	SAP4-32	4	4.40	4.60	32	3.90	1.10	4.00	4.12	£0.15
SAP2.5-12	2.5	2.80	2.90	12	2.40	0.70	2.50	2.60	£0.10	SAP4-36	4	4.40	4.60	36	3.90	1.10	4.00	4.12	£0.15
SAP2.5-14	2.5	2.80	2.90	14	2.40	0.70	2.50	2.60	£0.11	SAP4-40	4	4.40	4.60	40	3.90	1.10	4.00	4.12	£0.16
SAP2.5-16	2.5	2.80	2.90	16	2.40	0.70	2.50	2.60	£0.12	SAP4-45	4	4.40	4.60	45	3.90	1.10	4.00	4.12	£0.16
SAP2.5-18	2.5	2.80	2.90	18	2.40	0.70	2.50	2.60	£0.12	SAP4-50	4	4.40	4.60	50	3.90	1.10	4.00	4.12	£0.16
SAP2.5-20	2.5	2.80	2.90	20	2.40	0.70	2.50	2.60	£0.13	SAP5-8	5	5.40	5.60	8	4.85	1.30	5.00	5.12	£0.10
SAP2.5-22	2.5	2.80	2.90	22	2.40	0.70	2.50	2.60	£0.14	SAP5-10	5	5.40	5.60	10	4.85	1.30	5.00	5.12	£0.10
SAP2.5-24	2.5	2.80	2.90	24	2.40	0.70	2.50	2.60	£0.14	SAP5-12	5	5.40	5.60	12	4.85	1.30	5.00	5.12	£0.10
SAP2.5-26	2.5	2.80	2.90	26	2.40	0.70	2.50	2.60	£0.15	SAP5-14	5	5.40	5.60	14	4.85	1.30	5.00	5.12	£0.10
SAP2.5-28	2.5	2.80	2.90	28	2.40	0.70	2.50	2.60	£0.16	SAP5-16	5	5.40	5.60	16	4.85	1.30	5.00	5.12	£0.10
SAP2.5-30	2.5	2.80	2.90	30	2.40	0.70	2.50	2.60	£0.16	SAP5-18	5	5.40	5.60	18	4.85	1.30	5.00	5.12	£0.12
SAP3-4	3.0	3.30	3.50	4	2.90	0.90	3.00	3.10	£0.08	SAP5-20	5	5.40	5.60	20	4.85	1.30	5.00	5.12	£0.12
SAP3-5	3.0	3.30	3.50	5	2.90	0.90	3.00	3.10	£0.08	SAP5-22	5	5.40	5.60	22	4.85	1.30	5.00	5.12	£0.12
SAP3-6	3.0	3.30	3.50	6	2.90	0.90	3.00	3.10	£0.08	SAP5-24	5	5.40	5.60	24	4.85	1.30	5.00	5.12	£0.13
SAP3-8	3.0	3.30	3.50	8	2.90	0.90	3.00	3.10	£0.08	SAP5-26	5	5.40	5.60	26	4.85	1.30	5.00	5.12	£0.13

Material Carbon Steel (CS70) DIN 1481, ISO 8752

Performance Uniform strength and flexibility. Absorbs shock and vibration. Closer diameter tolerances. Equal stress distribution
Wider hole tolerance. Conforms to hole. Swaged chamfers. Low insertion pressure - radial tension

Other Info. Prices are listed per individual pin.

+44 (0)1246 455500
+44 (0)1246 455522

ondrives

sales@ondrives.com
www.ondrives.com

Product information updated 1st April 2011 and subject to change. Please contact Sales for the latest prices and availability.

MECHANICAL

Carbon Steel Slotted Spring Pins

ISO 8752 : 5 - 12mm Dia.

SAP

Discounts: 31+ -15% 50+ -30% 100+ -50% 200+ -60% 1000+ -65%

Part Number	Diameter (ØD)			L	Chamfer		Hole		Price Each 1 - 30	Part Number	Diameter (ØD)			L	Chamfer		Hole		Price Each 1 - 30
	Nom	Min	Max		ØB	C	Min	Max			Nom	Min	Max		ØB	C	Min	Max	
SAP5-28	5	5.40	5.60	28	4.85	1.30	5.00	5.12	£0.14	SAP8-65	8	8.50	8.80	65	7.80	2.00	8.00	8.15	£0.58
SAP5-30	5	5.40	5.60	30	4.85	1.30	5.00	5.12	£0.15	SAP8-70	8	8.50	8.80	70	7.80	2.00	8.00	8.15	£0.58
SAP5-32	5	5.40	5.60	32	4.85	1.30	5.00	5.12	£0.15	SAP8-75	8	8.50	8.80	75	7.80	2.00	8.00	8.15	£0.61
SAP5-40	5	5.40	5.60	40	4.85	1.30	5.00	5.12	£0.16	SAP8-80	8	8.50	8.80	80	7.80	2.00	8.00	8.15	£0.61
SAP5-45	5	5.40	5.60	45	4.85	1.30	5.00	5.12	£0.22	SAP8-85	8	8.50	8.80	85	7.80	2.00	8.00	8.15	£0.61
SAP5-50	5	5.40	5.60	50	4.85	1.30	5.00	5.12	£0.22	SAP8-90	8	8.50	8.80	90	7.80	2.00	8.00	8.15	£0.78
SAP5-55	5	5.40	5.60	55	4.85	1.30	5.00	5.12	£0.22	SAP8-95	8	8.50	8.80	95	7.80	2.00	8.00	8.15	£0.85
SAP5-60	5	5.40	5.60	60	4.85	1.30	5.00	5.12	£0.29	SAP8-100	8	8.50	8.80	100	7.80	2.00	8.00	8.15	£1.02
SAP5-65	5	5.40	5.60	65	4.85	1.30	5.00	5.12	£0.30	SAP8-120	8	8.50	8.80	120	7.80	2.00	8.00	8.15	£1.02
SAP5-70	5	5.40	5.60	70	4.85	1.30	5.00	5.12	£0.31	SAP10-16	10	10.50	10.80	16	9.75	2.50	10.00	10.15	£0.39
SAP5-75	5	5.40	5.60	75	4.85	1.30	5.00	5.12	£0.32	SAP10-18	10	10.50	10.80	18	9.75	2.50	10.00	10.15	£0.39
SAP5-80	5	5.40	5.60	80	4.85	1.30	5.00	5.12	£0.33	SAP10-20	10	10.50	10.80	20	9.75	2.50	10.00	10.15	£0.39
SAP6-10	6	6.40	6.70	10	5.85	1.50	6.00	6.12	£0.14	SAP10-22	10	10.50	10.80	22	9.75	2.50	10.00	10.15	£0.45
SAP6-12	6	6.40	6.70	12	5.85	1.50	6.00	6.12	£0.14	SAP10-24	10	10.50	10.80	24	9.75	2.50	10.00	10.15	£0.45
SAP6-14	6	6.40	6.70	14	5.85	1.50	6.00	6.12	£0.14	SAP10-26	10	10.50	10.80	26	9.75	2.50	10.00	10.15	£0.51
SAP6-16	6	6.40	6.70	16	5.85	1.50	6.00	6.12	£0.14	SAP10-28	10	10.50	10.80	28	9.75	2.50	10.00	10.15	£0.51
SAP6-18	6	6.40	6.70	18	5.85	1.50	6.00	6.12	£0.14	SAP10-30	10	10.50	10.80	30	9.75	2.50	10.00	10.15	£0.58
SAP6-20	6	6.40	6.70	20	5.85	1.50	6.00	6.12	£0.15	SAP10-32	10	10.50	10.80	32	9.75	2.50	10.00	10.15	£0.61
SAP6-22	6	6.40	6.70	22	5.85	1.50	6.00	6.12	£0.15	SAP10-35	10	10.50	10.80	35	9.75	2.50	10.00	10.15	£0.61
SAP6-24	6	6.40	6.70	24	5.85	1.50	6.00	6.12	£0.15	SAP10-36	10	10.50	10.80	36	9.75	2.50	10.00	10.15	£0.61
SAP6-26	6	6.40	6.70	26	5.85	1.50	6.00	6.12	£0.15	SAP10-40	10	10.50	10.80	40	9.75	2.50	10.00	10.15	£0.67
SAP6-28	6	6.40	6.70	28	5.85	1.50	6.00	6.12	£0.16	SAP10-45	10	10.50	10.80	45	9.75	2.50	10.00	10.15	£0.69
SAP6-30	6	6.40	6.70	30	5.85	1.50	6.00	6.12	£0.22	SAP10-50	10	10.50	10.80	50	9.75	2.50	10.00	10.15	£0.78
SAP6-32	6	6.40	6.70	32	5.85	1.50	6.00	6.12	£0.22	SAP10-55	10	10.50	10.80	55	9.75	2.50	10.00	10.15	£0.80
SAP6-36	6	6.40	6.70	36	5.85	1.50	6.00	6.12	£0.25	SAP10-60	10	10.50	10.80	60	9.75	2.50	10.00	10.15	£0.93
SAP6-40	6	6.40	6.70	40	5.85	1.50	6.00	6.12	£0.25	SAP10-65	10	10.50	10.80	65	9.75	2.50	10.00	10.15	£1.02
SAP6-45	6	6.40	6.70	45	5.85	1.50	6.00	6.12	£0.25	SAP10-70	10	10.50	10.80	70	9.75	2.50	10.00	10.15	£1.06
SAP6-50	6	6.40	6.70	50	5.85	1.50	6.00	6.12	£0.26	SAP10-75	10	10.50	10.80	75	9.75	2.50	10.00	10.15	£1.09
SAP6-55	6	6.40	6.70	55	5.85	1.50	6.00	6.12	£0.26	SAP10-80	10	10.50	10.80	80	9.75	2.50	10.00	10.15	£1.24
SAP6-60	6	6.40	6.70	60	5.85	1.50	6.00	6.12	£0.26	SAP10-85	10	10.50	10.80	85	9.75	2.50	10.00	10.15	£1.34
SAP6-65	6	6.40	6.70	65	5.85	1.50	6.00	6.12	£0.26	SAP10-90	10	10.50	10.80	90	9.75	2.50	10.00	10.15	£1.41
SAP6-70	6	6.40	6.70	70	5.85	1.50	6.00	6.12	£0.26	SAP10-95	10	10.50	10.80	95	9.75	2.50	10.00	10.15	£1.41
SAP6-75	6	6.40	6.70	75	5.85	1.50	6.00	6.12	£0.26	SAP10-100	10	10.50	10.80	100	9.75	2.50	10.00	10.15	£2.23
SAP6-80	6	6.40	6.70	80	5.85	1.50	6.00	6.12	£0.26	SAP12-18	12	12.50	12.80	18	11.70	3.00	12.00	12.18	£0.61
SAP6-85	6	6.40	6.70	85	5.85	1.50	6.00	6.12	£0.26	SAP12-20	12	12.50	12.80	20	11.70	3.00	12.00	12.18	£0.63
SAP6-90	6	6.40	6.70	90	5.85	1.50	6.00	6.12	£0.26	SAP12-22	12	12.50	12.80	22	11.70	3.00	12.00	12.18	£0.68
SAP6-95	6	6.40	6.70	95	5.85	1.50	6.00	6.12	£0.26	SAP12-24	12	12.50	12.80	24	11.70	3.00	12.00	12.18	£0.68
SAP6-100	6	6.40	6.70	100	5.85	1.50	6.00	6.12	£0.26	SAP12-26	12	12.50	12.80	26	11.70	3.00	12.00	12.18	£0.69
SAP8-10	8	8.50	8.80	10	7.80	2.00	8.00	8.15	£0.22	SAP12-28	12	12.50	12.80	28	11.70	3.00	12.00	12.18	£0.78
SAP8-12	8	8.50	8.80	12	7.80	2.00	8.00	8.15	£0.22	SAP12-30	12	12.50	12.80	30	11.70	3.00	12.00	12.18	£0.87
SAP8-14	8	8.50	8.80	14	7.80	2.00	8.00	8.15	£0.22	SAP12-32	12	12.50	12.80	32	11.70	3.00	12.00	12.18	£0.93
SAP8-16	8	8.50	8.80	16	7.80	2.00	8.00	8.15	£0.22	SAP12-35	12	12.50	12.80	35	11.70	3.00	12.00	12.18	£1.06
SAP8-18	8	8.50	8.80	18	7.80	2.00	8.00	8.15	£0.25	SAP12-36	12	12.50	12.80	36	11.70	3.00	12.00	12.18	£1.06
SAP8-20	8	8.50	8.80	20	7.80	2.00	8.00	8.15	£0.25	SAP12-40	12	12.50	12.80	40	11.70	3.00	12.00	12.18	£1.09
SAP8-22	8	8.50	8.80	22	7.80	2.00	8.00	8.15	£0.25	SAP12-45	12	12.50	12.80	45	11.70	3.00	12.00	12.18	£1.17
SAP8-24	8	8.50	8.80	24	7.80	2.00	8.00	8.15	£0.25	SAP12-50	12	12.50	12.80	50	11.70	3.00	12.00	12.18	£1.24
SAP8-26	8	8.50	8.80	26	7.80	2.00	8.00	8.15	£0.26	SAP12-55	12	12.50	12.80	55	11.70	3.00	12.00	12.18	£1.39
SAP8-28	8	8.50	8.80	28	7.80	2.00	8.00	8.15	£0.26	SAP12-60	12	12.50	12.80	60	11.70	3.00	12.00	12.18	£1.43
SAP8-30	8	8.50	8.80	30	7.80	2.00	8.00	8.15	£0.30	SAP12-65	12	12.50	12.80	65	11.70	3.00	12.00	12.18	£1.58
SAP8-32	8	8.50	8.80	32	7.80	2.00	8.00	8.15	£0.31	SAP12-70	12	12.50	12.80	70	11.70	3.00	12.00	12.18	£1.73
SAP8-35	8	8.50	8.80	35	7.80	2.00	8.00	8.15	£0.33	SAP12-75	12	12.50	12.80	75	11.70	3.00	12.00	12.18	£1.90
SAP8-36	8	8.50	8.80	36	7.80	2.00	8.00	8.15	£0.33	SAP12-80	12	12.50	12.80	80	11.70	3.00	12.00	12.18	£1.90
SAP8-40	8	8.50	8.80	40	7.80	2.00	8.00	8.15	£0.37	SAP12-85	12	12.50	12.80	85	11.70	3.00	12.00	12.18	£2.23
SAP8-45	8	8.50	8.80	45	7.80	2.00	8.00	8.15	£0.48	SAP12-90	12	12.50	12.80	90	11.70	3.00	12.00	12.18	£2.67
SAP8-50	8	8.50	8.80	50	7.80	2.00	8.00	8.15	£0.55	SAP12-95	12	12.50	12.80	95	11.70	3.00	12.00	12.18	£3.21
SAP8-55	8	8.50	8.80	55	7.80	2.00	8.00	8.15	£0.55	SAP12-100	12	12.50	12.80	100	11.70	3.00	12.00	12.18	£3.39
SAP8-60	8	8.50	8.80	60	7.80	2.00	8.00	8.15	£0.55										

+44 (0)1246 455500

+44 (0)1246 455522

ondrives

sales@ondrives.com

www.ondrives.com

Product information updated 1st April 2011 and subject to change. Please contact Sales for the latest prices and availability.

SRP

MECHANICAL

Stainless Slotted Spring Pins

ISO 8752 : 1.5 - 4mm Dia.

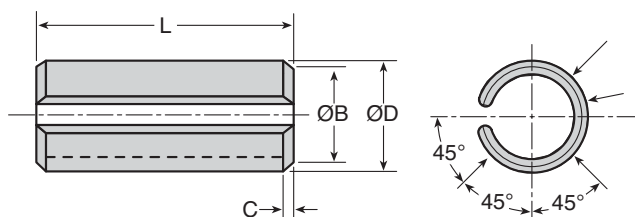
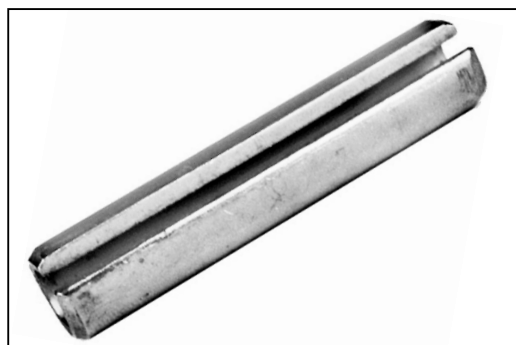
Discounts: 31+ -15% 50+ -30% 100+ -50% 200+ -60% 1000+ -65% 2000+ -72%

Part Number	Diameter (ØD)			L	Chamfer		Hole		Price Each 1 - 30	Part Number	Diameter (ØD)			L	Chamfer		Hole		Price Each 1 - 30
	Nom	Min	Max		ØB	C	Min	Max			Nom	Min	Max		ØB	C	Min	Max	
SRP1.5-5	1.5	1.70	1.80	5	1.40	0.50	1.50	1.60	£0.09	SRP2.5-22	2.5	2.80	2.90	22	2.40	0.70	2.50	2.60	£0.21
SRP1.5-6	1.5	1.70	1.80	6	1.40	0.50	1.50	1.60	£0.09	SRP2.5-24	2.5	2.80	2.90	24	2.40	0.70	2.50	2.60	£0.22
SRP1.5-8	1.5	1.70	1.80	8	1.40	0.50	1.50	1.60	£0.10	SRP2.5-26	2.5	2.80	2.90	26	2.40	0.70	2.50	2.60	£0.22
SRP1.5-10	1.5	1.70	1.80	10	1.40	0.50	1.50	1.60	£0.11	SRP2.5-30	2.5	2.80	2.90	30	2.40	0.70	2.50	2.60	£0.22
SRP1.5-12	1.5	1.70	1.80	12	1.40	0.50	1.50	1.60	£0.11	SRP3-5	3.0	3.30	3.50	5	2.90	0.90	3.00	3.10	£0.12
SRP1.5-14	1.5	1.70	1.80	14	1.40	0.50	1.50	1.60	£0.11	SRP3-6	3.0	3.30	3.50	6	2.90	0.90	3.00	3.10	£0.13
SRP1.5-16	1.5	1.70	1.80	16	1.40	0.50	1.50	1.60	£0.11	SRP3-8	3.0	3.30	3.50	8	2.90	0.90	3.00	3.10	£0.14
SRP1.5-18	1.5	1.70	1.80	18	1.40	0.50	1.50	1.60	£0.12	SRP3-10	3.0	3.30	3.50	10	2.90	0.90	3.00	3.10	£0.14
SRP1.5-20	1.5	1.70	1.80	20	1.40	0.50	1.50	1.60	£0.12	SRP3-12	3.0	3.30	3.50	12	2.90	0.90	3.00	3.10	£0.15
SRP2-4	2.0	2.30	2.40	4	1.90	0.70	2.00	2.10	£0.09	SRP3-14	3.0	3.30	3.50	14	2.90	0.90	3.00	3.10	£0.15
SRP2-5	2.0	2.30	2.40	5	1.90	0.70	2.00	2.10	£0.10	SRP3-16	3.0	3.30	3.50	16	2.90	0.90	3.00	3.10	£0.16
SRP2-6	2.0	2.30	2.40	6	1.90	0.70	2.00	2.10	£0.10	SRP3-18	3.0	3.30	3.50	18	2.90	0.90	3.00	3.10	£0.19
SRP2-8	2.0	2.30	2.40	8	1.90	0.70	2.00	2.10	£0.11	SRP3-20	3.0	3.30	3.50	20	2.90	0.90	3.00	3.10	£0.22
SRP2-10	2.0	2.30	2.40	10	1.90	0.70	2.00	2.10	£0.11	SRP3-22	3.0	3.30	3.50	22	2.90	0.90	3.00	3.10	£0.25
SRP2-12	2.0	2.30	2.40	12	1.90	0.70	2.00	2.10	£0.12	SRP3-24	3.0	3.30	3.50	24	2.90	0.90	3.00	3.10	£0.26
SRP2-14	2.0	2.30	2.40	14	1.90	0.70	2.00	2.10	£0.12	SRP3-26	3.0	3.30	3.50	26	2.90	0.90	3.00	3.10	£0.27
SRP2-16	2.0	2.30	2.40	16	1.90	0.70	2.00	2.10	£0.12	SRP3-28	3.0	3.30	3.50	28	2.90	0.90	3.00	3.10	£0.29
SRP2-18	2.0	2.30	2.40	18	1.90	0.70	2.00	2.10	£0.12	SRP3-30	3.0	3.30	3.50	30	2.90	0.90	3.00	3.10	£0.30
SRP2-20	2.0	2.30	2.40	20	1.90	0.70	2.00	2.10	£0.13	SRP3-32	3.0	3.30	3.50	32	2.90	0.90	3.00	3.10	£0.31
SRP2-22	2.0	2.30	2.40	22	1.90	0.70	2.00	2.10	£0.13	SRP3-35	3.0	3.30	3.50	35	2.90	0.90	3.00	3.10	£0.33
SRP2-24	2.0	2.30	2.40	24	1.90	0.70	2.00	2.10	£0.14	SRP3-40	3.0	3.30	3.50	40	2.90	0.90	3.00	3.10	£0.39
SRP2-26	2.0	2.30	2.40	26	1.90	0.70	2.00	2.10	£0.15	SRP4-6	4.0	4.40	4.60	6	3.90	1.10	4.00	4.12	£0.13
SRP2-28	2.0	2.30	2.40	28	1.90	0.70	2.00	2.10	£0.19	SRP4-8	4.0	4.40	4.60	8	3.90	1.10	4.00	4.12	£0.15
SRP2-30	2.0	2.30	2.40	30	1.90	0.70	2.00	2.10	£0.19	SRP4-10	4.0	4.40	4.60	10	3.90	1.10	4.00	4.12	£0.19
SRP2.5-5	2.5	2.80	2.90	5	2.40	0.70	2.50	2.60	£0.13	SRP4-12	4.0	4.40	4.60	12	3.90	1.10	4.00	4.12	£0.25
SRP2.5-6	2.5	2.80	2.90	6	2.40	0.70	2.50	2.60	£0.13	SRP4-14	4.0	4.40	4.60	14	3.90	1.10	4.00	4.12	£0.27
SRP2.5-8	2.5	2.80	2.90	8	2.40	0.70	2.50	2.60	£0.13	SRP4-16	4.0	4.40	4.60	16	3.90	1.10	4.00	4.12	£0.29
SRP2.5-10	2.5	2.80	2.90	10	2.40	0.70	2.50	2.60	£0.13	SRP4-18	4.0	4.40	4.60	18	3.90	1.10	4.00	4.12	£0.32
SRP2.5-12	2.5	2.80	2.90	12	2.40	0.70	2.50	2.60	£0.13	SRP4-20	4.0	4.40	4.60	20	3.90	1.10	4.00	4.12	£0.35
SRP2.5-14	2.5	2.80	2.90	14	2.40	0.70	2.50	2.60	£0.15	SRP4-22	4.0	4.40	4.60	22	3.90	1.10	4.00	4.12	£0.40
SRP2.5-16	2.5	2.80	2.90	16	2.40	0.70	2.50	2.60	£0.15	SRP4-24	4.0	4.40	4.60	24	3.90	1.10	4.00	4.12	£0.45
SRP2.5-18	2.5	2.80	2.90	18	2.40	0.70	2.50	2.60	£0.19	SRP4-26	4.0	4.40	4.60	26	3.90	1.10	4.00	4.12	£0.50
SRP2.5-20	2.5	2.80	2.90	20	2.40	0.70	2.50	2.60	£0.19	SRP4-28	4.0	4.40	4.60	28	3.90	1.10	4.00	4.12	£0.52

Material

Stainless Steel Grade 304 DIN 1481, ISO 8752

Performance

Uniform strength and flexibility. Absorbs shock and vibration. Closer diameter tolerances. Equal stress distribution
Wider hole tolerance. Conforms to hole. Swaged chamfers. Low insertion pressure - radial tension

Other Info.

Prices are listed per individual pin.

+44 (0)1246 455500

+44 (0)1246 455522

ondrives

sales@ondrives.com

www.ondrives.com

Product information updated 1st April 2011 and subject to change. Please contact Sales for the latest prices and availability.

MECHANICAL

Stainless Slotted Spring Pins

ISO 8752 : 4 - 10mm Dia.

SRP

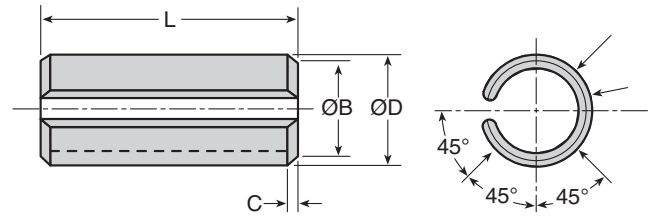
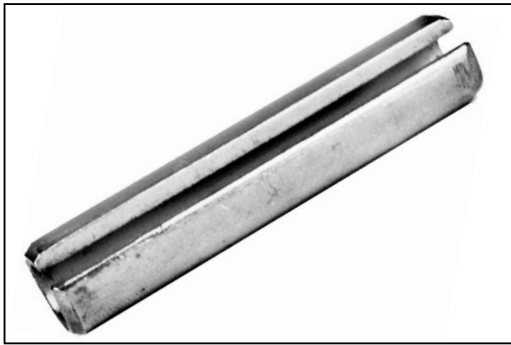

Discounts: 31+ -15% 50+ -30% 100+ -50% 200+ -60% 1000+ -65% 2000+ -72%

Part Number	Diameter (ØD)			L	Chamfer		Hole		Price Each 1 - 30	Part Number	Diameter (ØD)			L	Chamfer		Hole		Price Each 1 - 30
	Nom	Min	Max		ØB	C	Min	Max			Nom	Min	Max		ØB	C	Min	Max	
SRP4-30	4	4.40	4.60	30	3.90	1.10	4.00	4.12	£0.56	SRP6-32	6	6.40	6.70	32	5.85	1.50	6.00	6.12	£1.20
SRP4-35	4	4.40	4.60	35	3.90	1.10	4.00	4.12	£0.63	SRP6-35	6	6.40	6.70	35	5.85	1.50	6.00	6.12	£1.34
SRP4-40	4	4.40	4.60	40	3.90	1.10	4.00	4.12	£0.68	SRP6-40	6	6.40	6.70	40	5.85	1.50	6.00	6.12	£1.52
SRP4-45	4	4.40	4.60	45	3.90	1.10	4.00	4.12	£0.76	SRP6-45	6	6.40	6.70	45	5.85	1.50	6.00	6.12	£1.63
SRP4-50	4	4.40	4.60	50	3.90	1.10	4.00	4.12	£0.82	SRP6-50	6	6.40	6.70	50	5.85	1.50	6.00	6.12	£1.78
SRP5-8	5	5.40	5.60	8	4.85	1.30	5.00	5.12	£0.27	SRP8-10	8	8.80	8.80	10	7.80	2.00	8.00	8.15	£0.70
SRP5-10	5	5.40	5.60	10	4.85	1.30	5.00	5.12	£0.31	SRP8-12	8	8.80	8.80	12	7.80	2.00	8.00	8.15	£0.81
SRP5-12	5	5.40	5.60	12	4.85	1.30	5.00	5.12	£0.35	SRP8-14	8	8.80	8.80	14	7.80	2.00	8.00	8.15	£0.98
SRP5-14	5	5.40	5.60	14	4.85	1.30	5.00	5.12	£0.43	SRP8-16	8	8.80	8.80	16	7.80	2.00	8.00	8.15	£0.98
SRP5-16	5	5.40	5.60	16	4.85	1.30	5.00	5.12	£0.48	SRP8-18	8	8.80	8.80	18	7.80	2.00	8.00	8.15	£1.03
SRP5-18	5	5.40	5.60	18	4.85	1.30	5.00	5.12	£0.52	SRP8-20	8	8.80	8.80	20	7.80	2.00	8.00	8.15	£1.17
SRP5-20	5	5.40	5.60	20	4.85	1.30	5.00	5.12	£0.58	SRP8-22	8	8.80	8.80	22	7.80	2.00	8.00	8.15	£1.26
SRP5-22	5	5.40	5.60	22	4.85	1.30	5.00	5.12	£0.63	SRP8-24	8	8.80	8.80	24	7.80	2.00	8.00	8.15	£1.37
SRP5-24	5	5.40	5.60	24	4.85	1.30	5.00	5.12	£0.67	SRP8-26	8	8.80	8.80	26	7.80	2.00	8.00	8.15	£1.42
SRP5-26	5	5.40	5.60	26	4.85	1.30	5.00	5.12	£0.72	SRP8-28	8	8.80	8.80	28	7.80	2.00	8.00	8.15	£1.57
SRP5-28	5	5.40	5.60	28	4.85	1.30	5.00	5.12	£0.78	SRP8-30	8	8.80	8.80	30	7.80	2.00	8.00	8.15	£1.64
SRP5-30	5	5.40	5.60	30	4.85	1.30	5.00	5.12	£0.82	SRP8-32	8	8.80	8.80	32	7.80	2.00	8.00	8.15	£1.81
SRP5-32	5	5.40	5.60	32	4.85	1.30	5.00	5.12	£0.88	SRP8-35	8	8.80	8.80	35	7.80	2.00	8.00	8.15	£1.89
SRP5-35	5	5.40	5.60	35	4.85	1.30	5.00	5.12	£0.94	SRP8-40	8	8.80	8.80	40	7.80	2.00	8.00	8.15	£1.91
SRP5-40	5	5.40	5.60	40	4.85	1.30	5.00	5.12	£1.05	SRP8-45	8	8.80	8.80	45	7.80	2.00	8.00	8.15	£1.94
SRP5-45	5	5.40	5.60	45	4.85	1.30	5.00	5.12	£1.14	SRP8-50	8	8.80	8.80	50	7.80	2.00	8.00	8.15	£1.94
SRP5-50	5	5.40	5.60	50	4.85	1.30	5.00	5.12	£1.26	SRP10-16	10	10.50	10.80	16	9.75	2.50	10.00	10.15	£P.O.A
SRP6-10	6	6.40	6.70	10	5.85	1.50	6.00	6.12	£0.43	SRP10-18	10	10.50	10.80	18	9.75	2.50	10.00	10.15	£P.O.A
SRP6-12	6	6.40	6.70	12	5.85	1.50	6.00	6.12	£0.53	SRP10-20	10	10.50	10.80	20	9.75	2.50	10.00	10.15	£1.73
SRP6-14	6	6.40	6.70	14	5.85	1.50	6.00	6.12	£0.60	SRP10-22	10	10.50	10.80	22	9.75	2.50	10.00	10.15	£1.81
SRP6-16	6	6.40	6.70	16	5.85	1.50	6.00	6.12	£0.66	SRP10-24	10	10.50	10.80	24	9.75	2.50	10.00	10.15	£1.92
SRP6-18	6	6.40	6.70	18	5.85	1.50	6.00	6.12	£0.72	SRP10-26	10	10.50	10.80	26	9.75	2.50	10.00	10.15	£2.01
SRP6-20	6	6.40	6.70	20	5.85	1.50	6.00	6.12	£0.80	SRP10-28	10	10.50	10.80	28	9.75	2.50	10.00	10.15	£2.10
SRP6-22	6	6.40	6.70	22	5.85	1.50	6.00	6.12	£0.88	SRP10-30	10	10.50	10.80	30	9.75	2.50	10.00	10.15	£2.22
SRP6-24	6	6.40	6.70	24	5.85	1.50	6.00	6.12	£0.94	SRP10-32	10	10.50	10.80	32	9.75	2.50	10.00	10.15	£2.22
SRP6-26	6	6.40	6.70	26	5.85	1.50	6.00	6.12	£1.02	SRP10-35	10	10.50	10.80	35	9.75	2.50	10.00	10.15	£2.24
SRP6-28	6	6.40	6.70	28	5.85	1.50	6.00	6.12	£1.08	SRP10-40	10	10.50	10.80	40	9.75	2.50	10.00	10.15	£2.26
SRP6-30	6	6.40	6.70	30	5.85	1.50	6.00	6.12	£1.14	SRP10-50	10	10.50	10.80	50	9.75	2.50	10.00	10.15	£2.33

Material

Stainless Steel Grade 304 DIN 1481, ISO 8752

Performance

Uniform strength and flexibility. Absorbs shock and vibration. Closer diameter tolerances. Equal stress distribution
Wider hole tolerance. Conforms to hole. Swaged chamfers. Low insertion pressure - radial tension

Other Info.

Prices are listed per individual pin.

+44 (0)1246 455500
+44 (0)1246 455522

ondrives

sales@ondrives.com
www.ondrives.com

Product information updated 1st April 2011 and subject to change. Please contact Sales for the latest prices and availability.

MECHANICAL

Coiled Spring Pins and Slotted Spring Pins

Shear Strength

SEP Range (Carbon/Alloy Steel) & EP Range (Stainless Steel)

Spring pins are supplied as standard duty. Heavy and light duty spring pins are available P.O.A.

Minimum Double Shear Strength kN

NOMINAL Ø		0.8	1.0	1.2	1.5	2.0	2.5	3.0	3.5	4	5	6	8	10	12	16	20
Carbon/Alloy Steel																	
Chrome Stainless Steel																	
SEP	Standard Duty ISO 8750	0.4	0.60	0.90	1.45	2.5	3.9	5.5	7.5	9.6	15.0	22.0	39	62	89	155	250
	Heavy Duty ISO 8748	-	-	-	1.90	3.5	5.5	7.6	10.0	13.5	20.0	30.0	53	84	120	210	340
	Light Duty ISO 8751	-	-	-	0.80	1.5	2.3	3.6	4.5	5.7	9.0	13.0	23	-	-	-	-
Nickel Stainless Steel																	
EP	Standard Duty ISO 8750	0.3	0.45	0.65	1.05	1.9	2.9	4.2	5.7	7.6	11.5	16.8	30	48	67	-	-
	Heavy Duty ISO 8748	-	-	-	1.45	2.5	3.8	5.7	7.6	10.0	15.5	23.0	41	64	91	-	-
	Light Duty ISO 8751	-	-	-	0.65	1.1	1.8	2.5	3.4	4.4	7.0	10.0	18	-	-	-	-

SAP Range (Carbon Steel)

ISO 8752 (BS 7060, DIN 1481)

Material: BS 1449 CS 70

Harden and temper to HV420-HV520 equivalent to DIN 17222 C67 or AISI 1070.

SRP Range (Stainless)

ISO 8752 (BS 7060, DIN 1481)

Material: AISI 304 (ISO A2)

All dimensions in mm. Chamfer angle 15-30°. Chamfer dia, to be less than nominal hole size.

Length Tolerance (ISO 8752): Up to 10mm: ±0.25mm, 12mm to 50mm: ±0.50mm, over 55mm: ±0.75mm

Nom. Dia. ISO 8752 mm	Expanded Dia. 'd'		Recommended Hole Size		Material Thickness 's'	Minimum Double Shear Strength Kn		Chamfer Length 'a'	
	Min.	Max	Min.	Max		Carbon	Stainless	Min.	Max
1.0	1.2	1.3	1.00	1.10	0.2	0.70	0.40	0.15	0.34
1.5	1.7	1.8	1.50	1.60	0.3	1.58	0.98	0.24	0.45
2.0	2.3	2.4	2.00	2.10	0.4	2.82	1.81	0.35	0.55
2.5	2.8	2.9	2.50	2.60	0.5	4.38	2.84	0.40	0.60
3.0	3.3	3.5	3.00	3.10	0.6	6.32	4.07	0.50	0.70
3.5	3.8	4.0	3.50	3.62	0.7	9.06	5.80	0.60	0.80
4.0	4.4	4.6	4.00	4.12	0.8	11.24	7.25	0.65	0.85
5.0	5.4	5.6	5.00	5.12	1.0	17.54	10.75	0.90	1.10
6.0	6.4	6.7	6.00	6.12	1.2	26.04	16.17	1.20	1.40
8.0	8.5	8.8	8.00	8.15	1.5	42.76	26.46	1.40	1.80
10.0	10.5	10.8	10.00	10.15	2.0	70.16	42.14	2.00	2.40
12.0	12.5	12.8	12.00	12.17	2.5	104.10	62.00	2.00	2.40
14.0	14.5	14.8	14.00	14.17	3.0	144.70	-	2.00	2.40
16.0	16.5	16.8	16.00	16.17	3.0	171.00	-	2.00	2.40
20.0	20.5	20.9	20.00	20.20	4.0	280.00	-	-	-

Slotted spring pins consist of a single coil of spring steel (or stainless steel) with an open slot sufficiently wide to enable the pin to reduce in diameter as it is driven into a hole of appropriate size. The ends of the pin have a bevelled chamfer. They are designed for plain drilled holes but a countersink makes assembly easier. Slotted pins are normally supplied in the heavy duty form to ISO 8752, but a light duty version can be supplied to ISO 13337.

It is possible to increase the shear strength of slotted pins by inserting a small diameter pin inside a large one. This should always be done by inserting the larger pin first, then inserting the smaller one, taking care that the slot is between 90° and 180° away from the slot in the larger pin. Suitable combinations for pins to ISO 8752 are:

Outer Pin (mm)	Inner Pin (mm)	Outer Pin (mm)	Inner Pin (mm)
2.5	1.5	10.0	6.0
3.5	2.0	12.0	7.0
5.0	3.0	14.0	8.0
6.0	3.5	16.0	10.0
8.0	5.0	20.0	12.0

Supplied in plain oiled finish. Steel pins may be given a protective finish such as zinc or phosphate, but care is needed to prevent the open slots entangling in barrel plating processes. Where electrolytically applied finishes are used it is essential to de-embrittle the pins immediately after plating. Since the de-embrittlement process is not completely reliable, non-electrolytic finishes should be used for safety-critical applications. Where pins are to be installed in plastic it is recommended that they be de-oiled before use to avoid embrittlement of the plastic.

MECHANICAL

RPS
RPD

Retaining Pins - 'R' Clips

Single and Double Coil

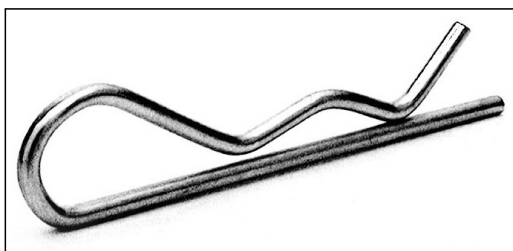

RPS Single Coil

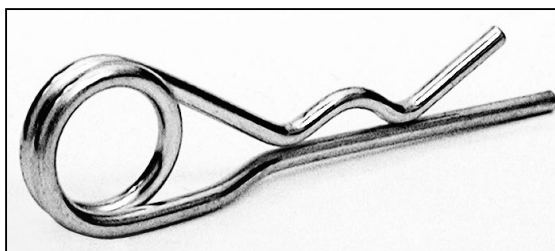

RPD Double Coil

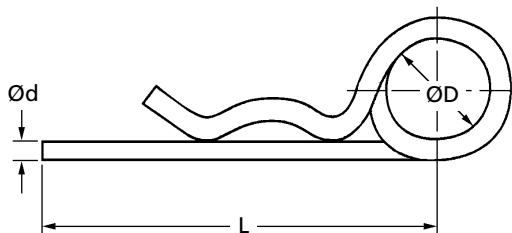
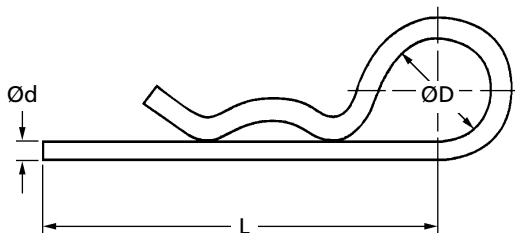

Discounts: 6+ -12% 20+ -25% 40+ -33% 60+ -37% 100+ -42% 200+ -50% 500+ -55% 1000+ -65%

Part Number	Diameter Ød	Length L	Diameter ØD	Recommended Hole Diameter	Range of Shaft Diameter	Price Each 1 - 5
SINGLE COIL						
RPS1.2-22	1.2	22	3.5	1.5	5 - 8	£0.28
RPS1.6-22	1.6	22	5.0	2.0	7 - 12	£0.12
RPS1.8-32	1.8	32	7.5	2.2	8 - 13	£0.14
RPS2-50	2.0	50	10.0	2.5	9 - 14	£0.13
RPS3-60	3.0	60	18.0	3.5	10 - 16	£0.30
RPS4-60	4.0	60	20.0	4.5	16 - 20	£0.48
RPS5-85	5.0	85	24.0	6.0	20 - 28	£0.81
RPS6-105	6.0	105	30.0	7.0	28 - 40	£1.30
RPS7-105	7.0	105	30.0	8.0	28 - 45	£2.37
RPS8-110	8.0	110	28.0	9.0	30 - 45	£3.07
DOUBLE COIL						
RPD2-50	2.0	50	10	2.5	8 - 14	£0.33
RPD3-62	3.0	62	16	3.5	14 - 20	£0.48
RPD4-78	4.0	78	23	4.5	17 - 24	£0.78
RPD5-92	5.0	92	26	5.5	18 - 30	£1.32
RPD6-120	6.0	120	30	6.5	24 - 36	£2.13
RPD7-130	7.0	130	30	8.0	26 - 40	£3.59
RPD8-130	8.0	130	30	9.0	24 - 40	£3.59

Material

Spring Steel, zinc plated

Other Info.

Retaining pins are available in two designs - the single coil for most applications and the double coil for more demanding use. Stainless single coil types are available in some sizes. Please contact Sales for price and delivery.

**SCP
SCPS**

MECHANICAL

Split Cotter Pins

DIN 94 / ISO 1234 : To Suit 1 - 2mm Dia. Holes

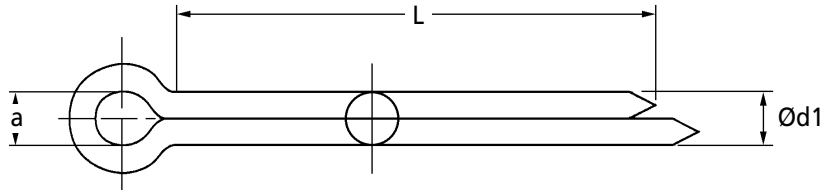
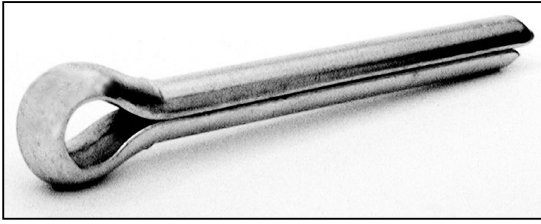

Steel Discounts: 50+ -20% | 100+ -30% | 200+ -40% | 500+ -50% | 1000+ -60% | 2000+ -70%

Stainless Discounts: 50+ -5% | 100+ -10% | 200+ -15% | 500+ -20% | 1000+ -25% | 2000+ -30%

Part Number	Steel	Stainless	To Suit Hole Ø	Ød1 Min.	Ød1 Max.	a Min.	a Max.	L	Price Each 1 - 49	
									Steel	Stainless
SCP1.0-6	SCP1.0-6	1.0	0.80	0.90	0.80	1.60	6	£0.04	£P.O.A	
SCP1.0-8	SCP1.0-8	1.0	0.80	0.90	0.80	1.60	8	£0.04	£P.O.A	
SCP1.0-10	SCP1.0-10	1.0	0.80	0.90	0.80	1.60	12	£0.04	£P.O.A	
SCP1.0-12	SCP1.0-12	1.0	0.80	0.90	0.80	1.60	16	£0.05	£P.O.A	
SCP1.0-16	SCP1.0-16	1.0	0.80	0.90	0.80	1.60	18	£0.05	£P.O.A	
SCP1.0-18	SCP1.0-18	1.0	0.80	0.90	0.80	1.60	22	£0.05	£P.O.A	
SCP1.0-20	SCP1.0-20	1.0	0.80	0.90	0.80	1.60	25	£0.05	£P.O.A	
SCP1.0-22	SCP1.0-22	1.0	0.80	0.90	0.80	1.60	32	£0.05	£P.O.A	
SCP1.0-25	SCP1.0-25	1.0	0.80	0.90	0.80	1.60	36	£0.06	£P.O.A	
SCP1.0-28	SCP1.0-28	1.0	0.80	0.90	0.80	1.60	40	£0.07	£P.O.A	
SCP1.0-32	SCP1.0-32	1.0	0.80	0.90	0.80	1.60	45	£0.09	£P.O.A	
SCP1.0-36	-	1.0	0.80	0.90	0.80	1.60	50	£0.09	-	
SCP1.2-10	SCP1.2-10	1.2	1.09	1.00	1.25	2.50	10	£0.05	£0.11	
SCP1.2-12	SCP1.2-12	1.2	1.09	1.00	1.25	2.50	12	£0.05	£0.11	
SCP1.2-16	SCP1.2-16	1.2	1.09	1.00	1.25	2.50	16	£0.05	£0.11	
SCP1.2-18	SCP1.2-18	1.2	1.09	1.00	1.25	2.50	18	£P.O.A	£P.O.A	
SCP1.2-20	SCP1.2-20	1.2	1.09	1.00	1.25	2.50	20	£0.06	£0.14	
SCP1.2-22	SCP1.2-22	1.2	1.09	1.00	1.25	2.50	22	£0.06	£0.14	
SCP1.2-25	SCP1.2-25	1.2	1.09	1.00	1.25	2.50	25	£0.06	£0.14	
SCP1.2-28	SCP1.2-28	1.2	1.09	1.00	1.25	2.50	28	£0.07	£0.16	
SCP1.2-32	SCP1.2-32	1.2	1.09	1.00	1.25	2.50	32	£0.07	£P.O.A	
SCP1.2-36	-	1.2	1.09	1.00	1.25	2.50	36	£0.08	-	
SCP1.6-10	SCP1.6-10	1.6	1.30	1.40	1.25	2.50	10	£0.04	£0.09	
SCP1.6-12	SCP1.6-12	1.6	1.30	1.40	1.25	2.50	12	£0.04	£0.09	
SCP1.6-16	SCP1.6-16	1.6	1.30	1.40	1.25	2.50	16	£0.04	£0.09	
SCP1.6-18	SCP1.6-18	1.6	1.30	1.40	1.25	2.50	18	£0.05	£0.11	
SCP1.6-20	SCP1.6-20	1.6	1.30	1.40	1.25	2.50	20	£0.05	£0.11	
SCP1.6-22	SCP1.6-22	1.6	1.30	1.40	1.25	2.50	22	£0.05	£0.11	
SCP1.6-25	SCP1.6-25	1.6	1.30	1.40	1.25	2.50	25	£0.05	£0.11	
SCP1.6-28	SCP1.6-28	1.6	1.30	1.40	1.25	2.50	28	£0.06	£0.14	
SCP1.6-32	SCP1.6-32	1.6	1.30	1.40	1.25	2.50	32	£0.06	£0.14	
SCP1.6-36	-	1.6	1.30	1.40	1.25	2.50	36	£0.07	-	
SCP2.0-10	SCP2.0-10	2.0	1.70	1.80	1.25	2.50	10	£0.04	£0.09	
SCP2.0-12	SCP2.0-12	2.0	1.70	1.80	1.25	2.50	12	£0.04	£0.09	
SCP2.0-16	SCP2.0-16	2.0	1.70	1.80	1.25	2.50	16	£0.04	£0.09	
SCP2.0-18	SCP2.0-18	2.0	1.70	1.80	1.25	2.50	18	£0.04	£0.09	
SCP2.0-20	SCP2.0-20	2.0	1.70	1.80	1.25	2.50	20	£0.04	£0.09	
SCP2.0-22	SCP2.0-22	2.0	1.70	1.80	1.25	2.50	22	£0.04	£0.09	
SCP2.0-25	SCP2.0-25	2.0	1.70	1.80	1.25	2.50	25	£0.05	£0.11	
SCP2.0-28	SCP2.0-28	2.0	1.70	1.80	1.25	2.50	28	£0.05	£0.11	
SCP2.0-32	SCP2.0-32	2.0	1.70	1.80	1.25	2.50	32	£0.06	£0.14	
SCP2.0-36	SCP2.0-36	2.0	1.70	1.80	1.25	2.50	36	£0.06	£0.14	
SCP2.0-40	SCP2.0-40	2.0	1.70	1.80	1.25	2.50	40	£0.07	£0.16	
SCP2.0-45	SCP2.0-45	2.0	1.70	1.80	1.25	2.50	45	£0.08	£0.21	
SCP2.0-50	SCP2.0-50	2.0	1.70	1.80	1.25	2.50	50	£0.09	£0.26	

Material SCP Type: Low Carbon Steel SCPS Type: Stainless Steel A2 (WS 1.4301) SCPS1.0 to SCPS1.6, A4 SCPS2.0 to SCPS6.3

Other Info. Cotter pins are made to DIN94 and also equal to ISO1234 and BS1574. Steel Pins can be zinc plated or phosphate coated, but since such finishes cannot be applied to the inside faces of the pin, only stainless can be recommended where full corrosion resistance is needed.

+44 (0)1246 455500
+44 (0)1246 455522

ondrives

sales@ondrives.com
www.ondrives.com

Product information updated 1st April 2011 and subject to change. Please contact Sales for the latest prices and availability.

MECHANICAL

**SCP
SCPS**

Split Cotter Pins

DIN 94 / ISO 1234 : To Suit 2.5 - 4mm Dia. Holes

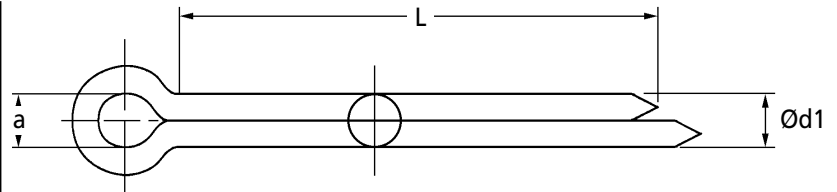
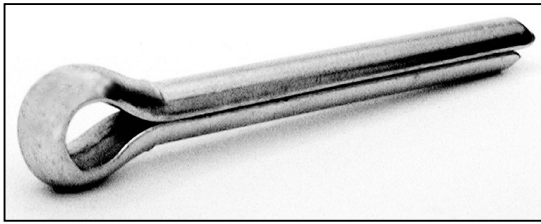

Steel Discounts: 50+ -20% | 100+ -30% | 200+ -40% | 500+ -50% | 1000+ -60% | 2000+ -70%

Stainless Discounts: 50+ -5% | 100+ -10% | 200+ -15% | 500+ -20% | 1000+ -25% | 2000+ -30%

Part Number		To Suit Hole Ø	Ød1 Min.	Ød1 Max.	a Min.	a Max.	L	Price Each 1 - 49	
Steel	Stainless							Steel	Stainless
SCP2.5-10	SCPS2.5-10	2.5	2.10	2.30	1.25	2.50	10	£0.04	£0.09
SCP2.5-12	SCPS2.5-12	2.5	2.10	2.30	1.25	2.50	12	£0.04	£0.09
SCP2.5-16	SCPS2.5-16	2.5	2.10	2.30	1.25	2.50	16	£0.04	£0.09
SCP2.5-18	SCPS2.5-18	2.5	2.10	2.30	1.25	2.50	18	£0.04	£0.09
SCP2.5-20	SCPS2.5-20	2.5	2.10	2.30	1.25	2.50	20	£0.05	£0.11
SCP2.5-22	SCPS2.5-22	2.5	2.10	2.30	1.25	2.50	22	£0.05	£0.11
SCP2.5-25	SCPS2.5-25	2.5	2.10	2.30	1.25	2.50	25	£0.06	£0.14
SCP2.5-28	SCPS2.5-28	2.5	2.10	2.30	1.25	2.50	28	£0.06	£0.14
SCP2.5-32	SCPS2.5-32	2.5	2.10	2.30	1.25	2.50	32	£0.07	£0.16
SCP2.5-36	SCPS2.5-36	2.5	2.10	2.30	1.25	2.50	36	£0.07	£0.16
SCP2.5-40	SCPS2.5-40	2.5	2.10	2.30	1.25	2.50	40	£0.08	£0.21
SCP2.5-45	SCPS2.5-45	2.5	2.10	2.30	1.25	2.50	45	£0.08	£0.21
SCP2.5-50	SCPS2.5-50	2.5	2.10	2.30	1.25	2.50	50	£0.09	£0.26
SCP2.5-56	SCPS2.5-56	2.5	2.10	2.30	1.25	2.50	56	£0.09	£0.26
SCP2.5-63	SCPS2.5-63	2.5	2.10	2.30	1.25	2.50	63	£0.10	£0.28
SCP2.5-71	SCPS2.5-71	2.5	2.10	2.30	1.25	2.50	71	£0.11	£0.30
SCP3.2-16	SCPS3.2-16	3.2	2.70	2.90	1.60	3.20	16	£0.04	£0.09
SCP3.2-18	SCPS3.2-18	3.2	2.70	2.90	1.60	3.20	18	£0.04	£0.09
SCP3.2-20	SCPS3.2-20	3.2	2.70	2.90	1.60	3.20	20	£0.05	£0.11
SCP3.2-22	SCPS3.2-22	3.2	2.70	2.90	1.60	3.20	22	£0.05	£0.11
SCP3.2-25	SCPS3.2-25	3.2	2.70	2.90	1.60	3.20	25	£0.06	£0.14
SCP3.2-28	SCPS3.2-28	3.2	2.70	2.90	1.60	3.20	28	£0.06	£0.14
SCP3.2-32	SCPS3.2-32	3.2	2.70	2.90	1.60	3.20	32	£0.07	£0.16
SCP3.2-36	SCPS3.2-36	3.2	2.70	2.90	1.60	3.20	36	£0.07	£0.16
SCP3.2-40	SCPS3.2-40	3.2	2.70	2.90	1.60	3.20	40	£0.08	£0.21
SCP3.2-45	SCPS3.2-45	3.2	2.70	2.90	1.60	3.20	45	£0.08	£0.21
SCP3.2-50	SCPS3.2-50	3.2	2.70	2.90	1.60	3.20	50	£0.10	£0.28
SCP3.2-56	SCPS3.2-56	3.2	2.70	2.90	1.60	3.20	56	£0.11	£0.30
SCP3.2-63	SCPS3.2-63	3.2	2.70	2.90	1.60	3.20	63	£0.12	£0.33
SCP3.2-71	SCPS3.2-71	3.2	2.70	2.90	1.60	3.20	71	£0.13	£0.35
SCP4.0-16	SCPS4.0-16	4.0	3.50	3.70	2.00	4.00	16	£0.05	£0.11
SCP4.0-18	SCPS4.0-18	4.0	3.50	3.70	2.00	4.00	18	£0.06	£0.14
SCP4.0-20	SCPS4.0-20	4.0	3.50	3.70	2.00	4.00	20	£0.06	£0.14
SCP4.0-22	SCPS4.0-22	4.0	3.50	3.70	2.00	4.00	22	£0.07	£0.16
SCP4.0-25	SCPS4.0-25	4.0	3.50	3.70	2.00	4.00	25	£0.07	£0.16
SCP4.0-28	SCPS4.0-28	4.0	3.50	3.70	2.00	4.00	28	£0.08	£0.21
SCP4.0-32	SCPS4.0-32	4.0	3.50	3.70	2.00	4.00	32	£0.08	£0.21
SCP4.0-36	SCPS4.0-36	4.0	3.50	3.70	2.00	4.00	36	£0.08	£0.21
SCP4.0-40	SCPS4.0-40	4.0	3.50	3.70	2.00	4.00	40	£0.09	£0.26
SCP4.0-45	SCPS4.0-45	4.0	3.50	3.70	2.00	4.00	45	£0.10	£0.28
SCP4.0-50	SCPS4.0-50	4.0	3.50	3.70	2.00	4.00	50	£0.11	£0.30
SCP4.0-56	SCPS4.0-56	4.0	3.50	3.70	2.00	4.00	56	£0.11	£0.30
SCP4.0-63	SCPS4.0-63	4.0	3.50	3.70	2.00	4.00	63	£0.12	£0.33
SCP4.0-71	SCPS4.0-71	4.0	3.50	3.70	2.00	4.00	71	£0.12	£0.33
SCP4.0-80	SCPS4.0-80	4.0	3.50	3.70	2.00	4.00	80	£0.13	£0.35
SCP4.0-90	SCPS4.0-90	4.0	3.50	3.70	2.00	4.00	90	£0.14	£0.39
SCP4.0-100	SCPS4.0-100	4.0	3.50	3.70	2.00	4.00	100	£0.25	£0.56
SCP4.0-112	SCPS4.0-112	4.0	3.50	3.70	2.00	4.00	112	£0.28	£0.65
SCP4.0-125	SCPS4.0-125	4.0	3.50	3.70	2.00	4.00	125	£0.31	£0.74

+44 (0)1246 455500
+44 (0)1246 455522

ondrives

sales@ondrives.com
www.ondrives.com

Product information updated 1st April 2011 and subject to change. Please contact Sales for the latest prices and availability.

Split Cotter Pins

DIN 94 / ISO 1234 : To Suit 5 - 6.3mm Dia. Holes

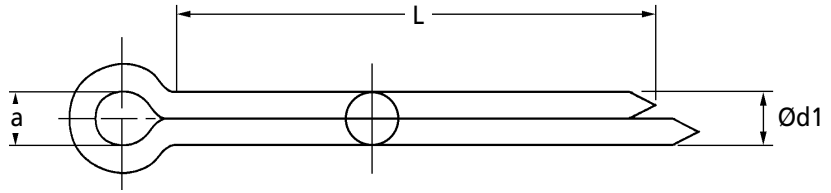
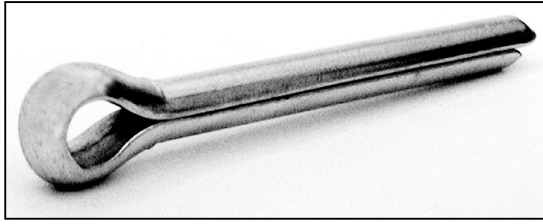

Steel Discounts: 50+ -20% | 100+ -30% | 200+ -40% | 500+ -50% | 1000+ -60% | 2000+ -70%

Stainless Discounts: 50+ -5% | 100+ -10% | 200+ -15% | 500+ -20% | 1000+ -25% | 2000+ -30%

Part Number	Steel	Stainless	To Suit Hole Ø	Ød1 Min.	Ød1 Max.	a Min.	a Max.	L	Price Each 1 - 49	
									Steel	Stainless
SCP5.0-16	SCP5.0-16	5.0	4.40	4.60	2.00	4.00	16	£0.06	£0.14	
SCP5.0-18	SCP5.0-18	5.0	4.40	4.60	2.00	4.00	18	£0.07	£0.16	
SCP5.0-20	SCP5.0-20	5.0	4.40	4.60	2.00	4.00	20	£0.08	£0.21	
SCP5.0-22	SCP5.0-22	5.0	4.40	4.60	2.00	4.00	22	£0.09	£0.26	
SCP5.0-25	SCP5.0-25	5.0	4.40	4.60	2.00	4.00	25	£0.10	£0.28	
SCP5.0-28	SCP5.0-28	5.0	4.40	4.60	2.00	4.00	28	£0.10	£0.28	
SCP5.0-32	SCP5.0-32	5.0	4.40	4.60	2.00	4.00	32	£0.11	£0.30	
SCP5.0-36	SCP5.0-36	5.0	4.40	4.60	2.00	4.00	36	£0.12	£0.33	
SCP5.0-40	SCP5.0-40	5.0	4.40	4.60	2.00	4.00	40	£0.12	£0.33	
SCP5.0-45	SCP5.0-45	5.0	4.40	4.60	2.00	4.00	45	£0.13	£0.35	
SCP5.0-50	SCP5.0-50	5.0	4.40	4.60	2.00	4.00	50	£0.13	£0.35	
SCP5.0-56	SCP5.0-56	5.0	4.40	4.60	2.00	4.00	56	£0.14	£0.39	
SCP5.0-63	SCP5.0-63	5.0	4.40	4.60	2.00	4.00	63	£0.15	£0.44	
SCP5.0-71	SCP5.0-71	5.0	4.40	4.60	2.00	4.00	71	£0.16	£0.46	
SCP5.0-80	SCP5.0-80	5.0	4.40	4.60	2.00	4.00	80	£0.21	£0.50	
SCP5.0-90	SCP5.0-90	5.0	4.40	4.60	2.00	4.00	90	£0.22	£0.53	
SCP5.0-100	SCP5.0-100	5.0	4.40	4.60	2.00	4.00	100	£0.31	£0.74	
SCP5.0-112	SCP5.0-112	5.0	4.40	4.60	2.00	4.00	112	£0.32	£0.78	
SCP5.0-125	SCP5.0-125	5.0	4.40	4.60	2.00	4.00	125	£0.35	£0.87	
SCP6.3-20	SCP6.3-20	6.3	5.70	5.90	2.00	4.00	20	£0.15	£0.44	
SCP6.3-22	SCP6.3-22	6.3	5.70	5.90	2.00	4.00	22	£0.15	£0.44	
SCP6.3-25	SCP6.3-25	6.3	5.70	5.90	2.00	4.00	25	£0.16	£0.46	
SCP6.3-28	SCP6.3-28	6.3	5.70	5.90	2.00	4.00	28	£0.16	£0.46	
SCP6.3-32	SCP6.3-32	6.3	5.70	5.90	2.00	4.00	32	£0.21	£0.50	
SCP6.3-36	SCP6.3-36	6.3	5.70	5.90	2.00	4.00	36	£0.22	£0.53	
SCP6.3-40	SCP6.3-40	6.3	5.70	5.90	2.00	4.00	40	£0.25	£0.56	
SCP6.3-45	SCP6.3-45	6.3	5.70	5.90	2.00	4.00	45	£0.28	£0.65	
SCP6.3-50	SCP6.3-50	6.3	5.70	5.90	2.00	4.00	50	£0.29	£0.67	
SCP6.3-56	SCP6.3-56	6.3	5.70	5.90	2.00	4.00	56	£0.30	£0.70	
SCP6.3-63	SCP6.3-63	6.3	5.70	5.90	2.00	4.00	63	£0.32	£0.78	
SCP6.3-71	SCP6.3-71	6.3	5.70	5.90	2.00	4.00	71	£0.33	£0.81	
SCP6.3-80	SCP6.3-80	6.3	5.70	5.90	2.00	4.00	80	£0.35	£0.87	
SCP6.3-90	SCP6.3-90	6.3	5.70	5.90	2.00	4.00	90	£0.40	£0.95	
SCP6.3-100	SCP6.3-100	6.3	5.70	5.90	2.00	4.00	100	£0.45	£1.03	
SCP6.3-112	SCP6.3-112	6.3	5.70	5.90	2.00	4.00	112	£0.46	£1.06	
SCP6.3-125	SCP6.3-125	6.3	5.70	5.90	2.00	4.00	125	£0.51	£1.14	
SCP6.3-140	SCP6.3-140	6.3	5.70	5.90	2.00	4.00	140	£0.53	£1.20	

Material

SCP Type: Low Carbon Steel

SCPS Type: Stainless Steel A2 (WS 1.4301) SCPS1.0 to SCPS1.6, A4 SCPS2.0 to SCPS6.3

Other Info.

Cotter pins are made to DIN94 and also equal to ISO1234 and BS1574.

Steel Pins can be zinc plated or phosphate coated, but since such finishes cannot be applied to the inside faces of the pin, only stainless can be recommended where full corrosion resistance is needed.

MECHANICAL

SCP

Split Cotter Pins

DIN 94 / ISO 1234 : To Suit 8 - 12mm Dia. Holes

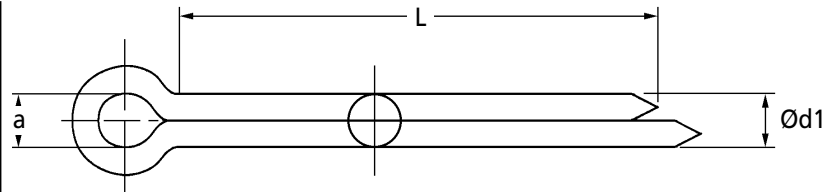
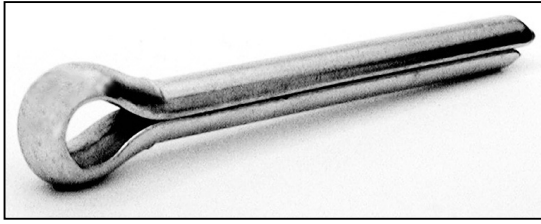

Steel Discounts: 50+ -20% 100+ -30% 200+ -40% 500+ -50% 1000+ -60% 2000+ -70%

Part Number Steel	To Suit Hole Ø	Ød1 Min.	Ød1 Max.	a Min.	a Max.	L	Price Each 1 - 49 Steel
SCP8.0-32	8.0	7.30	7.50	2.00	4.00	32	£0.32
SCP8.0-36	8.0	7.30	7.50	2.00	4.00	36	£0.34
SCP8.0-40	8.0	7.30	7.50	2.00	4.00	40	£0.37
SCP8.0-45	8.0	7.30	7.50	2.00	4.00	45	£0.45
SCP8.0-50	8.0	7.30	7.50	2.00	4.00	50	£0.48
SCP8.0-56	8.0	7.30	7.50	2.00	4.00	56	£0.51
SCP8.0-63	8.0	7.30	7.50	2.00	4.00	63	£0.53
SCP8.0-71	8.0	7.30	7.50	2.00	4.00	71	£0.56
SCP8.0-80	8.0	7.30	7.50	2.00	4.00	80	£0.59
SCP8.0-90	8.0	7.30	7.50	2.00	4.00	90	£0.61
SCP8.0-100	8.0	7.30	7.50	2.00	4.00	100	£0.67
SCP8.0-112	8.0	7.30	7.50	2.00	4.00	112	£0.74
SCP8.0-125	8.0	7.30	7.50	2.00	4.00	125	£0.79
SCP8.0-140	8.0	7.30	7.50	2.00	4.00	140	£0.84
SCP8.0-160	8.0	7.30	7.50	2.00	4.00	160	£0.93
SCP10.0-32	10.0	9.30	9.50	3.20	6.30	32	£0.46
SCP10.0-36	10.0	9.30	9.50	3.20	6.30	36	£0.50
SCP10.0-40	10.0	9.30	9.50	3.20	6.30	40	£0.53
SCP10.0-45	10.0	9.30	9.50	3.20	6.30	45	£0.58
SCP10.0-50	10.0	9.30	9.50	3.20	6.30	50	£0.64
SCP10.0-56	10.0	9.30	9.50	3.20	6.30	56	£0.69
SCP10.0-63	10.0	9.30	9.50	3.20	6.30	63	£0.72
SCP10.0-71	10.0	9.30	9.50	3.20	6.30	71	£0.88
SCP10.0-80	10.0	9.30	9.50	3.20	6.30	80	£0.98
SCP10.0-90	10.0	9.30	9.50	3.20	6.30	90	£0.99
SCP10.0-100	10.0	9.30	9.50	3.20	6.30	100	£1.07
SCP10.0-112	10.0	9.30	9.50	3.20	6.30	112	£1.20
SCP10.0-125	10.0	9.30	9.50	3.20	6.30	125	£1.30
SCP10.0-140	10.0	9.30	9.50	3.20	6.30	140	£1.41
SCP10.0-160	10.0	9.30	9.50	3.20	6.30	160	£1.47
SCP12.0-45	12.0	12.10	12.40	3.20	6.30	45	£0.68
SCP12.0-50	12.0	12.10	12.40	3.20	6.30	50	£0.76
SCP12.0-56	12.0	12.10	12.40	3.20	6.30	56	£0.85
SCP12.0-63	12.0	12.10	12.40	3.20	6.30	63	£0.98
SCP12.0-71	12.0	12.10	12.40	3.20	6.30	71	£1.09
SCP12.0-80	12.0	12.10	12.40	3.20	6.30	80	£1.23
SCP12.0-90	12.0	12.10	12.40	3.20	6.30	90	£1.35
SCP12.0-100	12.0	12.10	12.40	3.20	6.30	100	£1.55
SCP12.0-112	12.0	12.10	12.40	3.20	6.30	112	£1.66
SCP12.0-125	12.0	12.10	12.40	3.20	6.30	125	£1.85
SCP12.0-140	12.0	12.10	12.40	3.20	6.30	140	£2.07
SCP12.0-160	12.0	12.10	12.40	3.20	6.30	160	£2.12

Material

SCP Type: Low Carbon Steel

Other Info.

Cotter pins are made to DIN94 and also equal to ISO1234 and BS1574.

Steel Pins can be zinc plated or phosphate coated, but since such finishes cannot be applied to the inside faces of the pin, only stainless can be recommended where full corrosion resistance is needed.

+44 (0)1246 455500

+44 (0)1246 455522

ondrives

sales@ondrives.com

www.ondrives.com

Product information updated 1st April 2011 and subject to change. Please contact Sales for the latest prices and availability.