

EP

MECHANICAL

302 Nickel Stainless Coiled Spring Pins

ISO 8750 : 0.8 - 4mm Dia.

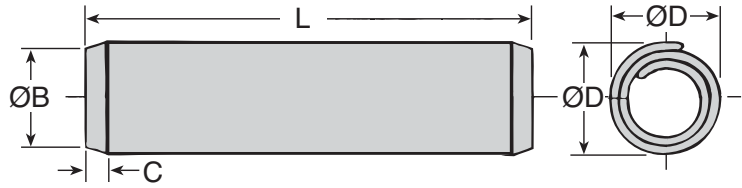
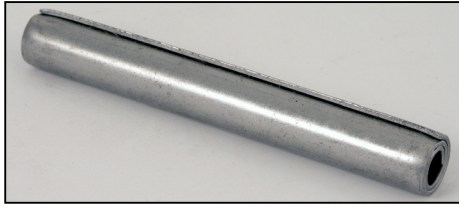

Discounts: 31+ -15% | 50+ -30% | 100+ -50% | 200+ -60% | 1000+ -65% | 2000+ -70%

Part Number	Diameter (ØD)			L	Chamfer		Hole		Price Each 1 - 30	Part Number	Diameter (ØD)			L	Chamfer		Hole		Price Each 1 - 30
	Nom	Min	Max		ØB	C	Min	Max			Nom	Min	Max		ØB	C	Min	Max	
EP0.8-4	0.8	0.85	0.91	4	0.75	0.30	0.80	0.84	£2.25	EP2.5-8	2.5	2.62	2.79	8	2.40	0.70	2.49	2.60	£0.19
EP0.8-5	0.8	0.85	0.91	5	0.75	0.30	0.80	0.84	£P.O.A	EP2.5-10	2.5	2.62	2.79	10	2.40	0.70	2.49	2.60	£0.21
EP0.8-6	0.8	0.85	0.91	6	0.75	0.30	0.80	0.84	£0.21	EP2.5-12	2.5	2.62	2.79	12	2.40	0.70	2.49	2.60	£0.21
EP0.8-8	0.8	0.85	0.91	8	0.75	0.30	0.80	0.84	£0.21	EP2.5-14	2.5	2.62	2.79	14	2.40	0.70	2.49	2.60	£0.22
EP0.8-10	0.8	0.85	0.91	10	0.75	0.30	0.80	0.84	£0.21	EP2.5-16	2.5	2.62	2.79	16	2.40	0.70	2.49	2.60	£0.22
EP0.8-12	0.8	0.85	0.91	12	0.75	0.30	0.80	0.84	£0.22	EP2.5-18	2.5	2.62	2.79	18	2.40	0.70	2.49	2.60	£0.25
EP1-4	1.0	1.05	1.15	4	0.95	0.30	1.00	1.04	£0.16	EP2.5-20	2.5	2.62	2.79	20	2.40	0.70	2.49	2.60	£0.25
EP1-5	1.0	1.05	1.15	5	0.95	0.30	1.00	1.04	£0.19	EP2.5-22	2.5	2.62	2.79	22	2.40	0.70	2.49	2.60	£0.26
EP1-6	1.0	1.05	1.15	6	0.95	0.30	1.00	1.04	£0.21	EP2.5-24	2.5	2.62	2.79	24	2.40	0.70	2.49	2.60	£0.26
EP1-8	1.0	1.05	1.15	8	0.95	0.30	1.00	1.04	£0.21	EP3-10	3.0	3.15	3.30	10	2.90	0.90	2.99	3.10	£0.22
EP1-10	1.0	1.05	1.15	10	0.95	0.30	1.00	1.04	£0.21	EP3-12	3.0	3.15	3.30	12	2.90	0.90	2.99	3.10	£0.25
EP1-12	1.0	1.05	1.15	12	0.95	0.30	1.00	1.04	£0.21	EP3-14	3.0	3.15	3.30	14	2.90	0.90	2.99	3.10	£0.26
EP1-14	1.0	1.05	1.15	14	0.95	0.30	1.00	1.04	£0.21	EP3-16	3.0	3.15	3.30	16	2.90	0.90	2.99	3.10	£0.27
EP1-16	1.0	1.05	1.15	16	0.95	0.30	1.00	1.04	£0.26	EP3-18	3.0	3.15	3.30	18	2.90	0.90	2.99	3.10	£0.28
EP1.2-4	1.2	1.25	1.35	4	1.15	0.40	1.20	1.24	£0.19	EP3-20	3.0	3.15	3.30	20	2.90	0.90	2.99	3.10	£0.29
EP1.2-6	1.2	1.25	1.35	6	1.15	0.40	1.20	1.24	£P.O.A	EP3-22	3.0	3.15	3.30	22	2.90	0.90	2.99	3.10	£0.30
EP1.2-8	1.2	1.25	1.35	8	1.15	0.40	1.20	1.24	£0.21	EP3-24	3.0	3.15	3.30	24	2.90	0.90	2.99	3.10	£0.31
EP1.2-10	1.2	1.25	1.35	10	1.15	0.40	1.20	1.24	£0.21	EP3-26	3.0	3.15	3.30	26	2.90	0.90	2.99	3.10	£0.32
EP1.2-12	1.2	1.25	1.35	12	1.15	0.40	1.20	1.24	£0.21	EP3-28	3.0	3.15	3.30	28	2.90	0.90	2.99	3.10	£0.33
EP1.5-5	1.5	1.62	1.73	5	1.40	0.50	1.50	1.60	£0.13	EP3-30	3.0	3.15	3.30	30	2.90	0.90	2.99	3.10	£0.34
EP1.5-6	1.5	1.62	1.73	6	1.40	0.50	1.50	1.60	£0.14	EP3-35	3.0	3.15	3.30	35	2.90	0.90	2.99	3.10	£0.34
EP1.5-8	1.5	1.62	1.73	8	1.40	0.50	1.50	1.60	£0.14	EP3-40	3.0	3.15	3.30	40	2.90	0.90	2.99	3.10	£0.34
EP1.5-10	1.5	1.62	1.73	10	1.40	0.50	1.50	1.60	£0.14	EP3.5-12	3.5	3.64	3.79	12	3.40	1.00	3.48	3.62	£0.44
EP1.5-12	1.5	1.62	1.73	12	1.40	0.50	1.50	1.60	£0.15	EP3.5-16	3.5	3.64	3.79	16	3.40	1.00	3.48	3.62	£0.48
EP1.5-14	1.5	1.62	1.73	14	1.40	0.50	1.50	1.60	£0.15	EP3.5-18	3.5	3.64	3.79	18	3.40	1.00	3.48	3.62	£0.51
EP1.5-16	1.5	1.62	1.73	16	1.40	0.50	1.50	1.60	£0.15	EP3.5-20	3.5	3.64	3.79	20	3.40	1.00	3.48	3.62	£0.51
EP1.5-20	1.5	1.62	1.73	20	1.40	0.50	1.50	1.60	£0.16	EP3.5-22	3.5	3.64	3.79	22	3.40	1.00	3.48	3.62	£0.53
EP1.5-24	1.5	1.62	1.73	24	1.40	0.50	1.50	1.60	£0.19	EP3.5-24	3.5	3.64	3.79	24	3.40	1.00	3.48	3.62	£0.58
EP2-6	2.0	2.13	2.25	6	1.90	0.70	1.99	2.10	£0.15	EP3.5-28	3.5	3.64	3.79	28	3.40	1.00	3.48	3.62	£0.63
EP2-8	2.0	2.13	2.25	8	1.90	0.70	1.99	2.10	£0.15	EP3.5-30	3.5	3.64	3.79	30	3.40	1.00	3.48	3.62	£0.64
EP2-10	2.0	2.13	2.25	10	1.90	0.70	1.99	2.10	£0.15	EP3.5-35	3.5	3.64	3.79	35	3.40	1.00	3.48	3.62	£P.O.A
EP2-12	2.0	2.13	2.25	12	1.90	0.70	1.99	2.10	£0.16	EP4-12	4.0	4.20	4.40	12	3.90	1.10	3.98	4.12	£0.51
EP2-14	2.0	2.13	2.25	14	1.90	0.70	1.99	2.10	£0.16	EP4-14	4.0	4.20	4.40	14	3.90	1.10	3.98	4.12	£0.53
EP2-16	2.0	2.13	2.25	16	1.90	0.70	1.99	2.10	£0.19	EP4-16	4.0	4.20	4.40	16	3.90	1.10	3.98	4.12	£0.56
EP2-18	2.0	2.13	2.25	18	1.90	0.70	1.99	2.10	£0.19	EP4-18	4.0	4.20	4.40	18	3.90	1.10	3.98	4.12	£0.59
EP2-20	2.0	2.13	2.25	20	1.90	0.70	1.99	2.10	£0.21	EP4-20	4.0	4.20	4.40	20	3.90	1.10	3.98	4.12	£0.61
EP2-30	2.0	2.13	2.25	30	1.90	0.70	1.99	2.10	£0.32	EP4-22	4.0	4.20	4.40	22	3.90	1.10	3.98	4.12	£0.64
										EP4-24	4.0	4.20	4.40	24	3.90	1.10	3.98	4.12	£0.66

Material

Nickel Stainless Steel (AISI.302)

Performance

Uniform strength and flexibility. Absorbs shock and vibration. Closer diameter tolerances. Equal stress distribution

Wider hole tolerance. Conforms to hole. Swaged chamfers. Low insertion pressure - radial tension

Standard type: ISO 8750, **Heavy Duty:** ISO 8748 (available depending on size), **Light Duty:** ISO 8751 (available depending on size)

Other Info.

Prices are listed per individual pin.

+44 (0)1246 455500

+44 (0)1246 455522

ondrives

sales@ondrives.com

www.ondrives.com

Product information updated 1st April 2011 and subject to change. Please contact Sales for the latest prices and availability.

MECHANICAL

302 Nickel Stainless Coiled Spring Pins

ISO 8750 : 4 - 12mm Dia.

EP

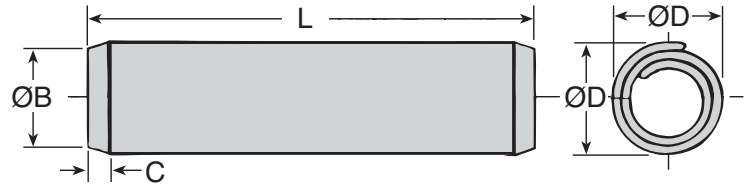
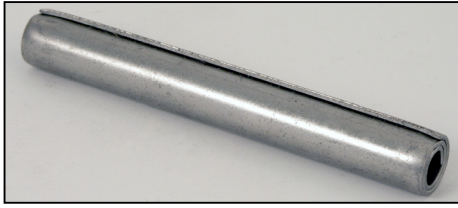

Discounts: 31+ -15% 50+ -30% 100+ -50% 200+ -60% 1000+ -65% 2000+ -70%

Part Number	Diameter (ØD)			L	Chamfer		Hole		Price Each 1 - 30	Part Number	Diameter (ØD)			L	Chamfer		Hole		Price Each 1 - 30
	Nom	Min	Max		ØB	C	Min	Max			Nom	Min	Max		ØB	C	Min	Max	
EP4-26	4	4.20	4.40	26	3.90	1.10	3.98	4.12	£0.68	EP8-30	8	8.30	8.63	30	7.80	2.00	7.93	8.17	£2.08
EP4-28	4	4.20	4.40	28	3.90	1.10	3.98	4.12	£0.70	EP8-35	8	8.30	8.63	35	7.80	2.00	7.93	8.17	£2.25
EP4-30	4	4.20	4.40	30	3.90	1.10	3.98	4.12	£0.74	EP8-40	8	8.30	8.63	40	7.80	2.00	7.93	8.17	£2.47
EP4-35	4	4.20	4.40	35	3.90	1.10	3.98	4.12	£0.80	EP8-45	8	8.30	8.63	45	7.80	2.00	7.93	8.17	£2.73
EP4-40	4	4.20	4.40	40	3.90	1.10	3.98	4.12	£0.87	EP8-50	8	8.30	8.63	50	7.80	2.00	7.93	8.17	£3.01
EP4-45	4	4.20	4.40	45	3.90	1.10	3.98	4.12	£0.90	EP8-60	8	8.30	8.63	60	7.80	2.00	7.93	8.17	£3.65
EP4-50	4	4.20	4.40	50	3.90	1.10	3.98	4.12	£0.90	EP8-65	8	8.30	8.63	65	7.80	2.00	7.93	8.17	£4.03
EP5-14	5	5.25	5.50	14	4.85	1.30	4.95	5.12	£0.72	EP8-70	8	8.30	8.63	70	7.80	2.00	7.93	8.17	£4.15
EP5-16	5	5.25	5.50	16	4.85	1.30	4.95	5.12	£0.78	EP8-75	8	8.30	8.63	75	7.80	2.00	7.93	8.17	£4.57
EP5-18	5	5.25	5.50	18	4.85	1.30	4.95	5.12	£0.81	EP10-24	10	10.30	10.65	24	9.75	2.50	9.96	10.20	£3.49
EP5-20	5	5.25	5.50	20	4.85	1.30	4.95	5.12	£0.85	EP10-26	10	10.30	10.65	26	9.75	2.50	9.96	10.20	£3.78
EP5-22	5	5.25	5.50	22	4.85	1.30	4.95	5.12	£0.89	EP10-28	10	10.30	10.65	28	9.75	2.50	9.96	10.20	£4.03
EP5-24	5	5.25	5.50	24	4.85	1.30	4.95	5.12	£0.93	EP10-30	10	10.30	10.65	30	9.75	2.50	9.96	10.20	£4.28
EP5-26	5	5.25	5.50	26	4.85	1.30	4.95	5.12	£0.95	EP10-35	10	10.30	10.65	35	9.75	2.50	9.96	10.20	£4.94
EP5-28	5	5.25	5.50	28	4.85	1.30	4.95	5.12	£1.00	EP10-40	10	10.30	10.65	40	9.75	2.50	9.96	10.20	£5.57
EP5-30	5	5.25	5.50	30	4.85	1.30	4.95	5.12	£1.05	EP10-45	10	10.30	10.65	45	9.75	2.50	9.96	10.20	£6.20
EP5-35	5	5.25	5.50	35	4.85	1.30	4.95	5.12	£1.14	EP10-50	10	10.30	10.65	50	9.75	2.50	9.96	10.20	£6.80
EP5-40	5	5.25	5.50	40	4.85	1.30	4.95	5.12	£1.23	EP10-55	10	10.30	10.65	55	9.75	2.50	9.96	10.20	£7.49
EP5-45	5	5.25	5.50	45	4.85	1.30	4.95	5.12	£1.34	EP10-60	10	10.30	10.65	60	9.75	2.50	9.96	10.20	£8.13
EP5-50	5	5.25	5.50	50	4.85	1.30	4.95	5.12	£1.34	EP10-65	10	10.30	10.65	65	9.75	2.50	9.96	10.20	£8.77
EP6-16	6	6.25	6.50	16	5.85	1.50	5.95	6.13	£0.98	EP10-70	10	10.30	10.65	70	9.75	2.50	9.96	10.20	£9.42
EP6-18	6	6.25	6.50	18	5.85	1.50	5.95	6.13	£0.98	EP10-75	10	10.30	10.65	75	9.75	2.50	9.96	10.20	£10.05
EP6-20	6	6.25	6.50	20	5.85	1.50	5.95	6.13	£1.02	EP10-80	10	10.30	10.65	80	9.75	2.50	9.96	10.20	£10.71
EP6-22	6	6.25	6.50	22	5.85	1.50	5.95	6.13	£1.08	EP10-85	10	10.30	10.65	85	9.75	2.50	9.96	10.20	£11.02
EP6-24	6	6.25	6.50	24	5.85	1.50	5.95	6.13	£1.12	EP12-30	12	12.35	12.75	30	11.70	3.00	11.90	12.22	£4.56
EP6-26	6	6.25	6.50	26	5.85	1.50	5.95	6.13	£1.18	EP12-35	12	12.35	12.75	35	11.70	3.00	11.90	12.22	£5.61
EP6-28	6	6.25	6.50	28	5.85	1.50	5.95	6.13	£1.24	EP12-40	12	12.35	12.75	40	11.70	3.00	11.90	12.22	£6.68
EP6-30	6	6.25	6.50	30	5.85	1.50	5.95	6.13	£1.49	EP12-45	12	12.35	12.75	45	11.70	3.00	11.90	12.22	£7.71
EP6-35	6	6.25	6.50	35	5.85	1.50	5.95	6.13	£1.59	EP12-50	12	12.35	12.75	50	11.70	3.00	11.90	12.22	£8.75
EP6-40	6	6.25	6.50	40	5.85	1.50	5.95	6.13	£1.74	EP12-55	12	12.35	12.75	55	11.70	3.00	11.90	12.22	£9.79
EP6-45	6	6.25	6.50	45	5.85	1.50	5.95	6.13	£1.90	EP12-60	12	12.35	12.75	60	11.70	3.00	11.90	12.22	£10.84
EP6-50	6	6.25	6.50	50	5.85	1.50	5.95	6.13	£2.06	EP12-65	12	12.35	12.75	65	11.70	3.00	11.90	12.22	£11.90
EP6-55	6	6.25	6.50	55	5.85	1.50	5.95	6.13	£2.24	EP12-70	12	12.35	12.75	70	11.70	3.00	11.90	12.22	£12.94
EP6-60	6	6.25	6.50	60	5.85	1.50	5.95	6.13	£2.43	EP12-75	12	12.35	12.75	75	11.70	3.00	11.90	12.22	£13.99
EP8-20	8	8.30	8.63	20	7.80	2.00	7.93	8.17	£1.59	EP12-80	12	12.35	12.75	80	11.70	3.00	11.90	12.22	£14.51
EP8-22	8	8.30	8.63	22	7.80	2.00	7.93	8.17	£1.66	EP12-85	12	12.35	12.75	85	11.70	3.00	11.90	12.22	£15.82
EP8-24	8	8.30	8.63	24	7.80	2.00	7.93	8.17	£1.77	EP12-90	12	12.35	12.75	90	11.70	3.00	11.90	12.22	£17.13
EP8-26	8	8.30	8.63	26	7.80	2.00	7.93	8.17	£1.86	EP12-95	12	12.35	12.75	95	11.70	3.00	11.90	12.22	£18.19
EP8-28	8	8.30	8.63	28	7.80	2.00	7.93	8.17	£1.94	EP12-100	12	12.35	12.75	100	11.70	3.00	11.90	12.22	£P.O.A

Material

Nickel Stainless Steel (AISI.302)

Performance

Uniform strength and flexibility. Absorbs shock and vibration. Closer diameter tolerances. Equal stress distribution

Wider hole tolerance. Conforms to hole. Swaged chamfers. Low insertion pressure - radial tension

Standard type: ISO 8750, **Heavy Duty:** ISO 8748 (available depending on size), **Light Duty:** ISO 8751 (available depending on size)

Other Info.

Prices are listed per individual pin.

+44 (0)1246 455500

+44 (0)1246 455522

ondrives

sales@ondrives.com

www.ondrives.com

Product information updated 1st April 2011 and subject to change. Please contact Sales for the latest prices and availability.