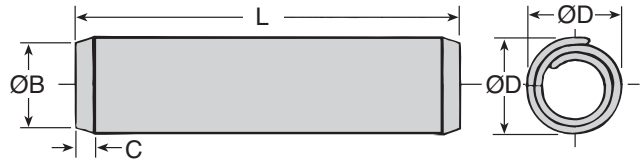
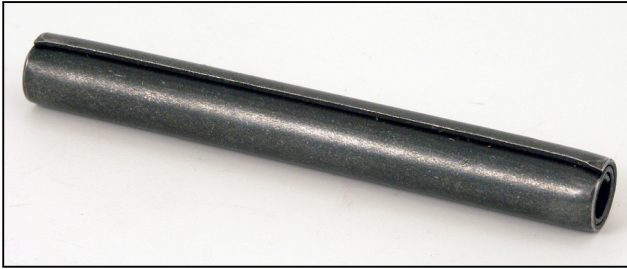

**SEP**

# MECHANICAL

## Carbon Steel Coiled Spring Pins

ISO 8750 : 1.5 - 5mm Dia.

**Discounts:** 31+ -15%   50+ -30%   100+ -50%   200+ -60%   1000+ -65%   2000+ -70%

Part Number	Diameter (ØD)			L	Chamfer		Hole		Price Each 1 - 30	Part Number	Diameter (ØD)			L	Chamfer		Hole		Price Each 1 - 30
	Nom	Min	Max		ØB	C	Min	Max			Nom	Min	Max		ØB	C	Min	Max	
SEP1.5-5	1.5	1.62	1.73	5	1.40	0.50	1.50	1.60	£0.10	SEP3-28	3.0	3.15	3.30	28	2.90	0.90	2.99	3.10	£0.27
SEP1.5-6	1.5	1.62	1.73	6	1.40	0.50	1.50	1.60	£0.10	SEP3-30	3.0	3.15	3.30	30	2.90	0.90	2.99	3.10	£0.27
SEP1.5-8	1.5	1.62	1.73	8	1.40	0.50	1.50	1.60	£0.11	SEP3-35	3.0	3.15	3.30	35	2.90	0.90	2.99	3.10	£0.27
SEP1.5-10	1.5	1.62	1.73	10	1.40	0.50	1.50	1.60	£0.11	SEP3-40	3.0	3.15	3.30	40	2.90	0.90	2.99	3.10	£0.27
SEP1.5-12	1.5	1.62	1.73	12	1.40	0.50	1.50	1.60	£0.11	SEP3.5-12	3.5	3.64	3.79	12	3.40	1.00	3.48	3.62	£0.32
SEP1.5-14	1.5	1.62	1.73	14	1.40	0.50	1.50	1.60	£0.11	SEP3.5-14	3.5	3.64	3.79	14	3.40	1.00	3.48	3.62	£0.34
SEP1.5-16	1.5	1.62	1.73	16	1.40	0.50	1.50	1.60	£0.12	SEP3.5-16	3.5	3.64	3.79	16	3.40	1.00	3.48	3.62	£0.35
SEP2-6	2.0	2.13	2.25	6	1.90	0.70	1.99	2.10	£0.12	SEP3.5-18	3.5	3.64	3.79	18	3.40	1.00	3.48	3.62	£0.37
SEP2-8	2.0	2.13	2.25	8	1.90	0.70	1.99	2.10	£0.12	SEP3.5-20	3.5	3.64	3.79	20	3.40	1.00	3.48	3.62	£0.39
SEP2-10	2.0	2.13	2.25	10	1.90	0.70	1.99	2.10	£0.12	SEP3.5-22	3.5	3.64	3.79	22	3.40	1.00	3.98	3.62	£0.40
SEP2-12	2.0	2.13	2.25	12	1.90	0.70	1.99	2.10	£0.13	SEP3.5-24	3.5	3.64	3.79	24	3.40	1.00	3.48	3.62	£0.44
SEP2-14	2.0	2.13	2.25	14	1.90	0.70	1.99	2.10	£0.13	SEP3.5-26	3.5	3.64	3.79	26	3.40	1.00	3.48	3.62	£0.48
SEP2-16	2.0	2.13	2.25	16	1.90	0.70	1.99	2.10	£0.13	SEP3.5-28	3.5	3.64	3.79	28	3.40	1.00	3.48	3.62	£0.50
SEP2-18	2.0	2.13	2.25	18	1.90	0.70	1.99	2.10	£0.13	SEP3.5-30	3.5	3.64	3.79	30	3.40	1.00	3.48	3.62	£0.50
SEP2-20	2.0	2.13	2.25	20	1.90	0.70	1.99	2.10	£0.14	SEP3.5-35	3.5	3.64	3.79	35	3.40	1.00	3.48	3.62	£0.51
SEP2-26	2.0	2.13	2.25	26	1.90	0.70	1.99	2.10	£0.14	SEP4-10	4.0	4.20	4.40	10	3.90	1.10	3.98	4.12	£0.37
SEP2-35	2.0	2.13	2.25	35	1.90	0.70	1.99	2.10	£0.14	SEP4-12	4.0	4.20	4.40	12	3.90	1.10	3.98	4.12	£0.37
SEP2.5-8	2.5	2.62	2.79	8	2.40	0.70	2.49	2.60	£0.13	SEP4-14	4.0	4.20	4.40	14	3.90	1.10	3.98	4.12	£0.40
SEP2.5-10	2.5	2.62	2.79	10	2.40	0.70	2.49	2.60	£0.14	SEP4-16	4.0	4.20	4.40	16	3.90	1.10	3.98	4.12	£0.43
SEP2.5-12	2.5	2.62	2.79	12	2.40	0.70	2.49	2.60	£0.14	SEP4-18	4.0	4.20	4.40	18	3.90	1.10	3.98	4.12	£0.45
SEP2.5-14	2.5	2.62	2.79	14	2.40	0.70	2.49	2.60	£0.15	SEP4-20	4.0	4.20	4.40	20	3.90	1.10	3.98	4.12	£0.46
SEP2.5-16	2.5	2.62	2.79	16	2.40	0.70	2.49	2.60	£0.15	SEP4-22	4.0	4.20	4.40	22	3.90	1.10	3.98	4.12	£0.50
SEP2.5-18	2.5	2.62	2.79	18	2.40	0.70	2.49	2.60	£0.15	SEP4-24	4.0	4.20	4.40	24	3.90	1.10	3.98	4.12	£0.51
SEP2.5-20	2.5	2.62	2.79	20	2.40	0.70	2.49	2.60	£0.16	SEP4-26	4.0	4.20	4.40	26	3.90	1.10	3.98	4.12	£0.53
SEP2.5-22	2.5	2.62	2.79	22	2.40	0.70	2.49	2.60	£0.16	SEP4-28	4.0	4.20	4.40	28	3.90	1.10	3.98	4.12	£0.56
SEP2.5-24	2.5	2.62	2.79	24	2.40	0.70	2.49	2.60	£0.19	SEP4-30	4.0	4.20	4.40	30	3.90	1.10	3.98	4.12	£0.58
SEP3-10	3.0	3.15	3.30	10	2.90	0.90	2.99	3.10	£0.15	SEP4-35	4.0	4.20	4.40	35	3.90	1.10	3.98	4.12	£0.63
SEP3-12	3.0	3.15	3.30	12	2.90	0.90	2.99	3.10	£0.15	SEP4-40	4.0	4.20	4.40	40	3.90	1.10	3.98	4.12	£0.67
SEP3-14	3.0	3.15	3.30	14	2.90	0.90	2.99	3.10	£0.16	SEP4-45	4.0	4.20	4.40	45	3.90	1.10	3.98	4.12	£0.69
SEP3-16	3.0	3.15	3.30	16	2.90	0.90	2.99	3.10	£0.19	SEP5-14	5.0	5.25	5.50	14	4.85	1.30	4.95	5.12	£0.58
SEP3-18	3.0	3.15	3.30	18	2.90	0.90	2.99	3.10	£0.21	SEP5-16	5.0	5.25	5.50	16	4.85	1.30	4.95	5.12	£0.60
SEP3-20	3.0	3.15	3.30	20	2.90	0.90	2.99	3.10	£0.22	SEP5-18	5.0	5.25	5.50	18	4.85	1.30	4.95	5.12	£0.63
SEP3-22	3.0	3.15	3.30	22	2.90	0.90	2.99	3.10	£0.22	SEP5-20	5.0	5.25	5.50	20	4.85	1.30	4.95	5.12	£0.66
SEP3-24	3.0	3.15	3.30	24	2.90	0.90	2.99	3.10	£0.25	SEP5-22	5.0	5.25	5.50	22	4.85	1.30	4.95	5.12	£0.68
SEP3-26	3.0	3.15	3.30	26	2.90	0.90	2.99	3.10	£0.26										

### Material

Carbon Steel (CS70)

### Performance

Uniform strength and flexibility. Absorbs shock and vibration. Closer diameter tolerances. Equal stress distribution

Wider hole tolerance. Conforms to hole. Swaged chamfers. Low insertion pressure - radial tension

**Standard type:** ISO 8750**Heavy Duty:** ISO 8748 (available depending on size)**Light Duty:** ISO 8751 (available depending on size)

### Other Info.

Prices are listed per individual pin.

+44 (0)1246 455500

+44 (0)1246 455522

**ondrives**

sales@ondrives.com

www.ondrives.com

Product information updated 1st April 2011 and subject to change. Please contact Sales for the latest prices and availability.

# MECHANICAL

## Carbon Steel Coiled Spring Pins

ISO 8750 : 5 - 12mm Dia.

SEP

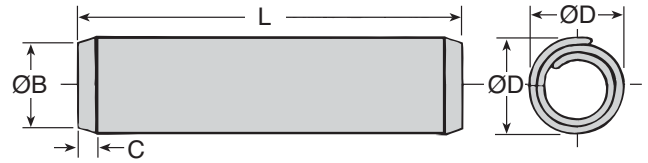
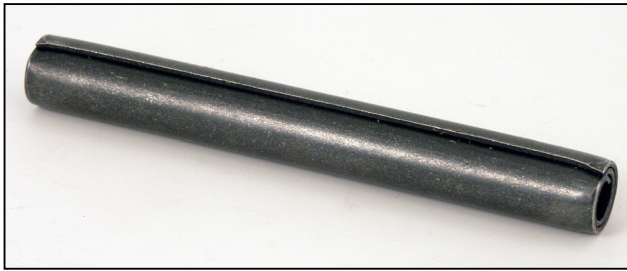

**Discounts:** 31+ -15% 50+ -30% 100+ -50% 200+ -60% 1000+ -65% 2000+ -70%

Part Number	Diameter (ØD)			L	Chamfer		Hole		Price Each 1 - 30	Part Number	Diameter (ØD)			L	Chamfer		Hole		Price Each 1 - 30
	Nom	Min	Max		ØB	C	Min	Max			Nom	Min	Max		ØB	C	Min	Max	
SEP5-24	5	5.25	5.50	24	4.85	1.30	4.95	5.12	£0.70	SEP8-60	8	8.30	8.63	60	7.80	2.00	7.93	8.17	£2.44
SEP5-26	5	5.25	5.50	26	4.85	1.30	4.95	5.12	£0.74	SEP8-65	8	8.30	8.63	65	7.80	2.00	7.93	8.17	£2.65
SEP5-28	5	5.25	5.50	28	4.85	1.30	4.95	5.12	£0.79	SEP8-70	8	8.30	8.63	70	7.80	2.00	7.93	8.17	£2.81
SEP5-30	5	5.25	5.50	30	4.85	1.30	4.95	5.12	£0.81	SEP8-75	8	8.30	8.63	75	7.80	2.00	7.93	8.17	£3.01
SEP5-35	5	5.25	5.50	35	4.85	1.30	4.95	5.12	£0.89	SEP10-24	10	10.30	10.65	24	9.75	2.50	9.93	10.20	£1.61
SEP5-40	5	5.25	5.50	40	4.85	1.30	4.95	5.12	£0.95	SEP10-26	10	10.30	10.65	26	9.75	2.50	9.93	10.20	£1.73
SEP5-45	5	5.25	5.50	45	4.85	1.30	4.95	5.12	£1.05	SEP10-28	10	10.30	10.65	28	9.75	2.50	9.93	10.20	£1.87
SEP5-50	5	5.25	5.50	50	4.85	1.30	4.95	5.12	£1.05	SEP10-30	10	10.30	10.65	30	9.75	2.50	9.93	10.20	£3.37
SEP6-16	6	6.25	6.50	16	5.85	1.50	5.95	6.13	£1.00	SEP10-35	10	10.30	10.65	35	9.75	2.50	9.93	10.20	£2.32
SEP6-18	6	6.25	6.50	18	5.85	1.50	5.95	6.13	£0.82	SEP10-40	10	10.30	10.65	40	9.75	2.50	9.93	10.20	£2.60
SEP6-20	6	6.25	6.50	20	5.85	1.50	5.95	6.13	£0.88	SEP10-45	10	10.30	10.65	45	9.75	2.50	9.93	10.20	£2.88
SEP6-22	6	6.25	6.50	22	5.85	1.50	5.95	6.13	£0.90	SEP10-50	10	10.30	10.65	50	9.75	2.50	9.93	10.20	£3.18
SEP6-24	6	6.25	6.50	24	5.85	1.50	5.95	6.13	£0.98	SEP10-55	10	10.30	10.65	55	9.75	2.50	9.93	10.20	£3.48
SEP6-26	6	6.25	6.50	26	5.85	1.50	5.95	6.13	£1.00	SEP10-60	10	10.30	10.65	60	9.75	2.50	9.93	10.20	£3.80
SEP6-28	6	6.25	6.50	28	5.85	1.50	5.95	6.13	£1.05	SEP10-65	10	10.30	10.65	65	9.75	2.50	9.93	10.20	£4.10
SEP6-30	6	6.25	6.50	30	5.85	1.50	5.95	6.13	£1.09	SEP10-70	10	10.30	10.65	70	9.75	2.50	9.93	10.20	£4.39
SEP6-35	6	6.25	6.50	35	5.85	1.50	5.95	6.13	£1.19	SEP10-75	10	10.30	10.65	75	9.75	2.50	9.93	10.20	£4.72
SEP6-40	6	6.25	6.50	40	5.85	1.50	5.95	6.13	£1.32	SEP10-80	10	10.30	10.65	80	9.75	2.50	9.93	10.20	£5.01
SEP6-45	6	6.25	6.50	45	5.85	1.50	5.95	6.13	£1.40	SEP10-85	10	10.30	10.65	85	9.75	2.50	9.93	10.20	£5.15
SEP6-50	6	6.25	6.50	50	5.85	1.50	5.95	6.13	£1.50	SEP12-30	12	12.35	12.75	30	11.70	3.00	11.90	12.22	£2.12
SEP6-55	6	6.25	6.50	55	5.85	1.50	5.95	6.13	£1.61	SEP12-35	12	12.35	12.75	35	11.70	3.00	11.90	12.22	£2.61
SEP6-60	6	6.25	6.50	60	5.85	1.50	5.95	6.13	£1.51	SEP12-40	12	12.35	12.75	40	11.70	3.00	11.90	12.22	£3.11
SEP8-16	8	8.30	8.63	16	7.80	2.00	7.93	8.17	£0.99	SEP12-45	12	12.35	12.75	45	11.70	3.00	11.90	12.22	£3.60
SEP8-20	8	8.30	8.63	20	7.80	2.00	7.93	8.17	£0.99	SEP12-50	12	12.35	12.75	50	11.70	3.00	11.90	12.22	£4.08
SEP8-22	8	8.30	8.63	22	7.80	2.00	7.93	8.17	£1.06	SEP12-55	12	12.35	12.75	55	11.70	3.00	11.90	12.22	£4.58
SEP8-24	8	8.30	8.63	24	7.80	2.00	7.93	8.17	£1.13	SEP12-60	12	12.35	12.75	60	11.70	3.00	11.90	12.22	£5.07
SEP8-26	8	8.30	8.63	26	7.80	2.00	7.93	8.17	£1.19	SEP12-65	12	12.35	12.75	65	11.70	3.00	11.90	12.22	£5.58
SEP8-28	8	8.30	8.63	28	7.80	2.00	7.93	8.17	£1.26	SEP12-70	12	12.35	12.75	70	11.70	3.00	11.90	12.22	£6.06
SEP8-30	8	8.30	8.63	30	7.80	2.00	7.93	8.17	£1.35	SEP12-75	12	12.35	12.75	75	11.70	3.00	11.90	12.22	£6.57
SEP8-35	8	8.30	8.63	35	7.80	2.00	7.93	8.17	£1.54	SEP12-80	12	12.35	12.75	80	11.70	3.00	11.90	12.22	£6.81
SEP8-40	8	8.30	8.63	40	7.80	2.00	7.93	8.17	£1.70	SEP12-85	12	12.35	12.75	85	11.70	3.00	11.90	12.22	£7.42
SEP8-45	8	8.30	8.63	45	7.80	2.00	7.93	8.17	£1.90	SEP12-90	12	12.35	12.75	90	11.70	3.00	11.90	12.22	£8.06
SEP8-50	8	8.30	8.63	50	7.80	2.00	7.93	8.17	£2.07	SEP12-95	12	12.35	12.75	95	11.70	3.00	11.90	12.22	£8.53
SEP8-55	8	8.30	8.63	55	7.80	2.00	7.93	8.17	£2.26	SEP12-100	12	12.35	12.75	100	11.70	3.00	11.90	12.22	£9.01

### Material

Carbon Steel (CS70)

### Performance

Uniform strength and flexibility. Absorbs shock and vibration. Closer diameter tolerances. Equal stress distribution  
Wider hole tolerance. Conforms to hole. Swaged chamfers. Low insertion pressure - radial tension

**Standard type:** ISO 8750

**Heavy Duty:** ISO 8748 (available depending on size)

**Light Duty:** ISO 8751 (available depending on size)

### Other Info.

Prices are listed per individual pin.

+44 (0)1246 455500

+44 (0)1246 455522

**ondrives**

sales@ondrives.com

www.ondrives.com

Product information updated 1st April 2011 and subject to change. Please contact Sales for the latest prices and availability.

EP

# MECHANICAL

## 302 Nickel Stainless Coiled Spring Pins

ISO 8750 : 0.8 - 4mm Dia.

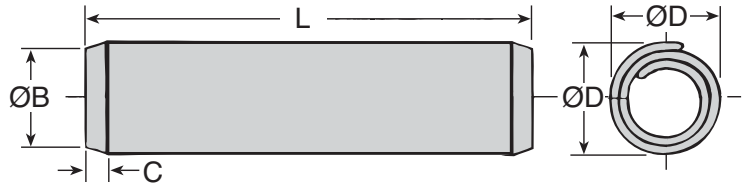
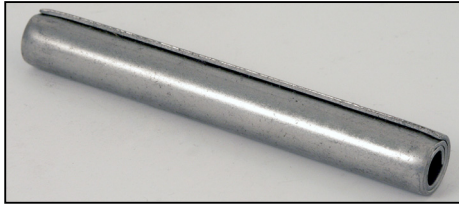

**Discounts:** 31+ -15% | 50+ -30% | 100+ -50% | 200+ -60% | 1000+ -65% | 2000+ -70%

Part Number	Diameter (ØD)			L	Chamfer		Hole		Price Each 1 - 30	Part Number	Diameter (ØD)			L	Chamfer		Hole		Price Each 1 - 30
	Nom	Min	Max		ØB	C	Min	Max			Nom	Min	Max		ØB	C	Min	Max	
EP0.8-4	0.8	0.85	0.91	4	0.75	0.30	0.80	0.84	£2.25	EP2.5-8	2.5	2.62	2.79	8	2.40	0.70	2.49	2.60	£0.19
EP0.8-5	0.8	0.85	0.91	5	0.75	0.30	0.80	0.84	£P.O.A	EP2.5-10	2.5	2.62	2.79	10	2.40	0.70	2.49	2.60	£0.21
EP0.8-6	0.8	0.85	0.91	6	0.75	0.30	0.80	0.84	£0.21	EP2.5-12	2.5	2.62	2.79	12	2.40	0.70	2.49	2.60	£0.21
EP0.8-8	0.8	0.85	0.91	8	0.75	0.30	0.80	0.84	£0.21	EP2.5-14	2.5	2.62	2.79	14	2.40	0.70	2.49	2.60	£0.22
EP0.8-10	0.8	0.85	0.91	10	0.75	0.30	0.80	0.84	£0.21	EP2.5-16	2.5	2.62	2.79	16	2.40	0.70	2.49	2.60	£0.22
EP0.8-12	0.8	0.85	0.91	12	0.75	0.30	0.80	0.84	£0.22	EP2.5-18	2.5	2.62	2.79	18	2.40	0.70	2.49	2.60	£0.25
EP1-4	1.0	1.05	1.15	4	0.95	0.30	1.00	1.04	£0.16	EP2.5-20	2.5	2.62	2.79	20	2.40	0.70	2.49	2.60	£0.25
EP1-5	1.0	1.05	1.15	5	0.95	0.30	1.00	1.04	£0.19	EP2.5-22	2.5	2.62	2.79	22	2.40	0.70	2.49	2.60	£0.26
EP1-6	1.0	1.05	1.15	6	0.95	0.30	1.00	1.04	£0.21	EP2.5-24	2.5	2.62	2.79	24	2.40	0.70	2.49	2.60	£0.26
EP1-8	1.0	1.05	1.15	8	0.95	0.30	1.00	1.04	£0.21	EP3-10	3.0	3.15	3.30	10	2.90	0.90	2.99	3.10	£0.22
EP1-10	1.0	1.05	1.15	10	0.95	0.30	1.00	1.04	£0.21	EP3-12	3.0	3.15	3.30	12	2.90	0.90	2.99	3.10	£0.25
EP1-12	1.0	1.05	1.15	12	0.95	0.30	1.00	1.04	£0.21	EP3-14	3.0	3.15	3.30	14	2.90	0.90	2.99	3.10	£0.26
EP1-14	1.0	1.05	1.15	14	0.95	0.30	1.00	1.04	£0.21	EP3-16	3.0	3.15	3.30	16	2.90	0.90	2.99	3.10	£0.27
EP1-16	1.0	1.05	1.15	16	0.95	0.30	1.00	1.04	£0.26	EP3-18	3.0	3.15	3.30	18	2.90	0.90	2.99	3.10	£0.28
EP1.2-4	1.2	1.25	1.35	4	1.15	0.40	1.20	1.24	£0.19	EP3-20	3.0	3.15	3.30	20	2.90	0.90	2.99	3.10	£0.29
EP1.2-6	1.2	1.25	1.35	6	1.15	0.40	1.20	1.24	£P.O.A	EP3-22	3.0	3.15	3.30	22	2.90	0.90	2.99	3.10	£0.30
EP1.2-8	1.2	1.25	1.35	8	1.15	0.40	1.20	1.24	£0.21	EP3-24	3.0	3.15	3.30	24	2.90	0.90	2.99	3.10	£0.31
EP1.2-10	1.2	1.25	1.35	10	1.15	0.40	1.20	1.24	£0.21	EP3-26	3.0	3.15	3.30	26	2.90	0.90	2.99	3.10	£0.32
EP1.2-12	1.2	1.25	1.35	12	1.15	0.40	1.20	1.24	£0.21	EP3-28	3.0	3.15	3.30	28	2.90	0.90	2.99	3.10	£0.33
EP1.5-5	1.5	1.62	1.73	5	1.40	0.50	1.50	1.60	£0.13	EP3-30	3.0	3.15	3.30	30	2.90	0.90	2.99	3.10	£0.34
EP1.5-6	1.5	1.62	1.73	6	1.40	0.50	1.50	1.60	£0.14	EP3-35	3.0	3.15	3.30	35	2.90	0.90	2.99	3.10	£0.34
EP1.5-8	1.5	1.62	1.73	8	1.40	0.50	1.50	1.60	£0.14	EP3-40	3.0	3.15	3.30	40	2.90	0.90	2.99	3.10	£0.34
EP1.5-10	1.5	1.62	1.73	10	1.40	0.50	1.50	1.60	£0.14	EP3.5-12	3.5	3.64	3.79	12	3.40	1.00	3.48	3.62	£0.44
EP1.5-12	1.5	1.62	1.73	12	1.40	0.50	1.50	1.60	£0.15	EP3.5-16	3.5	3.64	3.79	16	3.40	1.00	3.48	3.62	£0.48
EP1.5-14	1.5	1.62	1.73	14	1.40	0.50	1.50	1.60	£0.15	EP3.5-18	3.5	3.64	3.79	18	3.40	1.00	3.48	3.62	£0.51
EP1.5-16	1.5	1.62	1.73	16	1.40	0.50	1.50	1.60	£0.15	EP3.5-20	3.5	3.64	3.79	20	3.40	1.00	3.48	3.62	£0.51
EP1.5-20	1.5	1.62	1.73	20	1.40	0.50	1.50	1.60	£0.16	EP3.5-22	3.5	3.64	3.79	22	3.40	1.00	3.48	3.62	£0.53
EP1.5-24	1.5	1.62	1.73	24	1.40	0.50	1.50	1.60	£0.19	EP3.5-24	3.5	3.64	3.79	24	3.40	1.00	3.48	3.62	£0.58
EP2-6	2.0	2.13	2.25	6	1.90	0.70	1.99	2.10	£0.15	EP3.5-28	3.5	3.64	3.79	28	3.40	1.00	3.48	3.62	£0.63
EP2-8	2.0	2.13	2.25	8	1.90	0.70	1.99	2.10	£0.15	EP3.5-30	3.5	3.64	3.79	30	3.40	1.00	3.48	3.62	£0.64
EP2-10	2.0	2.13	2.25	10	1.90	0.70	1.99	2.10	£0.15	EP3.5-35	3.5	3.64	3.79	35	3.40	1.00	3.48	3.62	£P.O.A
EP2-12	2.0	2.13	2.25	12	1.90	0.70	1.99	2.10	£0.16	EP4-12	4.0	4.20	4.40	12	3.90	1.10	3.98	4.12	£0.51
EP2-14	2.0	2.13	2.25	14	1.90	0.70	1.99	2.10	£0.16	EP4-14	4.0	4.20	4.40	14	3.90	1.10	3.98	4.12	£0.53
EP2-16	2.0	2.13	2.25	16	1.90	0.70	1.99	2.10	£0.19	EP4-16	4.0	4.20	4.40	16	3.90	1.10	3.98	4.12	£0.56
EP2-18	2.0	2.13	2.25	18	1.90	0.70	1.99	2.10	£0.19	EP4-18	4.0	4.20	4.40	18	3.90	1.10	3.98	4.12	£0.59
EP2-20	2.0	2.13	2.25	20	1.90	0.70	1.99	2.10	£0.21	EP4-20	4.0	4.20	4.40	20	3.90	1.10	3.98	4.12	£0.61
EP2-30	2.0	2.13	2.25	30	1.90	0.70	1.99	2.10	£0.32	EP4-22	4.0	4.20	4.40	22	3.90	1.10	3.98	4.12	£0.64
										EP4-24	4.0	4.20	4.40	24	3.90	1.10	3.98	4.12	£0.66

### Material

Nickel Stainless Steel (AISI.302)

### Performance

Uniform strength and flexibility. Absorbs shock and vibration. Closer diameter tolerances. Equal stress distribution

Wider hole tolerance. Conforms to hole. Swaged chamfers. Low insertion pressure - radial tension

**Standard type:** ISO 8750, **Heavy Duty:** ISO 8748 (available depending on size), **Light Duty:** ISO 8751 (available depending on size)

### Other Info.

Prices are listed per individual pin.

+44 (0)1246 455500

+44 (0)1246 455522

**ondrives**

sales@ondrives.com

www.ondrives.com

Product information updated 1st April 2011 and subject to change. Please contact Sales for the latest prices and availability.

# MECHANICAL

EP

## 302 Nickel Stainless Coiled Spring Pins

ISO 8750 : 4 - 12mm Dia.

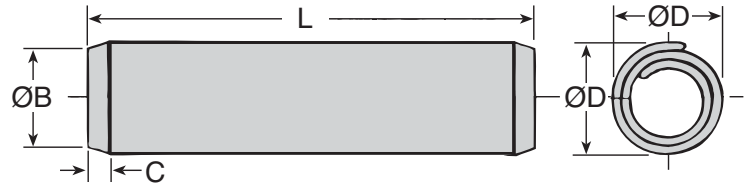
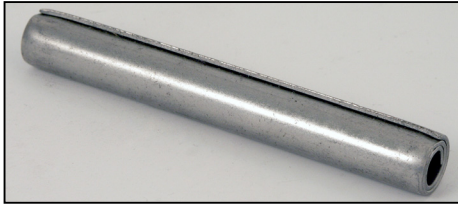

**Discounts:** 31+ -15% 50+ -30% 100+ -50% 200+ -60% 1000+ -65% 2000+ -70%

Part Number	Diameter (ØD)			L	Chamfer		Hole		Price Each 1 - 30	Part Number	Diameter (ØD)			L	Chamfer		Hole		Price Each 1 - 30
	Nom	Min	Max		ØB	C	Min	Max			Nom	Min	Max		ØB	C	Min	Max	
EP4-26	4	4.20	4.40	26	3.90	1.10	3.98	4.12	£0.68	EP8-30	8	8.30	8.63	30	7.80	2.00	7.93	8.17	£2.08
EP4-28	4	4.20	4.40	28	3.90	1.10	3.98	4.12	£0.70	EP8-35	8	8.30	8.63	35	7.80	2.00	7.93	8.17	£2.25
EP4-30	4	4.20	4.40	30	3.90	1.10	3.98	4.12	£0.74	EP8-40	8	8.30	8.63	40	7.80	2.00	7.93	8.17	£2.47
EP4-35	4	4.20	4.40	35	3.90	1.10	3.98	4.12	£0.80	EP8-45	8	8.30	8.63	45	7.80	2.00	7.93	8.17	£2.73
EP4-40	4	4.20	4.40	40	3.90	1.10	3.98	4.12	£0.87	EP8-50	8	8.30	8.63	50	7.80	2.00	7.93	8.17	£3.01
EP4-45	4	4.20	4.40	45	3.90	1.10	3.98	4.12	£0.90	EP8-60	8	8.30	8.63	60	7.80	2.00	7.93	8.17	£3.65
EP4-50	4	4.20	4.40	50	3.90	1.10	3.98	4.12	£0.90	EP8-65	8	8.30	8.63	65	7.80	2.00	7.93	8.17	£4.03
EP5-14	5	5.25	5.50	14	4.85	1.30	4.95	5.12	£0.72	EP8-70	8	8.30	8.63	70	7.80	2.00	7.93	8.17	£4.15
EP5-16	5	5.25	5.50	16	4.85	1.30	4.95	5.12	£0.78	EP8-75	8	8.30	8.63	75	7.80	2.00	7.93	8.17	£4.57
EP5-18	5	5.25	5.50	18	4.85	1.30	4.95	5.12	£0.81	EP10-24	10	10.30	10.65	24	9.75	2.50	9.96	10.20	£3.49
EP5-20	5	5.25	5.50	20	4.85	1.30	4.95	5.12	£0.85	EP10-26	10	10.30	10.65	26	9.75	2.50	9.96	10.20	£3.78
EP5-22	5	5.25	5.50	22	4.85	1.30	4.95	5.12	£0.89	EP10-28	10	10.30	10.65	28	9.75	2.50	9.96	10.20	£4.03
EP5-24	5	5.25	5.50	24	4.85	1.30	4.95	5.12	£0.93	EP10-30	10	10.30	10.65	30	9.75	2.50	9.96	10.20	£4.28
EP5-26	5	5.25	5.50	26	4.85	1.30	4.95	5.12	£0.95	EP10-35	10	10.30	10.65	35	9.75	2.50	9.96	10.20	£4.94
EP5-28	5	5.25	5.50	28	4.85	1.30	4.95	5.12	£1.00	EP10-40	10	10.30	10.65	40	9.75	2.50	9.96	10.20	£5.57
EP5-30	5	5.25	5.50	30	4.85	1.30	4.95	5.12	£1.05	EP10-45	10	10.30	10.65	45	9.75	2.50	9.96	10.20	£6.20
EP5-35	5	5.25	5.50	35	4.85	1.30	4.95	5.12	£1.14	EP10-50	10	10.30	10.65	50	9.75	2.50	9.96	10.20	£6.80
EP5-40	5	5.25	5.50	40	4.85	1.30	4.95	5.12	£1.23	EP10-55	10	10.30	10.65	55	9.75	2.50	9.96	10.20	£7.49
EP5-45	5	5.25	5.50	45	4.85	1.30	4.95	5.12	£1.34	EP10-60	10	10.30	10.65	60	9.75	2.50	9.96	10.20	£8.13
EP5-50	5	5.25	5.50	50	4.85	1.30	4.95	5.12	£1.34	EP10-65	10	10.30	10.65	65	9.75	2.50	9.96	10.20	£8.77
EP6-16	6	6.25	6.50	16	5.85	1.50	5.95	6.13	£0.98	EP10-70	10	10.30	10.65	70	9.75	2.50	9.96	10.20	£9.42
EP6-18	6	6.25	6.50	18	5.85	1.50	5.95	6.13	£0.98	EP10-75	10	10.30	10.65	75	9.75	2.50	9.96	10.20	£10.05
EP6-20	6	6.25	6.50	20	5.85	1.50	5.95	6.13	£1.02	EP10-80	10	10.30	10.65	80	9.75	2.50	9.96	10.20	£10.71
EP6-22	6	6.25	6.50	22	5.85	1.50	5.95	6.13	£1.08	EP10-85	10	10.30	10.65	85	9.75	2.50	9.96	10.20	£11.02
EP6-24	6	6.25	6.50	24	5.85	1.50	5.95	6.13	£1.12	EP12-30	12	12.35	12.75	30	11.70	3.00	11.90	12.22	£4.56
EP6-26	6	6.25	6.50	26	5.85	1.50	5.95	6.13	£1.18	EP12-35	12	12.35	12.75	35	11.70	3.00	11.90	12.22	£5.61
EP6-28	6	6.25	6.50	28	5.85	1.50	5.95	6.13	£1.24	EP12-40	12	12.35	12.75	40	11.70	3.00	11.90	12.22	£6.68
EP6-30	6	6.25	6.50	30	5.85	1.50	5.95	6.13	£1.49	EP12-45	12	12.35	12.75	45	11.70	3.00	11.90	12.22	£7.71
EP6-35	6	6.25	6.50	35	5.85	1.50	5.95	6.13	£1.59	EP12-50	12	12.35	12.75	50	11.70	3.00	11.90	12.22	£8.75
EP6-40	6	6.25	6.50	40	5.85	1.50	5.95	6.13	£1.74	EP12-55	12	12.35	12.75	55	11.70	3.00	11.90	12.22	£9.79
EP6-45	6	6.25	6.50	45	5.85	1.50	5.95	6.13	£1.90	EP12-60	12	12.35	12.75	60	11.70	3.00	11.90	12.22	£10.84
EP6-50	6	6.25	6.50	50	5.85	1.50	5.95	6.13	£2.06	EP12-65	12	12.35	12.75	65	11.70	3.00	11.90	12.22	£11.90
EP6-55	6	6.25	6.50	55	5.85	1.50	5.95	6.13	£2.24	EP12-70	12	12.35	12.75	70	11.70	3.00	11.90	12.22	£12.94
EP6-60	6	6.25	6.50	60	5.85	1.50	5.95	6.13	£2.43	EP12-75	12	12.35	12.75	75	11.70	3.00	11.90	12.22	£13.99
EP8-20	8	8.30	8.63	20	7.80	2.00	7.93	8.17	£1.59	EP12-80	12	12.35	12.75	80	11.70	3.00	11.90	12.22	£14.51
EP8-22	8	8.30	8.63	22	7.80	2.00	7.93	8.17	£1.66	EP12-85	12	12.35	12.75	85	11.70	3.00	11.90	12.22	£15.82
EP8-24	8	8.30	8.63	24	7.80	2.00	7.93	8.17	£1.77	EP12-90	12	12.35	12.75	90	11.70	3.00	11.90	12.22	£17.13
EP8-26	8	8.30	8.63	26	7.80	2.00	7.93	8.17	£1.86	EP12-95	12	12.35	12.75	95	11.70	3.00	11.90	12.22	£18.19
EP8-28	8	8.30	8.63	28	7.80	2.00	7.93	8.17	£1.94	EP12-100	12	12.35	12.75	100	11.70	3.00	11.90	12.22	£P.O.A

### Material

Nickel Stainless Steel (AISI.302)

### Performance

Uniform strength and flexibility. Absorbs shock and vibration. Closer diameter tolerances. Equal stress distribution

Wider hole tolerance. Conforms to hole. Swaged chamfers. Low insertion pressure - radial tension

**Standard type:** ISO 8750, **Heavy Duty:** ISO 8748 (available depending on size), **Light Duty:** ISO 8751 (available depending on size)

### Other Info.

Prices are listed per individual pin.

+44 (0)1246 455500

+44 (0)1246 455522

**ondrives**

sales@ondrives.com

www.ondrives.com

Product information updated 1st April 2011 and subject to change. Please contact Sales for the latest prices and availability.