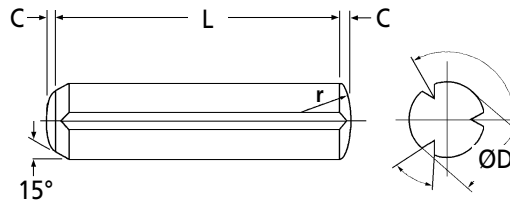
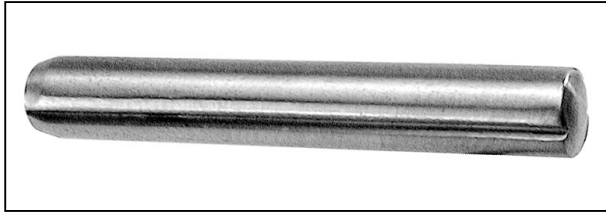

GRP

MECHANICAL

Mild Steel Full Length Grooved Pins

DIN 1473 (Type GP3) : 1 - 4mm Dia.

Discounts: 6+ -10% 20+ -25% 40+ -30% 60+ -35% 100+ -40% 200+ -45% 500+ -50%

Part Number	ØD	C	L	Price Each 1 - 5	Part Number	ØD	C	L	Price Each 1 - 5
GRP1-4	1.0	0.14	4	£P.O.A	GRP2.5-6	2.5	0.30	6	£0.13
GRP1-5	1.0	0.14	5	£P.O.A	GRP2.5-8	2.5	0.30	8	£0.13
GRP1-6	1.0	0.14	6	£P.O.A	GRP2.5-10	2.5	0.30	10	£0.13
GRP1-8	1.0	0.14	8	£P.O.A	GRP2.5-12	2.5	0.30	12	£0.13
GRP1-10	1.0	0.14	10	£P.O.A	GRP2.5-14	2.5	0.30	14	£0.13
GRP1.2-4	1.2	0.16	4	£P.O.A	GRP2.5-16	2.5	0.30	16	£0.13
GRP1.2-5	1.2	0.16	5	£P.O.A	GRP2.5-18	2.5	0.30	18	£0.13
GRP1.2-6	1.2	0.16	6	£P.O.A	GRP2.5-20	2.5	0.30	20	£0.15
GRP1.2-8	1.2	0.16	8	£P.O.A	GRP2.5-22	2.5	0.30	22	£0.15
GRP1.2-10	1.2	0.16	10	£P.O.A	GRP2.5-24	2.5	0.30	24	£0.15
GRP1.5-4	1.5	0.20	4	£0.10	GRP2.5-26	2.5	0.30	26	£0.15
GRP1.5-5	1.5	0.20	5	£0.10	GRP2.5-28	2.5	0.30	28	£0.15
GRP1.5-6	1.5	0.20	6	£0.10	GRP2.5-30	2.5	0.30	30	£0.15
GRP1.5-8	1.5	0.20	8	£0.10	GRP3-6	3.0	0.40	6	£0.13
GRP1.5-10	1.5	0.20	10	£0.10	GRP3-8	3.0	0.40	8	£0.13
GRP1.5-12	1.5	0.20	12	£0.10	GRP3-10	3.0	0.40	10	£0.13
GRP1.5-14	1.5	0.20	14	£0.10	GRP3-12	3.0	0.40	12	£0.13
GRP1.5-16	1.5	0.20	16	£0.10	GRP3-14	3.0	0.40	14	£0.15
GRP1.5-18	1.5	0.20	18	£0.10	GRP3-16	3.0	0.40	16	£0.15
GRP1.5-20	1.5	0.20	20	£0.10	GRP3-18	3.0	0.40	18	£0.15
GRP2-4	2.0	0.25	4	£0.10	GRP3-20	3.0	0.40	20	£0.15
GRP2-5	2.0	0.25	5	£0.10	GRP3-22	3.0	0.40	22	£0.15
GRP2-6	2.0	0.25	6	£0.10	GRP3-24	3.0	0.40	24	£0.15
GRP2-8	2.0	0.25	8	£0.10	GRP3-26	3.0	0.40	26	£0.15
GRP2-10	2.0	0.25	10	£0.10	GRP3-28	3.0	0.40	28	£0.15
GRP2-12	2.0	0.25	12	£0.13	GRP3-30	3.0	0.40	30	£0.15
GRP2-14	2.0	0.25	14	£0.13	GRP4-6	4.0	0.50	6	£0.15
GRP2-16	2.0	0.25	16	£0.13	GRP4-8	4.0	0.50	8	£0.15
GRP2-18	2.0	0.25	18	£0.13	GRP4-10	4.0	0.50	10	£0.15
GRP2-20	2.0	0.25	20	£0.13	GRP4-12	4.0	0.50	12	£0.15
GRP2-22	2.0	0.25	22	£0.13	GRP4-14	4.0	0.50	14	£0.15
GRP2-24	2.0	0.25	24	£0.15	GRP4-16	4.0	0.50	16	£0.15
GRP2-26	2.0	0.25	26	£0.15	GRP4-18	4.0	0.50	18	£0.15
GRP2-28	2.0	0.25	28	£0.15	GRP4-20	4.0	0.50	20	£0.18
GRP2-30	2.0	0.25	30	£0.15	GRP4-22	4.0	0.50	22	£0.18

Material

Mild Steel
DIN 1473 (GP3) in dias. 1 to 16mm

Other options available (1.5-8mm)

GP1 DIN 1471

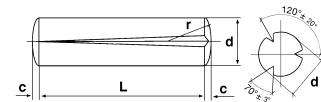

GP2 DIN 1472

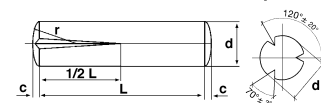

GP4 DIN 1474

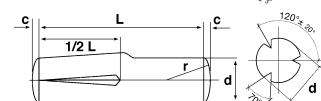

Other Info.

Grooved pins offer an economic method of fastening without the need for precision drilled and reamed holes. Recommended hole tolerance is H11. The domes at each end are not included in the nominal length, i.e. the total length is longer than the nominal length.

 +44 (0)1246 455500
 +44 (0)1246 455522

 sales@ondrives.com
 www.ondrives.com

Product information updated 1st April 2011 and subject to change. Please contact Sales for the latest prices and availability.

MECHANICAL

GRP

Mild Steel Full Length Grooved Pins

DIN 1473 (Type GP3) : 4 - 8mm Dia.

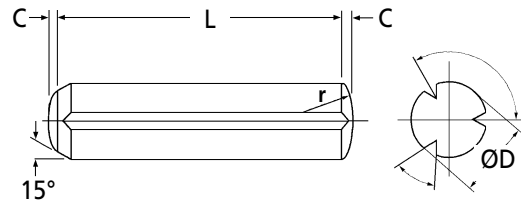
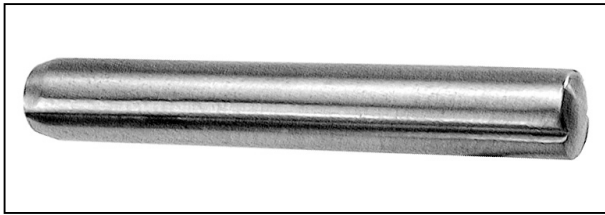

Discounts: 6+ -10% 20+ -25% 40+ -30% 60+ -35% 100+ -40% 200+ -45% 500+ -50%

Part Number	ØD	C	L	Price Each 1 - 5	Part Number	ØD	C	L	Price Each 1 - 5
GRP4-24	4	0.50	24	£0.18	GRP6-26	6	0.80	26	£0.32
GRP4-26	4	0.50	26	£0.18	GRP6-28	6	0.80	28	£0.32
GRP4-28	4	0.50	28	£0.18	GRP6-30	6	0.80	30	£0.32
GRP4-30	4	0.50	30	£0.18	GRP6-32	6	0.80	32	£0.32
GRP4-32	4	0.50	32	£0.24	GRP6-36	6	0.80	36	£0.35
GRP4-40	4	0.50	40	£0.22	GRP6-40	6	0.80	40	£0.38
GRP4-45	4	0.50	45	£0.24	GRP6-45	6	0.80	45	£0.40
GRP4-50	4	0.50	50	£0.24	GRP6-50	6	0.80	50	£0.44
GRP5-8	5	0.60	8	£0.22	GRP6-55	6	0.80	55	£0.49
GRP5-10	5	0.60	10	£0.22	GRP6-60	6	0.80	60	£0.52
GRP5-12	5	0.60	12	£0.22	GRP8-10	8	1.00	10	£0.44
GRP5-14	5	0.60	14	£0.22	GRP8-12	8	1.00	12	£0.49
GRP5-16	5	0.60	16	£0.22	GRP8-14	8	1.00	14	£0.49
GRP5-18	5	0.60	18	£0.22	GRP8-16	8	1.00	16	£0.49
GRP5-20	5	0.60	20	£0.22	GRP8-18	8	1.00	18	£0.49
GRP5-22	5	0.60	22	£0.22	GRP8-20	8	1.00	20	£0.49
GRP5-24	5	0.60	24	£0.22	GRP8-22	8	1.00	22	£0.52
GRP5-26	5	0.60	26	£0.24	GRP8-24	8	1.00	24	£0.52
GRP5-28	5	0.60	28	£0.24	GRP8-26	8	1.00	26	£0.52
GRP5-30	5	0.60	30	£0.24	GRP8-28	8	1.00	28	£0.52
GRP5-32	5	0.60	32	£0.24	GRP8-30	8	1.00	30	£0.52
GRP5-36	5	0.60	36	£0.27	GRP8-32	8	1.00	32	£0.55
GRP5-40	5	0.60	40	£0.27	GRP8-36	8	1.00	36	£0.63
GRP5-45	5	0.60	45	£0.30	GRP8-40	8	1.00	40	£0.69
GRP5-50	5	0.60	50	£0.32	GRP8-45	8	1.00	45	£0.74
GRP6-8	6	0.80	8	£0.30	GRP8-50	8	1.00	50	£0.79
GRP6-10	6	0.80	10	£0.30	GRP8-55	8	1.00	55	£0.82
GRP6-12	6	0.80	12	£0.30	GRP8-60	8	1.00	60	£0.86
GRP6-14	6	0.80	14	£0.30	GRP8-65	8	1.00	65	£0.94
GRP6-16	6	0.80	16	£0.30	GRP8-70	8	1.00	70	£1.08
GRP6-18	6	0.80	18	£0.30					
GRP6-20	6	0.80	20	£0.30					
GRP6-22	6	0.80	22	£0.30					
GRP6-24	6	0.80	24	£0.32					

Material

Mild Steel
DIN 1473 (GP3) in dias. 1 to 16mm

Other options available (1.5-8mm)

Other Info.

Grooved pins offer an economic method of fastening without the need for precision drilled and reamed holes. Recommended hole tolerance is H11. The domes at each end are not included in the nominal length, i.e. the total length is longer than the nominal length.

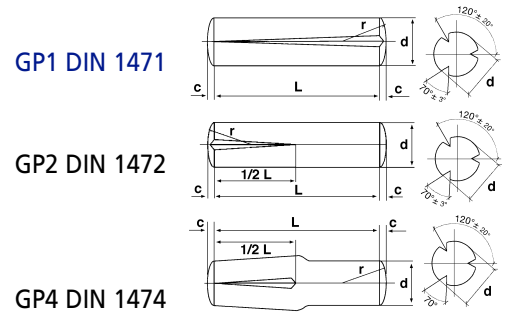

+44 (0)1246 455500
+44 (0)1246 455522

ondrives

sales@ondrives.com
www.ondrives.com

Product information updated 1st April 2011 and subject to change. Please contact Sales for the latest prices and availability.