

**DP**

# MECHANICAL

## A2 Stainless Steel Dowel Pins

ISO 2338A : 1997, 0.8 - 5mm Dia.

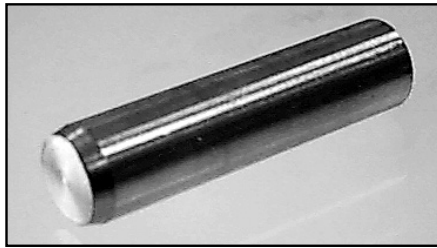

Chamfered End

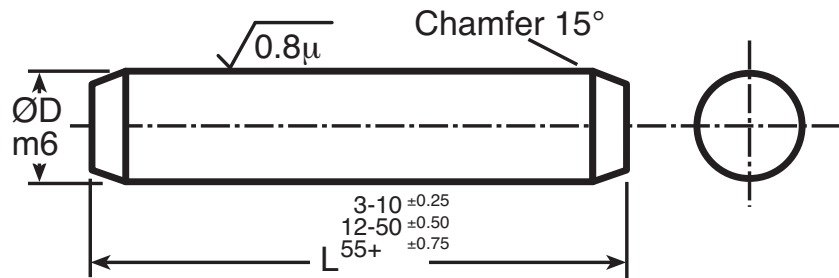

**Discounts:** 6+ -12%   20+ -25%   40+ -33%   60+ -37%   100+ -42%   200+ -48%   500+ -55%   1000+ -65%

Part Number	ØD m6	Length L	Double Shear Strength (kN)	Price Each 1 - 5	Part Number	ØD m6	Length L	Double Shear Strength (kN)	Price Each 1 - 5
DP0.8-4	0.8	4	0.4	£P.O.A	DP3.0-4	3	4	6.6	£0.19
DP0.8-5	0.8	5	0.4	£0.08	DP3.0-5	3	5	6.6	£0.21
DP0.8-6	0.8	6	0.4	£P.O.A	DP3.0-6	3	6	6.6	£0.21
DP0.8-8	0.8	8	0.4	£0.09	DP3.0-8	3	8	6.6	£0.88
DP0.8-10	0.8	10	0.4	£0.68	DP3.0-10	3	10	6.6	£0.25
DP0.8-12	0.8	12	0.4	£0.10	DP3.0-12	3	12	6.6	£0.27
DP1.0-4	1.0	4	0.7	£0.08	DP3.0-14	3	14	6.6	£0.28
DP1.0-5	1.0	5	0.7	£0.08	DP3.0-16	3	16	6.6	£0.29
DP1.0-6	1.0	6	0.7	£0.09	DP3.0-18	3	18	6.6	£0.30
DP1.0-8	1.0	8	0.7	£0.09	DP3.0-20	3	20	6.6	£0.32
DP1.0-10	1.0	10	0.7	£0.10	DP3.0-24	3	24	6.6	£0.37
DP1.0-12	1.0	12	0.7	£0.10	DP3.0-28	3	28	6.6	£0.46
DP1.5-4	1.5	4	1.7	£0.09	DP3.0-30	3	30	6.6	£0.51
DP1.5-5	1.5	5	1.7	£0.09	DP4.0-5	4	5	11.7	£0.27
DP1.5-6	1.5	6	1.7	£0.10	DP4.0-6	4	6	11.7	£0.28
DP1.5-8	1.5	8	1.7	£0.10	DP4.0-8	4	8	11.7	£0.30
DP1.5-10	1.5	10	1.7	£0.11	DP4.0-10	4	10	11.7	£0.32
DP1.5-12	1.5	12	1.7	£0.12	DP4.0-12	4	12	11.7	£0.35
DP1.5-14	1.5	14	1.7	£0.12	DP4.0-14	4	14	11.7	£0.43
DP1.5-16	1.5	16	1.7	£0.13	DP4.0-16	4	16	11.7	£0.45
DP2.0-4	2.0	4	2.9	£0.10	DP4.0-18	4	18	11.7	£0.48
DP2.0-5	2.0	5	2.9	£0.31	DP4.0-20	4	20	11.7	£0.55
DP2.0-6	2.0	6	2.9	£0.10	DP4.0-24	4	24	11.7	£0.59
DP2.0-8	2.0	8	2.9	£0.12	DP4.0-28	4	28	11.7	£0.63
DP2.0-10	2.0	10	2.9	£0.13	DP4.0-30	4	30	11.7	£0.68
DP2.0-12	2.0	12	2.9	£0.13	DP4.0-32	4	32	11.7	£0.72
DP2.0-14	2.0	14	2.9	£0.14	DP4.0-36	4	36	11.7	£0.89
DP2.0-16	2.0	16	2.9	£0.15	DP4.0-40	4	40	11.7	£0.95
DP2.0-18	2.0	18	2.9	£0.16	DP4.0-45	4	45	11.7	£1.17
DP2.0-20	2.0	20	2.9	£0.19	DP4.0-50	4	50	11.7	£1.42
DP2.0-24	2.0	24	2.9	£0.25	DP5.0-6	5	6	18.1	£0.44
DP2.5-4	2.5	4	4.4	£0.12	DP5.0-8	5	8	18.1	£1.23
DP2.5-5	2.5	5	4.4	£0.12	DP5.0-10	5	10	18.1	£0.45
DP2.5-6	2.5	6	4.4	£0.13	DP5.0-12	5	12	18.1	£0.51
DP2.5-8	2.5	8	4.4	£0.13	DP5.0-14	5	14	18.1	£0.53
DP2.5-10	2.5	10	4.4	£0.14	DP5.0-16	5	16	18.1	£0.56
DP2.5-12	2.5	12	4.4	£0.15	DP5.0-18	5	18	18.1	£0.59
DP2.5-14	2.5	14	4.4	£0.21	DP5.0-20	5	20	18.1	£0.63
DP2.5-16	2.5	16	4.4	£0.22	DP5.0-24	5	24	18.1	£0.68
DP2.5-18	2.5	18	4.4	£0.27	DP5.0-28	5	28	18.1	£0.76
DP2.5-20	2.5	20	4.4	£0.28	DP5.0-30	5	30	18.1	£0.87
DP2.5-24	2.5	24	4.4	£0.33	DP5.0-32	5	32	18.1	£0.93

+44 (0)1246 455500  
+44 (0)1246 455522

**ondrives**

sales@ondrives.com  
www.ondrives.com

Product information updated 1st April 2011 and subject to change. Please contact Sales for the latest prices and availability.

# MECHANICAL

DP

## A2 Stainless Steel Dowel Pins

ISO 2338A : 1997, 5 - 12mm Dia.

**Discounts:** 6+ -12%   20+ -25%   40+ -33%   60+ -37%   100+ -42%   200+ -48%   500+ -55%   1000+ -65%

Part Number	ØD m6	Length L	Double Shear Strength (kN)	Price Each 1 - 5	Part Number	ØD m6	Length L	Double Shear Strength (kN)	Price Each 1 - 5
DP5.0-36	5	36	18.1	£1.05	DP8.0-70	8	70	47.0	£3.87
DP5.0-40	5	40	18.1	£1.20	DP8.0-80	8	80	47.0	£4.83
DP5.0-45	5	45	18.1	£1.47	DP10.0-10	10	10	64.1	£1.93
DP5.0-50	5	50	18.1	£1.64	DP10.0-12	10	12	64.1	£2.01
DP5.0-55	5	55	18.1	£1.82	DP10.0-14	10	14	64.1	£2.11
DP5.0-60	5	60	18.1	£2.23	DP10.0-16	10	16	64.1	£2.24
DP6.0-6	6	6	26.0	£0.84	DP10.0-18	10	18	64.1	£2.33
DP6.0-8	6	8	26.0	£0.89	DP10.0-20	10	20	64.1	£2.42
DP6.0-10	6	10	26.0	£0.93	DP10.0-24	10	24	64.1	£2.65
DP6.0-12	6	12	26.0	£0.98	DP10.0-28	10	28	64.1	£3.01
DP6.0-14	6	14	26.0	£1.02	DP10.0-30	10	30	64.1	£3.22
DP6.0-16	6	16	26.0	£1.06	DP10.0-32	10	32	64.1	£3.31
DP6.0-18	6	18	26.0	£1.09	DP10.0-36	10	36	64.1	£3.59
DP6.0-20	6	20	26.0	£1.13	DP10.0-40	10	40	64.1	£3.83
DP6.0-24	6	24	26.0	£1.22	DP10.0-45	10	45	64.1	£4.16
DP6.0-28	6	28	26.0	£1.30	DP10.0-50	10	50	64.1	£4.33
DP6.0-30	6	30	26.0	£1.37	DP10.0-55	10	55	64.1	£4.50
DP6.0-32	6	32	26.0	£1.39	DP10.0-60	10	60	64.1	£4.67
DP6.0-36	6	36	26.0	£1.47	DP10.0-70	10	70	64.1	£5.79
DP6.0-40	6	40	26.0	£1.59	DP10.0-80	10	80	64.1	£6.61
DP6.0-45	6	45	26.0	£1.74	DP10.0-90	10	90	64.1	£7.95
DP6.0-50	6	50	26.0	£1.87	DP10.0-100	10	100	64.1	£8.73
DP6.0-55	6	55	26.0	£2.04	DP12.0-14	12	14	92.0	£3.10
DP6.0-60	6	60	26.0	£2.23	DP12.0-16	12	16	92.0	£3.30
DP8.0-8	8	8	47.0	£1.11	DP12.0-18	12	18	92.0	£3.55
DP8.0-10	8	10	47.0	£1.13	DP12.0-20	12	20	92.0	£3.83
DP8.0-12	8	12	47.0	£1.18	DP12.0-24	12	24	92.0	£3.97
DP8.0-14	8	14	47.0	£1.24	DP12.0-28	12	28	92.0	£4.32
DP8.0-16	8	16	47.0	£1.43	DP12.0-30	12	30	92.0	£4.48
DP8.0-18	8	18	47.0	£1.52	DP12.0-32	12	32	92.0	£5.07
DP8.0-20	8	20	47.0	£1.60	DP12.0-36	12	36	92.0	£5.51
DP8.0-24	8	24	47.0	£1.73	DP12.0-40	12	40	92.0	£6.55
DP8.0-28	8	28	47.0	£1.80	DP12.0-45	12	45	92.0	£7.29
DP8.0-30	8	30	47.0	£2.01	DP12.0-50	12	50	92.0	£8.30
DP8.0-32	8	32	47.0	£2.04	DP12.0-55	12	55	92.0	£9.04
DP8.0-36	8	36	47.0	£2.18	DP12.0-60	12	60	92.0	£9.47
DP8.0-40	8	40	47.0	£2.37	DP12.0-70	12	70	92.0	£10.17
DP8.0-45	8	45	47.0	£2.53	DP12.0-80	12	80	92.0	£11.97
DP8.0-50	8	50	47.0	£2.87	DP12.0-90	12	90	92.0	£12.96
DP8.0-55	8	55	47.0	£3.24	DP12.0-100	12	100	92.0	£16.23
DP8.0-60	8	60	47.0	£3.49					

### Material

Stainless Steel Grade 1.4305 (similar to 303 / A2). The Dowels are made to ISO 2338A : 1997.

\*Please note that some dowels will still be made to ISO 2338-1992 (to the manufacturer's preference).

### Other Info.

The following gives general guidance on hole tolerances but there are graduations within each category:

Hole Material	Interference Fit	Transition Fit	Clearance Fit
Hardened Steel	PinØ less 05 µm	PinØ less 2 µm	PinØ plus 25-60 µm
Mild Steel	PinØ less 25 µm	PinØ less 5 µm	PinØ plus 25-60 µm
Aluminium/Zinc/Brass	PinØ less 35 µm	PinØ less 5 µm	PinØ plus 25-60 µm

When a dowel is interference-fitted into a blind hole it increases the pressure of the air trapped into the hole. It is strongly advised to specify that the dowel should have an air release flat ground along its full length to prevent the dowel being ejected under the pressure of compressed air, or bursting the component into which it is driven.

Specials available in Grade 1.4571 and h8 tolerance. Please ask for a quote. The length of the new ISO Standard design is the exact length.

The length of the old DIN 7 Standard design (still available on request) is measured between the domes.

+44 (0)1246 455500

+44 (0)1246 455522

**ondrives**

sales@ondrives.com

www.ondrives.com

Product information updated 1st April 2011 and subject to change. Please contact Sales for the latest prices and availability.