

LINEAR MOTION

2RB

SuperSlide™ - Continuously Supported System

BallScrew Driven (Backlash Free)

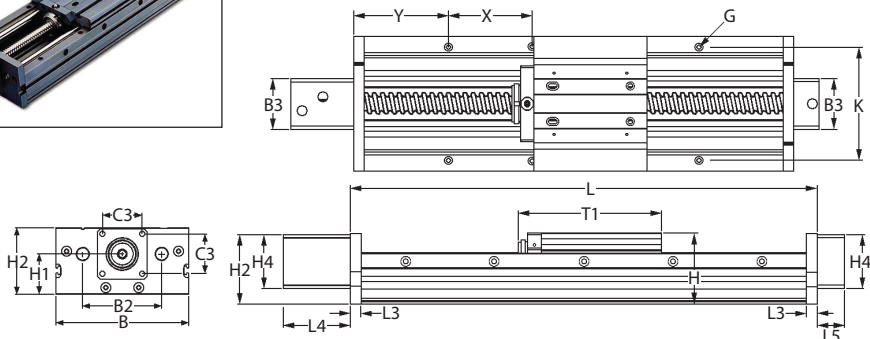
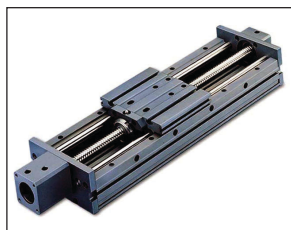

Used in continuously supported applications when stiffness and rigidity is required.

Maximum Stroke Length is determined by subtracting the carriage length (T1) and 2x end block length (L3) from the total system length.

Part Numbers 12 Series (Medium Duty)		Standard Lengths	Max. Stroke Lengths	Price Each 1 - 4	
5mm Pitch	10mm Pitch			5mm Pitch	10mm Pitch
2RB-12G-300	2RB-12H-300	300	151	£1,887.12	£1,887.12
2RB-12G-375	2RB-12H-375	375	226	£1,962.69	£1,962.69
2RB-12G-450	2RB-12H-450	450	301	£2,038.24	£2,038.24
2RB-12G-525	2RB-12H-525	525	376	£2,113.83	£2,113.83
2RB-12G-600	2RB-12H-600	600	451	£2,189.41	£2,189.41
2RB-12G-675	2RB-12H-675	675	526	£2,264.97	£2,264.97
2RB-12G-750	2RB-12H-750	750	601	£2,340.55	£2,340.55
2RB-12G-825	2RB-12H-825	825	676	£2,416.15	£2,416.15
2RB-12G-900	2RB-12H-900	900	751	£2,491.71	£2,491.71
2RB-12G-975	2RB-12H-975	975	826	£2,567.29	£2,567.29
2RB-12G-1050	2RB-12H-1050	1050	901	£2,642.88	£2,642.88
2RB-12G-1125	2RB-12H-1125	1125	976	£2,718.47	£2,718.47
2RB-12G-1200	2RB-12H-1200	1200	1051	£2,794.04	£2,794.04
2RB-12G-1275	2RB-12H-1275	1275	1126	£2,869.63	£2,869.63
2RB-12G-1350	2RB-12H-1350	1350	1201	£2,945.21	£2,945.21
2RB-12G-1425	2RB-12H-1425	1425	1276	£3,020.76	£3,020.76
2RB-12G-1500	2RB-12H-1500	1500	1351	£0.00	£0.00

12 Series (Medium Duty)

Increments of 75mm are available for longer lengths. Maximum length is 2100mm.

16 Series (Heavy Duty)

Increments of 100mm are available for longer lengths. Maximum length is 3000mm. Special lengths for both series, to your specification, exceeding the maximum length are available. However, stroke length will alter according to the length specified (see formula above to calculate maximum stroke length).

Discounts: 5+ -10%

Part Numbers 16 Series (Heavy Duty)			Standard Lengths	Max. Stroke Lengths	Price Each 1 - 4		
5mm Pitch	10mm Pitch	20mm Pitch			5mm Pitch	10mm Pitch	20mm Pitch
2RB-16I-300	2RB-16J-300	2RB-16K-300	300	115	£2,100.08	£2,100.08	£2,100.08
2RB-16I-400	2RB-16J-400	2RB-16K-400	400	215	£2,212.34	£2,212.34	£2,212.34
2RB-16I-500	2RB-16J-500	2RB-16K-500	500	315	£2,324.53	£2,324.53	£2,324.53
2RB-16I-600	2RB-16J-600	2RB-16K-600	600	415	£2,436.75	£2,436.75	£2,436.75
2RB-16I-700	2RB-16J-700	2RB-16K-700	700	515	£2,548.98	£2,548.98	£2,548.98
2RB-16I-800	2RB-16J-800	2RB-16K-800	800	615	£2,661.21	£2,661.21	£2,661.21
2RB-16I-900	2RB-16J-900	2RB-16K-900	900	715	£2,773.44	£2,773.44	£2,773.44
2RB-16I-1000	2RB-16J-1000	2RB-16K-1000	1000	815	£2,885.66	£2,885.66	£2,885.66
2RB-16I-1100	2RB-16J-1100	2RB-16K-1100	1100	915	£2,997.88	£2,997.88	£2,997.88
2RB-16I-1200	2RB-16J-1200	2RB-16K-1200	1200	1015	£3,110.11	£3,110.11	£3,110.11
2RB-16I-1300	2RB-16J-1300	2RB-16K-1300	1300	1115	£3,222.28	£3,222.28	£3,222.28
2RB-16I-1400	2RB-16J-1400	2RB-16K-1400	1400	1215	£3,334.52	£3,334.52	£3,334.52
2RB-16I-1500	2RB-16J-1500	2RB-16K-1500	1500	1315	£0.00	£0.00	£0.00

Material

Body: Anodised Aluminium.

Shaft/BallScrew: Screwed Hard Steel (pre-loaded nut backlash-free).

Performance

Repeatability: as low as 0.01mm ±0.005

Positioning Accuracy: 0.025mm/300mm (0.012 available at extra cost)



+44 (0)1246 455500



+44 (0)1246 455522

ondrives



sales@ondrives.com



www.ondrives.com

LINEAR MOTION

SuperSlide™ - Continuously Supported System

Ballscrew Driven (Backlash Free)

2RB

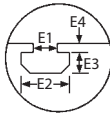

T4 T-Slots

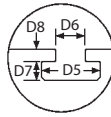

T7 T-Slots

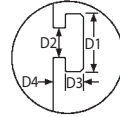

T8 T-Slots

Carriage X-Section

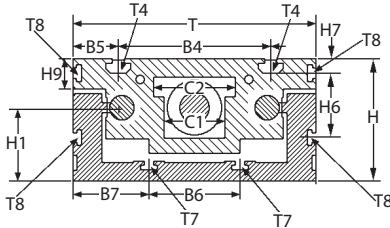

Motor Mounting (NEMA23)

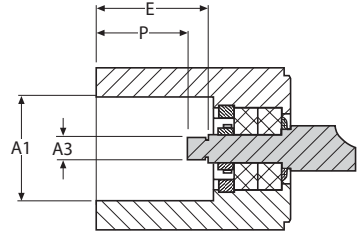

SuperSlide™ 2RB System with Integral Ball Screw Assembly and T-Slot Carriage

Technical Criteria			2RB-12G-XXX	2RB-12H-XXX	2RB-16I-XXX	2RB-16J-XXX	2RB-16K-XXX
Nominal Dia.			12	12	16	16	16
Ball Screw (Dia. x Lead)			16 x 5P	16 x 10P	20 x 5P	20 x 10P	20 x 20P
B	B4	E1	130	75	160	100	8.1
B2	B5	E2	75	27.5	13	30	16.5
B3	B6	E3	60	65	4	80	6.8
C3	B7	E4	47.15	32.5	3	40	3
G	D1	H	M4	8	65	M5	10.5
H1	D2	H1	40	4.2	40	48	6
H2	D3	H6	75	2.75	35	79	3.5
H4	D4	H7	60	2	7	60	2.5
K	D5	H9	110	8	14	135	10.5
L3	D6	T	9.5	4.2	130	12.5	6
L4	D7	E	70	2.75	42	75	3.5
L5	D8	P	26.5	2	34	31.5	2.5
T1	A3	A1	130	Ø8	Ø38.2	160	Ø10
Base Mounting Holes X				75		100	
Base Mounting Holes Y				75		100	
Max. Stroke Length				L-149		L-185	
Carriage Weight (N)				8.8		16.7	
Carriage Friction Coefficient				0.002		0.002	
Number of Seals				8		8	
Seal Drag (N)				0.5		0.7	

XXX = Standard Length (L) - See page opposite

Features

- Double acting wipers
- Speeds up to 1m/s
- 1 double LinearRace™ Rail Assembly with T-slots for mounting ease
- 1 T-slot integrated carriage with 4 open SuperSmart Ball Bushing™ bearings
- 1 integral ball screw assembly (pre-loaded nut)
- Standard motor mounting (NEMA 23, coupling needed)
- Long travel life capability

Options

- Protective bellows (2 per slide needed, shortens stroke)
- Lubrication system
- Couplings (MJT-30C-RD bored to suit)



+44 (0)1246 455500



+44 (0)1246 455522

ondrives



sales@ondrives.com



www.ondrives.com

Product information updated 1st April 2011 and subject to change. Please contact Sales for the latest prices and availability.

LINEAR MOTION

SuperSlide™ - Continuously Supported System

TECHNICAL

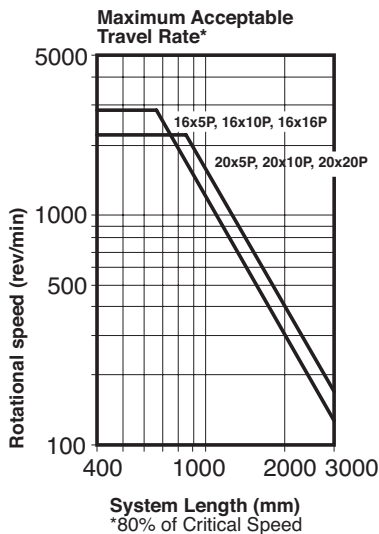

Compressive Load on the ball screw is a key factor in selecting the proper system. Using maximum load and acceleration requirements, plot compressive load on the left side of the chart. Using system length and compressive load plot the maximum allowable compressive force on the right chart. Select the system with a rated maximum compressive force above your plotted point.

The SuperSlide has a pre-designed maximum acceptable travel rate. Calculate maximum rotational speed (rpm) by dividing your required maximum linear speed (m/s) by the corresponding system ball screw lead (m/rev). Enter the chart with the required system length and your maximum rotational speed. Select the system with a maximum acceptable travel rate curve above the plotted line.

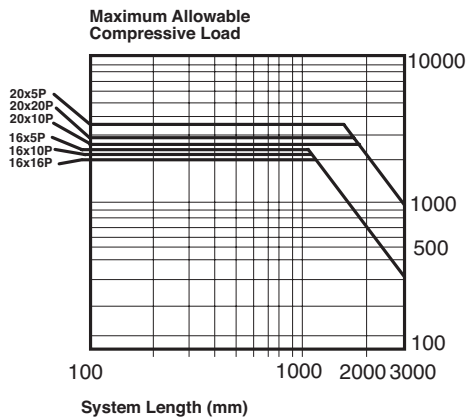
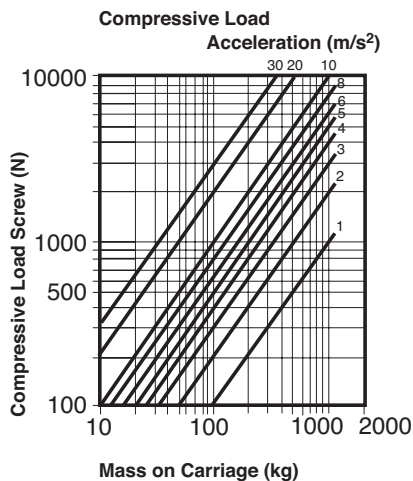

If you have any questions concerning your system requirements, contact our sales department.

Note: Ball screw should never exceed recommended critical speed.



+44 (0)1246 455500

+44 (0)1246 455522

ondrives



sales@ondrives.com

www.ondrives.com

Product information updated 1st April 2011 and subject to change. Please contact Sales for the latest prices and availability.

LINEAR MOTION

SuperSlide™ - Continuously Supported System

Nuts and Bellows Accessories

**TNUT
BEL**

T-Nuts for Mounting

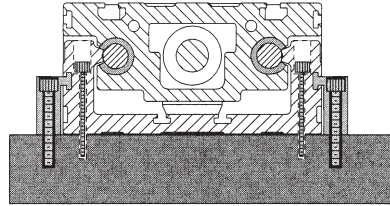
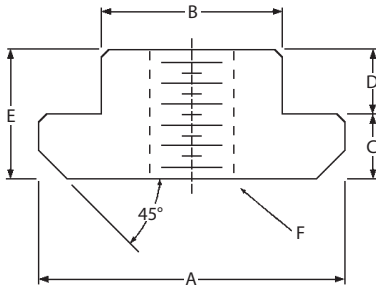

Discounts: 5+ -10%

Part Number	A	B	C	D	E	F	Price Each 1 - 4
TNUT-01-M3	7.0	4.0	1.75	1.25	3.0	M3	£12.38
TNUT-02-M4	9.5	5.5	2.25	1.75	4.0	M4	£12.38
TNUT-03-M5	12.0	7.0	2.50	2.50	5.0	M5	£12.38
TNUT-04-M4	16.5	7.9	4.80	1.20	6.0	M4	£11.14
TNUT-04-M5	16.5	7.9	4.80	1.20	6.0	M5	£11.14
TNUT-04-M6	16.5	7.9	4.80	1.20	6.0	M6	£11.14
TNUT-05-M4	19.5	9.8	5.80	2.80	8.6	M4	£11.14
TNUT-05-M5	19.5	9.8	5.80	2.80	8.6	M5	£11.14
TNUT-05-M6	19.5	9.8	5.80	2.80	8.6	M6	£11.14
TNUT-05-M8	19.5	9.8	5.80	2.80	8.6	M8	£11.14

Protective Bellows

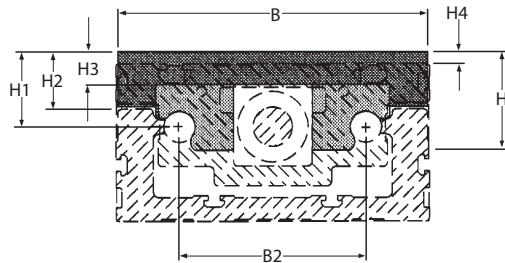
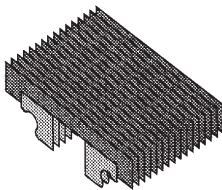

Protective Bellows

Way Covers (Note: these must be ordered when ordering the system as extra machining is required on the slide unit).

Discounts: 5+ -10%

Part Number	Nominal Shaft Dia.	B	B2	H	H1	H2	H3	H4	Price Each 1 - 4
BEL-2R-12	12	128	75	48	37	29	15	12	£0.00
BEL-2R-16	16	158	95	52	42	30	15	10	£0.00

The SuperSlide™ 2RB Ball Screw Drive System can be mounted using the T-Nuts and T-slots with clamping fixtures as shown above. In addition, SuperSlide™ Ball Screw Systems 2RB can be mounted using the bolt down attachment holes found in each system support base. For other mounting fixity, please contact Sales. These parts are POA on their own as they are normally included in the price of the SuperSlide assembly.



+44 (0)1246 455500



+44 (0)1246 455522

ondrives



sales@ondrives.com



www.ondrives.com

Product information updated 1st April 2011 and subject to change. Please contact Sales for the latest prices and availability.