

PSG-DL
PSG-PK
3.0m_n

PRECISION GEARS

3.0 Module Plastic Spur Gear α 20° PA

Quality Grade 8e25 DIN 3961/3967 (AGMA Q9)

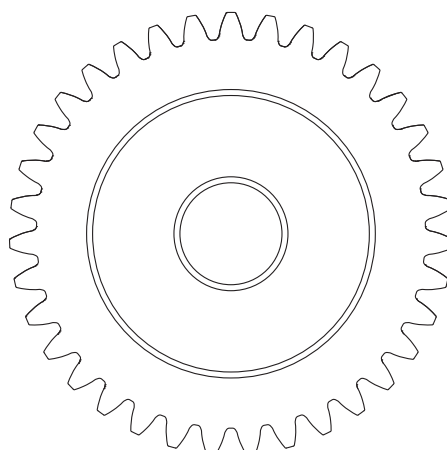
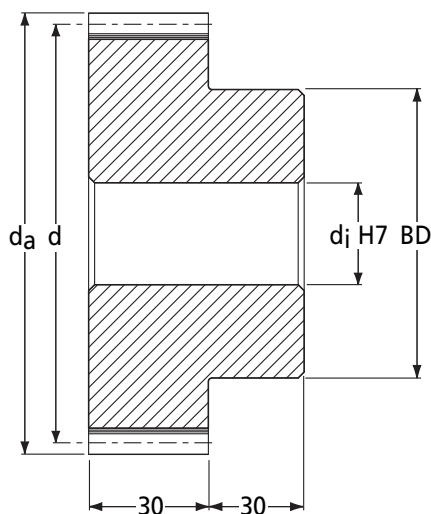
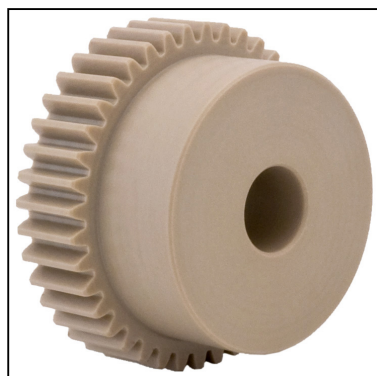

DIN 3967 Tooth Thickness tol.

Part Number	No. of Teeth <i>z</i>	Ref. Dia. <i>d</i>	Tip Dia. <i>d_a</i>	Bore H7 <i>d_j</i>	Max. Bore H7 <i>d_j</i>	Hub Dia. <i>BD</i>	Backlash (mm)		I Inertia <i>kgm² (Delrin)</i>	Mass <i>kg (Delrin)</i>
							<i>j_{t,e} (max)</i>	<i>j_{t,i} (min)</i>		
PSG3.0-18DL	18	54	60	14	25	45	0.171	-0.069	5.33 x 10 ⁻⁵	0.150
PSG3.0-19DL	19	57	63	14	25	45	0.171	-0.069	6.19 x 10 ⁻⁵	0.161
PSG3.0-20DL	20	60	66	14	25	45	0.171	-0.069	7.19 x 10 ⁻⁵	0.172
PSG3.0-21DL	21	63	69	16	30	55	0.171	-0.069	1.04 x 10 ⁻⁴	0.214
PSG3.0-22DL	22	66	72	16	30	55	0.171	-0.069	1.18 x 10 ⁻⁴	0.226
PSG3.0-23DL	23	69	75	16	30	55	0.171	-0.069	1.33 x 10 ⁻⁴	0.240
PSG3.0-24DL	24	72	78	16	30	55	0.171	-0.069	1.50 x 10 ⁻⁴	0.254
PSG3.0-25DL	25	75	81	16	30	55	0.171	-0.069	1.70 x 10 ⁻⁴	0.268
PSG3.0-26DL	26	78	84	16	30	55	0.171	-0.069	1.92 x 10 ⁻⁴	0.283
PSG3.0-27DL	27	81	87	16	30	55	0.173	-0.067	2.17 x 10 ⁻⁴	0.299
PSG3.0-28DL	28	84	90	16	30	55	0.173	-0.067	2.45 x 10 ⁻⁴	0.315
PSG3.0-29DL	29	87	93	18	40	70	0.173	-0.067	3.37 x 10 ⁻⁴	0.390
PSG3.0-30DL	30	90	96	18	40	70	0.173	-0.067	3.71 x 10 ⁻⁴	0.407
PSG3.0-32DL	32	96	102	18	40	70	0.173	-0.067	4.51 x 10 ⁻⁴	0.444
PSG3.0-35DL	35	105	111	18	40	70	0.173	-0.067	6.02 x 10 ⁻⁴	0.504
PSG3.0-38DL	38	114	120	18	40	70	0.173	-0.067	7.97 x 10 ⁻⁴	0.569
PSG3.0-40DL	40	120	126	18	40	70	0.173	-0.067	9.55 x 10 ⁻⁴	0.615
PSG3.0-42DL	42	126	132	18	40	80	0.227	-0.097	1.21 x 10 ⁻³	0.714
PSG3.0-45DL	45	135	141	18	40	80	0.227	-0.097	1.54 x 10 ⁻³	0.791
PSG3.0-48DL	48	144	150	18	40	80	0.227	-0.097	1.94 x 10 ⁻³	0.874

PRECISION GEARS

PSG-DL
PSG-PK
3.0m_n

3.0 Module Plastic Spur Gear α 20° PA

Quality Grade 8e25 DIN 3961/3967 (AGMA Q9)

Standard Part **PSG** **3.0** **40** **DL**

Modified Part **PSG** **3.0** **40** **PK** **25** **K** **T**

PSG - Precision Spur Gear
Quality Grade 8e25 DIN 3961/3967
Other Quality Grades available.
See page 291

m_n Module - Cut with DIN 867 1.25/0.20/1.0
Ref. Tooth Profile Topping WD = 2.25 x m_n

Number of Teeth z

DL = Delrin POM (White)
PK = PEEK GF30® (Light Brown)

T = 1 x Tapped hole 2T = 2 x Tapped holes.
P = 1 x Pin Hole PT = 1 x Pin Hole thru.
All threads metric as standard,
refer to page 308 for sizes and prices.

K- Keyway supplied to
DIN 6885 - Js9 tolerance.
For prices see page 308

To specify different bore enter size required
Example: 25 = 25mm H7 etc
For prices see page 308

η Efficiency approx. 98%

Discounts: 6+ -5% 19+ -10%

Part Number	Delrin POM		Part Number	PEEK GF30®	
	T ₂ Nm n ₂ 100min ⁻¹	Price Each 1 - 5		T ₂ Nm n ₂ 100min ⁻¹	Price Each 1 - 5
PSG3.0-18DL	6.63	£21.80	PSG3.0-18PK	7.50	£110.43
PSG3.0-19DL	7.46	£22.62	PSG3.0-19PK	8.45	£114.57
PSG3.0-20DL	8.35	£23.37	PSG3.0-20PK	9.45	£118.36
PSG3.0-21DL	9.30	£24.13	PSG3.0-21PK	10.53	£122.24
PSG3.0-22DL	10.31	£24.96	PSG3.0-22PK	11.67	£126.42
PSG3.0-23DL	11.38	£25.76	PSG3.0-23PK	12.88	£130.43
PSG3.0-24DL	12.51	£26.50	PSG3.0-24PK	14.15	£134.18
PSG3.0-25DL	13.70	£28.10	PSG3.0-25PK	15.50	£142.30
PSG3.0-26DL	14.96	£29.71	PSG3.0-26PK	16.92	£150.45
PSG3.0-27DL	16.28	£30.42	PSG3.0-27PK	18.42	£154.06
PSG3.0-28DL	17.66	£31.27	PSG3.0-28PK	19.99	£158.34
PSG3.0-29DL	19.12	£32.56	PSG3.0-29PK	21.63	£164.84
PSG3.0-30DL	20.63	£33.73	PSG3.0-30PK	23.35	£170.79
PSG3.0-32DL	23.88	£36.18	PSG3.0-32PK	27.01	£183.18
PSG3.0-35DL	29.26	£41.91	PSG3.0-35PK	33.11	£212.21
PSG3.0-38DL	35.30	£44.98	PSG3.0-38PK	39.93	£227.76
PSG3.0-40DL	39.69	£46.25	PSG3.0-40PK	44.90	£234.17
PSG3.0-42DL	44.38	£47.72	PSG3.0-42PK	50.21	£241.63
PSG3.0-45DL	52.00	£49.15	PSG3.0-45PK	58.84	£248.88
PSG3.0-48DL	60.33	£50.62	PSG3.0-48PK	68.26	£256.35