

**PSG**  
**3.0m<sub>n</sub>**

# PRECISION GEARS

## 3.0 Module Spur Gear α 20° PA Quality Grade 7e25 DIN 3961/3967 (AGMA Q10)

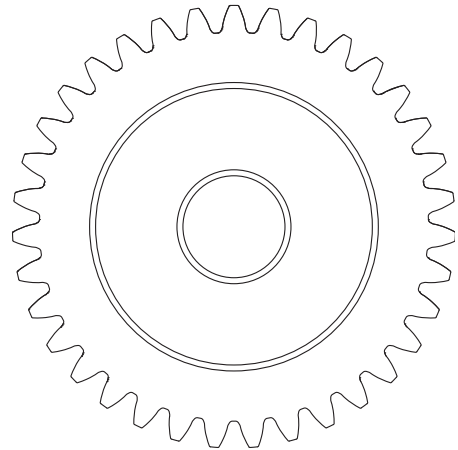
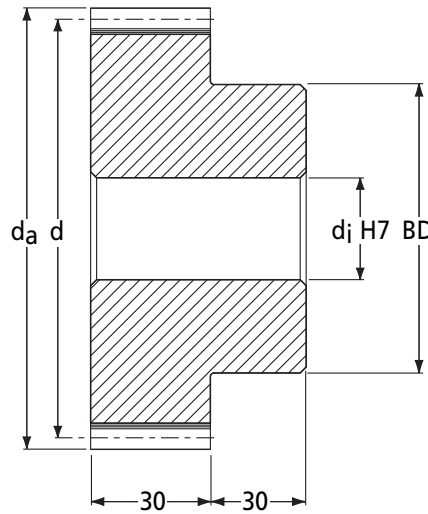

DIN 3967 Tooth Thickness tol.

Part Number	No. of Teeth <i>z</i>	Ref. Dia. <i>d</i>	Tip Dia. <i>d<sub>a</sub></i>	Bore H7 <i>d<sub>j</sub></i>	Max. Bore H7 <i>d<sub>j</sub></i>	Hub Dia. <i>BD</i>	Backlash (mm)		I Inertia <i>kgm<sup>2</sup></i>	Mass <i>kg</i>
							<i>j<sub>t,e</sub></i> (max)	<i>j<sub>t,i</sub></i> (min)		
PSG3.0-18	18	54	60	14	25	45	0.171	-0.069	2.97 x 10 <sup>-4</sup>	0.835
PSG3.0-19	19	57	63	14	25	45	0.171	-0.069	3.45 x 10 <sup>-4</sup>	0.896
PSG3.0-20	20	60	66	14	25	45	0.171	-0.069	4.00 x 10 <sup>-4</sup>	0.960
PSG3.0-21	21	63	69	16	30	55	0.171	-0.069	5.80 x 10 <sup>-4</sup>	1.190
PSG3.0-22	22	66	72	16	30	55	0.171	-0.069	6.55 x 10 <sup>-4</sup>	1.261
PSG3.0-23	23	69	75	16	30	55	0.171	-0.069	7.40 x 10 <sup>-4</sup>	1.335
PSG3.0-24	24	72	78	16	30	55	0.171	-0.069	8.37 x 10 <sup>-4</sup>	1.412
PSG3.0-25	25	75	81	16	30	55	0.171	-0.069	9.46 x 10 <sup>-4</sup>	1.493
PSG3.0-26	26	78	84	16	30	55	0.171	-0.069	1.07 x 10 <sup>-3</sup>	1.577
PSG3.0-27	27	81	87	16	30	55	0.173	-0.067	1.21 x 10 <sup>-3</sup>	1.664
PSG3.0-28	28	84	90	16	30	55	0.173	-0.067	1.36 x 10 <sup>-3</sup>	1.755
PSG3.0-29	29	87	93	18	40	70	0.173	-0.067	1.88 x 10 <sup>-3</sup>	2.171
PSG3.0-30	30	90	96	18	40	70	0.173	-0.067	2.07 x 10 <sup>-3</sup>	2.268
PSG3.0-32	32	96	102	18	40	70	0.173	-0.067	2.51 x 10 <sup>-3</sup>	2.473
PSG3.0-35	35	105	111	18	40	70	0.173	-0.067	3.35 x 10 <sup>-3</sup>	2.805
PSG3.0-38	38	114	120	18	40	70	0.173	-0.067	4.43 x 10 <sup>-3</sup>	3.167
PSG3.0-40	40	120	126	18	40	70	0.173	-0.067	5.32 x 10 <sup>-3</sup>	3.425
PSG3.0-42	42	126	132	18	40	80	0.227	-0.097	6.73 x 10 <sup>-3</sup>	3.974
PSG3.0-45	45	135	141	18	40	80	0.227	-0.097	8.57 x 10 <sup>-3</sup>	4.406
PSG3.0-48	48	144	150	18	40	80	0.227	-0.097	1.08 x 10 <sup>-2</sup>	4.868

# PRECISION GEARS

**PSG**  
**3.0m<sub>n</sub>**

## 3.0 Module Spur Gear α 20° PA

Quality Grade 7e25 DIN 3961/3967 (AGMA Q10)

Standard Part **PSG** **3.0** **40**      
Modified Part **PSG** **3.0** **40** **H** **30** **K** **T**

PSG - Precision Spur Gear  
Quality Grade 7e25 DIN 3961/3967  
Other Quality Grades available.  
See page 291

m<sub>n</sub> Module - Cut with DIN 867 1.25/0.20/1.0  
Ref. Tooth Profile Topping WD = 2.25 x m<sub>n</sub>

Number of Teeth z

Standard Material = 817M40T (28HRC)  
H = 805M20 Case Hardened (58HRC)  
S = 303 Stainless Steel  
SL = 316 Stainless Steel

T = 1 x Tapped hole 2T = 2 x Tapped holes.  
P = 1 x Pin Hole PT = 1 x Pin Hole thru.  
All threads metric as standard,  
refer to page 308 for sizes and prices.

K- Keyway supplied to  
DIN 6885 - Js9 tolerance.  
For prices see page 308

To specify different bore enter size required  
Example: 30 = 30mm H7 etc  
For prices see page 308

# Quality Grades and Tolerances stated prior to heat treatment processes.  
η Efficiency approx. 98%

**Discounts: 6+ -5% 19+ -10%**

817M40T (28HRC)			Case Hardened 805M20 (58HRC)#			Stainless 303			Stainless 316		
Part Number	T <sub>2</sub> Nm n <sub>2</sub> 100min <sup>-1</sup>	Price Each 1 - 5	Part Number	T <sub>2</sub> Nm n <sub>2</sub> 100min <sup>-1</sup>	Price Each 1 - 5	Part Number	T <sub>2</sub> Nm n <sub>2</sub> 100min <sup>-1</sup>	Price Each 1 - 5	Part Number	T <sub>2</sub> Nm n <sub>2</sub> 100min <sup>-1</sup>	Price Each 1 - 5
PSG3.0-18	38.23	£30.72	PSG3.0-18H	140.16	£50.70	PSG3.0-18S	22.94	£41.47	PSG3.0-18SL	17.84	£47.62
PSG3.0-19	40.35	£31.55	PSG3.0-19H	147.95	£52.05	PSG3.0-19S	24.21	£42.58	PSG3.0-19SL	18.83	£48.90
PSG3.0-20	53.71	£32.70	PSG3.0-20H	196.92	£53.95	PSG3.0-20S	32.22	£44.16	PSG3.0-20SL	25.06	£50.69
PSG3.0-21	56.39	£33.49	PSG3.0-21H	206.77	£55.26	PSG3.0-21S	33.83	£45.21	PSG3.0-21SL	26.32	£51.91
PSG3.0-22	59.08	£34.70	PSG3.0-22H	216.61	£57.25	PSG3.0-22S	35.45	£46.84	PSG3.0-22SL	27.57	£53.78
PSG3.0-23	61.76	£35.57	PSG3.0-23H	226.46	£58.69	PSG3.0-23S	37.06	£48.01	PSG3.0-23SL	28.82	£55.14
PSG3.0-24	64.45	£36.61	PSG3.0-24H	236.31	£60.41	PSG3.0-24S	38.67	£49.43	PSG3.0-24SL	30.08	£56.76
PSG3.0-25	67.13	£38.60	PSG3.0-25H	246.15	£63.70	PSG3.0-25S	40.28	£52.11	PSG3.0-25SL	31.33	£59.83
PSG3.0-26	82.14	£40.56	PSG3.0-26H	301.17	£66.92	PSG3.0-26S	49.28	£54.75	PSG3.0-26SL	38.33	£62.86
PSG3.0-27	85.30	£41.41	PSG3.0-27H	312.76	£68.33	PSG3.0-27S	51.18	£55.90	PSG3.0-27SL	39.81	£64.18
PSG3.0-28	88.46	£42.49	PSG3.0-28H	324.34	£70.09	PSG3.0-28S	53.07	£57.36	PSG3.0-28SL	41.28	£65.86
PSG3.0-29	91.62	£43.87	PSG3.0-29H	335.93	£72.40	PSG3.0-29S	54.97	£59.24	PSG3.0-29SL	42.75	£68.01
PSG3.0-30	104.25	£45.38	PSG3.0-30H	356.63	£74.87	PSG3.0-30S	62.55	£61.26	PSG3.0-30SL	48.65	£70.35
PSG3.0-32	111.20	£48.12	PSG3.0-32H	380.40	£79.41	PSG3.0-32S	66.72	£64.96	PSG3.0-32SL	51.89	£74.59
PSG3.0-35	121.63	£50.97	PSG3.0-35H	416.07	£84.11	PSG3.0-35S	72.98	£68.82	PSG3.0-35SL	56.76	£79.02
PSG3.0-38	132.05	£56.03	PSG3.0-38H	451.73	£92.46	PSG3.0-38S	79.23	£75.65	PSG3.0-38SL	61.62	£86.86
PSG3.0-40	177.62	£58.25	PSG3.0-40H	528.93	£96.11	PSG3.0-40S	106.57	£78.63	PSG3.0-40SL	82.89	£90.27
PSG3.0-42	186.50	£60.61	PSG3.0-42H	555.38	£100.00	PSG3.0-42S	111.90	£80.25	PSG3.0-42SL	87.03	£92.15
PSG3.0-45	199.82	£63.03	PSG3.0-45H	595.05	£104.00	PSG3.0-45S	119.89	£82.66	PSG3.0-45SL	93.25	£94.92
PSG3.0-48	213.14	£65.55	PSG3.0-48H	634.72	£108.16	PSG3.0-48S	127.88	£85.14	PSG3.0-48SL	99.46	£97.78