

**PSG-DL**  
**PSG-PK**  
**2.5m<sub>n</sub>**

# PRECISION GEARS

## 2.5 Module Plastic Spur Gear $\alpha$ 20° PA

Quality Grade 8e25 DIN 3961/3967 (AGMA Q9)

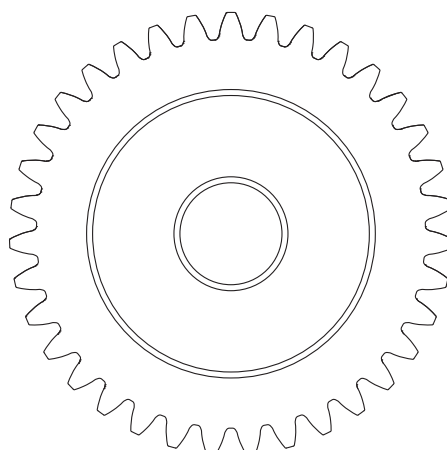
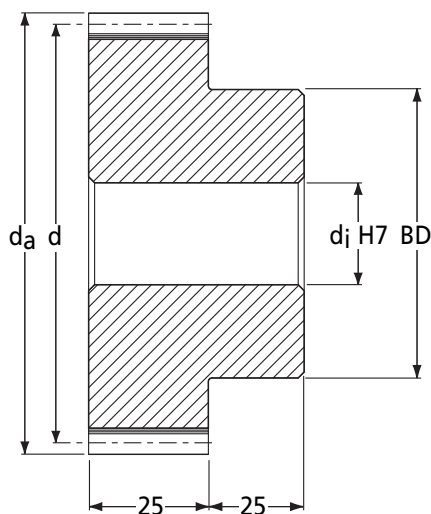
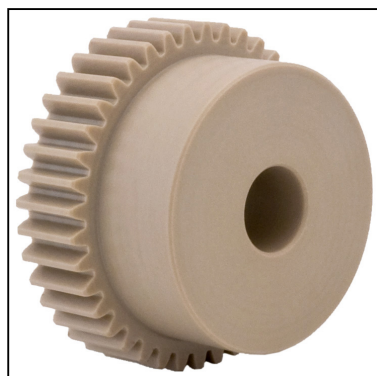

DIN 3967 Tooth Thickness tol.

Part Number	No. of Teeth <i>z</i>	Ref. Dia. <i>d</i>	Tip Dia. <i>d<sub>a</sub></i>	Bore H7 <i>d<sub>j</sub></i>	Max. Bore H7 <i>d<sub>j</sub></i>	Hub Dia. <i>BD</i>	Backlash (mm)		I Inertia <i>kgm<sup>2</sup> (Delrin)</i>	Mass <i>kg (Delrin)</i>
							<i>j<sub>t,e</sub> (max)</i>	<i>j<sub>t,i</sub> (min)</i>		
PSG2.5-18DL	18	45.0	50.0	14	18	35	0.129 - 0.051	1.96 x 10 <sup>-5</sup>	0.078	
PSG2.5-19DL	19	47.5	52.5	14	18	35	0.129 - 0.051	2.31 x 10 <sup>-5</sup>	0.085	
PSG2.5-20DL	20	50.0	55.0	14	18	35	0.129 - 0.051	2.71 x 10 <sup>-5</sup>	0.091	
PSG2.5-21DL	21	52.5	57.5	14	18	35	0.171 - 0.069	3.18 x 10 <sup>-5</sup>	0.098	
PSG2.5-22DL	22	55.0	60.0	14	18	35	0.171 - 0.069	3.71 x 10 <sup>-5</sup>	0.106	
PSG2.5-23DL	23	57.5	62.5	16	25	45	0.171 - 0.069	5.21 x 10 <sup>-5</sup>	0.132	
PSG2.5-24DL	24	60.0	65.0	16	25	45	0.171 - 0.069	5.91 x 10 <sup>-5</sup>	0.140	
PSG2.5-25DL	25	62.5	67.5	16	25	45	0.171 - 0.069	6.70 x 10 <sup>-5</sup>	0.149	
PSG2.5-26DL	26	65.0	70.0	16	25	45	0.171 - 0.069	7.59 x 10 <sup>-5</sup>	0.157	
PSG2.5-27DL	27	67.5	72.5	16	25	45	0.171 - 0.069	8.59 x 10 <sup>-5</sup>	0.167	
PSG2.5-28DL	28	70.0	75.0	16	25	45	0.171 - 0.069	9.71 x 10 <sup>-5</sup>	0.176	
PSG2.5-29DL	29	72.5	77.5	18	35	55	0.171 - 0.069	1.27 x 10 <sup>-4</sup>	0.210	
PSG2.5-30DL	30	75.0	80.0	18	35	55	0.171 - 0.069	1.40 x 10 <sup>-4</sup>	0.220	
PSG2.5-32DL	32	80.0	85.0	18	35	55	0.171 - 0.069	1.72 x 10 <sup>-4</sup>	0.241	
PSG2.5-35DL	35	87.5	92.5	18	35	55	0.173 - 0.067	2.33 x 10 <sup>-4</sup>	0.276	
PSG2.5-38DL	38	95.0	100.0	20	40	70	0.173 - 0.067	3.62 x 10 <sup>-4</sup>	0.361	
PSG2.5-40DL	40	100.0	105.0	20	40	70	0.173 - 0.067	4.26 x 10 <sup>-4</sup>	0.388	
PSG2.5-42DL	42	105.0	110.0	20	40	70	0.173 - 0.067	5.00 x 10 <sup>-4</sup>	0.416	
PSG2.5-45DL	45	112.5	117.5	20	40	70	0.173 - 0.067	6.32 x 10 <sup>-4</sup>	0.461	
PSG2.5-48DL	48	120.0	125.0	20	40	70	0.173 - 0.067	7.94 x 10 <sup>-4</sup>	0.509	
PSG2.5-50DL	50	125.0	130.0	20	40	70	0.175 - 0.065	9.20 x 10 <sup>-4</sup>	0.543	
PSG2.5-52DL	52	130.0	135.0	20	40	70	0.227 - 0.097	1.06 x 10 <sup>-3</sup>	0.578	
PSG2.5-55DL	55	137.5	142.5	20	40	70	0.227 - 0.097	1.31 x 10 <sup>-3</sup>	0.633	
PSG2.5-58DL	58	145.0	150.0	20	40	70	0.227 - 0.097	1.60 x 10 <sup>-3</sup>	0.691	

# PRECISION GEARS

**PSG-DL**  
**PSG-PK**  
**2.5m<sub>n</sub>**

## 2.5 Module Plastic Spur Gear α 20° PA

Quality Grade 8e25 DIN 3961/3967 (AGMA Q9)

Standard Part **PSG** **2.5** **50** **DL**     
Modified Part **PSG** **2.5** **50** **PK** **25** **K** **T**

PSG - Precision Spur Gear  
Quality Grade 8e25 DIN 3961/3967  
Other Quality Grades available.  
See page 291

m<sub>n</sub> Module - Cut with DIN 867 1.25/0.20/1.0  
Ref. Tooth Profile Topping WD = 2.25 x m<sub>n</sub>

Number of Teeth z

DL = Delrin POM (White)  
PK = PEEK GF30® (Light Brown)

T = 1 x Tapped hole 2T = 2 x Tapped holes.  
P = 1 x Pin Hole PT = 1 x Pin Hole thru.  
All threads metric as standard,  
refer to page 308 for sizes and prices.

K- Keyway supplied to  
DIN 6885 - Js9 tolerance.  
For prices see page 308

To specify different bore enter size required  
Example: 25 = 25mm H7 etc  
For prices see page 308

η Efficiency approx. 98%

**Discounts: 6+ -5% 19+ -10%**

Part Number	Delrin POM		Part Number	PEEK GF30®	
	T <sub>2</sub> Nm n <sub>2</sub> 100min <sup>-1</sup>	Price Each 1 - 5		T <sub>2</sub> Nm n <sub>2</sub> 100min <sup>-1</sup>	Price Each 1 - 5
PSG2.5-18DL	4.78	£24.58	PSG2.5-18PK	5.40	£124.44
PSG2.5-19DL	5.38	£25.24	PSG2.5-19PK	6.08	£127.78
PSG2.5-20DL	6.02	£26.16	PSG2.5-20PK	6.81	£132.47
PSG2.5-21DL	6.70	£26.79	PSG2.5-21PK	7.58	£135.66
PSG2.5-22DL	7.43	£27.76	PSG2.5-22PK	8.40	£140.54
PSG2.5-23DL	8.20	£28.46	PSG2.5-23PK	9.27	£144.10
PSG2.5-24DL	9.01	£29.28	PSG2.5-24PK	10.19	£148.29
PSG2.5-25DL	9.87	£30.88	PSG2.5-25PK	11.17	£156.36
PSG2.5-26DL	10.77	£32.44	PSG2.5-26PK	12.19	£164.30
PSG2.5-27DL	11.72	£33.12	PSG2.5-27PK	13.27	£167.71
PSG2.5-28DL	12.72	£33.98	PSG2.5-28PK	14.39	£172.09
PSG2.5-29DL	13.77	£35.10	PSG2.5-29PK	15.58	£177.72
PSG2.5-30DL	14.86	£36.30	PSG2.5-30PK	16.81	£183.82
PSG2.5-32DL	17.20	£38.49	PSG2.5-32PK	19.46	£194.90
PSG2.5-35DL	21.08	£40.78	PSG2.5-35PK	23.85	£206.48
PSG2.5-38DL	25.42	£44.82	PSG2.5-38PK	28.76	£226.95
PSG2.5-40DL	28.58	£46.59	PSG2.5-40PK	32.34	£235.92
PSG2.5-42DL	31.96	£48.44	PSG2.5-42PK	36.17	£245.29
PSG2.5-45DL	37.45	£50.16	PSG2.5-45PK	42.38	£254.00
PSG2.5-48DL	43.46	£53.73	PSG2.5-48PK	49.17	£272.07
PSG2.5-50DL	47.75	£56.71	PSG2.5-50PK	54.02	£287.12
PSG2.5-52DL	50.18	£60.38	PSG2.5-52PK	59.15	£299.96
PSG2.5-55DL	53.62	£64.00	PSG2.5-55PK	67.35	£314.96
PSG2.5-58DL	57.11	£67.84	PSG2.5-58PK	76.17	£330.70