

**PSG**  
**2.5m<sub>n</sub>**

# PRECISION GEARS

## 2.5 Module Spur Gear α 20° PA Quality Grade 7e25 DIN 3961/3967 (AGMA Q10)

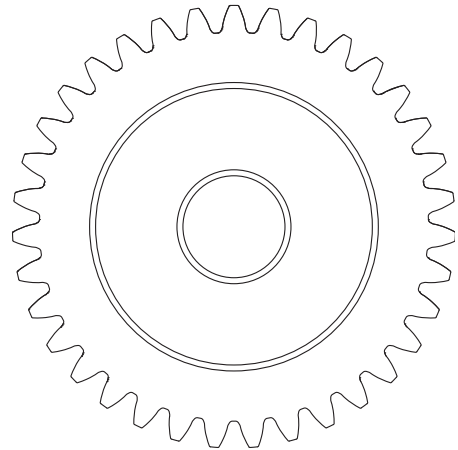
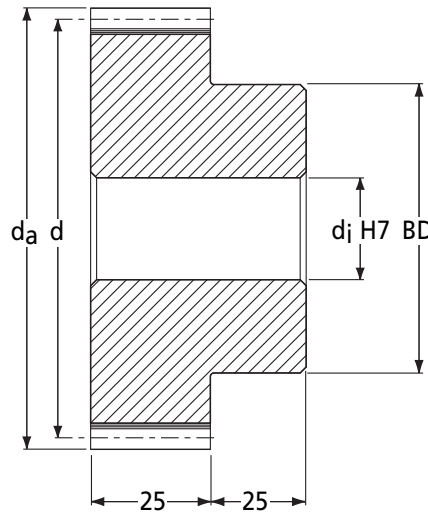

DIN 3967 Tooth Thickness tol.

Part Number	No. of Teeth <i>z</i>	Ref. Dia. <i>d</i>	Tip Dia. <i>d<sub>a</sub></i>	Bore H7 <i>d<sub>j</sub></i>	Max. Bore H7 <i>d<sub>j</sub></i>	Hub Dia. <i>BD</i>	Backlash (mm)		I Inertia <i>kgm<sup>2</sup></i>	Mass <i>kg</i>
							<i>j<sub>t,e</sub></i> (max)	<i>j<sub>t,i</sub></i> (min)		
PSG2.5-18	18	45.0	50.0	14	18	35	0.129 - 0.051	1.09 x 10 <sup>-4</sup>	0.437	
PSG2.5-19	19	47.5	52.5	14	18	35	0.129 - 0.051	1.29 x 10 <sup>-4</sup>	0.472	
PSG2.5-20	20	50.0	55.0	14	18	35	0.129 - 0.051	1.51 x 10 <sup>-4</sup>	0.509	
PSG2.5-21	21	52.5	57.5	14	18	35	0.171 - 0.069	1.77 x 10 <sup>-4</sup>	0.548	
PSG2.5-22	22	55.0	60.0	14	18	35	0.171 - 0.069	2.07 x 10 <sup>-4</sup>	0.589	
PSG2.5-23	23	57.5	62.5	16	25	45	0.171 - 0.069	2.90 x 10 <sup>-4</sup>	0.737	
PSG2.5-24	24	60.0	65.0	16	25	45	0.171 - 0.069	3.29 x 10 <sup>-4</sup>	0.781	
PSG2.5-25	25	62.5	67.5	16	25	45	0.171 - 0.069	3.73 x 10 <sup>-4</sup>	0.828	
PSG2.5-26	26	65.0	70.0	16	25	45	0.171 - 0.069	4.23 x 10 <sup>-4</sup>	0.877	
PSG2.5-27	27	67.5	72.5	16	25	45	0.171 - 0.069	4.78 x 10 <sup>-4</sup>	0.927	
PSG2.5-28	28	70.0	75.0	16	25	45	0.171 - 0.069	5.40 x 10 <sup>-4</sup>	0.980	
PSG2.5-29	29	72.5	77.5	18	35	55	0.171 - 0.069	7.05 x 10 <sup>-4</sup>	1.168	
PSG2.5-30	30	75.0	80.0	18	35	55	0.171 - 0.069	7.82 x 10 <sup>-4</sup>	1.224	
PSG2.5-32	32	80.0	85.0	18	35	55	0.171 - 0.069	9.60 x 10 <sup>-4</sup>	1.342	
PSG2.5-35	35	87.5	92.5	18	35	55	0.173 - 0.067	1.30 x 10 <sup>-3</sup>	1.535	
PSG2.5-38	38	95.0	100.0	20	40	70	0.173 - 0.067	2.02 x 10 <sup>-3</sup>	2.010	
PSG2.5-40	40	100.0	105.0	20	40	70	0.173 - 0.067	2.37 x 10 <sup>-3</sup>	2.159	
PSG2.5-42	42	105.0	110.0	20	40	70	0.173 - 0.067	2.78 x 10 <sup>-3</sup>	2.316	
PSG2.5-45	45	112.5	117.5	20	40	70	0.173 - 0.067	3.52 x 10 <sup>-3</sup>	2.566	
PSG2.5-48	48	120.0	125.0	20	40	70	0.173 - 0.067	4.42 x 10 <sup>-3</sup>	2.833	
PSG2.5-50	50	125.0	130.0	20	40	70	0.175 - 0.065	5.12 x 10 <sup>-3</sup>	3.021	
PSG2.5-52	52	130.0	135.0	20	40	70	0.227 - 0.097	5.92 x 10 <sup>-3</sup>	3.217	
PSG2.5-55	55	137.5	142.5	20	40	70	0.227 - 0.097	7.29 x 10 <sup>-3</sup>	3.524	
PSG2.5-58	58	145.0	150.0	20	40	70	0.227 - 0.097	8.90 x 10 <sup>-3</sup>	3.850	

# PRECISION GEARS

**PSG**  
**2.5m<sub>n</sub>**

## 2.5 Module Spur Gear α 20° PA

Quality Grade 7e25 DIN 3961/3967 (AGMA Q10)

Standard Part **PSG 2.5-50**      
Modified Part **PSG 2.5-50 H 25 K T**

PSG - Precision Spur Gear  
Quality Grade 7e25 DIN 3961/3967  
Other Quality Grades available.  
See page 291

m<sub>n</sub> Module - Cut with DIN 867 1.25/0.20/1.0  
Ref. Tooth Profile Topping WD = 2.25 x m<sub>n</sub>

Number of Teeth z

Standard Material = 817M40T (28HRC)  
H = 805M20 Case Hardened (58HRC)  
S = 303 Stainless Steel  
SL = 316 Stainless Steel

T = 1 x Tapped hole 2T = 2 x Tapped holes.  
P = 1 x Pin Hole PT = 1 x Pin Hole thru.  
All threads metric as standard,  
refer to page 308 for sizes and prices.

K- Keyway supplied to  
DIN 6885 - Js9 tolerance.  
For prices see page 308

To specify different bore enter size required  
Example: 25 = 25mm H7 etc  
For prices see page 308

# Quality Grades and Tolerances stated prior to heat treatment processes.

η Efficiency approx. 98%

**Discounts: 6+ -5% 19+ -10%**

817M40T (28HRC)			Case Hardened 805M20 (58HRC)#			Stainless 303			Stainless 316		
Part Number	T <sub>2</sub> Nm n <sub>2</sub> 100min <sup>-1</sup>	Price Each 1 - 5	Part Number	T <sub>2</sub> Nm n <sub>2</sub> 100min <sup>-1</sup>	Price Each 1 - 5	Part Number	T <sub>2</sub> Nm n <sub>2</sub> 100min <sup>-1</sup>	Price Each 1 - 5	Part Number	T <sub>2</sub> Nm n <sub>2</sub> 100min <sup>-1</sup>	Price Each 1 - 5
PSG2.5-18	22.94	£27.26	PSG2.5-18H	84.12	£44.99	PSG2.5-18S	13.77	£36.81	PSG2.5-18SL	10.71	£42.26
PSG2.5-19	24.22	£28.28	PSG2.5-19H	88.80	£46.68	PSG2.5-19S	14.53	£38.18	PSG2.5-19SL	11.30	£43.84
PSG2.5-20	32.23	£29.22	PSG2.5-20H	118.19	£48.20	PSG2.5-20S	19.34	£39.44	PSG2.5-20SL	15.04	£45.29
PSG2.5-21	33.85	£30.17	PSG2.5-21H	124.10	£49.79	PSG2.5-21S	20.31	£40.74	PSG2.5-21SL	15.79	£46.77
PSG2.5-22	35.46	£31.21	PSG2.5-22H	130.01	£51.50	PSG2.5-22S	21.27	£42.13	PSG2.5-22SL	16.55	£48.37
PSG2.5-23	37.07	£32.20	PSG2.5-23H	135.92	£53.15	PSG2.5-23S	22.24	£43.48	PSG2.5-23SL	17.30	£49.92
PSG2.5-24	38.68	£33.12	PSG2.5-24H	141.83	£54.65	PSG2.5-24S	23.21	£44.71	PSG2.5-24SL	18.05	£51.34
PSG2.5-25	40.29	£35.13	PSG2.5-25H	147.74	£57.97	PSG2.5-25S	24.18	£47.42	PSG2.5-25SL	18.80	£54.45
PSG2.5-26	49.30	£37.14	PSG2.5-26H	180.01	£61.29	PSG2.5-26S	29.58	£50.15	PSG2.5-26SL	23.01	£57.59
PSG2.5-27	51.20	£38.04	PSG2.5-27H	186.94	£62.76	PSG2.5-27S	30.72	£51.35	PSG2.5-27SL	23.89	£58.95
PSG2.5-28	53.09	£39.09	PSG2.5-28H	193.86	£64.50	PSG2.5-28S	31.85	£52.77	PSG2.5-28SL	24.78	£60.59
PSG2.5-29	54.99	£40.69	PSG2.5-29H	200.78	£67.13	PSG2.5-29S	32.99	£54.93	PSG2.5-29SL	25.66	£63.08
PSG2.5-30	62.57	£42.16	PSG2.5-30H	206.38	£69.57	PSG2.5-30S	37.54	£56.91	PSG2.5-30SL	29.20	£65.35
PSG2.5-32	66.74	£45.22	PSG2.5-32H	220.14	£74.63	PSG2.5-32S	40.05	£61.06	PSG2.5-32SL	31.15	£70.11
PSG2.5-35	73.00	£52.39	PSG2.5-35H	240.78	£86.45	PSG2.5-35S	43.80	£70.73	PSG2.5-35SL	34.07	£81.21
PSG2.5-38	79.26	£56.23	PSG2.5-38H	261.42	£92.78	PSG2.5-38S	47.55	£75.91	PSG2.5-38SL	36.99	£87.16
PSG2.5-40	106.60	£57.81	PSG2.5-40H	306.09	£95.39	PSG2.5-40S	63.96	£78.04	PSG2.5-40SL	49.75	£89.61
PSG2.5-42	111.93	£60.56	PSG2.5-42H	321.40	£99.93	PSG2.5-42S	67.16	£81.76	PSG2.5-42SL	52.24	£93.89
PSG2.5-45	119.93	£62.71	PSG2.5-45H	344.36	£103.47	PSG2.5-45S	71.96	£84.66	PSG2.5-45SL	55.97	£97.20
PSG2.5-48	127.92	£67.17	PSG2.5-48H	367.31	£110.84	PSG2.5-48S	76.75	£90.68	PSG2.5-48SL	59.70	£104.12
PSG2.5-50	158.01	£70.89	PSG2.5-50H	415.19	£116.98	PSG2.5-50S	94.81	£95.71	PSG2.5-50SL	73.74	£109.89
PSG2.5-52	164.33	£74.06	PSG2.5-52H	431.80	£124.54	PSG2.5-52S	98.60	£101.89	PSG2.5-52SL	76.69	£114.80
PSG2.5-55	173.81	£77.76	PSG2.5-55H	456.71	£132.02	PSG2.5-55S	104.29	£108.01	PSG2.5-55SL	81.11	£120.54
PSG2.5-58	183.29	£81.65	PSG2.5-58H	481.62	£139.94	PSG2.5-58S	109.97	£114.49	PSG2.5-58SL	85.54	£126.56