

**PSG**  
**2.0m<sub>n</sub>**

# PRECISION GEARS

## 2.0 Module Spur Gear α 20° PA Quality Grade 7e25 DIN 3961/3967 (AGMA Q10)

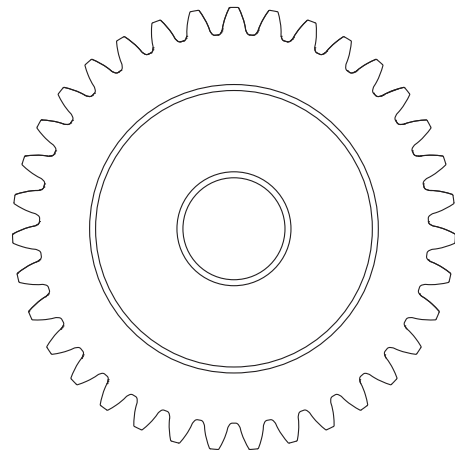
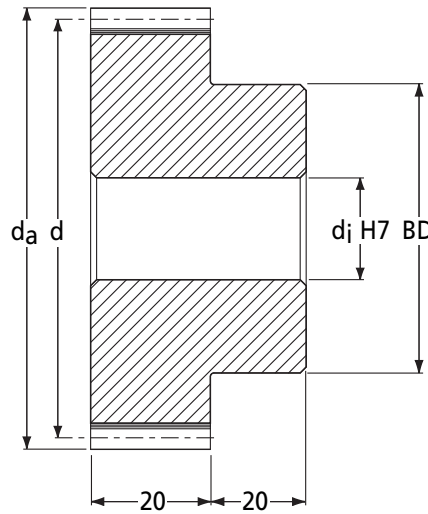
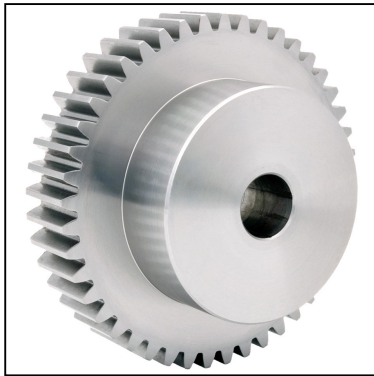

DIN 3967 Tooth Thickness tol.

Part Number	No. of Teeth <i>z</i>	Ref. Dia. <i>d</i>	Tip Dia. <i>d<sub>a</sub></i>	Bore H7 <i>d<sub>j</sub></i>	Max. Bore H7 <i>d<sub>j</sub></i>	Hub Dia. BD	Backlash (mm)		I Inertia <i>I</i> kgm <sup>2</sup>	Mass <i>M</i> kg
							<i>j<sub>t,e</sub></i> (max)	<i>j<sub>t,i</sub></i> (min)		
PSG2.0-18	18	36	40	10	16	30	0.129 - 0.051	3.90 x 10 <sup>-5</sup>	0.244	
PSG2.0-19	19	38	42	10	16	30	0.129 - 0.051	4.53 x 10 <sup>-5</sup>	0.262	
PSG2.0-20	20	40	44	10	16	30	0.129 - 0.051	5.26 x 10 <sup>-5</sup>	0.281	
PSG2.0-21	21	42	46	12	20	35	0.129 - 0.051	7.14 x 10 <sup>-5</sup>	0.330	
PSG2.0-22	22	44	48	12	20	35	0.129 - 0.051	8.12 x 10 <sup>-5</sup>	0.351	
PSG2.0-23	23	46	50	12	20	35	0.129 - 0.051	9.24 x 10 <sup>-5</sup>	0.373	
PSG2.0-24	24	48	52	12	20	35	0.129 - 0.051	1.05 x 10 <sup>-4</sup>	0.396	
PSG2.0-25	25	50	54	12	20	35	0.129 - 0.051	1.20 x 10 <sup>-4</sup>	0.420	
PSG2.0-26	26	52	56	12	20	35	0.171 - 0.069	1.36 x 10 <sup>-4</sup>	0.445	
PSG2.0-27	27	54	58	12	20	35	0.171 - 0.069	1.54 x 10 <sup>-4</sup>	0.471	
PSG2.0-28	28	56	60	12	20	35	0.171 - 0.069	1.75 x 10 <sup>-4</sup>	0.498	
PSG2.0-29	29	58	62	14	25	45	0.171 - 0.069	2.37 x 10 <sup>-4</sup>	0.612	
PSG2.0-30	30	60	64	14	25	45	0.171 - 0.069	2.62 x 10 <sup>-4</sup>	0.640	
PSG2.0-32	32	64	68	14	25	45	0.171 - 0.069	3.20 x 10 <sup>-4</sup>	0.701	
PSG2.0-35	35	70	74	14	25	45	0.171 - 0.069	4.31 x 10 <sup>-4</sup>	0.799	
PSG2.0-38	38	76	80	14	25	45	0.171 - 0.069	5.74 x 10 <sup>-4</sup>	0.907	
PSG2.0-40	40	80	84	16	30	55	0.171 - 0.069	7.67 x 10 <sup>-4</sup>	1.092	
PSG2.0-42	42	84	88	16	30	55	0.173 - 0.067	9.01 x 10 <sup>-4</sup>	1.172	
PSG2.0-45	45	90	94	16	30	55	0.173 - 0.067	1.14 x 10 <sup>-3</sup>	1.300	
PSG2.0-48	48	96	100	16	30	55	0.173 - 0.067	1.44 x 10 <sup>-3</sup>	1.437	
PSG2.0-50	50	100	104	20	40	65	0.173 - 0.067	1.80 x 10 <sup>-3</sup>	1.646	
PSG2.0-52	52	104	108	20	40	65	0.173 - 0.067	2.06 x 10 <sup>-3</sup>	1.746	
PSG2.0-55	55	110	114	20	40	65	0.173 - 0.067	2.51 x 10 <sup>-3</sup>	1.903	
PSG2.0-58	58	116	120	20	40	65	0.173 - 0.067	3.04 x 10 <sup>-3</sup>	2.070	
PSG2.0-60	60	120	124	20	40	65	0.173 - 0.067	3.44 x 10 <sup>-3</sup>	2.186	
PSG2.0-62	62	124	128	20	40	65	0.175 - 0.065	3.88 x 10 <sup>-3</sup>	2.306	
PSG2.0-65	65	130	134	20	40	65	0.227 - 0.097	4.64 x 10 <sup>-3</sup>	2.493	
PSG2.0-68	68	136	140	20	40	65	0.227 - 0.097	5.50 x 10 <sup>-3</sup>	2.689	
PSG2.0-70	70	140	144	20	40	65	0.227 - 0.097	6.14 x 10 <sup>-3</sup>	2.824	
PSG2.0-72	72	144	148	20	40	65	0.227 - 0.097	6.84 x 10 <sup>-3</sup>	2.964	

# PRECISION GEARS

**PSG**  
**2.0m<sub>n</sub>**

## 2.0 Module Spur Gear α 20° PA

Quality Grade 7e25 DIN 3961/3967 (AGMA Q10)

Standard Part **PSG 2.0 - 50**      
Modified Part **PSG 2.0 - 50 H 25 K T**

PSG - Precision Spur Gear  
Quality Grade 7e25 DIN 3961/3967  
Other Quality Grades available.  
See page 291

m<sub>n</sub> Module - Cut with DIN 867 1.25/0.20/1.0  
Ref. Tooth Profile Topping WD = 2.25 x m<sub>n</sub>

Number of Teeth z

Standard Material = 817M40T (28HRC)  
H = 805M20 Case Hardened (58HRC)  
S = 303 Stainless Steel  
SL = 316 Stainless Steel

T = 1 x Tapped hole 2T = 2 x Tapped holes.  
P = 1 x Pin Hole PT = 1 x Pin Hole thru.  
All threads metric as standard,  
refer to page 308 for sizes and prices.

K- Keyway supplied to  
DIN 6885 - Js9 tolerance.  
For prices see page 308

To specify different bore enter size required  
Example: 25 = 25mm H7 etc  
For prices see page 308

# Quality Grades and Tolerances stated prior to heat treatment processes.

η Efficiency approx. 98%

**Discounts: 6+ -5% 19+ -10%**

817M40T (28HRC)			Case Hardened 805M20 (58HRC)#			Stainless 303			Stainless 316		
Part Number	T <sub>2</sub> Nm n <sub>2</sub> 100min <sup>-1</sup>	Price Each 1 - 5	Part Number	T <sub>2</sub> Nm n <sub>2</sub> 100min <sup>-1</sup>	Price Each 1 - 5	Part Number	T <sub>2</sub> Nm n <sub>2</sub> 100min <sup>-1</sup>	Price Each 1 - 5	Part Number	T <sub>2</sub> Nm n <sub>2</sub> 100min <sup>-1</sup>	Price Each 1 - 5
PSG2.0-18	12.28	£22.83	PSG2.0-18H	45.04	£37.68	PSG2.0-18S	7.37	£30.82	PSG2.0-18SL	5.73	£35.39
PSG2.0-19	12.97	£23.35	PSG2.0-19H	47.54	£38.53	PSG2.0-19S	7.78	£31.52	PSG2.0-19SL	6.05	£36.20
PSG2.0-20	17.26	£23.83	PSG2.0-20H	63.28	£39.33	PSG2.0-20S	10.35	£32.18	PSG2.0-20SL	8.05	£36.94
PSG2.0-21	18.12	£24.46	PSG2.0-21H	66.44	£40.37	PSG2.0-21S	10.87	£33.04	PSG2.0-21SL	8.46	£37.93
PSG2.0-22	18.98	£24.84	PSG2.0-22H	69.60	£41.01	PSG2.0-22S	11.39	£33.54	PSG2.0-22SL	8.86	£38.52
PSG2.0-23	19.85	£25.36	PSG2.0-23H	72.77	£41.86	PSG2.0-23S	11.91	£34.25	PSG2.0-23SL	9.26	£39.33
PSG2.0-24	20.71	£25.92	PSG2.0-24H	75.93	£42.78	PSG2.0-24S	12.43	£35.00	PSG2.0-24SL	9.66	£40.19
PSG2.0-25	21.57	£27.37	PSG2.0-25H	79.09	£45.17	PSG2.0-25S	12.94	£36.96	PSG2.0-25SL	10.07	£42.43
PSG2.0-26	26.39	£28.25	PSG2.0-26H	92.17	£46.62	PSG2.0-26S	15.84	£38.13	PSG2.0-26SL	12.32	£43.79
PSG2.0-27	27.41	£29.25	PSG2.0-27H	95.71	£48.27	PSG2.0-27S	16.44	£39.49	PSG2.0-27SL	12.79	£45.34
PSG2.0-28	28.42	£29.89	PSG2.0-28H	99.26	£49.31	PSG2.0-28S	17.05	£40.35	PSG2.0-28SL	13.26	£46.32
PSG2.0-29	29.44	£30.63	PSG2.0-29H	102.80	£50.55	PSG2.0-29S	17.66	£41.37	PSG2.0-29SL	13.74	£47.49
PSG2.0-30	33.50	£31.31	PSG2.0-30H	105.67	£51.66	PSG2.0-30S	20.10	£42.26	PSG2.0-30SL	15.63	£48.53
PSG2.0-32	35.73	£34.00	PSG2.0-32H	112.71	£56.12	PSG2.0-32S	21.44	£45.91	PSG2.0-32SL	16.68	£52.72
PSG2.0-35	39.08	£37.53	PSG2.0-35H	123.28	£61.93	PSG2.0-35S	23.45	£50.68	PSG2.0-35SL	18.24	£58.19
PSG2.0-38	42.43	£41.21	PSG2.0-38H	133.85	£67.98	PSG2.0-38S	25.46	£55.62	PSG2.0-38SL	19.80	£63.87
PSG2.0-40	57.07	£42.94	PSG2.0-40H	156.72	£70.86	PSG2.0-40S	34.24	£57.98	PSG2.0-40SL	26.63	£66.55
PSG2.0-42	59.93	£44.25	PSG2.0-42H	164.56	£73.03	PSG2.0-42S	35.96	£59.76	PSG2.0-42SL	27.97	£68.60
PSG2.0-45	64.21	£46.18	PSG2.0-45H	176.31	£76.19	PSG2.0-45S	38.52	£62.34	PSG2.0-45SL	29.96	£71.57
PSG2.0-48	68.49	£49.73	PSG2.0-48H	188.06	£82.06	PSG2.0-48S	41.09	£67.13	PSG2.0-48SL	31.96	£77.09
PSG2.0-50	84.59	£53.25	PSG2.0-50H	212.58	£87.86	PSG2.0-50S	50.76	£71.88	PSG2.0-50SL	39.48	£82.53
PSG2.0-52	87.98	£55.21	PSG2.0-52H	221.08	£91.12	PSG2.0-52S	52.79	£74.55	PSG2.0-52SL	41.06	£85.60
PSG2.0-55	93.05	£62.35	PSG2.0-55H	233.84	£102.88	PSG2.0-55S	55.83	£84.17	PSG2.0-55SL	43.42	£96.66
PSG2.0-58	98.13	£66.12	PSG2.0-58H	246.59	£109.11	PSG2.0-58S	58.88	£89.27	PSG2.0-58SL	45.79	£102.50
PSG2.0-60	120.80	£67.80	PSG2.0-60H	265.61	£111.89	PSG2.0-60S	72.48	£91.54	PSG2.0-60SL	56.37	£105.11
PSG2.0-62	124.83	£69.46	PSG2.0-62H	274.46	£114.60	PSG2.0-62S	74.90	£93.77	PSG2.0-62SL	58.25	£107.66
PSG2.0-65	130.87	£71.93	PSG2.0-65H	287.75	£118.71	PSG2.0-65S	78.52	£97.12	PSG2.0-65SL	61.07	£111.51
PSG2.0-68	136.91	£74.09	PSG2.0-68H	301.03	£122.27	PSG2.0-68S	82.14	£100.03	PSG2.0-68SL	63.89	£114.86
PSG2.0-70	140.93	£76.31	PSG2.0-70H	309.88	£125.94	PSG2.0-70S	84.56	£103.04	PSG2.0-70SL	65.77	£118.30
PSG2.0-72	144.96	£78.60	PSG2.0-72H	318.73	£129.72	PSG2.0-72S	86.98	£106.13	PSG2.0-72SL	67.65	£121.85