

PSG
1.5m_n

PRECISION GEARS

1.5 Module Spur Gear α 20° PA Quality Grade 7e25 DIN 3961/3967 (AGMA Q10)

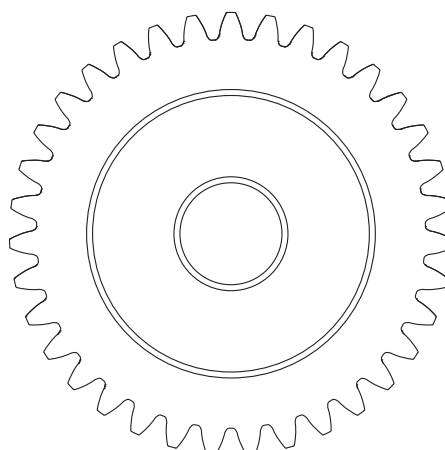
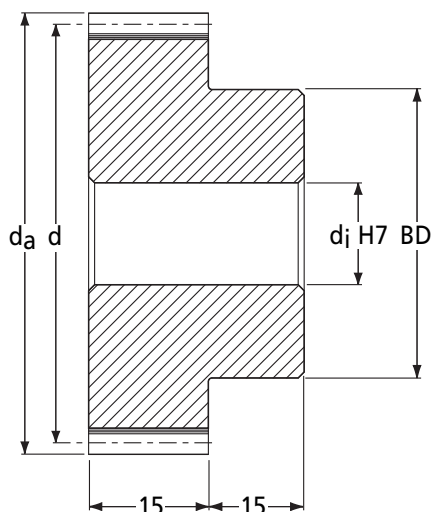

DIN 3967 Tooth Thickness tol.

Part Number	No. of Teeth z	Ref. Dia. d	Tip Dia. d _a	Bore H7 d _j	Max. Bore H7 d _j	Hub Dia. BD	Backlash (mm)		I Inertia kgm ²	Mass kg
							j _{t,e} (max)	j _{t,i} (min)		
PSG1.5-18	18	27.0	30.0	6	12	22	0.128	-0.052	9.05 x 10 ⁻⁶	0.105
PSG1.5-19	19	28.5	31.5	6	12	22	0.128	-0.052	1.05 x 10 ⁻⁵	0.112
PSG1.5-20	20	30.0	33.0	6	12	22	0.128	-0.052	1.23 x 10 ⁻⁵	0.120
PSG1.5-21	21	31.5	34.5	8	14	25	0.129	-0.051	1.60 x 10 ⁻⁵	0.137
PSG1.5-22	22	33.0	36.0	8	14	25	0.129	-0.051	1.84 x 10 ⁻⁵	0.145
PSG1.5-23	23	34.5	37.5	8	14	25	0.129	-0.051	2.10 x 10 ⁻⁵	0.155
PSG1.5-24	24	36.0	39.0	8	14	25	0.129	-0.051	2.40 x 10 ⁻⁵	0.164
PSG1.5-25	25	37.5	40.5	8	14	25	0.129	-0.051	2.75 x 10 ⁻⁵	0.174
PSG1.5-26	26	39.0	42.0	8	14	25	0.129	-0.051	3.13 x 10 ⁻⁵	0.185
PSG1.5-27	27	40.5	43.5	8	14	25	0.129	-0.051	3.57 x 10 ⁻⁵	0.196
PSG1.5-28	28	42.0	45.0	8	14	25	0.129	-0.051	4.05 x 10 ⁻⁵	0.207
PSG1.5-29	29	43.5	46.5	10	20	35	0.129	-0.051	5.86 x 10 ⁻⁵	0.268
PSG1.5-30	30	45.0	48.0	10	20	35	0.129	-0.051	6.45 x 10 ⁻⁵	0.280
PSG1.5-32	32	48.0	51.0	10	20	35	0.129	-0.051	7.84 x 10 ⁻⁵	0.306
PSG1.5-35	35	52.5	55.5	10	20	35	0.171	-0.069	1.05 x 10 ⁻⁴	0.347
PSG1.5-38	38	57.0	60.0	12	25	45	0.171	-0.069	1.68 x 10 ⁻⁴	0.458
PSG1.5-40	40	60.0	63.0	12	25	45	0.171	-0.069	1.96 x 10 ⁻⁴	0.490
PSG1.5-42	42	63.0	66.0	12	25	45	0.171	-0.069	2.28 x 10 ⁻⁴	0.524
PSG1.5-45	45	67.5	70.5	12	25	45	0.171	-0.069	2.85 x 10 ⁻⁴	0.578
PSG1.5-48	48	72.0	75.0	12	25	45	0.171	-0.069	3.55 x 10 ⁻⁴	0.636
PSG1.5-50	50	75.0	78.0	14	30	55	0.171	-0.069	4.68 x 10 ⁻⁴	0.760
PSG1.5-52	52	78.0	81.0	14	30	55	0.171	-0.069	5.29 x 10 ⁻⁴	0.802
PSG1.5-55	55	82.5	85.5	14	30	55	0.173	-0.067	6.36 x 10 ⁻⁴	0.868
PSG1.5-58	58	87.0	90.0	14	30	55	0.173	-0.067	7.62 x 10 ⁻⁴	0.939
PSG1.5-60	60	90.0	93.0	14	30	55	0.173	-0.067	8.57 x 10 ⁻⁴	0.987
PSG1.5-62	62	93.0	96.0	14	30	55	0.173	-0.067	9.63 x 10 ⁻⁴	1.038
PSG1.5-65	65	97.5	100.5	14	30	55	0.173	-0.067	1.14 x 10 ⁻³	1.117
PSG1.5-68	68	102.0	105.0	16	40	65	0.173	-0.067	1.45 x 10 ⁻³	1.300
PSG1.5-70	70	105.0	108.0	16	40	65	0.173	-0.067	1.60 x 10 ⁻³	1.357
PSG1.5-72	72	108.0	111.0	16	40	65	0.173	-0.067	1.76 x 10 ⁻³	1.416
PSG1.5-75	75	112.5	115.5	16	40	65	0.173	-0.067	2.04 x 10 ⁻³	1.507
PSG1.5-78	78	117.0	120.0	16	40	65	0.173	-0.067	2.35 x 10 ⁻³	1.602
PSG1.5-80	80	120.0	123.0	16	40	65	0.173	-0.067	2.58 x 10 ⁻³	1.668
PSG1.5-82	82	123.0	126.0	16	40	65	0.175	-0.065	2.83 x 10 ⁻³	1.735
PSG1.5-85	85	127.5	130.5	16	40	65	0.227	-0.097	3.24 x 10 ⁻³	1.839
PSG1.5-88	88	132.0	135.0	16	40	65	0.227	-0.097	3.69 x 10 ⁻³	1.947
PSG1.5-90	90	135.0	138.0	16	40	65	0.227	-0.097	4.02 x 10 ⁻³	2.021
PSG1.5-92	92	138.0	141.0	16	40	65	0.227	-0.097	4.37 x 10 ⁻³	2.096
PSG1.5-95	95	142.5	145.5	16	40	65	0.227	-0.097	4.94 x 10 ⁻³	2.212
PSG1.5-98	98	147.0	150.0	16	40	65	0.227	-0.097	5.56 x 10 ⁻³	2.333

+44 (0)1246 455500
+44 (0)1246 455522

ondrives

sales@ondrives.com
www.ondrives.com

Product information updated 1st April 2011 and subject to change. Please contact Sales for the latest prices and availability.

PRECISION GEARS

PSG
1.5m_n

1.5 Module Spur Gear α 20° PA

Quality Grade 7e25 DIN 3961/3967 (AGMA Q10)

Standard Part **PSG 1.5 - 50**
Modified Part **PSG 1.5 - 50 H 16 K T**

PSG - Precision Spur Gear
Quality Grade 7e25 DIN 3961/3967
Other Quality Grades available.
See page 291

m_n Module - Cut with DIN 867 1.25/0.20/1.0
Ref. Tooth Profile Topping WD = 2.25 x m_n

Number of Teeth z

Standard Material = 817M40T (28HRC)
H = 805M20 Case Hardened (58HRC)
S = 303 Stainless Steel
SL = 316 Stainless Steel

T = 1 x Tapped hole 2T = 2 x Tapped holes.
P = 1 x Pin Hole PT = 1 x Pin Hole thru.
All threads metric as standard,
refer to page 308 for sizes and prices.

K- Keyway supplied to
DIN 6885 - Js9 tolerance.
For prices see page 308

To specify different bore enter size required
Example: 16 = 16mm H7 etc
For prices see page 308

Quality Grades and Tolerances stated prior to heat treatment processes.
η Efficiency approx. 98%

Discounts: 6+ -5% 19+ -10%

817M40T (28HRC)			Case Hardened 805M20 (58HRC)#			Stainless 303			Stainless 316		
Part Number	T ₂ Nm n ₂ 100min ⁻¹	Price Each 1 - 5	Part Number	T ₂ Nm n ₂ 100min ⁻¹	Price Each 1 - 5	Part Number	T ₂ Nm n ₂ 100min ⁻¹	Price Each 1 - 5	Part Number	T ₂ Nm n ₂ 100min ⁻¹	Price Each 1 - 5
PSG1.5-18	5.49	£15.19	PSG1.5-18H	20.13	£25.07	PSG1.5-18S	3.29	£20.51	PSG1.5-18SL	2.56	£23.56
PSG1.5-19	5.79	£15.77	PSG1.5-19H	21.24	£26.01	PSG1.5-19S	3.48	£21.28	PSG1.5-19SL	2.70	£24.43
PSG1.5-20	7.71	£16.56	PSG1.5-20H	28.28	£27.34	PSG1.5-20S	4.63	£22.36	PSG1.5-20SL	3.60	£25.68
PSG1.5-21	8.10	£16.70	PSG1.5-21H	29.69	£27.56	PSG1.5-21S	4.86	£22.55	PSG1.5-21SL	3.78	£25.89
PSG1.5-22	8.48	£16.89	PSG1.5-22H	31.10	£27.87	PSG1.5-22S	5.09	£22.81	PSG1.5-22SL	3.96	£26.19
PSG1.5-23	8.87	£17.19	PSG1.5-23H	32.52	£28.39	PSG1.5-23S	5.32	£23.22	PSG1.5-23SL	4.14	£26.65
PSG1.5-24	9.25	£17.36	PSG1.5-24H	33.93	£28.65	PSG1.5-24S	5.55	£23.44	PSG1.5-24SL	4.32	£26.92
PSG1.5-25	9.64	£18.27	PSG1.5-25H	35.34	£30.14	PSG1.5-25S	5.78	£24.65	PSG1.5-25SL	4.50	£28.30
PSG1.5-26	11.79	£19.14	PSG1.5-26H	38.88	£31.58	PSG1.5-26S	7.08	£25.84	PSG1.5-26SL	5.50	£29.66
PSG1.5-27	12.25	£19.74	PSG1.5-27H	40.38	£32.57	PSG1.5-27S	7.35	£26.64	PSG1.5-27SL	5.72	£30.58
PSG1.5-28	12.70	£20.29	PSG1.5-28H	41.87	£33.49	PSG1.5-28S	7.62	£27.39	PSG1.5-28SL	5.93	£31.45
PSG1.5-29	13.15	£20.62	PSG1.5-29H	43.37	£34.02	PSG1.5-29S	7.89	£27.83	PSG1.5-29SL	6.14	£31.95
PSG1.5-30	14.97	£21.23	PSG1.5-30H	44.58	£35.03	PSG1.5-30S	8.98	£28.66	PSG1.5-30SL	6.99	£32.91
PSG1.5-32	15.97	£21.95	PSG1.5-32H	47.55	£36.23	PSG1.5-32S	9.58	£29.64	PSG1.5-32SL	7.45	£34.04
PSG1.5-35	17.46	£22.65	PSG1.5-35H	52.01	£37.38	PSG1.5-35S	10.48	£30.58	PSG1.5-35SL	8.15	£35.12
PSG1.5-38	18.96	£24.82	PSG1.5-38H	56.47	£40.96	PSG1.5-38S	11.38	£33.51	PSG1.5-38SL	8.85	£38.48
PSG1.5-40	25.50	£25.81	PSG1.5-40H	66.12	£42.59	PSG1.5-40S	15.30	£34.84	PSG1.5-40SL	11.90	£40.01
PSG1.5-42	26.78	£25.93	PSG1.5-42H	69.42	£42.80	PSG1.5-42S	16.07	£35.01	PSG1.5-42SL	12.50	£40.21
PSG1.5-45	28.69	£26.49	PSG1.5-45H	74.38	£43.72	PSG1.5-45S	17.21	£35.77	PSG1.5-45SL	13.39	£41.07
PSG1.5-48	30.60	£28.30	PSG1.5-48H	79.34	£46.71	PSG1.5-48S	18.36	£38.23	PSG1.5-48SL	14.28	£43.89
PSG1.5-50	37.80	£31.63	PSG1.5-50H	89.68	£52.20	PSG1.5-50S	22.68	£42.71	PSG1.5-50SL	17.64	£49.04
PSG1.5-52	39.31	£33.25	PSG1.5-52H	93.27	£54.86	PSG1.5-52S	23.59	£44.89	PSG1.5-52SL	18.35	£51.53
PSG1.5-55	41.58	£34.08	PSG1.5-55H	98.65	£56.24	PSG1.5-55S	24.95	£46.02	PSG1.5-55SL	19.40	£52.83
PSG1.5-58	43.85	£34.86	PSG1.5-58H	104.03	£57.52	PSG1.5-58S	26.31	£47.06	PSG1.5-58SL	20.46	£54.04
PSG1.5-60	53.98	£35.18	PSG1.5-60H	112.05	£58.07	PSG1.5-60S	32.39	£47.51	PSG1.5-60SL	25.19	£54.55
PSG1.5-62	55.78	£35.88	PSG1.5-62H	115.79	£59.22	PSG1.5-62S	33.47	£48.45	PSG1.5-62SL	26.03	£55.62
PSG1.5-65	58.48	£37.23	PSG1.5-65H	121.39	£61.44	PSG1.5-65S	35.09	£50.27	PSG1.5-65SL	27.29	£57.71
PSG1.5-68	61.18	£39.49	PSG1.5-68H	127.00	£65.17	PSG1.5-68S	36.71	£53.31	PSG1.5-68SL	28.55	£61.22
PSG1.5-70	62.98	£40.91	PSG1.5-70H	130.73	£67.50	PSG1.5-70S	37.79	£55.23	PSG1.5-70SL	29.39	£63.42
PSG1.5-72	64.78	£43.24	PSG1.5-72H	134.47	£71.35	PSG1.5-72S	38.87	£58.38	PSG1.5-72SL	30.23	£67.04
PSG1.5-75	67.48	£46.10	PSG1.5-75H	140.07	£76.08	PSG1.5-75S	40.49	£62.24	PSG1.5-75SL	31.49	£71.46
PSG1.5-78	70.17	£48.58	PSG1.5-78H	145.67	£80.17	PSG1.5-78S	42.10	£65.59	PSG1.5-78SL	32.75	£75.32
PSG1.5-80	92.13	£50.38	PSG1.5-80H	156.66	£83.14	PSG1.5-80S	55.28	£68.02	PSG1.5-80SL	43.00	£78.12
PSG1.5-82	94.44	£52.69	PSG1.5-82H	160.57	£86.94	PSG1.5-82S	56.66	£71.13	PSG1.5-82SL	44.07	£81.67
PSG1.5-85	97.89	£55.55	PSG1.5-85H	166.45	£89.93	PSG1.5-85S	58.74	£73.58	PSG1.5-85SL	45.68	£84.49
PSG1.5-88	101.35	£58.31	PSG1.5-88H	172.32	£93.53	PSG1.5-88S	60.81	£76.52	PSG1.5-88SL	47.30	£87.87
PSG1.5-90	103.65	£61.24	PSG1.5-90H	176.24	£97.27	PSG1.5-90S	62.19	£79.58	PSG1.5-90SL	48.37	£91.38
PSG1.5-92	105.95	£64.31	PSG1.5-92H	180.16	£101.16	PSG1.5-92S	63.57	£82.76	PSG1.5-92SL	49.45	£95.10
PSG1.5-95	109.41	£67.52	PSG1.5-95H	186.03	£105.21	PSG1.5-95S	65.65	£86.07	PSG1.5-95SL	51.06	£98.84
PSG1.5-98	112.86	£70.90	PSG1.5-98H	191.90	£109.41	PSG1.5-98S	67.72	£89.52	PSG1.5-98SL	52.67	£102.80

+44 (0)1246 455500
+44 (0)1246 455522

ondrives

sales@ondrives.com
www.ondrives.com

Product information updated 1st April 2011 and subject to change. Please contact Sales for the latest prices and availability.