

**PSG-HCK**  
**1.25m<sub>n</sub>**

# PRECISION GEARS

## 1.25 Module Skive Hobbed Spur Gear α 20° PA

Quality Grade 6e25 DIN 3961/3967 (AGMA Q11)

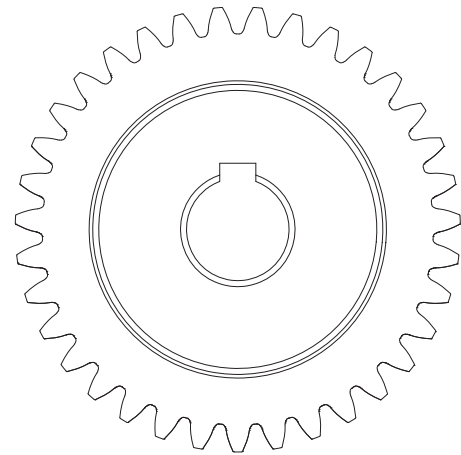
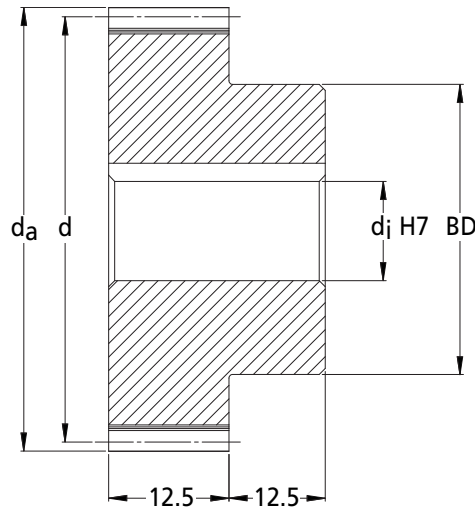

DIN 3967 Tooth Thickness tol.

Part Number	No. of Teeth <i>z</i>	Ref. Dia. <i>d</i>	Tip Dia. <i>d<sub>a</sub></i>	Bore H7 <i>d<sub>j</sub></i>	Max. Bore H7 <i>d<sub>j</sub></i>	Hub Dia. <i>BD</i>	Keyway	Backlash (mm)		I Inertia <i>kgm<sup>2</sup></i>	Mass <i>kg</i>
								<i>j<sub>t,e</sub></i> (max)	<i>j<sub>t,i</sub></i> (min)		
PSG1.25-18HCK	18	22.50	25.00	6	8	15	2	0.128 - 0.052	3.02 x 10 <sup>-6</sup>	0.050	
PSG1.25-19HCK	19	23.75	26.25	6	8	15	2	0.128 - 0.052	3.62 x 10 <sup>-6</sup>	0.055	
PSG1.25-20HCK	20	25.00	27.50	6	8	15	2	0.128 - 0.052	4.32 x 10 <sup>-6</sup>	0.059	
PSG1.25-21HCK	21	26.25	28.75	8	12	20	2	0.128 - 0.052	6.13 x 10 <sup>-6</sup>	0.073	
PSG1.25-22HCK	22	27.50	30.00	8	12	20	2	0.128 - 0.052	7.06 x 10 <sup>-6</sup>	0.079	
PSG1.25-23HCK	23	28.75	31.25	8	12	20	2	0.128 - 0.052	8.13 x 10 <sup>-6</sup>	0.084	
PSG1.25-24HCK	24	30.00	32.50	8	12	22	2	0.129 - 0.051	1.01 x 10 <sup>-5</sup>	0.096	
PSG1.25-25HCK	25	31.25	33.75	8	12	22	2	0.129 - 0.051	1.14 x 10 <sup>-5</sup>	0.102	
PSG1.25-26HCK	26	32.50	35.00	8	12	22	2	0.129 - 0.051	1.30 x 10 <sup>-5</sup>	0.108	
PSG1.25-27HCK	27	33.75	36.25	8	12	22	2	0.129 - 0.051	1.47 x 10 <sup>-5</sup>	0.114	
PSG1.25-28HCK	28	35.00	37.50	8	15	25	2	0.129 - 0.051	1.82 x 10 <sup>-5</sup>	0.132	
PSG1.25-29HCK	29	36.25	38.75	8	15	25	2	0.129 - 0.051	2.03 x 10 <sup>-5</sup>	0.138	
PSG1.25-30HCK	30	37.50	40.00	8	15	25	2	0.129 - 0.051	2.27 x 10 <sup>-5</sup>	0.145	
PSG1.25-32HCK	32	40.00	42.50	8	15	25	2	0.129 - 0.051	2.83 x 10 <sup>-5</sup>	0.160	
PSG1.25-35HCK	35	43.75	46.25	10	18	30	3	0.129 - 0.051	4.28 x 10 <sup>-5</sup>	0.200	
PSG1.25-38HCK	38	47.50	50.00	10	18	30	3	0.129 - 0.051	5.64 x 10 <sup>-5</sup>	0.226	
PSG1.25-40HCK	40	50.00	52.50	10	18	30	3	0.129 - 0.051	6.75 x 10 <sup>-5</sup>	0.245	
PSG1.25-42HCK	42	52.50	55.00	10	18	30	3	0.171 - 0.069	8.03 x 10 <sup>-5</sup>	0.264	
PSG1.25-45HCK	45	56.25	58.75	10	18	30	3	0.171 - 0.069	1.03 x 10 <sup>-4</sup>	0.296	
PSG1.25-48HCK	48	60.00	62.50	10	25	40	3	0.171 - 0.069	1.48 x 10 <sup>-4</sup>	0.383	
PSG1.25-50HCK	50	62.50	65.00	10	25	40	3	0.171 - 0.069	1.70 x 10 <sup>-4</sup>	0.407	
PSG1.25-52HCK	52	65.00	67.50	10	25	40	3	0.171 - 0.069	1.95 x 10 <sup>-4</sup>	0.431	
PSG1.25-55HCK	55	68.75	71.25	10	25	40	3	0.171 - 0.069	2.38 x 10 <sup>-4</sup>	0.469	
PSG1.25-58HCK	58	72.50	75.00	10	25	40	3	0.171 - 0.069	2.88 x 10 <sup>-4</sup>	0.510	
PSG1.25-60HCK	60	75.00	77.50	10	30	50	3	0.171 - 0.069	3.62 x 10 <sup>-4</sup>	0.608	
PSG1.25-62HCK	62	77.50	80.00	10	30	50	3	0.171 - 0.069	4.05 x 10 <sup>-4</sup>	0.637	
PSG1.25-65HCK	65	81.25	83.75	10	30	50	3	0.173 - 0.067	4.76 x 10 <sup>-4</sup>	0.683	
PSG1.25-68HCK	68	85.00	87.50	10	30	50	3	0.173 - 0.067	5.59 x 10 <sup>-4</sup>	0.731	
PSG1.25-70HCK	70	87.50	90.00	10	30	50	3	0.173 - 0.067	6.20 x 10 <sup>-4</sup>	0.764	
PSG1.25-72HCK	72	90.00	92.50	10	30	50	3	0.173 - 0.067	6.87 x 10 <sup>-4</sup>	0.798	
PSG1.25-75HCK	75	93.75	96.25	10	35	60	3	0.173 - 0.067	8.63 x 10 <sup>-4</sup>	0.935	
PSG1.25-78HCK	78	97.50	100.00	10	35	60	3	0.173 - 0.067	9.88 x 10 <sup>-4</sup>	0.991	
PSG1.25-80HCK	80	100.00	102.50	10	35	60	3	0.173 - 0.067	1.08 x 10 <sup>-3</sup>	1.029	
PSG1.25-82HCK	82	102.50	105.00	10	35	60	3	0.173 - 0.067	1.18 x 10 <sup>-3</sup>	1.067	
PSG1.25-85HCK	85	106.25	108.75	10	35	60	3	0.173 - 0.067	1.34 x 10 <sup>-3</sup>	1.128	
PSG1.25-90HCK	90	112.50	115.00	10	40	65	3	0.173 - 0.067	1.70 x 10 <sup>-3</sup>	1.281	
PSG1.25-95HCK	95	118.75	121.25	10	40	65	3	0.173 - 0.067	2.07 x 10 <sup>-3</sup>	1.392	
PSG1.25-100HCK	100	125.00	127.50	14	40	65	5	0.175 - 0.065	2.51 x 10 <sup>-3</sup>	1.494	
PSG1.25-110HCK	110	137.50	140.00	14	40	70	5	0.227 - 0.097	3.65 x 10 <sup>-3</sup>	1.798	
PSG1.25-120HCK	120	150.00	152.50	14	40	70	5	0.227 - 0.097	5.08 x 10 <sup>-3</sup>	2.075	

+44 (0)1246 455500  
+44 (0)1246 455522

**ondrives**

sales@ondrives.com  
www.ondrives.com

Product information updated 1st April 2011 and subject to change. Please contact Sales for the latest prices and availability.

# PRECISION GEARS

**PSG-HCK**  
**1.25m<sub>n</sub>**

## 1.25 Module Skive Hobbed Spur Gear α 20° PA

Quality Grade 6e25 DIN 3961/3967 (AGMA Q11)

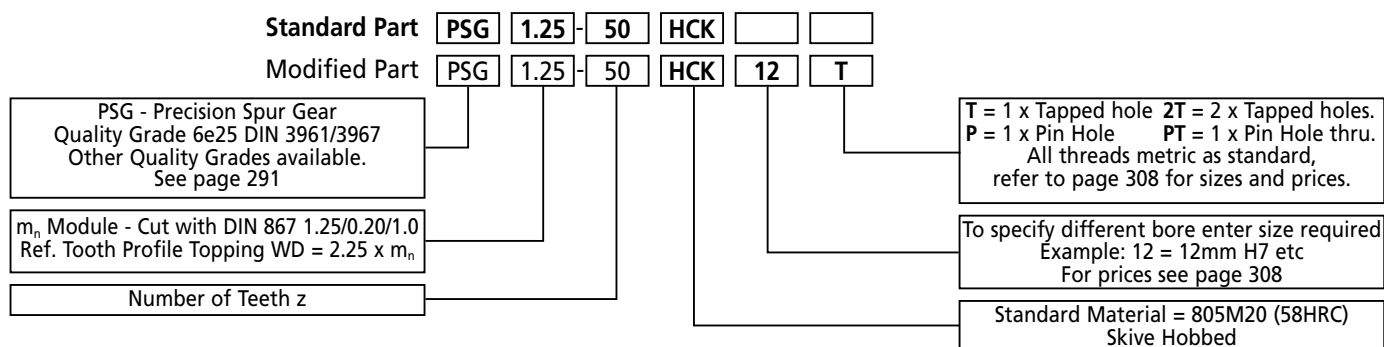

Standard bores less than 6mm supplied without keyway.

Quality Grades and Tolerances stated prior to heat treatment processes.

η Efficiency approx. 98%

**Discounts: 6+ -5% 19+ -10%**

Part Number	Hard Cut T <sub>2</sub> Nm n <sub>2</sub> 100min <sup>-1</sup>	Price Each 1 - 5
PSG1.25-18HCK	12.08	£38.11
PSG1.25-19HCK	12.75	£38.90
PSG1.25-20HCK	16.97	£39.48
PSG1.25-21HCK	17.82	£40.71
PSG1.25-22HCK	18.67	£41.30
PSG1.25-23HCK	19.52	£41.49
PSG1.25-24HCK	20.36	£41.71
PSG1.25-25HCK	21.21	£43.45
PSG1.25-26HCK	22.50	£45.01
PSG1.25-27HCK	23.37	£45.93
PSG1.25-28HCK	24.23	£46.97
PSG1.25-29HCK	25.10	£48.19
PSG1.25-30HCK	25.80	£49.01
PSG1.25-32HCK	27.52	£50.27
PSG1.25-35HCK	30.10	£51.97
PSG1.25-38HCK	32.68	£54.08
PSG1.25-40HCK	38.26	£56.08
PSG1.25-42HCK	40.17	£56.49
PSG1.25-45HCK	43.04	£57.30
PSG1.25-48HCK	45.91	£57.79
PSG1.25-50HCK	51.90	£63.78
PSG1.25-52HCK	53.98	£65.67
PSG1.25-55HCK	57.09	£68.41
PSG1.25-58HCK	60.20	£70.48
PSG1.25-60HCK	64.85	£72.11
PSG1.25-62HCK	67.01	£74.48
PSG1.25-65HCK	70.25	£79.82
PSG1.25-68HCK	73.49	£83.92
PSG1.25-70HCK	75.65	£85.66
PSG1.25-72HCK	77.82	£87.51
PSG1.25-75HCK	81.06	£93.36
PSG1.25-78HCK	84.30	£94.77
PSG1.25-80HCK	90.66	£96.69
PSG1.25-82HCK	92.92	£98.07
PSG1.25-85HCK	96.32	£100.18
PSG1.25-90HCK	101.99	£103.40
PSG1.25-95HCK	107.66	£114.47
PSG1.25-100HCK	115.95	£115.98
PSG1.25-110HCK	121.74	£145.19
PSG1.25-120HCK	127.54	£164.18

+44 (0)1246 455500  
+44 (0)1246 455522

**ondrives**

sales@ondrives.com  
www.ondrives.com

Product information updated 1st April 2011 and subject to change. Please contact Sales for the latest prices and availability.