

PSG-DL
PSG-PK
1.25m_n

PRECISION GEARS

1.25 Module Plastic Spur Gear α 20° PA

Quality Grade 8e25 DIN 3961/3967 (AGMA Q9)

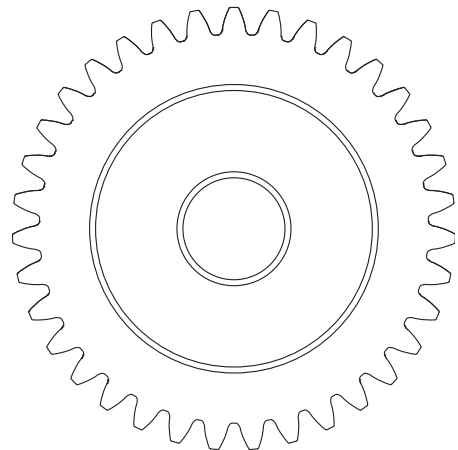
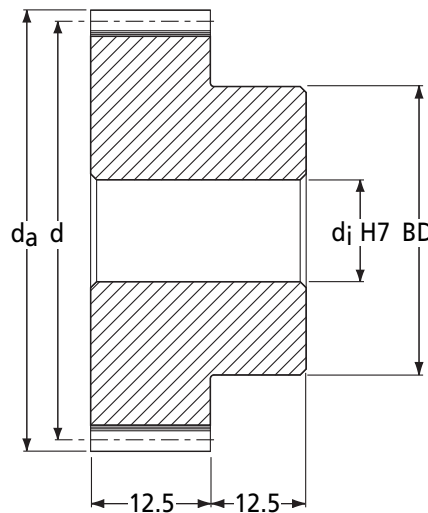

DIN 3967 Tooth Thickness tol.

Part Number	No. of Teeth z	Ref. Dia. d	Tip Dia. d _a	Bore H7 d _j	Max. Bore H7 d _j	Hub Dia. BD	Backlash (mm)		I Inertia kgm ² (Delrin)	Mass kg (Delrin)
							j _{t,e} (max)	j _{t,i} (min)		
PSG1.25-18DL	18	22.50	25.00	6	8	15	0.128 - 0.052	5.43 x 10 ⁻⁷	0.009	
PSG1.25-19DL	19	23.75	26.25	6	8	15	0.128 - 0.052	6.50 x 10 ⁻⁷	0.010	
PSG1.25-20DL	20	25.00	27.50	6	8	15	0.128 - 0.052	7.76 x 10 ⁻⁷	0.011	
PSG1.25-21DL	21	26.25	28.75	8	12	20	0.128 - 0.052	1.10 x 10 ⁻⁶	0.013	
PSG1.25-22DL	22	27.50	30.00	8	12	20	0.128 - 0.052	1.27 x 10 ⁻⁶	0.014	
PSG1.25-23DL	23	28.75	31.25	8	12	20	0.128 - 0.052	1.46 x 10 ⁻⁶	0.015	
PSG1.25-24DL	24	30.00	32.50	8	12	22	0.128 - 0.052	1.81 x 10 ⁻⁶	0.017	
PSG1.25-25DL	25	31.25	33.75	8	12	22	0.129 - 0.051	2.06 x 10 ⁻⁶	0.018	
PSG1.25-26DL	26	32.50	35.00	8	12	22	0.129 - 0.051	2.33 x 10 ⁻⁶	0.020	
PSG1.25-27DL	27	33.75	36.25	8	12	22	0.129 - 0.051	2.65 x 10 ⁻⁶	0.021	
PSG1.25-28DL	28	35.00	37.50	8	15	25	0.129 - 0.051	3.27 x 10 ⁻⁶	0.024	
PSG1.25-29DL	29	36.25	38.75	8	15	25	0.129 - 0.051	3.65 x 10 ⁻⁶	0.025	
PSG1.25-30DL	30	37.50	40.00	8	15	25	0.129 - 0.051	4.08 x 10 ⁻⁶	0.026	
PSG1.25-32DL	32	40.00	42.50	8	15	25	0.129 - 0.051	5.08 x 10 ⁻⁶	0.029	
PSG1.25-35DL	35	43.75	46.25	10	18	30	0.129 - 0.051	7.68 x 10 ⁻⁶	0.036	
PSG1.25-38DL	38	47.50	50.00	10	18	30	0.129 - 0.051	1.01 x 10 ⁻⁵	0.041	
PSG1.25-40DL	40	50.00	52.50	10	18	30	0.129 - 0.051	1.21 x 10 ⁻⁵	0.044	
PSG1.25-42DL	42	52.50	55.00	10	18	30	0.171 - 0.069	1.44 x 10 ⁻⁵	0.048	
PSG1.25-45DL	45	56.25	58.75	10	18	30	0.171 - 0.069	1.86 x 10 ⁻⁵	0.053	
PSG1.25-48DL	48	60.00	62.50	10	25	40	0.171 - 0.069	2.66 x 10 ⁻⁵	0.069	
PSG1.25-50DL	50	62.50	65.00	10	25	40	0.171 - 0.069	3.06 x 10 ⁻⁵	0.073	
PSG1.25-52DL	52	65.00	67.50	10	25	40	0.171 - 0.069	3.50 x 10 ⁻⁵	0.077	
PSG1.25-55DL	55	68.75	71.25	10	25	40	0.171 - 0.069	4.27 x 10 ⁻⁵	0.084	
PSG1.25-58DL	58	72.50	75.00	10	25	40	0.171 - 0.069	5.18 x 10 ⁻⁵	0.092	
PSG1.25-60DL	60	75.00	77.50	10	30	50	0.171 - 0.069	6.51 x 10 ⁻⁵	0.109	
PSG1.25-62DL	62	77.50	80.00	10	30	50	0.171 - 0.069	7.27 x 10 ⁻⁵	0.114	
PSG1.25-65DL	65	81.25	83.75	10	30	50	0.173 - 0.067	8.56 x 10 ⁻⁵	0.123	
PSG1.25-68DL	68	85.00	87.50	10	30	50	0.173 - 0.067	1.00 x 10 ⁻⁴	0.131	
PSG1.25-70DL	70	87.50	90.00	10	30	50	0.173 - 0.067	1.11 x 10 ⁻⁴	0.137	
PSG1.25-72DL	72	90.00	92.50	10	30	50	0.173 - 0.067	1.23 x 10 ⁻⁴	0.143	
PSG1.25-75DL	75	93.75	96.25	10	35	60	0.173 - 0.067	1.55 x 10 ⁻⁴	0.168	
PSG1.25-78DL	78	97.50	100.00	10	35	60	0.173 - 0.067	1.78 x 10 ⁻⁴	0.178	
PSG1.25-80DL	80	100.00	102.50	10	35	60	0.173 - 0.067	1.94 x 10 ⁻⁴	0.185	
PSG1.25-82DL	82	102.50	105.00	10	35	60	0.173 - 0.067	2.12 x 10 ⁻⁴	0.192	
PSG1.25-85DL	85	106.25	108.75	10	35	60	0.173 - 0.067	2.41 x 10 ⁻⁴	0.203	
PSG1.25-90DL	90	112.50	115.00	10	40	65	0.173 - 0.067	3.06 x 10 ⁻⁴	0.230	
PSG1.25-95DL	95	118.75	121.25	10	40	65	0.173 - 0.067	3.72 x 10 ⁻⁴	0.250	
PSG1.25-100DL	100	125.00	127.50	14	40	65	0.175 - 0.065	4.50 x 10 ⁻⁴	0.268	
PSG1.25-110DL	110	137.50	140.00	14	40	70	0.227 - 0.097	6.56 x 10 ⁻⁴	0.323	
PSG1.25-120DL	120	150.00	152.50	14	40	70	0.227 - 0.097	9.12 x 10 ⁻⁴	0.373	

+44 (0)1246 455500
+44 (0)1246 455522

ondrives

sales@ondrives.com
www.ondrives.com

Product information updated 1st April 2011 and subject to change. Please contact Sales for the latest prices and availability.

PRECISION GEARS

PSG-DL
PSG-PK
1.25m_n

1.25 Module Plastic Spur Gear α 20° PA

Quality Grade 8e25 DIN 3961/3967 (AGMA Q9)

Standard Part **PSG** **1.25** **50** **DL**
Modified Part **PSG** **1.25** **50** **PK** **12** **K** **T**

PSG - Precision Spur Gear
Quality Grade 8e25 DIN 3961/3967
Other Quality Grades available.
See page 291

m_n Module - Cut with DIN 867 1.25/0.20/1.0
Ref. Tooth Profile Topping WD = 2.25 x m_n

Number of Teeth z

DL = Delrin POM (White)
PK = PEEK GF30® (Light Brown)

T = 1 x Tapped hole 2T = 2 x Tapped holes.
P = 1 x Pin Hole PT = 1 x Pin Hole thru.
All threads metric as standard,
refer to page 308 for sizes and prices.

K- Keyway supplied to
DIN 6885 - Js9 tolerance.
For prices see page 308

To specify different bore enter size required
Example: 12 = 12mm H7 etc
For prices see page 308

η Efficiency approx. 98%

Discounts: 6+ -5% 19+ -10%

Part Number	Delrin POM		Part Number	PEEK GF30®	
	T ₂ Nm n ₂ 100min ⁻¹	Price Each 1 - 5		T ₂ Nm n ₂ 100min ⁻¹	Price Each 1 - 5
PSG1.25-18DL	1.37	£11.60	PSG1.25-18PK	1.55	£58.78
PSG1.25-19DL	1.54	£11.78	PSG1.25-19PK	1.75	£59.67
PSG1.25-20DL	1.73	£11.95	PSG1.25-20PK	1.96	£60.56
PSG1.25-21DL	1.92	£12.33	PSG1.25-21PK	2.18	£62.46
PSG1.25-22DL	2.13	£12.51	PSG1.25-22PK	2.41	£63.37
PSG1.25-23DL	2.35	£12.56	PSG1.25-23PK	2.66	£63.65
PSG1.25-24DL	2.59	£12.64	PSG1.25-24PK	2.93	£64.00
PSG1.25-25DL	2.83	£13.16	PSG1.25-25PK	3.21	£66.66
PSG1.25-26DL	3.09	£13.63	PSG1.25-26PK	3.50	£69.06
PSG1.25-27DL	3.37	£13.91	PSG1.25-27PK	3.81	£70.47
PSG1.25-28DL	3.65	£14.22	PSG1.25-28PK	4.13	£72.06
PSG1.25-29DL	3.87	£14.60	PSG1.25-29PK	4.47	£73.93
PSG1.25-30DL	4.05	£14.84	PSG1.25-30PK	4.83	£75.19
PSG1.25-32DL	4.39	£15.22	PSG1.25-32PK	5.59	£77.12
PSG1.25-35DL	4.91	£15.75	PSG1.25-35PK	6.70	£79.73
PSG1.25-38DL	5.45	£16.39	PSG1.25-38PK	7.43	£82.96
PSG1.25-40DL	5.81	£16.98	PSG1.25-40PK	7.93	£86.04
PSG1.25-42DL	6.17	£17.11	PSG1.25-42PK	8.41	£86.66
PSG1.25-45DL	6.71	£17.36	PSG1.25-45PK	9.14	£87.91
PSG1.25-48DL	7.26	£17.50	PSG1.25-48PK	9.89	£88.65
PSG1.25-50DL	7.63	£19.32	PSG1.25-50PK	10.40	£97.85
PSG1.25-52DL	7.99	£19.89	PSG1.25-52PK	10.89	£100.75
PSG1.25-55DL	8.54	£20.72	PSG1.25-55PK	11.64	£104.95
PSG1.25-58DL	9.09	£21.35	PSG1.25-58PK	12.40	£108.12
PSG1.25-60DL	9.47	£21.85	PSG1.25-60PK	12.91	£110.63
PSG1.25-62DL	9.82	£22.56	PSG1.25-62PK	13.39	£114.26
PSG1.25-65DL	10.36	£24.18	PSG1.25-65PK	14.13	£122.44
PSG1.25-68DL	10.90	£25.43	PSG1.25-68PK	14.87	£128.75
PSG1.25-70DL	11.27	£25.95	PSG1.25-70PK	15.36	£131.41
PSG1.25-72DL	11.63	£26.51	PSG1.25-72PK	15.86	£134.26
PSG1.25-75DL	12.18	£28.28	PSG1.25-75PK	16.61	£143.23
PSG1.25-78DL	12.74	£28.71	PSG1.25-78PK	17.37	£145.39
PSG1.25-80DL	13.11	£29.29	PSG1.25-80PK	17.88	£148.34
PSG1.25-82DL	13.49	£29.71	PSG1.25-82PK	18.40	£150.45
PSG1.25-85DL	14.04	£30.35	PSG1.25-85PK	19.14	£153.68
PSG1.25-90DL	14.96	£31.33	PSG1.25-90PK	20.40	£158.61
PSG1.25-95DL	15.88	£34.68	PSG1.25-95PK	21.66	£175.61
PSG1.25-100DL	16.79	£35.14	PSG1.25-100PK	22.89	£177.93
PSG1.25-110DL	18.61	£43.99	PSG1.25-110PK	25.37	£222.74
PSG1.25-120DL	20.43	£49.74	PSG1.25-120PK	27.85	£251.88

+44 (0)1246 455500
+44 (0)1246 455522

ondrives

sales@ondrives.com
www.ondrives.com

Product information updated 1st April 2011 and subject to change. Please contact Sales for the latest prices and availability.