

PSG
1.25m_n

PRECISION GEARS

1.25 Module Spur Gear α 20° PA Quality Grade 7e25 DIN 3961/3967 (AGMA Q10)

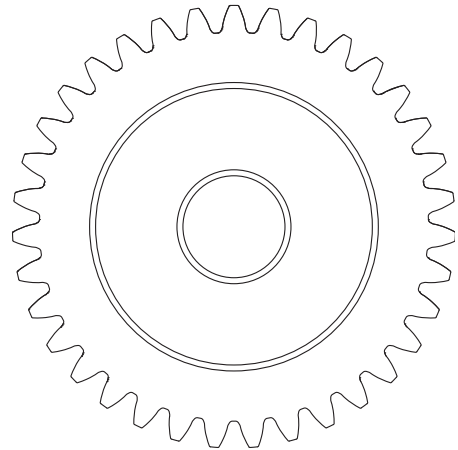
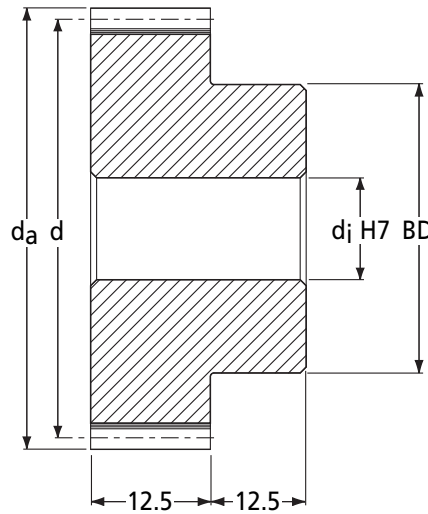

DIN 3967 Tooth Thickness tol.

Part Number	No. of Teeth z	Ref. Dia. d	Tip Dia. d _a	Bore H7 d _j	Max. Bore H7 d _j	Hub Dia. BD	Backlash (mm)		I Inertia kgm ²	Mass kg
							j _{t,e} (max)	j _{t,i} (min)		
PSG1.25-18	18	22.50	25.00	6	8	15	0.128	-0.052	3.02 x 10 ⁻⁶	0.050
PSG1.25-19	19	23.75	26.25	6	8	15	0.128	-0.052	3.62 x 10 ⁻⁶	0.055
PSG1.25-20	20	25.00	27.50	6	8	15	0.128	-0.052	4.32 x 10 ⁻⁶	0.059
PSG1.25-21	21	26.25	28.75	8	12	20	0.128	-0.052	6.13 x 10 ⁻⁶	0.073
PSG1.25-22	22	27.50	30.00	8	12	20	0.128	-0.052	7.06 x 10 ⁻⁶	0.079
PSG1.25-23	23	28.75	31.25	8	12	20	0.128	-0.052	8.13 x 10 ⁻⁶	0.084
PSG1.25-24	24	30.00	32.50	8	12	22	0.128	-0.052	1.01 x 10 ⁻⁵	0.096
PSG1.25-25	25	31.25	33.75	8	12	22	0.129	-0.051	1.14 x 10 ⁻⁵	0.102
PSG1.25-26	26	32.50	35.00	8	12	22	0.129	-0.051	1.30 x 10 ⁻⁵	0.108
PSG1.25-27	27	33.75	36.25	8	12	22	0.129	-0.051	1.47 x 10 ⁻⁵	0.114
PSG1.25-28	28	35.00	37.50	8	15	25	0.129	-0.051	1.82 x 10 ⁻⁵	0.132
PSG1.25-29	29	36.25	38.75	8	15	25	0.129	-0.051	2.03 x 10 ⁻⁵	0.138
PSG1.25-30	30	37.50	40.00	8	15	25	0.129	-0.051	2.27 x 10 ⁻⁵	0.145
PSG1.25-32	32	40.00	42.50	8	15	25	0.129	-0.051	2.83 x 10 ⁻⁵	0.160
PSG1.25-35	35	43.75	46.25	10	18	30	0.129	-0.051	4.28 x 10 ⁻⁵	0.200
PSG1.25-38	38	47.50	50.00	10	18	30	0.129	-0.051	5.64 x 10 ⁻⁵	0.226
PSG1.25-40	40	50.00	52.50	10	18	30	0.129	-0.051	6.75 x 10 ⁻⁵	0.245
PSG1.25-42	42	52.50	55.00	10	18	30	0.171	-0.069	8.03 x 10 ⁻⁵	0.264
PSG1.25-45	45	56.25	58.75	10	18	30	0.171	-0.069	1.03 x 10 ⁻⁴	0.296
PSG1.25-48	48	60.00	62.50	10	25	40	0.171	-0.069	1.48 x 10 ⁻⁴	0.383
PSG1.25-50	50	62.50	65.00	10	25	40	0.171	-0.069	1.70 x 10 ⁻⁴	0.407
PSG1.25-52	52	65.00	67.50	10	25	40	0.171	-0.069	1.95 x 10 ⁻⁴	0.431
PSG1.25-55	55	68.75	71.25	10	25	40	0.171	-0.069	2.38 x 10 ⁻⁴	0.469
PSG1.25-58	58	72.50	75.00	10	25	40	0.171	-0.069	2.88 x 10 ⁻⁴	0.510
PSG1.25-60	60	75.00	77.50	10	30	50	0.171	-0.069	3.62 x 10 ⁻⁴	0.608
PSG1.25-62	62	77.50	80.00	10	30	50	0.171	-0.069	4.05 x 10 ⁻⁴	0.637
PSG1.25-65	65	81.25	83.75	10	30	50	0.173	-0.067	4.76 x 10 ⁻⁴	0.683
PSG1.25-68	68	85.00	87.50	10	30	50	0.173	-0.067	5.59 x 10 ⁻⁴	0.731
PSG1.25-70	70	87.50	90.00	10	30	50	0.173	-0.067	6.20 x 10 ⁻⁴	0.764
PSG1.25-72	72	90.00	92.50	10	30	50	0.173	-0.067	6.87 x 10 ⁻⁴	0.798
PSG1.25-75	75	93.75	96.25	10	35	60	0.173	-0.067	8.63 x 10 ⁻⁴	0.935
PSG1.25-78	78	97.50	100.00	10	35	60	0.173	-0.067	9.88 x 10 ⁻⁴	0.991
PSG1.25-80	80	100.00	102.50	10	35	60	0.173	-0.067	1.08 x 10 ⁻³	1.029
PSG1.25-82	82	102.50	105.00	10	35	60	0.173	-0.067	1.18 x 10 ⁻³	1.067
PSG1.25-85	85	106.25	108.75	10	35	60	0.173	-0.067	1.34 x 10 ⁻³	1.128
PSG1.25-90	90	112.50	115.00	10	40	65	0.173	-0.067	1.70 x 10 ⁻³	1.281
PSG1.25-95	95	118.75	121.25	10	40	65	0.173	-0.067	2.07 x 10 ⁻³	1.392
PSG1.25-100	100	125.00	127.50	14	40	65	0.175	-0.065	2.51 x 10 ⁻³	1.494
PSG1.25-110	110	137.50	140.00	14	40	70	0.227	-0.097	3.65 x 10 ⁻³	1.798
PSG1.25-120	120	150.00	152.50	14	40	70	0.227	-0.097	5.08 x 10 ⁻³	2.075

+44 (0)1246 455500
+44 (0)1246 455522

ondrives

sales@ondrives.com
www.ondrives.com

Product information updated 1st April 2011 and subject to change. Please contact Sales for the latest prices and availability.

PRECISION GEARS

PSG
1.25m_n

1.25 Module Spur Gear α 20° PA Quality Grade 7e25 DIN 3961/3967 (AGMA Q10)

Standard Part **PSG 1.25-50**
Modified Part **PSG 1.25-50 H 12 K T**

PSG - Precision Spur Gear
Quality Grade 7e25 DIN 3961/3967
Other Quality Grades available.
See page 291

m_n Module - Cut with DIN 867 1.25/0.20/1.0
Ref. Tooth Profile Topping WD = 2.25 x m_n

Number of Teeth z

Standard Material = 817M40T (28HRC)
H = 805M20 Case Hardened (58HRC)
S = 303 Stainless Steel
SL = 316 Stainless Steel

T = 1 x Tapped hole 2T = 2 x Tapped holes.
P = 1 x Pin Hole PT = 1 x Pin Hole thru.
All threads metric as standard,
refer to page 308 for sizes and prices.

K- Keyway supplied to
DIN 6885 - Js9 tolerance.
For prices see page 308

To specify different bore enter size required
Example: 12 = 12mm H7 etc
For prices see page 308

Quality Grades and Tolerances stated prior to heat treatment processes.
η Efficiency approx. 98%

Discounts: 6+ -5% 19+ -10%

817M40T (28HRC)			Case Hardened 805M20 (58HRC)#			Stainless 303			Stainless 316		
Part Number	T ₂ Nm n ₂ 100min ⁻¹	Price Each 1 - 5	Part Number	T ₂ Nm n ₂ 100min ⁻¹	Price Each 1 - 5	Part Number	T ₂ Nm n ₂ 100min ⁻¹	Price Each 1 - 5	Part Number	T ₂ Nm n ₂ 100min ⁻¹	Price Each 1 - 5
PSG1.25-18	3.29	£14.51	PSG1.25-18H	12.08	£23.95	PSG1.25-18S	1.98	£19.60	PSG1.25-18SL	1.54	£22.50
PSG1.25-19	3.48	£14.73	PSG1.25-19H	12.75	£24.30	PSG1.25-19S	2.09	£19.89	PSG1.25-19SL	1.62	£22.83
PSG1.25-20	4.63	£14.95	PSG1.25-20H	16.97	£24.67	PSG1.25-20S	2.78	£20.19	PSG1.25-20SL	2.16	£23.17
PSG1.25-21	4.86	£15.42	PSG1.25-21H	17.82	£25.45	PSG1.25-21S	2.92	£20.82	PSG1.25-21SL	2.27	£23.90
PSG1.25-22	5.09	£15.64	PSG1.25-22H	18.67	£25.81	PSG1.25-22S	3.05	£21.12	PSG1.25-22SL	2.38	£24.25
PSG1.25-23	5.32	£15.71	PSG1.25-23H	19.52	£25.93	PSG1.25-23S	3.19	£21.22	PSG1.25-23SL	2.48	£24.36
PSG1.25-24	5.55	£15.80	PSG1.25-24H	20.36	£26.07	PSG1.25-24S	3.33	£21.33	PSG1.25-24SL	2.59	£24.49
PSG1.25-25	5.79	£16.45	PSG1.25-25H	21.21	£27.16	PSG1.25-25S	3.47	£22.21	PSG1.25-25SL	2.70	£25.51
PSG1.25-26	7.08	£17.05	PSG1.25-26H	22.50	£28.12	PSG1.25-26S	4.25	£23.01	PSG1.25-26SL	3.30	£26.42
PSG1.25-27	7.35	£17.39	PSG1.25-27H	23.37	£28.70	PSG1.25-27S	4.41	£23.48	PSG1.25-27SL	3.43	£26.97
PSG1.25-28	7.62	£17.78	PSG1.25-28H	24.23	£29.35	PSG1.25-28S	4.57	£24.02	PSG1.25-28SL	3.56	£27.58
PSG1.25-29	7.90	£18.24	PSG1.25-29H	25.10	£30.12	PSG1.25-29S	4.74	£24.64	PSG1.25-29SL	3.68	£28.29
PSG1.25-30	8.98	£18.56	PSG1.25-30H	25.80	£30.62	PSG1.25-30S	5.39	£25.06	PSG1.25-30SL	4.19	£28.77
PSG1.25-32	9.58	£19.03	PSG1.25-32H	27.52	£31.41	PSG1.25-32S	5.75	£25.70	PSG1.25-32SL	4.47	£29.51
PSG1.25-35	10.48	£19.68	PSG1.25-35H	30.10	£32.48	PSG1.25-35S	6.29	£26.57	PSG1.25-35SL	4.89	£30.51
PSG1.25-38	11.38	£20.48	PSG1.25-38H	32.68	£33.79	PSG1.25-38S	6.83	£27.65	PSG1.25-38SL	5.31	£31.75
PSG1.25-40	15.31	£21.24	PSG1.25-40H	38.26	£35.04	PSG1.25-40S	9.18	£28.67	PSG1.25-40SL	7.14	£32.92
PSG1.25-42	16.07	£21.39	PSG1.25-42H	40.17	£35.30	PSG1.25-42S	9.64	£28.88	PSG1.25-42SL	7.50	£33.16
PSG1.25-45	17.22	£21.70	PSG1.25-45H	43.04	£35.81	PSG1.25-45S	10.33	£29.30	PSG1.25-45SL	8.04	£33.64
PSG1.25-48	18.37	£21.88	PSG1.25-48H	45.91	£36.12	PSG1.25-48S	11.02	£29.54	PSG1.25-48SL	8.57	£33.92
PSG1.25-50	22.69	£24.16	PSG1.25-50H	51.90	£39.86	PSG1.25-50S	13.61	£32.61	PSG1.25-50SL	10.59	£37.44
PSG1.25-52	23.60	£24.87	PSG1.25-52H	53.98	£41.04	PSG1.25-52S	14.16	£33.57	PSG1.25-52SL	11.01	£38.55
PSG1.25-55	24.96	£25.91	PSG1.25-55H	57.09	£42.75	PSG1.25-55S	14.97	£34.98	PSG1.25-55SL	11.65	£40.16
PSG1.25-58	26.32	£26.69	PSG1.25-58H	60.20	£44.04	PSG1.25-58S	15.79	£36.04	PSG1.25-58SL	12.28	£41.38
PSG1.25-60	32.40	£27.31	PSG1.25-60H	64.85	£45.06	PSG1.25-60S	19.44	£36.87	PSG1.25-60SL	15.12	£42.33
PSG1.25-62	33.48	£28.21	PSG1.25-62H	67.01	£46.54	PSG1.25-62S	20.09	£38.08	PSG1.25-62SL	15.62	£43.73
PSG1.25-65	35.10	£30.22	PSG1.25-65H	70.25	£49.88	PSG1.25-65S	21.06	£40.81	PSG1.25-65SL	16.38	£46.86
PSG1.25-68	36.72	£31.78	PSG1.25-68H	73.49	£52.44	PSG1.25-68S	22.03	£42.91	PSG1.25-68SL	17.14	£49.27
PSG1.25-70	37.80	£32.44	PSG1.25-70H	75.65	£53.53	PSG1.25-70S	22.68	£43.80	PSG1.25-70SL	17.64	£50.29
PSG1.25-72	38.88	£33.14	PSG1.25-72H	77.82	£54.69	PSG1.25-72S	23.33	£44.75	PSG1.25-72SL	18.14	£51.37
PSG1.25-75	40.50	£35.36	PSG1.25-75H	81.06	£58.34	PSG1.25-75S	24.30	£47.74	PSG1.25-75SL	18.90	£54.81
PSG1.25-78	42.12	£35.89	PSG1.25-78H	84.30	£59.23	PSG1.25-78S	25.27	£48.45	PSG1.25-78SL	19.66	£55.63
PSG1.25-80	55.30	£36.62	PSG1.25-80H	90.66	£60.43	PSG1.25-80S	33.18	£49.44	PSG1.25-80SL	25.81	£56.77
PSG1.25-82	56.68	£37.14	PSG1.25-82H	92.92	£61.28	PSG1.25-82S	34.01	£50.14	PSG1.25-82SL	26.45	£57.57
PSG1.25-85	58.75	£37.94	PSG1.25-85H	96.32	£62.61	PSG1.25-85S	35.25	£51.22	PSG1.25-85SL	27.42	£58.81
PSG1.25-90	62.21	£39.16	PSG1.25-90H	101.99	£64.62	PSG1.25-90S	37.33	£52.86	PSG1.25-90SL	29.03	£60.71
PSG1.25-95	65.67	£43.35	PSG1.25-95H	107.66	£71.53	PSG1.25-95S	39.40	£58.53	PSG1.25-95SL	30.64	£67.20
PSG1.25-100	74.20	£43.93	PSG1.25-100H	115.95	£72.49	PSG1.25-100S	50.00	£59.30	PSG1.25-100SL	38.89	£68.09
PSG1.25-110	77.92	£54.99	PSG1.25-110H	121.74	£90.75	PSG1.25-110S	52.51	£74.24	PSG1.25-110SL	40.84	£85.24
PSG1.25-120	81.63	£62.19	PSG1.25-120H	127.54	£102.61	PSG1.25-120S	55.01	£83.95	PSG1.25-120SL	42.78	£96.40

+44 (0)1246 455500
+44 (0)1246 455522

ondrives

sales@ondrives.com
www.ondrives.com

Product information updated 1st April 2011 and subject to change. Please contact Sales for the latest prices and availability.