

**PSG-HC**  
**PSG-HCK**  
**1.0m<sub>n</sub>**

# PRECISION GEARS

## 1.0 Module Skive Hobbed Spur Gear $\alpha$ 20° PA

Quality Grade 6e25 DIN 3961/3967 (AGMA Q11)

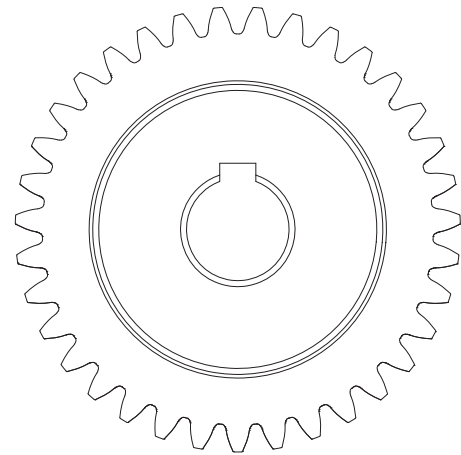
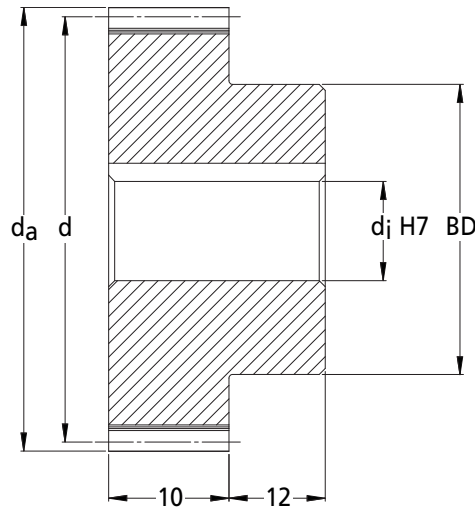

DIN 3967 Tooth Thickness tol.

Part Number	No. of Teeth z	Ref. Dia. d	Tip Dia. d <sub>a</sub>	Bore H7 d <sub>j</sub>	Max. Bore H7 d <sub>j</sub>	Hub Dia. BD	Keyway	Backlash (mm)		I Inertia kgm <sup>2</sup>	Mass kg
								j <sub>t,e</sub> (max)	j <sub>t,i</sub> (min)		
PSG1.0-18HC	18	18	20	5	8	15	-	0.127 - 0.053	1.30 x 10 <sup>-6</sup>	0.033	
PSG1.0-19HC	19	19	21	5	8	15	-	0.128 - 0.052	1.49 x 10 <sup>-6</sup>	0.035	
PSG1.0-20HC	20	20	22	5	8	15	-	0.128 - 0.052	1.72 x 10 <sup>-6</sup>	0.038	
PSG1.0-21HC	21	21	23	5	8	15	-	0.128 - 0.052	1.99 x 10 <sup>-6</sup>	0.040	
PSG1.0-22HC	22	22	24	5	8	15	-	0.128 - 0.052	2.29 x 10 <sup>-6</sup>	0.043	
PSG1.0-23HC	23	23	25	5	8	15	-	0.128 - 0.052	2.64 x 10 <sup>-6</sup>	0.045	
PSG1.0-24HCK	24	24	26	6	10	20	2	0.128 - 0.052	4.04 x 10 <sup>-6</sup>	0.060	
PSG1.0-25HCK	25	25	27	6	10	20	2	0.128 - 0.052	4.49 x 10 <sup>-6</sup>	0.063	
PSG1.0-26HCK	26	26	28	6	10	20	2	0.128 - 0.052	5.00 x 10 <sup>-6</sup>	0.066	
PSG1.0-27HCK	27	27	29	6	10	20	2	0.128 - 0.052	5.57 x 10 <sup>-6</sup>	0.069	
PSG1.0-28HCK	28	28	30	6	10	20	2	0.128 - 0.052	6.21 x 10 <sup>-6</sup>	0.073	
PSG1.0-29HCK	29	29	31	8	12	25	2	0.128 - 0.052	9.00 x 10 <sup>-6</sup>	0.089	
PSG1.0-30HCK	30	30	32	8	12	25	2	0.128 - 0.052	9.79 x 10 <sup>-6</sup>	0.092	
PSG1.0-32HCK	32	32	34	8	12	25	2	0.129 - 0.051	1.16 x 10 <sup>-5</sup>	0.100	
PSG1.0-35HCK	35	35	37	8	12	25	3	0.129 - 0.051	1.51 x 10 <sup>-5</sup>	0.112	
PSG1.0-38HCK	38	38	40	10	18	34	3	0.129 - 0.051	2.82 x 10 <sup>-5</sup>	0.160	
PSG1.0-40HCK	40	40	42	10	18	34	3	0.129 - 0.051	3.18 x 10 <sup>-5</sup>	0.170	
PSG1.0-42HCK	42	42	44	10	18	34	3	0.129 - 0.051	3.60 x 10 <sup>-5</sup>	0.180	
PSG1.0-45HCK	45	45	47	10	18	34	3	0.129 - 0.051	4.36 x 10 <sup>-5</sup>	0.196	
PSG1.0-48HCK	48	48	50	10	18	34	3	0.129 - 0.051	5.28 x 10 <sup>-5</sup>	0.213	
PSG1.0-50HCK	50	50	52	10	18	34	3	0.129 - 0.051	6.00 x 10 <sup>-5</sup>	0.225	
PSG1.0-52HCK	52	52	54	10	22	40	3	0.171 - 0.069	7.94 x 10 <sup>-5</sup>	0.270	
PSG1.0-55HCK	55	55	57	10	22	40	3	0.171 - 0.069	9.35 x 10 <sup>-5</sup>	0.290	
PSG1.0-58HCK	58	58	60	10	22	40	3	0.171 - 0.069	1.10 x 10 <sup>-4</sup>	0.311	
PSG1.0-60HCK	60	60	62	10	22	40	3	0.171 - 0.069	1.23 x 10 <sup>-4</sup>	0.325	
PSG1.0-62HCK	62	62	64	10	22	40	3	0.171 - 0.069	1.36 x 10 <sup>-4</sup>	0.340	
PSG1.0-65HCK	65	65	67	10	28	50	3	0.171 - 0.069	1.94 x 10 <sup>-4</sup>	0.430	
PSG1.0-68HCK	68	68	70	10	28	50	3	0.171 - 0.069	2.21 x 10 <sup>-4</sup>	0.455	
PSG1.0-70HCK	70	70	72	10	28	50	3	0.171 - 0.069	2.41 x 10 <sup>-4</sup>	0.472	
PSG1.0-72HCK	72	72	74	10	28	50	3	0.171 - 0.069	2.63 x 10 <sup>-4</sup>	0.489	
PSG1.0-75HCK	75	75	77	10	28	50	3	0.171 - 0.069	3.00 x 10 <sup>-4</sup>	0.516	
PSG1.0-78HCK	78	78	80	10	35	60	3	0.171 - 0.069	4.03 x 10 <sup>-4</sup>	0.626	
PSG1.0-80HCK	80	80	82	10	35	60	3	0.171 - 0.069	4.33 x 10 <sup>-4</sup>	0.645	
PSG1.0-82HCK	82	82	84	10	35	60	3	0.173 - 0.067	4.65 x 10 <sup>-4</sup>	0.665	
PSG1.0-85HCK	85	85	87	10	35	60	3	0.173 - 0.067	5.19 x 10 <sup>-4</sup>	0.696	
PSG1.0-90HCK	90	90	92	10	35	60	3	0.173 - 0.067	6.22 x 10 <sup>-4</sup>	0.750	
PSG1.0-95HCK	95	95	97	10	35	60	3	0.173 - 0.067	7.43 x 10 <sup>-4</sup>	0.807	
PSG1.0-100HCK	100	100	102	14	40	70	5	0.173 - 0.067	9.87 x 10 <sup>-4</sup>	0.950	
PSG1.0-110HCK	110	110	112	14	40	70	5	0.173 - 0.067	1.34 x 10 <sup>-3</sup>	1.079	
PSG1.0-120HCK	120	120	122	14	40	70	5	0.173 - 0.067	1.81 x 10 <sup>-3</sup>	1.220	

+44 (0)1246 455500  
+44 (0)1246 455522

**ondrives**

sales@ondrives.com  
www.ondrives.com

Product information updated 1st April 2011 and subject to change. Please contact Sales for the latest prices and availability.

# PRECISION GEARS

## 1.0 Module Skive Hobbed Spur Gear $\alpha$ 20° PA

Quality Grade 6e25 DIN 3961/3967 (AGMA Q11)

**PSG-HC**  
**PSG-HCK**  
**1.0m<sub>n</sub>**

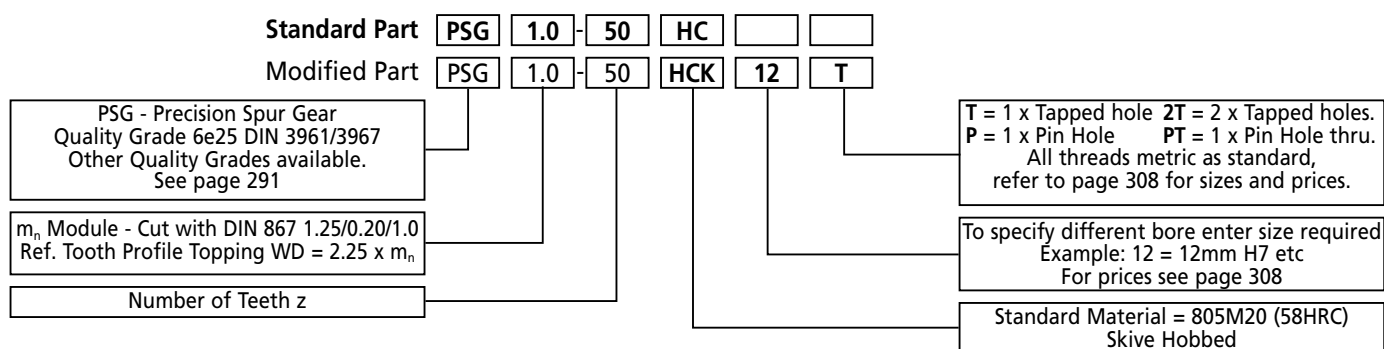

Standard bores less than 6mm supplied without keyway.

Quality Grades and Tolerances stated prior to heat treatment processes.

$\eta$  Efficiency approx. 98%

**Discounts: 6+ -5% 19+ -10%**

Part Number	Hard Cut T <sub>2</sub> Nm n <sub>2</sub> 100min <sup>-1</sup>	Price Each 1 - 5
PSG1.0-18HC	6.47	£30.63
PSG1.0-19HC	6.83	£31.10
PSG1.0-20HC	8.85	£32.11
PSG1.0-21HC	9.29	£32.31
PSG1.0-22HC	9.73	£32.78
PSG1.0-23HC	10.18	£32.91
PSG1.0-24HCK	10.62	£33.11
PSG1.0-25HCK	11.06	£34.49
PSG1.0-26HCK	11.52	£35.73
PSG1.0-27HCK	11.96	£36.46
PSG1.0-28HCK	12.41	£37.28
PSG1.0-29HCK	12.85	£38.25
PSG1.0-30HCK	13.21	£38.89
PSG1.0-32HCK	14.09	£39.88
PSG1.0-35HCK	15.41	£41.25
PSG1.0-38HCK	16.73	£42.93
PSG1.0-40HCK	19.59	£44.52
PSG1.0-42HCK	20.57	£44.85
PSG1.0-45HCK	22.04	£45.47
PSG1.0-48HCK	23.51	£45.85
PSG1.0-50HCK	26.57	£50.61
PSG1.0-52HCK	27.64	£52.12
PSG1.0-55HCK	29.23	£54.29
PSG1.0-58HCK	30.82	£55.93
PSG1.0-60HCK	33.20	£57.24
PSG1.0-62HCK	34.31	£59.11
PSG1.0-65HCK	35.97	£63.33
PSG1.0-68HCK	37.63	£66.61
PSG1.0-70HCK	38.73	£67.98
PSG1.0-72HCK	39.84	£69.46
PSG1.0-75HCK	41.50	£74.09
PSG1.0-78HCK	43.16	£75.23
PSG1.0-80HCK	46.42	£76.73
PSG1.0-82HCK	47.58	£77.83
PSG1.0-85HCK	49.32	£79.50
PSG1.0-90HCK	52.22	£82.05
PSG1.0-95HCK	55.12	£90.83
PSG1.0-100HCK	59.36	£92.04
PSG1.0-110HCK	65.30	£115.22
PSG1.0-120HCK	71.24	£130.29