

PSG-DL
PSG-PK
1.0m_n

PRECISION GEARS

1.0 Module Plastic Spur Gear α 20° PA

Quality Grade 8e25 DIN 3961/3967 (AGMA Q9)

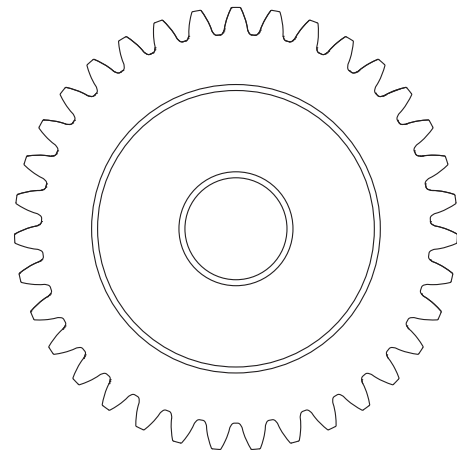
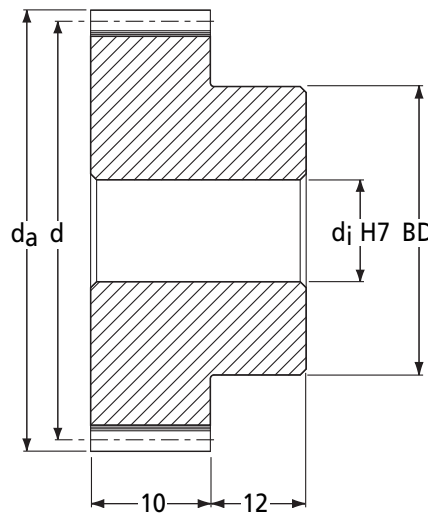

DIN 3967 Tooth Thickness tol.

Part Number	No. of Teeth z	Ref. Dia. d	Tip Dia. d _a	Bore H7 d _j	Max. Bore H7 d _j	Hub Dia. BD	Backlash (mm)		I Inertia kgm ² (Delrin)	Mass kg (Delrin)
							j _{t,e} (max)	j _{t,i} (min)		
PSG1.0-18DL	18	18	20	5	8	15	0.127	-0.053	2.33 x 10 ⁻⁷	0.006
PSG1.0-19DL	19	19	21	5	8	15	0.128	-0.052	2.68 x 10 ⁻⁷	0.006
PSG1.0-20DL	20	20	22	5	8	15	0.128	-0.052	3.09 x 10 ⁻⁷	0.007
PSG1.0-21DL	21	21	23	5	8	15	0.128	-0.052	3.57 x 10 ⁻⁷	0.007
PSG1.0-22DL	22	22	24	5	8	15	0.128	-0.052	4.12 x 10 ⁻⁷	0.008
PSG1.0-23DL	23	23	25	5	8	15	0.128	-0.052	4.75 x 10 ⁻⁷	0.008
PSG1.0-24DL	24	24	26	6	10	20	0.128	-0.052	7.26 x 10 ⁻⁷	0.011
PSG1.0-25DL	25	25	27	6	10	20	0.128	-0.052	8.07 x 10 ⁻⁷	0.011
PSG1.0-26DL	26	26	28	6	10	20	0.128	-0.052	8.98 x 10 ⁻⁷	0.012
PSG1.0-27DL	27	27	29	6	10	20	0.128	-0.052	1.00 x 10 ⁻⁶	0.012
PSG1.0-28DL	28	28	30	6	10	20	0.128	-0.052	1.12 x 10 ⁻⁶	0.013
PSG1.0-29DL	29	29	31	8	12	25	0.128	-0.052	1.62 x 10 ⁻⁶	0.016
PSG1.0-30DL	30	30	32	8	12	25	0.128	-0.052	1.76 x 10 ⁻⁶	0.017
PSG1.0-32DL	32	32	34	8	12	25	0.129	-0.051	2.09 x 10 ⁻⁶	0.018
PSG1.0-35DL	35	35	37	8	12	25	0.129	-0.051	2.71 x 10 ⁻⁶	0.020
PSG1.0-38DL	38	38	40	10	18	34	0.129	-0.051	5.06 x 10 ⁻⁶	0.029
PSG1.0-40DL	40	40	42	10	18	34	0.129	-0.051	5.71 x 10 ⁻⁶	0.030
PSG1.0-42DL	42	42	44	10	18	34	0.129	-0.051	6.47 x 10 ⁻⁶	0.032
PSG1.0-45DL	45	45	47	10	18	34	0.129	-0.051	7.82 x 10 ⁻⁶	0.035
PSG1.0-48DL	48	48	50	10	18	34	0.129	-0.051	9.48 x 10 ⁻⁶	0.038
PSG1.0-50DL	50	50	52	10	18	34	0.129	-0.051	1.08 x 10 ⁻⁵	0.040
PSG1.0-52DL	52	52	54	10	22	40	0.171	-0.069	1.43 x 10 ⁻⁵	0.049
PSG1.0-55DL	55	55	57	10	22	40	0.171	-0.069	1.68 x 10 ⁻⁵	0.052
PSG1.0-58DL	58	58	60	10	22	40	0.171	-0.069	1.98 x 10 ⁻⁵	0.056
PSG1.0-60DL	60	60	62	10	22	40	0.171	-0.069	2.20 x 10 ⁻⁵	0.058
PSG1.0-62DL	62	62	64	10	22	40	0.171	-0.069	2.45 x 10 ⁻⁵	0.061
PSG1.0-65DL	65	65	67	10	28	50	0.171	-0.069	3.49 x 10 ⁻⁵	0.077
PSG1.0-68DL	68	68	70	10	28	50	0.171	-0.069	3.97 x 10 ⁻⁵	0.082
PSG1.0-70DL	70	70	72	10	28	50	0.171	-0.069	4.33 x 10 ⁻⁵	0.085
PSG1.0-72DL	72	72	74	10	28	50	0.171	-0.069	4.73 x 10 ⁻⁵	0.088
PSG1.0-75DL	75	75	77	10	28	50	0.171	-0.069	5.38 x 10 ⁻⁵	0.093
PSG1.0-78DL	78	78	80	10	35	60	0.171	-0.069	7.23 x 10 ⁻⁵	0.112
PSG1.0-80DL	80	80	82	10	35	60	0.171	-0.069	7.78 x 10 ⁻⁵	0.116
PSG1.0-82DL	82	82	84	10	35	60	0.173	-0.067	8.36 x 10 ⁻⁵	0.119
PSG1.0-85DL	85	85	87	10	35	60	0.173	-0.067	9.32 x 10 ⁻⁵	0.125
PSG1.0-90DL	90	90	92	10	35	60	0.173	-0.067	1.12 x 10 ⁻⁴	0.135
PSG1.0-95DL	95	95	97	10	35	60	0.173	-0.067	1.33 x 10 ⁻⁴	0.145
PSG1.0-100DL	100	100	102	14	40	70	0.173	-0.067	1.77 x 10 ⁻⁴	0.171
PSG1.0-110DL	110	110	112	14	40	70	0.173	-0.067	2.41 x 10 ⁻⁴	0.194
PSG1.0-120DL	120	120	122	14	40	70	0.173	-0.067	3.25 x 10 ⁻⁴	0.219

+44 (0)1246 455500
+44 (0)1246 455522

ondrives

sales@ondrives.com
www.ondrives.com

Product information updated 1st April 2011 and subject to change. Please contact Sales for the latest prices and availability.

PRECISION GEARS

PSG-DL
PSG-PK
1.0m_n

1.0 Module Plastic Spur Gear α 20° PA

Quality Grade 8e25 DIN 3961/3967 (AGMA Q9)

Standard Part **PSG** **1.0** **50** **DL**
Modified Part **PSG** **1.0** **50** **PK** **12** **K** **T**

PSG - Precision Spur Gear
Quality Grade 8e25 DIN 3961/3967
Other Quality Grades available.
See page 291

m_n Module - Cut with DIN 867 1.25/0.20/1.0
Ref. Tooth Profile Topping WD = 2.25 x m_n

Number of Teeth z

DL = Delrin POM (White)
PK = PEEK GF30® (Light Brown)

T = 1 x Tapped hole 2T = 2 x Tapped holes.
P = 1 x Pin Hole PT = 1 x Pin Hole thru.
All threads metric as standard,
refer to page 308 for sizes and prices.

K- Keyway supplied to
DIN 6885 - Js9 tolerance.
For prices see page 308

To specify different bore enter size required
Example: 12 = 12mm H7 etc
For prices see page 308

η Efficiency approx. 98%

Discounts: 6+ -5% 19+ -10%

Part Number	Delrin POM		Part Number	PEEK GF30®	
	T ₂ Nm n ₂ 100min ⁻¹	Price Each 1 - 5		T ₂ Nm n ₂ 100min ⁻¹	Price Each 1 - 5
PSG1.0-18DL	0.92	£9.28	PSG1.0-18PK	1.04	£47.00
PSG1.0-19DL	1.03	£9.42	PSG1.0-19PK	1.17	£47.72
PSG1.0-20DL	1.16	£9.72	PSG1.0-20PK	1.31	£49.25
PSG1.0-21DL	1.29	£9.78	PSG1.0-21PK	1.46	£49.58
PSG1.0-22DL	1.43	£9.93	PSG1.0-22PK	1.61	£50.29
PSG1.0-23DL	1.54	£9.97	PSG1.0-23PK	1.78	£50.51
PSG1.0-24DL	1.63	£10.02	PSG1.0-24PK	1.96	£50.78
PSG1.0-25DL	1.73	£10.44	PSG1.0-25PK	2.15	£52.91
PSG1.0-26DL	1.83	£10.82	PSG1.0-26PK	2.34	£54.80
PSG1.0-27DL	1.92	£11.04	PSG1.0-27PK	2.55	£55.93
PSG1.0-28DL	2.02	£11.29	PSG1.0-28PK	2.75	£57.19
PSG1.0-29DL	2.11	£11.59	PSG1.0-29PK	2.88	£58.68
PSG1.0-30DL	2.21	£11.78	PSG1.0-30PK	3.02	£59.67
PSG1.0-32DL	2.40	£12.08	PSG1.0-32PK	3.27	£61.20
PSG1.0-35DL	2.68	£12.49	PSG1.0-35PK	3.66	£63.27
PSG1.0-38DL	2.98	£12.99	PSG1.0-38PK	4.06	£65.84
PSG1.0-40DL	3.18	£13.48	PSG1.0-40PK	4.33	£68.28
PSG1.0-42DL	3.37	£13.58	PSG1.0-42PK	4.59	£68.77
PSG1.0-45DL	3.66	£13.77	PSG1.0-45PK	4.99	£69.76
PSG1.0-48DL	3.96	£13.89	PSG1.0-48PK	5.40	£70.35
PSG1.0-50DL	4.17	£15.34	PSG1.0-50PK	5.68	£77.66
PSG1.0-52DL	4.36	£15.79	PSG1.0-52PK	5.95	£79.96
PSG1.0-55DL	4.66	£16.45	PSG1.0-55PK	6.36	£83.29
PSG1.0-58DL	4.97	£16.94	PSG1.0-58PK	6.77	£85.81
PSG1.0-60DL	5.17	£17.33	PSG1.0-60PK	7.05	£87.79
PSG1.0-62DL	5.36	£17.91	PSG1.0-62PK	7.31	£90.69
PSG1.0-65DL	5.66	£19.19	PSG1.0-65PK	7.72	£97.18
PSG1.0-68DL	5.95	£20.18	PSG1.0-68PK	8.12	£102.18
PSG1.0-70DL	6.15	£20.60	PSG1.0-70PK	8.39	£104.29
PSG1.0-72DL	6.35	£21.04	PSG1.0-72PK	8.66	£106.55
PSG1.0-75DL	6.65	£22.44	PSG1.0-75PK	9.07	£113.66
PSG1.0-78DL	6.96	£22.78	PSG1.0-78PK	9.49	£115.38
PSG1.0-80DL	7.16	£23.24	PSG1.0-80PK	9.76	£117.73
PSG1.0-82DL	7.37	£23.58	PSG1.0-82PK	10.05	£119.39
PSG1.0-85DL	7.67	£24.08	PSG1.0-85PK	10.45	£121.97
PSG1.0-90DL	8.17	£24.86	PSG1.0-90PK	11.14	£125.88
PSG1.0-95DL	8.67	£27.53	PSG1.0-95PK	11.83	£139.36
PSG1.0-100DL	9.17	£27.88	PSG1.0-100PK	12.50	£141.21
PSG1.0-110DL	10.16	£34.91	PSG1.0-110PK	13.86	£176.77
PSG1.0-120DL	11.16	£39.48	PSG1.0-120PK	15.21	£199.91

+44 (0)1246 455500
+44 (0)1246 455522

ondrives

sales@ondrives.com
www.ondrives.com

Product information updated 1st April 2011 and subject to change. Please contact Sales for the latest prices and availability.