

PSG
1.0m_n

PRECISION GEARS

1.0 Module Spur Gear α 20° PA Quality Grade 7e25 DIN 3961/3967 (AGMA Q10)

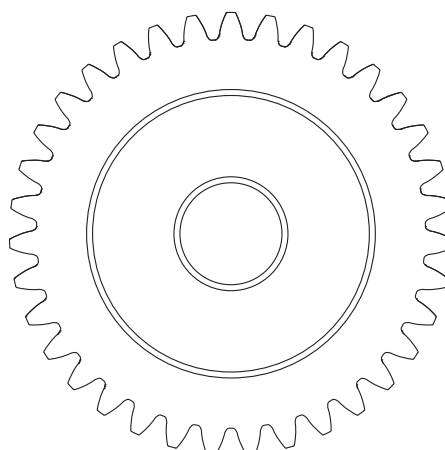
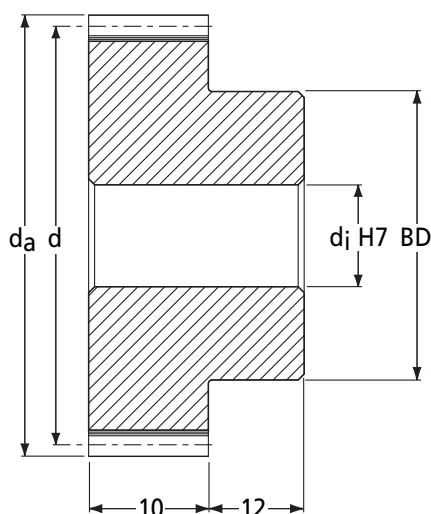

DIN 3967 Tooth Thickness tol.

Part Number	No. of Teeth <i>z</i>	Ref. Dia. <i>d</i>	Tip Dia. <i>d_a</i>	Bore H7 <i>d_j</i>	Max. Bore H7 <i>d_j</i>	Hub Dia. <i>BD</i>	Backlash (mm)		I Inertia <i>I</i> kgm ²	Mass <i>M</i> kg
							<i>j_{t,e}</i> (max)	<i>j_{t,i}</i> (min)		
PSG1.0-18	18	18	20	5	8	15	0.127	-0.053	1.30 x 10 ⁻⁶	0.033
PSG1.0-19	19	19	21	5	8	15	0.128	-0.052	1.49 x 10 ⁻⁶	0.035
PSG1.0-20	20	20	22	5	8	15	0.128	-0.052	1.72 x 10 ⁻⁶	0.038
PSG1.0-21	21	21	23	5	8	15	0.128	-0.052	1.99 x 10 ⁻⁶	0.040
PSG1.0-22	22	22	24	5	8	15	0.128	-0.052	2.29 x 10 ⁻⁶	0.043
PSG1.0-23	23	23	25	5	8	15	0.128	-0.052	2.64 x 10 ⁻⁶	0.045
PSG1.0-24	24	24	26	6	10	20	0.128	-0.052	4.04 x 10 ⁻⁶	0.060
PSG1.0-25	25	25	27	6	10	20	0.128	-0.052	4.49 x 10 ⁻⁶	0.063
PSG1.0-26	26	26	28	6	10	20	0.128	-0.052	5.00 x 10 ⁻⁶	0.066
PSG1.0-27	27	27	29	6	10	20	0.128	-0.052	5.57 x 10 ⁻⁶	0.069
PSG1.0-28	28	28	30	6	10	20	0.128	-0.052	6.21 x 10 ⁻⁶	0.073
PSG1.0-29	29	29	31	8	12	25	0.128	-0.052	9.00 x 10 ⁻⁶	0.089
PSG1.0-30	30	30	32	8	12	25	0.128	-0.052	9.79 x 10 ⁻⁶	0.092
PSG1.0-32	32	32	34	8	12	25	0.129	-0.051	1.16 x 10 ⁻⁵	0.100
PSG1.0-35	35	35	37	8	12	25	0.129	-0.051	1.51 x 10 ⁻⁵	0.112
PSG1.0-38	38	38	40	10	18	34	0.129	-0.051	2.82 x 10 ⁻⁵	0.160
PSG1.0-40	40	40	42	10	18	34	0.129	-0.051	3.18 x 10 ⁻⁵	0.170
PSG1.0-42	42	42	44	10	18	34	0.129	-0.051	3.60 x 10 ⁻⁵	0.180
PSG1.0-45	45	45	47	10	18	34	0.129	-0.051	4.36 x 10 ⁻⁵	0.196
PSG1.0-48	48	48	50	10	18	34	0.129	-0.051	5.28 x 10 ⁻⁵	0.213
PSG1.0-50	50	50	52	10	18	34	0.129	-0.051	6.00 x 10 ⁻⁵	0.225
PSG1.0-52	52	52	54	10	22	40	0.171	-0.069	7.94 x 10 ⁻⁵	0.270
PSG1.0-55	55	55	57	10	22	40	0.171	-0.069	9.35 x 10 ⁻⁵	0.290
PSG1.0-58	58	58	60	10	22	40	0.171	-0.069	1.10 x 10 ⁻⁴	0.311
PSG1.0-60	60	60	62	10	22	40	0.171	-0.069	1.23 x 10 ⁻⁴	0.325
PSG1.0-62	62	62	64	10	22	40	0.171	-0.069	1.36 x 10 ⁻⁴	0.340
PSG1.0-65	65	65	67	10	28	50	0.171	-0.069	1.94 x 10 ⁻⁴	0.430
PSG1.0-68	68	68	70	10	28	50	0.171	-0.069	2.21 x 10 ⁻⁴	0.455
PSG1.0-70	70	70	72	10	28	50	0.171	-0.069	2.41 x 10 ⁻⁴	0.472
PSG1.0-72	72	72	74	10	28	50	0.171	-0.069	2.63 x 10 ⁻⁴	0.489
PSG1.0-75	75	75	77	10	28	50	0.171	-0.069	3.00 x 10 ⁻⁴	0.516
PSG1.0-78	78	78	80	10	35	60	0.171	-0.069	4.03 x 10 ⁻⁴	0.626
PSG1.0-80	80	80	82	10	35	60	0.171	-0.069	4.33 x 10 ⁻⁴	0.645
PSG1.0-82	82	82	84	10	35	60	0.173	-0.067	4.65 x 10 ⁻⁴	0.665
PSG1.0-85	85	85	87	10	35	60	0.173	-0.067	5.19 x 10 ⁻⁴	0.696
PSG1.0-90	90	90	92	10	35	60	0.173	-0.067	6.22 x 10 ⁻⁴	0.750
PSG1.0-95	95	95	97	10	35	60	0.173	-0.067	7.43 x 10 ⁻⁴	0.807
PSG1.0-100	100	100	102	14	40	70	0.173	-0.067	9.87 x 10 ⁻⁴	0.950
PSG1.0-110	110	110	112	14	40	70	0.173	-0.067	1.34 x 10 ⁻³	1.079
PSG1.0-120	120	120	122	14	40	70	0.173	-0.067	1.81 x 10 ⁻³	1.220

+44 (0)1246 455500
+44 (0)1246 455522

ondrives

sales@ondrives.com
www.ondrives.com

Product information updated 1st April 2011 and subject to change. Please contact Sales for the latest prices and availability.

PRECISION GEARS

PSG
1.0m_n

1.0 Module Spur Gear α 20° PA

Quality Grade 7e25 DIN 3961/3967 (AGMA Q10)

Standard Part **PSG 1.0 - 50**
Modified Part **PSG 1.0 - 50 H 12 K T**

PSG - Precision Spur Gear
Quality Grade 7e25 DIN 3961/3967
Other Quality Grades available.
See page 291

m_n Module - Cut with DIN 867 1.25/0.20/1.0
Ref. Tooth Profile Topping WD = 2.25 x m_n

Number of Teeth z

Standard Material = 817M40T (28HRC)
H = 805M20 Case Hardened (58HRC)
S = 303 Stainless Steel
SL = 316 Stainless Steel

T = 1 x Tapped hole 2T = 2 x Tapped holes.
P = 1 x Pin Hole PT = 1 x Pin Hole thru.
All threads metric as standard,
refer to page 308 for sizes and prices.

K- Keyway supplied to
DIN 6885 - Js9 tolerance.
For prices see page 308

To specify different bore enter size required
Example: 12 = 12mm H7 etc
For prices see page 308

Quality Grades and Tolerances stated prior to heat treatment processes.
η Efficiency approx. 98%

Discounts: 6+ -5% 19+ -10%

817M40T (28HRC)			Case Hardened 805M20 (58HRC)#			Stainless 303			Stainless 316		
Part Number	T ₂ Nm n ₂ 100min ⁻¹	Price Each 1 - 5	Part Number	T ₂ Nm n ₂ 100min ⁻¹	Price Each 1 - 5	Part Number	T ₂ Nm n ₂ 100min ⁻¹	Price Each 1 - 5	Part Number	T ₂ Nm n ₂ 100min ⁻¹	Price Each 1 - 5
PSG1.0-18	1.76	£11.60	PSG1.0-18H	6.47	£19.15	PSG1.0-18S	1.06	£15.66	PSG1.0-18SL	0.82	£17.99
PSG1.0-19	1.86	£11.78	PSG1.0-19H	6.83	£19.43	PSG1.0-19S	1.12	£15.90	PSG1.0-19SL	0.87	£18.27
PSG1.0-20	2.48	£12.15	PSG1.0-20H	8.85	£20.07	PSG1.0-20S	1.49	£16.42	PSG1.0-20SL	1.16	£18.85
PSG1.0-21	2.60	£12.24	PSG1.0-21H	9.29	£20.19	PSG1.0-21S	1.56	£16.52	PSG1.0-21SL	1.21	£18.97
PSG1.0-22	2.73	£12.41	PSG1.0-22H	9.73	£20.48	PSG1.0-22S	1.64	£16.76	PSG1.0-22SL	1.27	£19.24
PSG1.0-23	2.85	£12.47	PSG1.0-23H	10.18	£20.56	PSG1.0-23S	1.71	£16.83	PSG1.0-23SL	1.33	£19.33
PSG1.0-24	2.97	£12.53	PSG1.0-24H	10.62	£20.69	PSG1.0-24S	1.78	£16.93	PSG1.0-24SL	1.39	£19.44
PSG1.0-25	3.10	£13.06	PSG1.0-25H	11.06	£21.55	PSG1.0-25S	1.86	£17.64	PSG1.0-25SL	1.45	£20.25
PSG1.0-26	3.79	£13.52	PSG1.0-26H	11.52	£22.33	PSG1.0-26S	2.27	£18.27	PSG1.0-26SL	1.77	£20.97
PSG1.0-27	3.94	£13.80	PSG1.0-27H	11.96	£22.78	PSG1.0-27S	2.36	£18.64	PSG1.0-27SL	1.84	£21.40
PSG1.0-28	4.08	£14.12	PSG1.0-28H	12.41	£23.29	PSG1.0-28S	2.45	£19.05	PSG1.0-28SL	1.90	£21.89
PSG1.0-29	4.23	£14.49	PSG1.0-29H	12.85	£23.89	PSG1.0-29S	2.54	£19.56	PSG1.0-29SL	1.97	£22.45
PSG1.0-30	4.81	£14.73	PSG1.0-30H	13.21	£24.30	PSG1.0-30S	2.89	£19.88	PSG1.0-30SL	2.24	£22.82
PSG1.0-32	5.13	£15.10	PSG1.0-32H	14.09	£24.92	PSG1.0-32S	3.08	£20.39	PSG1.0-32SL	2.39	£23.41
PSG1.0-35	5.61	£15.62	PSG1.0-35H	15.41	£25.78	PSG1.0-35S	3.37	£21.09	PSG1.0-35SL	2.62	£24.22
PSG1.0-38	6.09	£16.25	PSG1.0-38H	16.73	£26.82	PSG1.0-38S	3.66	£21.95	PSG1.0-38SL	2.84	£25.20
PSG1.0-40	8.19	£16.85	PSG1.0-40H	19.59	£27.82	PSG1.0-40S	4.92	£22.75	PSG1.0-40SL	3.82	£26.12
PSG1.0-42	8.60	£16.97	PSG1.0-42H	20.57	£28.03	PSG1.0-42S	5.16	£22.93	PSG1.0-42SL	4.02	£26.32
PSG1.0-45	9.22	£17.22	PSG1.0-45H	22.04	£28.42	PSG1.0-45S	5.53	£23.25	PSG1.0-45SL	4.30	£26.71
PSG1.0-48	9.83	£17.36	PSG1.0-48H	23.51	£28.65	PSG1.0-48S	5.90	£23.44	PSG1.0-48SL	4.59	£26.92
PSG1.0-50	12.15	£19.17	PSG1.0-50H	26.57	£31.62	PSG1.0-50S	7.29	£25.87	PSG1.0-50SL	5.67	£29.71
PSG1.0-52	12.63	£19.74	PSG1.0-52H	27.64	£32.57	PSG1.0-52S	7.58	£26.64	PSG1.0-52SL	5.90	£30.58
PSG1.0-55	13.36	£20.55	PSG1.0-55H	29.23	£33.92	PSG1.0-55S	8.02	£27.76	PSG1.0-55SL	6.24	£31.86
PSG1.0-58	14.09	£21.18	PSG1.0-58H	30.82	£34.95	PSG1.0-58S	8.45	£28.60	PSG1.0-58SL	6.58	£32.84
PSG1.0-60	17.35	£21.67	PSG1.0-60H	33.20	£35.77	PSG1.0-60S	10.41	£29.26	PSG1.0-60SL	8.09	£33.61
PSG1.0-62	17.92	£22.38	PSG1.0-62H	34.31	£36.94	PSG1.0-62S	10.75	£30.21	PSG1.0-62SL	8.36	£34.71
PSG1.0-65	18.79	£23.99	PSG1.0-65H	35.97	£39.58	PSG1.0-65S	11.27	£32.38	PSG1.0-65SL	8.77	£37.18
PSG1.0-68	19.66	£25.23	PSG1.0-68H	37.63	£41.63	PSG1.0-68S	11.79	£34.06	PSG1.0-68SL	9.17	£39.11
PSG1.0-70	20.24	£25.74	PSG1.0-70H	38.73	£42.49	PSG1.0-70S	12.14	£34.76	PSG1.0-70SL	9.44	£39.92
PSG1.0-72	20.81	£26.30	PSG1.0-72H	39.84	£43.41	PSG1.0-72S	12.49	£35.52	PSG1.0-72SL	9.71	£40.78
PSG1.0-75	21.68	£28.06	PSG1.0-75H	41.50	£46.30	PSG1.0-75S	13.01	£37.88	PSG1.0-75SL	10.12	£43.50
PSG1.0-78	22.55	£28.48	PSG1.0-78H	43.16	£47.01	PSG1.0-78S	13.53	£38.47	PSG1.0-78SL	10.52	£44.17
PSG1.0-80	29.61	£29.06	PSG1.0-80H	46.42	£47.95	PSG1.0-80S	17.76	£39.23	PSG1.0-80SL	13.82	£45.04
PSG1.0-82	30.35	£29.47	PSG1.0-82H	47.58	£48.64	PSG1.0-82S	18.21	£39.80	PSG1.0-82SL	14.16	£45.70
PSG1.0-85	31.46	£30.11	PSG1.0-85H	49.32	£49.68	PSG1.0-85S	18.87	£40.66	PSG1.0-85SL	14.68	£46.68
PSG1.0-90	33.31	£31.08	PSG1.0-90H	52.22	£51.28	PSG1.0-90S	19.98	£41.96	PSG1.0-90SL	15.54	£48.17
PSG1.0-95	35.16	£34.40	PSG1.0-95H	55.12	£56.77	PSG1.0-95S	21.09	£46.45	PSG1.0-95SL	16.41	£53.32
PSG1.0-100	37.99	£34.86	PSG1.0-100H	59.36	£57.52	PSG1.0-100S	23.75	£47.06	PSG1.0-100SL	18.76	£54.04
PSG1.0-110	41.79	£43.64	PSG1.0-110H	65.30	£72.01	PSG1.0-110S	26.12	£58.91	PSG1.0-110SL	20.63	£67.64
PSG1.0-120	45.59	£49.36	PSG1.0-120H	71.24	£81.43	PSG1.0-120S	28.49	£66.63	PSG1.0-120SL	22.51	£76.50

+44 (0)1246 455500
+44 (0)1246 455522

ondrives

sales@ondrives.com
www.ondrives.com

Product information updated 1st April 2011 and subject to change. Please contact Sales for the latest prices and availability.