

**PSG-DL**  
**PSG-PK**  
**0.8m<sub>n</sub>**

# PRECISION GEARS

## 0.8 Module Plastic Spur Gear α 20° PA

Quality Grade 8e DIN 3961/58405 (AGMA Q9)

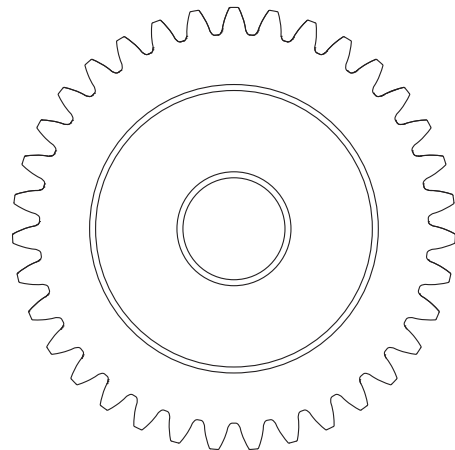
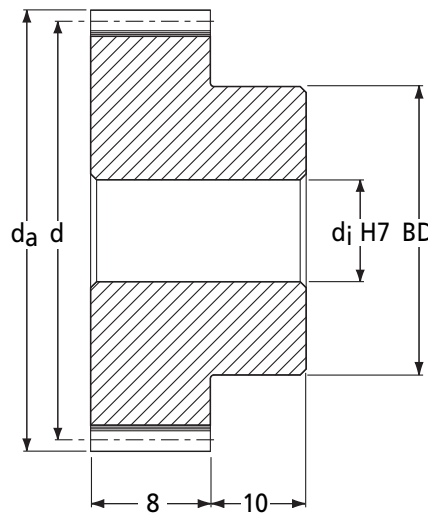

DIN 58405 Tooth Thickness tol.

Part Number	No. of Teeth z	Ref. Dia. d	Tip Dia. d <sub>a</sub>	Bore H7 d <sub>j</sub>	Max. Bore H7 d <sub>j</sub>	Hub Dia. BD	Backlash (mm)		I Inertia kgm <sup>2</sup> (Delrin)	Mass kg (Delrin)
							j <sub>t,e</sub> (max)	j <sub>t,i</sub> (min)		
PSG0.8-18DL	18	14.4	16.0	5	6	11	0.132 - 0.070	6.81 x 10 <sup>-8</sup>	0.003	
PSG0.8-19DL	19	15.2	16.8	5	6	11	0.132 - 0.070	7.96 x 10 <sup>-8</sup>	0.003	
PSG0.8-20DL	20	16.0	17.6	5	6	11	0.132 - 0.070	9.31 x 10 <sup>-8</sup>	0.003	
PSG0.8-21DL	21	16.8	18.4	5	6	12	0.132 - 0.070	1.17 x 10 <sup>-7</sup>	0.004	
PSG0.8-22DL	22	17.6	19.2	5	6	12	0.132 - 0.070	1.35 x 10 <sup>-7</sup>	0.004	
PSG0.8-23DL	23	18.4	20.0	5	6	12	0.133 - 0.069	1.56 x 10 <sup>-7</sup>	0.004	
PSG0.8-24DL	24	19.2	20.8	6	8	14	0.133 - 0.069	2.02 x 10 <sup>-7</sup>	0.005	
PSG0.8-25DL	25	20.0	21.6	6	8	14	0.133 - 0.069	2.29 x 10 <sup>-7</sup>	0.005	
PSG0.8-26DL	26	20.8	22.4	6	8	14	0.133 - 0.069	2.59 x 10 <sup>-7</sup>	0.005	
PSG0.8-27DL	27	21.6	23.2	6	8	14	0.133 - 0.069	2.92 x 10 <sup>-7</sup>	0.006	
PSG0.8-28DL	28	22.4	24.0	8	10	18	0.133 - 0.069	4.15 x 10 <sup>-7</sup>	0.007	
PSG0.8-29DL	29	23.2	24.8	8	10	18	0.133 - 0.069	4.56 x 10 <sup>-7</sup>	0.007	
PSG0.8-30DL	30	24.0	25.6	8	10	18	0.133 - 0.069	5.03 x 10 <sup>-7</sup>	0.007	
PSG0.8-32DL	32	25.6	27.2	8	10	18	0.148 - 0.075	6.10 x 10 <sup>-7</sup>	0.008	
PSG0.8-35DL	35	28.0	29.6	10	12	20	0.148 - 0.075	8.75 x 10 <sup>-7</sup>	0.009	
PSG0.8-38DL	38	30.4	32.0	10	12	20	0.150 - 0.074	1.14 x 10 <sup>-6</sup>	0.011	
PSG0.8-40DL	40	32.0	33.6	10	12	20	0.150 - 0.074	1.35 x 10 <sup>-6</sup>	0.011	
PSG0.8-42DL	42	33.6	35.2	10	12	20	0.150 - 0.074	1.60 x 10 <sup>-6</sup>	0.012	
PSG0.8-45DL	45	36.0	37.6	10	12	20	0.150 - 0.074	2.04 x 10 <sup>-6</sup>	0.014	
PSG0.8-48DL	48	38.4	40.0	10	18	30	0.150 - 0.074	3.49 x 10 <sup>-6</sup>	0.021	
PSG0.8-50DL	50	40.0	41.6	10	18	30	0.150 - 0.074	3.91 x 10 <sup>-6</sup>	0.022	
PSG0.8-52DL	52	41.6	43.2	10	18	30	0.150 - 0.074	4.39 x 10 <sup>-6</sup>	0.023	
PSG0.8-55DL	55	44.0	45.6	10	18	30	0.150 - 0.074	5.21 x 10 <sup>-6</sup>	0.025	
PSG0.8-58DL	58	46.4	48.0	10	18	30	0.150 - 0.074	6.19 x 10 <sup>-6</sup>	0.027	
PSG0.8-60DL	60	48.0	49.6	10	25	40	0.150 - 0.074	9.35 x 10 <sup>-6</sup>	0.036	
PSG0.8-62DL	62	49.6	51.2	10	25	40	0.150 - 0.074	1.02 x 10 <sup>-5</sup>	0.037	
PSG0.8-65DL	65	52.0	53.6	10	25	40	0.171 - 0.085	1.15 x 10 <sup>-5</sup>	0.040	
PSG0.8-68DL	68	54.4	56.0	10	25	40	0.171 - 0.085	1.31 x 10 <sup>-5</sup>	0.042	
PSG0.8-70DL	70	56.0	57.6	10	25	40	0.171 - 0.085	1.43 x 10 <sup>-5</sup>	0.043	
PSG0.8-72DL	72	57.6	59.2	10	25	40	0.171 - 0.085	1.56 x 10 <sup>-5</sup>	0.045	
PSG0.8-75DL	75	60.0	61.6	10	30	50	0.171 - 0.085	2.29 x 10 <sup>-5</sup>	0.057	
PSG0.8-78DL	78	62.4	64.0	10	30	50	0.171 - 0.085	2.53 x 10 <sup>-5</sup>	0.060	
PSG0.8-80DL	80	64.0	65.6	10	30	50	0.171 - 0.085	2.71 x 10 <sup>-5</sup>	0.062	
PSG0.8-82DL	82	65.6	67.2	10	30	50	0.171 - 0.085	2.90 x 10 <sup>-5</sup>	0.064	
PSG0.8-85DL	85	68.0	69.6	10	30	50	0.171 - 0.085	3.21 x 10 <sup>-5</sup>	0.066	
PSG0.8-90DL	90	72.0	73.6	10	40	65	0.171 - 0.085	5.42 x 10 <sup>-5</sup>	0.090	
PSG0.8-95DL	95	76.0	77.6	10	40	65	0.171 - 0.085	6.14 x 10 <sup>-5</sup>	0.096	
PSG0.8-100DL	100	80.0	81.6	14	40	65	0.171 - 0.085	6.97 x 10 <sup>-5</sup>	0.099	
PSG0.8-110DL	110	88.0	89.6	14	40	70	0.172 - 0.083	9.91 x 10 <sup>-5</sup>	0.119	
PSG0.8-120DL	120	96.0	97.6	14	40	70	0.172 - 0.083	1.27 x 10 <sup>-4</sup>	0.132	

+44 (0)1246 455500  
+44 (0)1246 455522

**ondrives**

sales@ondrives.com  
www.ondrives.com

Product information updated 1st April 2011 and subject to change. Please contact Sales for the latest prices and availability.

# PRECISION GEARS

**PSG-DL**  
**PSG-PK**  
**0.8m<sub>n</sub>**

## 0.8 Module Plastic Spur Gear α 20° PA

Quality Grade 8e DIN 3961/58405 (AGMA Q9)

Standard Part **PSG** **0.8** **50** **DL**     
Modified Part **PSG** **0.8** **50** **PK** **12** **K** **T**

PSG - Precision Spur Gear  
Quality Grade 8e DIN 3961/58405  
Other Quality Grades available.  
See page 291

m<sub>n</sub> Module - Cut with DIN 867 1.25/0.20/1.0  
Ref. Tooth Profile Topping WD = 2.25 x m<sub>n</sub>

Number of Teeth z

DL = Delrin POM (White)  
PK = PEEK GF30® (Light Brown)

T = 1 x Tapped hole 2T = 2 x Tapped holes.  
P = 1 x Pin Hole PT = 1 x Pin Hole thru.  
All threads metric as standard,  
refer to page 308 for sizes and prices.

K- Keyway supplied to  
DIN 6885 - Js9 tolerance.  
For prices see page 308

To specify different bore enter size required  
Example: 12 = 12mm H7 etc  
For prices see page 308

η Efficiency approx. 98%

**Discounts: 6+ -5% 19+ -10%**

Part Number	Delrin POM		Part Number	PEEK GF30®	
	T <sub>2</sub> Nm n <sub>2</sub> 100min <sup>-1</sup>	Price Each 1 - 5		T <sub>2</sub> Nm n <sub>2</sub> 100min <sup>-1</sup>	Price Each 1 - 5
PSG0.8-18DL	0.59	£8.74	PSG0.8-18PK	0.70	£44.32
PSG0.8-19DL	0.64	£8.88	PSG0.8-19PK	0.78	£44.99
PSG0.8-20DL	0.69	£9.01	PSG0.8-20PK	0.88	£45.66
PSG0.8-21DL	0.74	£9.30	PSG0.8-21PK	0.98	£47.10
PSG0.8-22DL	0.79	£9.43	PSG0.8-22PK	1.08	£47.78
PSG0.8-23DL	0.84	£9.48	PSG0.8-23PK	1.15	£47.99
PSG0.8-24DL	0.89	£9.52	PSG0.8-24PK	1.22	£48.25
PSG0.8-25DL	0.95	£9.92	PSG0.8-25PK	1.29	£50.26
PSG0.8-26DL	1.00	£10.27	PSG0.8-26PK	1.36	£52.06
PSG0.8-27DL	1.05	£10.48	PSG0.8-27PK	1.43	£53.14
PSG0.8-28DL	1.10	£10.73	PSG0.8-28PK	1.50	£54.33
PSG0.8-29DL	1.16	£11.00	PSG0.8-29PK	1.58	£55.75
PSG0.8-30DL	1.21	£11.19	PSG0.8-30PK	1.65	£56.68
PSG0.8-32DL	1.31	£11.48	PSG0.8-32PK	1.79	£58.14
PSG0.8-35DL	1.47	£11.87	PSG0.8-35PK	2.00	£60.11
PSG0.8-38DL	1.63	£12.34	PSG0.8-38PK	2.22	£62.55
PSG0.8-40DL	1.74	£12.81	PSG0.8-40PK	2.37	£64.86
PSG0.8-42DL	1.84	£12.90	PSG0.8-42PK	2.51	£65.34
PSG0.8-45DL	2.01	£13.09	PSG0.8-45PK	2.73	£66.28
PSG0.8-48DL	2.17	£13.19	PSG0.8-48PK	2.96	£66.83
PSG0.8-50DL	2.28	£14.57	PSG0.8-50PK	3.11	£73.78
PSG0.8-52DL	2.39	£15.00	PSG0.8-52PK	3.26	£75.96
PSG0.8-55DL	2.55	£15.62	PSG0.8-55PK	3.48	£79.12
PSG0.8-58DL	2.72	£16.09	PSG0.8-58PK	3.71	£81.52
PSG0.8-60DL	2.83	£16.47	PSG0.8-60PK	3.86	£83.40
PSG0.8-62DL	2.94	£17.01	PSG0.8-62PK	4.01	£86.15
PSG0.8-65DL	3.10	£18.22	PSG0.8-65PK	4.22	£92.32
PSG0.8-68DL	3.26	£19.17	PSG0.8-68PK	4.45	£97.07
PSG0.8-70DL	3.37	£19.57	PSG0.8-70PK	4.59	£99.08
PSG0.8-72DL	3.48	£19.99	PSG0.8-72PK	4.74	£101.22
PSG0.8-75DL	3.64	£21.32	PSG0.8-75PK	4.97	£107.98
PSG0.8-78DL	3.81	£21.65	PSG0.8-78PK	5.19	£109.61
PSG0.8-80DL	3.92	£22.09	PSG0.8-80PK	5.35	£111.84
PSG0.8-82DL	4.03	£22.40	PSG0.8-82PK	5.50	£113.42
PSG0.8-85DL	4.20	£22.87	PSG0.8-85PK	5.72	£115.86
PSG0.8-90DL	4.47	£23.62	PSG0.8-90PK	6.10	£119.59
PSG0.8-95DL	4.75	£26.14	PSG0.8-95PK	6.48	£132.39
PSG0.8-100DL	5.02	£26.49	PSG0.8-100PK	6.85	£134.15
PSG0.8-110DL	5.56	£33.16	PSG0.8-110PK	7.59	£167.94
PSG0.8-120DL	6.11	£37.50	PSG0.8-120PK	8.33	£189.91

+44 (0)1246 455500  
+44 (0)1246 455522

**ondrives**

sales@ondrives.com  
www.ondrives.com

Product information updated 1st April 2011 and subject to change. Please contact Sales for the latest prices and availability.