

PSG
0.8m_n

PRECISION GEARS

0.8 Module Spur Gear α 20° PA

Quality Grade 7e DIN 3961/58405 (AGMA Q10)

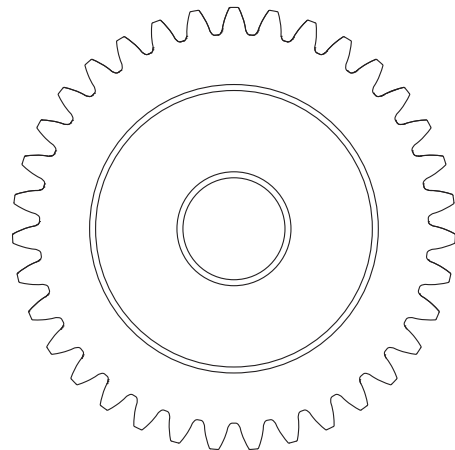
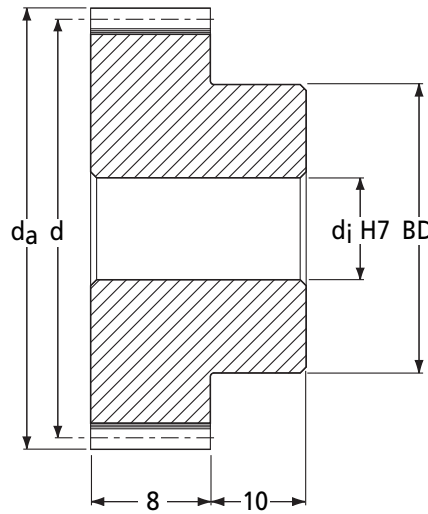
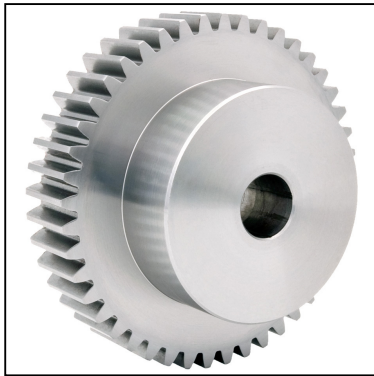

DIN 58405 Tooth Thickness tol.

Part Number	No. of Teeth z	Ref. Dia. d	Tip Dia. d _a	Bore H7 d _j	Max. Bore H7 d _j	Hub Dia. BD	Backlash (mm)		I Inertia kgm ²	Mass kg
							j _{t,e} (max)	j _{t,i} (min)		
PSG0.8-18	18	14.4	16.0	5	6	11	0.096	-0.047	3.79 x 10 ⁻⁷	0.015
PSG0.8-19	19	15.2	16.8	5	6	11	0.096	-0.047	4.43 x 10 ⁻⁷	0.016
PSG0.8-20	20	16.0	17.6	5	6	11	0.096	-0.047	5.18 x 10 ⁻⁷	0.017
PSG0.8-21	21	16.8	18.4	5	6	12	0.096	-0.047	6.52 x 10 ⁻⁷	0.020
PSG0.8-22	22	17.6	19.2	5	6	12	0.096	-0.047	7.53 x 10 ⁻⁷	0.021
PSG0.8-23	23	18.4	20.0	5	6	12	0.097	-0.046	8.67 x 10 ⁻⁷	0.023
PSG0.8-24	24	19.2	20.8	6	8	14	0.097	-0.046	1.12 x 10 ⁻⁶	0.026
PSG0.8-25	25	20.0	21.6	6	8	14	0.097	-0.046	1.27 x 10 ⁻⁶	0.028
PSG0.8-26	26	20.8	22.4	6	8	14	0.097	-0.046	1.44 x 10 ⁻⁶	0.029
PSG0.8-27	27	21.6	23.2	6	8	14	0.097	-0.046	1.63 x 10 ⁻⁶	0.031
PSG0.8-28	28	22.4	24.0	8	10	18	0.097	-0.046	2.31 x 10 ⁻⁶	0.037
PSG0.8-29	29	23.2	24.8	8	10	18	0.097	-0.046	2.54 x 10 ⁻⁶	0.039
PSG0.8-30	30	24.0	25.6	8	10	18	0.097	-0.046	2.80 x 10 ⁻⁶	0.041
PSG0.8-32	32	25.6	27.2	8	10	18	0.108	-0.052	3.40 x 10 ⁻⁶	0.045
PSG0.8-35	35	28.0	29.6	10	12	20	0.108	-0.052	4.87 x 10 ⁻⁶	0.052
PSG0.8-38	38	30.4	32.0	10	12	20	0.109	-0.050	6.33 x 10 ⁻⁶	0.059
PSG0.8-40	40	32.0	33.6	10	12	20	0.109	-0.050	7.52 x 10 ⁻⁶	0.064
PSG0.8-42	42	33.6	35.2	10	12	20	0.109	-0.050	8.90 x 10 ⁻⁶	0.069
PSG0.8-45	45	36.0	37.6	10	12	20	0.109	-0.050	1.14 x 10 ⁻⁵	0.077
PSG0.8-48	48	38.4	40.0	10	18	30	0.109	-0.050	1.94 x 10 ⁻⁵	0.117
PSG0.8-50	50	40.0	41.6	10	18	30	0.109	-0.050	2.18 x 10 ⁻⁵	0.123
PSG0.8-52	52	41.6	43.2	10	18	30	0.109	-0.050	2.44 x 10 ⁻⁵	0.129
PSG0.8-55	55	44.0	45.6	10	18	30	0.109	-0.050	2.90 x 10 ⁻⁵	0.139
PSG0.8-58	58	46.4	48.0	10	18	30	0.109	-0.050	3.44 x 10 ⁻⁵	0.150
PSG0.8-60	60	48.0	49.6	10	25	40	0.109	-0.050	5.21 x 10 ⁻⁵	0.200
PSG0.8-62	62	49.6	51.2	10	25	40	0.109	-0.050	5.66 x 10 ⁻⁵	0.208
PSG0.8-65	65	52.0	53.6	10	25	40	0.122	-0.055	6.43 x 10 ⁻⁵	0.220
PSG0.8-68	68	54.4	56.0	10	25	40	0.122	-0.055	7.31 x 10 ⁻⁵	0.233
PSG0.8-70	70	56.0	57.6	10	25	40	0.122	-0.055	7.97 x 10 ⁻⁵	0.241
PSG0.8-72	72	57.6	59.2	10	25	40	0.122	-0.055	8.69 x 10 ⁻⁵	0.250
PSG0.8-75	75	60.0	61.6	10	30	50	0.122	-0.055	1.27 x 10 ⁻⁴	0.320
PSG0.8-78	78	62.4	64.0	10	30	50	0.122	-0.055	1.41 x 10 ⁻⁴	0.334
PSG0.8-80	80	64.0	65.6	10	30	50	0.122	-0.055	1.51 x 10 ⁻⁴	0.344
PSG0.8-82	82	65.6	67.2	10	30	50	0.122	-0.055	1.61 x 10 ⁻⁴	0.354
PSG0.8-85	85	68.0	69.6	10	30	50	0.122	-0.055	1.79 x 10 ⁻⁴	0.370
PSG0.8-90	90	72.0	73.6	10	40	65	0.122	-0.055	3.02 x 10 ⁻⁴	0.504
PSG0.8-95	95	76.0	77.6	10	40	65	0.122	-0.055	3.42 x 10 ⁻⁴	0.533
PSG0.8-100	100	80.0	81.6	14	40	65	0.122	-0.055	3.88 x 10 ⁻⁴	0.553
PSG0.8-110	110	88.0	89.6	14	40	70	0.123	-0.053	5.52 x 10 ⁻⁴	0.661
PSG0.8-120	120	96.0	97.6	14	40	70	0.123	-0.053	7.05 x 10 ⁻⁴	0.733

+44 (0)1246 455500
+44 (0)1246 455522

ondrives

sales@ondrives.com
www.ondrives.com

Product information updated 1st April 2011 and subject to change. Please contact Sales for the latest prices and availability.

PRECISION GEARS

PSG
0.8m_n

0.8 Module Spur Gear α 20° PA Quality Grade 7e DIN 3961/58405 (AGMA Q10)

Standard Part **PSG 0.8 - 50**
Modified Part **PSG 0.8 - 50 H 12 K T**

PSG - Precision Spur Gear
Quality Grade 7e DIN 3961/58405
Other Quality Grades available.
See page 291

m_n Module - Cut with DIN 867 1.25/0.20/1.0
Ref. Tooth Profile Topping WD = 2.25 x m_n

Number of Teeth z

Standard Material = 817M40T (28HRC)
H = 805M20 Case Hardened (58HRC)
S = 303 Stainless Steel
SL = 316 Stainless Steel

T = 1 x Tapped hole 2T = 2 x Tapped holes.
P = 1 x Pin Hole PT = 1 x Pin Hole thru.
All threads metric as standard,
refer to page 308 for sizes and prices.

K- Keyway supplied to
DIN 6885 - Js9 tolerance.
For prices see page 308

To specify different bore enter size required
Example: 12 = 12mm H7 etc
For prices see page 308

Quality Grades and Tolerances stated prior to heat treatment processes.
η Efficiency approx. 98%

Discounts: 6+ -5% 19+ -10%

817M40T (28HRC)			Case Hardened 805M20 (58HRC)#			Stainless 303			Stainless 316		
Part Number	T ₂ Nm n ₂ 100min ⁻¹	Price Each 1 - 5	Part Number	T ₂ Nm n ₂ 100min ⁻¹	Price Each 1 - 5	Part Number	T ₂ Nm n ₂ 100min ⁻¹	Price Each 1 - 5	Part Number	T ₂ Nm n ₂ 100min ⁻¹	Price Each 1 - 5
PSG0.8-18	0.94	£10.94	PSG0.8-18H	3.46	£18.33	PSG0.8-18S	0.57	£14.77	PSG0.8-18SL	0.44	£16.96
PSG0.8-19	1.00	£11.10	PSG0.8-19H	3.65	£18.61	PSG0.8-19S	0.60	£14.99	PSG0.8-19SL	0.47	£17.22
PSG0.8-20	1.33	£11.27	PSG0.8-20H	4.53	£18.88	PSG0.8-20S	0.80	£15.22	PSG0.8-20SL	0.62	£17.47
PSG0.8-21	1.39	£11.62	PSG0.8-21H	4.76	£19.18	PSG0.8-21S	0.84	£15.69	PSG0.8-21SL	0.65	£18.01
PSG0.8-22	1.46	£11.79	PSG0.8-22H	4.98	£19.46	PSG0.8-22S	0.88	£15.92	PSG0.8-22SL	0.68	£18.28
PSG0.8-23	1.53	£11.84	PSG0.8-23H	5.21	£19.55	PSG0.8-23S	0.92	£15.99	PSG0.8-23SL	0.71	£18.36
PSG0.8-24	1.59	£11.90	PSG0.8-24H	5.44	£19.65	PSG0.8-24S	0.96	£16.08	PSG0.8-24SL	0.74	£18.46
PSG0.8-25	1.66	£12.41	PSG0.8-25H	5.66	£20.47	PSG0.8-25S	0.99	£16.74	PSG0.8-25SL	0.77	£19.23
PSG0.8-26	2.03	£12.85	PSG0.8-26H	5.90	£21.21	PSG0.8-26S	1.22	£17.35	PSG0.8-26SL	0.95	£19.91
PSG0.8-27	2.11	£13.11	PSG0.8-27H	6.13	£21.64	PSG0.8-27S	1.26	£17.71	PSG0.8-27SL	0.98	£20.33
PSG0.8-28	2.18	£13.40	PSG0.8-28H	6.35	£22.13	PSG0.8-28S	1.31	£18.11	PSG0.8-28SL	1.02	£20.79
PSG0.8-29	2.26	£13.76	PSG0.8-29H	6.58	£22.71	PSG0.8-29S	1.36	£18.58	PSG0.8-29SL	1.06	£21.33
PSG0.8-30	2.58	£13.99	PSG0.8-30H	6.76	£23.08	PSG0.8-30S	1.55	£18.88	PSG0.8-30SL	1.20	£21.69
PSG0.8-32	2.75	£14.35	PSG0.8-32H	7.21	£23.68	PSG0.8-32S	1.65	£19.38	PSG0.8-32SL	1.28	£22.24
PSG0.8-35	3.00	£14.83	PSG0.8-35H	7.89	£24.48	PSG0.8-35S	1.80	£20.03	PSG0.8-35SL	1.40	£23.00
PSG0.8-38	3.26	£15.44	PSG0.8-38H	8.57	£25.48	PSG0.8-38S	1.96	£20.85	PSG0.8-38SL	1.52	£23.94
PSG0.8-40	4.39	£16.01	PSG0.8-40H	10.03	£26.42	PSG0.8-40S	2.63	£21.61	PSG0.8-40SL	2.05	£24.82
PSG0.8-42	4.61	£16.12	PSG0.8-42H	10.53	£26.61	PSG0.8-42S	2.76	£21.77	PSG0.8-42SL	2.15	£25.00
PSG0.8-45	4.94	£16.35	PSG0.8-45H	11.28	£27.00	PSG0.8-45S	2.96	£22.09	PSG0.8-45SL	2.30	£25.36
PSG0.8-48	5.26	£16.49	PSG0.8-48H	12.04	£27.22	PSG0.8-48S	3.16	£22.28	PSG0.8-48SL	2.46	£25.57
PSG0.8-50	6.50	£18.21	PSG0.8-50H	13.61	£30.05	PSG0.8-50S	3.90	£24.59	PSG0.8-50SL	3.03	£28.23
PSG0.8-52	6.76	£18.75	PSG0.8-52H	14.15	£30.94	PSG0.8-52S	4.06	£25.31	PSG0.8-52SL	3.16	£29.06
PSG0.8-55	7.15	£19.53	PSG0.8-55H	14.97	£32.23	PSG0.8-55S	4.29	£26.37	PSG0.8-55SL	3.34	£30.28
PSG0.8-58	7.54	£20.12	PSG0.8-58H	15.78	£33.21	PSG0.8-58S	4.53	£27.17	PSG0.8-58SL	3.52	£31.19
PSG0.8-60	9.29	£20.59	PSG0.8-60H	17.00	£33.97	PSG0.8-60S	5.57	£27.80	PSG0.8-60SL	4.33	£31.92
PSG0.8-62	9.60	£21.27	PSG0.8-62H	17.57	£35.10	PSG0.8-62S	5.76	£28.71	PSG0.8-62SL	4.48	£32.97
PSG0.8-65	10.06	£22.79	PSG0.8-65H	18.42	£37.61	PSG0.8-65S	6.04	£30.76	PSG0.8-65SL	4.69	£35.33
PSG0.8-68	10.52	£23.96	PSG0.8-68H	19.27	£39.54	PSG0.8-68S	6.31	£32.35	PSG0.8-68SL	4.91	£37.14
PSG0.8-70	10.83	£24.46	PSG0.8-70H	19.83	£40.36	PSG0.8-70S	6.50	£33.02	PSG0.8-70SL	5.06	£37.91
PSG0.8-72	11.14	£24.99	PSG0.8-72H	20.40	£41.23	PSG0.8-72S	6.69	£33.73	PSG0.8-72SL	5.20	£38.73
PSG0.8-75	11.61	£26.65	PSG0.8-75H	21.25	£43.99	PSG0.8-75S	6.96	£35.99	PSG0.8-75SL	5.42	£41.32
PSG0.8-78	12.07	£27.05	PSG0.8-78H	22.10	£44.65	PSG0.8-78S	7.24	£36.54	PSG0.8-78SL	5.63	£41.94
PSG0.8-80	15.21	£27.61	PSG0.8-80H	23.77	£45.55	PSG0.8-80S	9.51	£37.27	PSG0.8-80SL	7.40	£42.79
PSG0.8-82	15.59	£28.00	PSG0.8-82H	24.36	£46.21	PSG0.8-82S	9.75	£37.81	PSG0.8-82SL	7.58	£43.40
PSG0.8-85	16.16	£28.60	PSG0.8-85H	25.25	£47.20	PSG0.8-85S	10.10	£38.61	PSG0.8-85SL	7.86	£44.34
PSG0.8-90	17.11	£29.52	PSG0.8-90H	26.74	£48.72	PSG0.8-90S	10.70	£39.85	PSG0.8-90SL	8.32	£45.76
PSG0.8-95	18.06	£32.68	PSG0.8-95H	28.22	£53.93	PSG0.8-95S	11.29	£44.13	PSG0.8-95SL	8.78	£50.67
PSG0.8-100	19.45	£33.11	PSG0.8-100H	30.39	£54.65	PSG0.8-100S	14.33	£44.71	PSG0.8-100SL	11.15	£51.34
PSG0.8-110	20.42	£41.46	PSG0.8-110H	31.91	£68.41	PSG0.8-110S	15.05	£55.97	PSG0.8-110SL	11.70	£64.27
PSG0.8-120	21.40	£46.89	PSG0.8-120H	33.43	£77.36	PSG0.8-120S	15.77	£63.30	PSG0.8-120SL	12.26	£72.68

+44 (0)1246 455500
+44 (0)1246 455522

ondrives

sales@ondrives.com
www.ondrives.com

Product information updated 1st April 2011 and subject to change. Please contact Sales for the latest prices and availability.