

PSG-DL
PSG-PK
0.5m_n

PRECISION GEARS

0.5 Module Plastic Spur Gear α 20° PA

Quality Grade 8e DIN 3961/58405 (AGMA Q9)

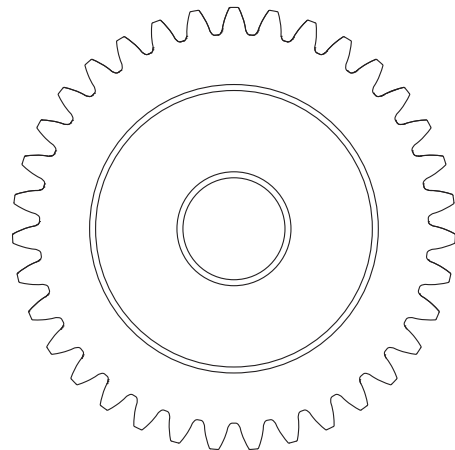
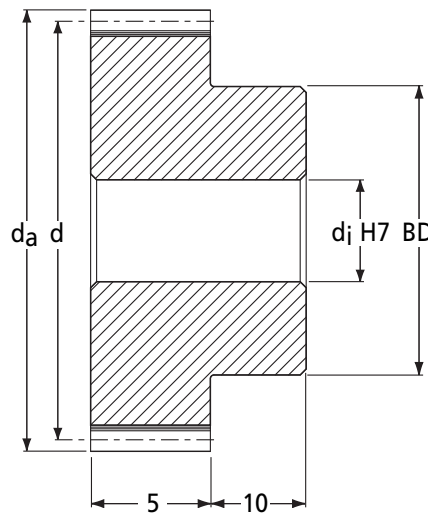

DIN 58405 Tooth Thickness tol.

Part Number	No. of Teeth z	Ref. Dia. d	Tip Dia. d _a	Bore H7 d _j	Max. Bore H7 d _j	Hub Dia. BD	Backlash (mm)		I Inertia kgm ² (Delrin)	Mass kg (Delrin)
							j _{t,e} (max)	j _{t,i} (min)		
PSG0.5-20DL	20	10.0	11.0	4	4	8	0.105 - 0.054	1.22 x 10 ⁻⁸	0.001	
PSG0.5-21DL	21	10.5	11.5	4	4	8	0.107 - 0.053	1.37 x 10 ⁻⁸	0.001	
PSG0.5-22DL	22	11.0	12.0	4	4	8	0.107 - 0.053	1.54 x 10 ⁻⁸	0.001	
PSG0.5-23DL	23	11.5	12.5	4	4	8	0.107 - 0.053	1.74 x 10 ⁻⁸	0.001	
PSG0.5-24DL	24	12.0	13.0	5	5	10	0.107 - 0.053	2.71 x 10 ⁻⁸	0.001	
PSG0.5-25DL	25	12.5	13.5	5	5	10	0.117 - 0.059	2.96 x 10 ⁻⁸	0.002	
PSG0.5-26DL	26	13.0	14.0	5	5	10	0.117 - 0.059	3.24 x 10 ⁻⁸	0.002	
PSG0.5-27DL	27	13.5	14.5	5	5	10	0.117 - 0.059	3.56 x 10 ⁻⁸	0.002	
PSG0.5-28DL	28	14.0	15.0	5	5	10	0.117 - 0.059	3.92 x 10 ⁻⁸	0.002	
PSG0.5-29DL	29	14.5	15.5	6	6	13	0.117 - 0.059	6.75 x 10 ⁻⁸	0.002	
PSG0.5-30DL	30	15.0	16.0	6	6	13	0.117 - 0.059	7.19 x 10 ⁻⁸	0.003	
PSG0.5-32DL	32	16.0	17.0	6	6	13	0.117 - 0.059	8.21 x 10 ⁻⁸	0.003	
PSG0.5-35DL	35	17.5	18.5	6	6	13	0.117 - 0.059	1.02 x 10 ⁻⁷	0.003	
PSG0.5-38DL	38	19.0	20.0	6	8	17	0.118 - 0.058	2.03 x 10 ⁻⁷	0.005	
PSG0.5-40DL	40	20.0	21.0	6	8	17	0.118 - 0.058	2.23 x 10 ⁻⁷	0.005	
PSG0.5-42DL	42	21.0	22.0	6	8	17	0.118 - 0.058	2.47 x 10 ⁻⁷	0.005	
PSG0.5-45DL	45	22.5	23.5	6	8	17	0.118 - 0.058	2.89 x 10 ⁻⁷	0.005	
PSG0.5-48DL	48	24.0	25.0	6	8	17	0.118 - 0.058	3.41 x 10 ⁻⁷	0.006	
PSG0.5-50DL	50	25.0	26.0	6	8	17	0.118 - 0.058	3.81 x 10 ⁻⁷	0.006	
PSG0.5-52DL	52	26.0	27.0	6	8	17	0.133 - 0.069	4.27 x 10 ⁻⁷	0.006	
PSG0.5-55DL	55	27.5	28.5	6	8	17	0.133 - 0.069	5.06 x 10 ⁻⁷	0.007	
PSG0.5-58DL	58	29.0	30.0	6	8	17	0.133 - 0.069	5.98 x 10 ⁻⁷	0.007	
PSG0.5-60DL	60	30.0	31.0	6	8	17	0.133 - 0.069	6.69 x 10 ⁻⁷	0.008	
PSG0.5-62DL	62	31.0	32.0	8	10	20	0.135 - 0.068	8.47 x 10 ⁻⁷	0.009	
PSG0.5-65DL	65	32.5	33.5	8	10	20	0.135 - 0.068	9.79 x 10 ⁻⁷	0.009	
PSG0.5-68DL	68	34.0	35.0	8	10	20	0.135 - 0.068	1.13 x 10 ⁻⁶	0.010	
PSG0.5-70DL	70	35.0	36.0	8	10	20	0.135 - 0.068	1.24 x 10 ⁻⁶	0.010	
PSG0.5-72DL	72	36.0	37.0	8	10	20	0.135 - 0.068	1.37 x 10 ⁻⁶	0.010	
PSG0.5-75DL	75	37.5	38.5	8	10	20	0.135 - 0.068	1.57 x 10 ⁻⁶	0.011	
PSG0.5-78DL	78	39.0	40.0	8	10	20	0.135 - 0.068	1.80 x 10 ⁻⁶	0.012	
PSG0.5-80DL	80	40.0	41.0	8	12	25	0.135 - 0.068	2.29 x 10 ⁻⁶	0.015	
PSG0.5-82DL	82	41.0	42.0	8	12	25	0.135 - 0.068	2.47 x 10 ⁻⁶	0.015	
PSG0.5-85DL	85	42.5	43.5	8	12	25	0.135 - 0.068	2.77 x 10 ⁻⁶	0.016	
PSG0.5-90DL	90	45.0	46.0	8	12	25	0.135 - 0.068	3.35 x 10 ⁻⁶	0.017	
PSG0.5-100DL	100	50.0	51.0	10	16	30	0.135 - 0.068	5.40 x 10 ⁻⁶	0.022	
PSG0.5-120DL	120	60.0	61.0	10	20	35	0.151 - 0.072	1.10 x 10 ⁻⁵	0.032	
PSG0.5-130DL	130	65.0	66.0	10	20	35	0.151 - 0.072	1.43 x 10 ⁻⁵	0.035	
PSG0.5-140DL	140	70.0	71.0	10	20	35	0.151 - 0.072	1.86 x 10 ⁻⁵	0.039	
PSG0.5-150DL	150	75.0	76.0	10	25	40	0.151 - 0.072	2.53 x 10 ⁻⁵	0.047	
PSG0.5-200DL	200	100.0	101.0	14	30	50	0.153 - 0.070	7.75 x 10 ⁻⁵	0.080	
PSG0.5-250DL	250	125.0	126.0	16	40	60	0.195 - 0.094	1.86 x 10 ⁻⁴	0.122	

+44 (0)1246 455500
+44 (0)1246 455522

ondrives

sales@ondrives.com
www.ondrives.com

Product information updated 1st April 2011 and subject to change. Please contact Sales for the latest prices and availability.

PRECISION GEARS

PSG-DL
PSG-PK
0.5m_n

0.5 Module Plastic Spur Gear α 20° PA

Quality Grade 8e DIN 3961/58405 (AGMA Q9)

Standard Part **PSG** **0.5** - **50** **DL**
Modified Part **PSG** **0.5** - **50** **PK** **8** **K** **T**

PSG - Precision Spur Gear
Quality Grade 8e DIN 3961/58405
Other Quality Grades available.
See page 291

m_n Module - Cut with DIN 867 1.25/0.20/1.0
Ref. Tooth Profile Topping WD = 2.25 x m_n

Number of Teeth z

DL = Delrin POM (White)
PK = PEEK GF30® (Light Brown)

T = 1 x Tapped hole 2T = 2 x Tapped holes.
P = 1 x Pin Hole PT = 1 x Pin Hole thru.
All threads metric as standard,
refer to page 308 for sizes and prices.

K- Keyway supplied to
DIN 6885 - Js9 tolerance.
For prices see page 308

To specify different bore enter size required
Example: 8 = 8mm H7 etc
For prices see page 308

η Efficiency approx. 98%

Discounts: 6+ -5% 19+ -10%

Part Number	Delrin POM		Part Number	PEEK GF30®	
	T ₂ Nm n ₂ 100min ⁻¹	Price Each 1 - 5		T ₂ Nm n ₂ 100min ⁻¹	Price Each 1 - 5
PSG0.5-20DL	0.20	£8.95	PSG0.5-20PK	0.27	£45.34
PSG0.5-21DL	0.21	£9.04	PSG0.5-21PK	0.29	£45.78
PSG0.5-22DL	0.23	£9.15	PSG0.5-22PK	0.31	£46.38
PSG0.5-23DL	0.24	£9.26	PSG0.5-23PK	0.33	£46.91
PSG0.5-24DL	0.26	£9.36	PSG0.5-24PK	0.35	£47.45
PSG0.5-25DL	0.27	£9.47	PSG0.5-25PK	0.37	£47.95
PSG0.5-26DL	0.29	£9.60	PSG0.5-26PK	0.39	£48.67
PSG0.5-27DL	0.30	£9.71	PSG0.5-27PK	0.41	£49.17
PSG0.5-28DL	0.31	£9.80	PSG0.5-28PK	0.43	£49.66
PSG0.5-29DL	0.33	£9.87	PSG0.5-29PK	0.45	£49.98
PSG0.5-30DL	0.35	£9.90	PSG0.5-30PK	0.47	£50.16
PSG0.5-32DL	0.37	£10.14	PSG0.5-32PK	0.51	£51.38
PSG0.5-35DL	0.42	£10.48	PSG0.5-35PK	0.57	£53.14
PSG0.5-38DL	0.46	£10.80	PSG0.5-38PK	0.63	£54.71
PSG0.5-40DL	0.50	£11.04	PSG0.5-40PK	0.68	£55.93
PSG0.5-42DL	0.53	£11.24	PSG0.5-42PK	0.72	£56.92
PSG0.5-45DL	0.57	£11.59	PSG0.5-45PK	0.78	£58.68
PSG0.5-48DL	0.62	£12.04	PSG0.5-48PK	0.84	£60.98
PSG0.5-50DL	0.65	£12.18	PSG0.5-50PK	0.89	£61.66
PSG0.5-52DL	0.68	£12.35	PSG0.5-52PK	0.93	£62.55
PSG0.5-55DL	0.73	£12.60	PSG0.5-55PK	0.99	£63.81
PSG0.5-58DL	0.78	£12.86	PSG0.5-58PK	1.06	£65.13
PSG0.5-60DL	0.81	£12.99	PSG0.5-60PK	1.10	£65.84
PSG0.5-62DL	0.84	£13.16	PSG0.5-62PK	1.14	£66.66
PSG0.5-65DL	0.88	£13.45	PSG0.5-65PK	1.21	£68.09
PSG0.5-68DL	0.93	£13.53	PSG0.5-68PK	1.27	£68.55
PSG0.5-70DL	0.96	£13.68	PSG0.5-70PK	1.31	£69.27
PSG0.5-72DL	0.99	£13.81	PSG0.5-72PK	1.35	£69.95
PSG0.5-75DL	1.04	£13.92	PSG0.5-75PK	1.42	£70.49
PSG0.5-78DL	1.09	£14.12	PSG0.5-78PK	1.48	£71.52
PSG0.5-80DL	1.12	£14.22	PSG0.5-80PK	1.53	£72.02
PSG0.5-82DL	1.15	£14.38	PSG0.5-82PK	1.57	£72.83
PSG0.5-85DL	1.20	£14.52	PSG0.5-85PK	1.63	£73.55
PSG0.5-90DL	1.28	£14.76	PSG0.5-90PK	1.74	£74.77
PSG0.5-100DL	1.43	£14.99	PSG0.5-100PK	1.95	£75.90
PSG0.5-120DL	1.74	£18.15	PSG0.5-120PK	2.38	£91.95
PSG0.5-130DL	1.90	£20.83	PSG0.5-130PK	2.59	£105.47
PSG0.5-140DL	2.06	£21.70	PSG0.5-140PK	2.81	£109.88
PSG0.5-150DL	2.22	£23.62	PSG0.5-150PK	3.02	£119.62
PSG0.5-200DL	3.02	£29.11	PSG0.5-200PK	4.12	£147.43
PSG0.5-250DL	3.83	£34.93	PSG0.5-250PK	5.22	£176.87

+44 (0)1246 455500
+44 (0)1246 455522

ondrives

sales@ondrives.com
www.ondrives.com

Product information updated 1st April 2011 and subject to change. Please contact Sales for the latest prices and availability.