

PSG-DL
PSG-PK
0.5m_n

PRECISION GEARS

0.5 Module Plastic Spur Gear α 20° PA

Quality Grade 8e DIN 3961/58405 (AGMA Q9)

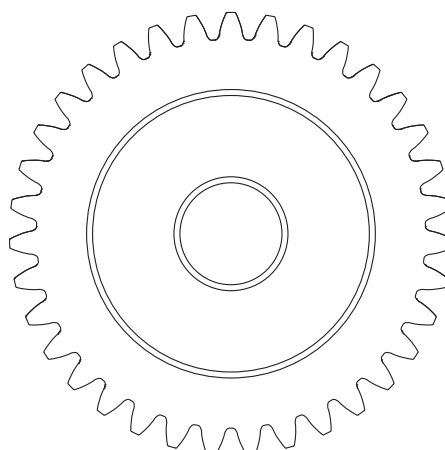
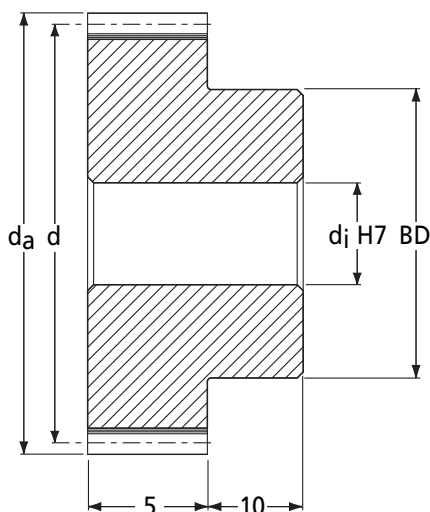
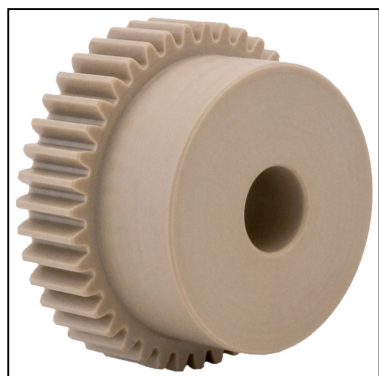

DIN 58405 Tooth Thickness tol.

Part Number	No. of Teeth z	Ref. Dia. d	Tip Dia. da	Bore H7 dj	Max. Bore H7 dj	Hub Dia. BD	Backlash (mm)		I Inertia kgm ² (Delrin)	Mass kg (Delrin)
							jt,e (max)	jt,i (min)		
PSG0.5-20DL	20	10.0	11.0	4	4	8	0.105 - 0.054		1.22 x 10 ⁻⁸	0.001
PSG0.5-21DL	21	10.5	11.5	4	4	8	0.107 - 0.053		1.37 x 10 ⁻⁸	0.001
PSG0.5-22DL	22	11.0	12.0	4	4	8	0.107 - 0.053		1.54 x 10 ⁻⁸	0.001
PSG0.5-23DL	23	11.5	12.5	4	4	8	0.107 - 0.053		1.74 x 10 ⁻⁸	0.001
PSG0.5-24DL	24	12.0	13.0	5	5	10	0.107 - 0.053		2.71 x 10 ⁻⁸	0.001
PSG0.5-25DL	25	12.5	13.5	5	5	10	0.117 - 0.059		2.96 x 10 ⁻⁸	0.002
PSG0.5-26DL	26	13.0	14.0	5	5	10	0.117 - 0.059		3.24 x 10 ⁻⁸	0.002
PSG0.5-27DL	27	13.5	14.5	5	5	10	0.117 - 0.059		3.56 x 10 ⁻⁸	0.002
PSG0.5-28DL	28	14.0	15.0	5	5	10	0.117 - 0.059		3.92 x 10 ⁻⁸	0.002
PSG0.5-29DL	29	14.5	15.5	6	6	13	0.117 - 0.059		6.75 x 10 ⁻⁸	0.002
PSG0.5-30DL	30	15.0	16.0	6	6	13	0.117 - 0.059		7.19 x 10 ⁻⁸	0.003
PSG0.5-32DL	32	16.0	17.0	6	6	13	0.117 - 0.059		8.21 x 10 ⁻⁸	0.003
PSG0.5-35DL	35	17.5	18.5	6	6	13	0.117 - 0.059		1.02 x 10 ⁻⁷	0.003
PSG0.5-38DL	38	19.0	20.0	6	8	17	0.118 - 0.058		2.03 x 10 ⁻⁷	0.005
PSG0.5-40DL	40	20.0	21.0	6	8	17	0.118 - 0.058		2.23 x 10 ⁻⁷	0.005
PSG0.5-42DL	42	21.0	22.0	6	8	17	0.118 - 0.058		2.47 x 10 ⁻⁷	0.005
PSG0.5-45DL	45	22.5	23.5	6	8	17	0.118 - 0.058		2.89 x 10 ⁻⁷	0.005
PSG0.5-48DL	48	24.0	25.0	6	8	17	0.118 - 0.058		3.41 x 10 ⁻⁷	0.006
PSG0.5-50DL	50	25.0	26.0	6	8	17	0.118 - 0.058		3.81 x 10 ⁻⁷	0.006
PSG0.5-52DL	52	26.0	27.0	6	8	17	0.133 - 0.069		4.27 x 10 ⁻⁷	0.006
PSG0.5-55DL	55	27.5	28.5	6	8	17	0.133 - 0.069		5.06 x 10 ⁻⁷	0.007
PSG0.5-58DL	58	29.0	30.0	6	8	17	0.133 - 0.069		5.98 x 10 ⁻⁷	0.007
PSG0.5-60DL	60	30.0	31.0	6	8	17	0.133 - 0.069		6.69 x 10 ⁻⁷	0.008
PSG0.5-62DL	62	31.0	32.0	8	10	20	0.135 - 0.068		8.47 x 10 ⁻⁷	0.009
PSG0.5-65DL	65	32.5	33.5	8	10	20	0.135 - 0.068		9.79 x 10 ⁻⁷	0.009
PSG0.5-68DL	68	34.0	35.0	8	10	20	0.135 - 0.068		1.13 x 10 ⁻⁶	0.010
PSG0.5-70DL	70	35.0	36.0	8	10	20	0.135 - 0.068		1.24 x 10 ⁻⁶	0.010
PSG0.5-72DL	72	36.0	37.0	8	10	20	0.135 - 0.068		1.37 x 10 ⁻⁶	0.010
PSG0.5-75DL	75	37.5	38.5	8	10	20	0.135 - 0.068		1.57 x 10 ⁻⁶	0.011
PSG0.5-78DL	78	39.0	40.0	8	10	20	0.135 - 0.068		1.80 x 10 ⁻⁶	0.012
PSG0.5-80DL	80	40.0	41.0	8	12	25	0.135 - 0.068		2.29 x 10 ⁻⁶	0.015
PSG0.5-82DL	82	41.0	42.0	8	12	25	0.135 - 0.068		2.47 x 10 ⁻⁶	0.015
PSG0.5-85DL	85	42.5	43.5	8	12	25	0.135 - 0.068		2.77 x 10 ⁻⁶	0.016
PSG0.5-90DL	90	45.0	46.0	8	12	25	0.135 - 0.068		3.35 x 10 ⁻⁶	0.017
PSG0.5-100DL	100	50.0	51.0	10	16	30	0.135 - 0.068		5.40 x 10 ⁻⁶	0.022
PSG0.5-120DL	120	60.0	61.0	10	20	35	0.151 - 0.072		1.10 x 10 ⁻⁵	0.032
PSG0.5-130DL	130	65.0	66.0	10	20	35	0.151 - 0.072		1.43 x 10 ⁻⁵	0.035
PSG0.5-140DL	140	70.0	71.0	10	20	35	0.151 - 0.072		1.86 x 10 ⁻⁵	0.039
PSG0.5-150DL	150	75.0	76.0	10	25	40	0.151 - 0.072		2.53 x 10 ⁻⁵	0.047
PSG0.5-200DL	200	100.0	101.0	14	30	50	0.153 - 0.070		7.75 x 10 ⁻⁵	0.080
PSG0.5-250DL	250	125.0	126.0	16	40	60	0.195 - 0.094		1.86 x 10 ⁻⁴	0.122

+44 (0)1246 455500
+44 (0)1246 455522

ondrives

sales@ondrives.com
www.ondrives.com

Product information updated 1st April 2011 and subject to change. Please contact Sales for the latest prices and availability.

PRECISION GEARS

PSG-DL
PSG-PK
0.5m_n

0.5 Module Plastic Spur Gear α 20° PA

Quality Grade 8e DIN 3961/58405 (AGMA Q9)

Standard Part **PSG** **0.5** - **50** **DL**
Modified Part **PSG** **0.5** - **50** **PK** **8** **K** **T**

PSG - Precision Spur Gear
Quality Grade 8e DIN 3961/58405
Other Quality Grades available.
See page 291

m_n Module - Cut with DIN 867 1.25/0.20/1.0
Ref. Tooth Profile Topping WD = 2.25 x m_n

Number of Teeth z

DL = Delrin POM (White)
PK = PEEK GF30® (Light Brown)

T = 1 x Tapped hole 2T = 2 x Tapped holes.
P = 1 x Pin Hole PT = 1 x Pin Hole thru.
All threads metric as standard,
refer to page 308 for sizes and prices.

K- Keyway supplied to
DIN 6885 - Js9 tolerance.
For prices see page 308

To specify different bore enter size required
Example: 8 = 8mm H7 etc
For prices see page 308

η Efficiency approx. 98%

Discounts: 6+ -5% 19+ -10%

Part Number	Delrin POM		Part Number	PEEK GF30®	
	T ₂ Nm n ₂ 100min ⁻¹	Price Each 1 - 5		T ₂ Nm n ₂ 100min ⁻¹	Price Each 1 - 5
PSG0.5-20DL	0.20	£8.95	PSG0.5-20PK	0.27	£45.34
PSG0.5-21DL	0.21	£9.04	PSG0.5-21PK	0.29	£45.78
PSG0.5-22DL	0.23	£9.15	PSG0.5-22PK	0.31	£46.38
PSG0.5-23DL	0.24	£9.26	PSG0.5-23PK	0.33	£46.91
PSG0.5-24DL	0.26	£9.36	PSG0.5-24PK	0.35	£47.45
PSG0.5-25DL	0.27	£9.47	PSG0.5-25PK	0.37	£47.95
PSG0.5-26DL	0.29	£9.60	PSG0.5-26PK	0.39	£48.67
PSG0.5-27DL	0.30	£9.71	PSG0.5-27PK	0.41	£49.17
PSG0.5-28DL	0.31	£9.80	PSG0.5-28PK	0.43	£49.66
PSG0.5-29DL	0.33	£9.87	PSG0.5-29PK	0.45	£49.98
PSG0.5-30DL	0.35	£9.90	PSG0.5-30PK	0.47	£50.16
PSG0.5-32DL	0.37	£10.14	PSG0.5-32PK	0.51	£51.38
PSG0.5-35DL	0.42	£10.48	PSG0.5-35PK	0.57	£53.14
PSG0.5-38DL	0.46	£10.80	PSG0.5-38PK	0.63	£54.71
PSG0.5-40DL	0.50	£11.04	PSG0.5-40PK	0.68	£55.93
PSG0.5-42DL	0.53	£11.24	PSG0.5-42PK	0.72	£56.92
PSG0.5-45DL	0.57	£11.59	PSG0.5-45PK	0.78	£58.68
PSG0.5-48DL	0.62	£12.04	PSG0.5-48PK	0.84	£60.98
PSG0.5-50DL	0.65	£12.18	PSG0.5-50PK	0.89	£61.66
PSG0.5-52DL	0.68	£12.35	PSG0.5-52PK	0.93	£62.55
PSG0.5-55DL	0.73	£12.60	PSG0.5-55PK	0.99	£63.81
PSG0.5-58DL	0.78	£12.86	PSG0.5-58PK	1.06	£65.13
PSG0.5-60DL	0.81	£12.99	PSG0.5-60PK	1.10	£65.84
PSG0.5-62DL	0.84	£13.16	PSG0.5-62PK	1.14	£66.66
PSG0.5-65DL	0.88	£13.45	PSG0.5-65PK	1.21	£68.09
PSG0.5-68DL	0.93	£13.53	PSG0.5-68PK	1.27	£68.55
PSG0.5-70DL	0.96	£13.68	PSG0.5-70PK	1.31	£69.27
PSG0.5-72DL	0.99	£13.81	PSG0.5-72PK	1.35	£69.95
PSG0.5-75DL	1.04	£13.92	PSG0.5-75PK	1.42	£70.49
PSG0.5-78DL	1.09	£14.12	PSG0.5-78PK	1.48	£71.52
PSG0.5-80DL	1.12	£14.22	PSG0.5-80PK	1.53	£72.02
PSG0.5-82DL	1.15	£14.38	PSG0.5-82PK	1.57	£72.83
PSG0.5-85DL	1.20	£14.52	PSG0.5-85PK	1.63	£73.55
PSG0.5-90DL	1.28	£14.76	PSG0.5-90PK	1.74	£74.77
PSG0.5-100DL	1.43	£14.99	PSG0.5-100PK	1.95	£75.90
PSG0.5-120DL	1.74	£18.15	PSG0.5-120PK	2.38	£91.95
PSG0.5-130DL	1.90	£20.83	PSG0.5-130PK	2.59	£105.47
PSG0.5-140DL	2.06	£21.70	PSG0.5-140PK	2.81	£109.88
PSG0.5-150DL	2.22	£23.62	PSG0.5-150PK	3.02	£119.62
PSG0.5-200DL	3.02	£29.11	PSG0.5-200PK	4.12	£147.43
PSG0.5-250DL	3.83	£34.93	PSG0.5-250PK	5.22	£176.87

+44 (0)1246 455500
+44 (0)1246 455522

ondrives

sales@ondrives.com
www.ondrives.com

Product information updated 1st April 2011 and subject to change. Please contact Sales for the latest prices and availability.

PSG-DL
PSG-PK
0.8m_n

PRECISION GEARS

0.8 Module Plastic Spur Gear α 20° PA

Quality Grade 8e DIN 3961/58405 (AGMA Q9)

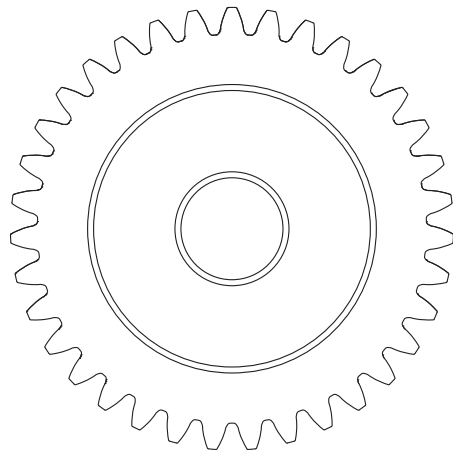
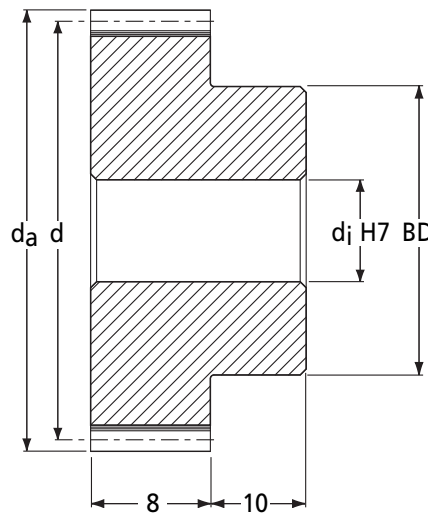

DIN 58405 Tooth Thickness tol.

Part Number	No. of Teeth z	Ref. Dia. d	Tip Dia. d _a	Bore H7 d _j	Max. Bore H7 d _j	Hub Dia. BD	Backlash (mm)		I Inertia kgm ² (Delrin)	Mass kg (Delrin)
							j _{t,e} (max)	j _{t,i} (min)		
PSG0.8-18DL	18	14.4	16.0	5	6	11	0.132 - 0.070	6.81 x 10 ⁻⁸	0.003	
PSG0.8-19DL	19	15.2	16.8	5	6	11	0.132 - 0.070	7.96 x 10 ⁻⁸	0.003	
PSG0.8-20DL	20	16.0	17.6	5	6	11	0.132 - 0.070	9.31 x 10 ⁻⁸	0.003	
PSG0.8-21DL	21	16.8	18.4	5	6	12	0.132 - 0.070	1.17 x 10 ⁻⁷	0.004	
PSG0.8-22DL	22	17.6	19.2	5	6	12	0.132 - 0.070	1.35 x 10 ⁻⁷	0.004	
PSG0.8-23DL	23	18.4	20.0	5	6	12	0.133 - 0.069	1.56 x 10 ⁻⁷	0.004	
PSG0.8-24DL	24	19.2	20.8	6	8	14	0.133 - 0.069	2.02 x 10 ⁻⁷	0.005	
PSG0.8-25DL	25	20.0	21.6	6	8	14	0.133 - 0.069	2.29 x 10 ⁻⁷	0.005	
PSG0.8-26DL	26	20.8	22.4	6	8	14	0.133 - 0.069	2.59 x 10 ⁻⁷	0.005	
PSG0.8-27DL	27	21.6	23.2	6	8	14	0.133 - 0.069	2.92 x 10 ⁻⁷	0.006	
PSG0.8-28DL	28	22.4	24.0	8	10	18	0.133 - 0.069	4.15 x 10 ⁻⁷	0.007	
PSG0.8-29DL	29	23.2	24.8	8	10	18	0.133 - 0.069	4.56 x 10 ⁻⁷	0.007	
PSG0.8-30DL	30	24.0	25.6	8	10	18	0.133 - 0.069	5.03 x 10 ⁻⁷	0.007	
PSG0.8-32DL	32	25.6	27.2	8	10	18	0.148 - 0.075	6.10 x 10 ⁻⁷	0.008	
PSG0.8-35DL	35	28.0	29.6	10	12	20	0.148 - 0.075	8.75 x 10 ⁻⁷	0.009	
PSG0.8-38DL	38	30.4	32.0	10	12	20	0.150 - 0.074	1.14 x 10 ⁻⁶	0.011	
PSG0.8-40DL	40	32.0	33.6	10	12	20	0.150 - 0.074	1.35 x 10 ⁻⁶	0.011	
PSG0.8-42DL	42	33.6	35.2	10	12	20	0.150 - 0.074	1.60 x 10 ⁻⁶	0.012	
PSG0.8-45DL	45	36.0	37.6	10	12	20	0.150 - 0.074	2.04 x 10 ⁻⁶	0.014	
PSG0.8-48DL	48	38.4	40.0	10	18	30	0.150 - 0.074	3.49 x 10 ⁻⁶	0.021	
PSG0.8-50DL	50	40.0	41.6	10	18	30	0.150 - 0.074	3.91 x 10 ⁻⁶	0.022	
PSG0.8-52DL	52	41.6	43.2	10	18	30	0.150 - 0.074	4.39 x 10 ⁻⁶	0.023	
PSG0.8-55DL	55	44.0	45.6	10	18	30	0.150 - 0.074	5.21 x 10 ⁻⁶	0.025	
PSG0.8-58DL	58	46.4	48.0	10	18	30	0.150 - 0.074	6.19 x 10 ⁻⁶	0.027	
PSG0.8-60DL	60	48.0	49.6	10	25	40	0.150 - 0.074	9.35 x 10 ⁻⁶	0.036	
PSG0.8-62DL	62	49.6	51.2	10	25	40	0.150 - 0.074	1.02 x 10 ⁻⁵	0.037	
PSG0.8-65DL	65	52.0	53.6	10	25	40	0.171 - 0.085	1.15 x 10 ⁻⁵	0.040	
PSG0.8-68DL	68	54.4	56.0	10	25	40	0.171 - 0.085	1.31 x 10 ⁻⁵	0.042	
PSG0.8-70DL	70	56.0	57.6	10	25	40	0.171 - 0.085	1.43 x 10 ⁻⁵	0.043	
PSG0.8-72DL	72	57.6	59.2	10	25	40	0.171 - 0.085	1.56 x 10 ⁻⁵	0.045	
PSG0.8-75DL	75	60.0	61.6	10	30	50	0.171 - 0.085	2.29 x 10 ⁻⁵	0.057	
PSG0.8-78DL	78	62.4	64.0	10	30	50	0.171 - 0.085	2.53 x 10 ⁻⁵	0.060	
PSG0.8-80DL	80	64.0	65.6	10	30	50	0.171 - 0.085	2.71 x 10 ⁻⁵	0.062	
PSG0.8-82DL	82	65.6	67.2	10	30	50	0.171 - 0.085	2.90 x 10 ⁻⁵	0.064	
PSG0.8-85DL	85	68.0	69.6	10	30	50	0.171 - 0.085	3.21 x 10 ⁻⁵	0.066	
PSG0.8-90DL	90	72.0	73.6	10	40	65	0.171 - 0.085	5.42 x 10 ⁻⁵	0.090	
PSG0.8-95DL	95	76.0	77.6	10	40	65	0.171 - 0.085	6.14 x 10 ⁻⁵	0.096	
PSG0.8-100DL	100	80.0	81.6	14	40	65	0.171 - 0.085	6.97 x 10 ⁻⁵	0.099	
PSG0.8-110DL	110	88.0	89.6	14	40	70	0.172 - 0.083	9.91 x 10 ⁻⁵	0.119	
PSG0.8-120DL	120	96.0	97.6	14	40	70	0.172 - 0.083	1.27 x 10 ⁻⁴	0.132	

+44 (0)1246 455500
+44 (0)1246 455522

ondrives

sales@ondrives.com
www.ondrives.com

Product information updated 1st April 2011 and subject to change. Please contact Sales for the latest prices and availability.

PRECISION GEARS

PSG-DL
PSG-PK
0.8m_n

0.8 Module Plastic Spur Gear α 20° PA

Quality Grade 8e DIN 3961/58405 (AGMA Q9)

Standard Part **PSG** **0.8** **50** **DL**
Modified Part **PSG** **0.8** **50** **PK** **12** **K** **T**

PSG - Precision Spur Gear
Quality Grade 8e DIN 3961/58405
Other Quality Grades available.
See page 291

m_n Module - Cut with DIN 867 1.25/0.20/1.0
Ref. Tooth Profile Topping WD = 2.25 x m_n

Number of Teeth z

DL = Delrin POM (White)
PK = PEEK GF30® (Light Brown)

T = 1 x Tapped hole 2T = 2 x Tapped holes.
P = 1 x Pin Hole PT = 1 x Pin Hole thru.
All threads metric as standard,
refer to page 308 for sizes and prices.

K- Keyway supplied to
DIN 6885 - Js9 tolerance.
For prices see page 308

To specify different bore enter size required
Example: 12 = 12mm H7 etc
For prices see page 308

η Efficiency approx. 98%

Discounts: 6+ -5% 19+ -10%

Part Number	Delrin POM		Part Number	PEEK GF30®	
	T ₂ Nm n ₂ 100min ⁻¹	Price Each 1 - 5		T ₂ Nm n ₂ 100min ⁻¹	Price Each 1 - 5
PSG0.8-18DL	0.59	£8.74	PSG0.8-18PK	0.70	£44.32
PSG0.8-19DL	0.64	£8.88	PSG0.8-19PK	0.78	£44.99
PSG0.8-20DL	0.69	£9.01	PSG0.8-20PK	0.88	£45.66
PSG0.8-21DL	0.74	£9.30	PSG0.8-21PK	0.98	£47.10
PSG0.8-22DL	0.79	£9.43	PSG0.8-22PK	1.08	£47.78
PSG0.8-23DL	0.84	£9.48	PSG0.8-23PK	1.15	£47.99
PSG0.8-24DL	0.89	£9.52	PSG0.8-24PK	1.22	£48.25
PSG0.8-25DL	0.95	£9.92	PSG0.8-25PK	1.29	£50.26
PSG0.8-26DL	1.00	£10.27	PSG0.8-26PK	1.36	£52.06
PSG0.8-27DL	1.05	£10.48	PSG0.8-27PK	1.43	£53.14
PSG0.8-28DL	1.10	£10.73	PSG0.8-28PK	1.50	£54.33
PSG0.8-29DL	1.16	£11.00	PSG0.8-29PK	1.58	£55.75
PSG0.8-30DL	1.21	£11.19	PSG0.8-30PK	1.65	£56.68
PSG0.8-32DL	1.31	£11.48	PSG0.8-32PK	1.79	£58.14
PSG0.8-35DL	1.47	£11.87	PSG0.8-35PK	2.00	£60.11
PSG0.8-38DL	1.63	£12.34	PSG0.8-38PK	2.22	£62.55
PSG0.8-40DL	1.74	£12.81	PSG0.8-40PK	2.37	£64.86
PSG0.8-42DL	1.84	£12.90	PSG0.8-42PK	2.51	£65.34
PSG0.8-45DL	2.01	£13.09	PSG0.8-45PK	2.73	£66.28
PSG0.8-48DL	2.17	£13.19	PSG0.8-48PK	2.96	£66.83
PSG0.8-50DL	2.28	£14.57	PSG0.8-50PK	3.11	£73.78
PSG0.8-52DL	2.39	£15.00	PSG0.8-52PK	3.26	£75.96
PSG0.8-55DL	2.55	£15.62	PSG0.8-55PK	3.48	£79.12
PSG0.8-58DL	2.72	£16.09	PSG0.8-58PK	3.71	£81.52
PSG0.8-60DL	2.83	£16.47	PSG0.8-60PK	3.86	£83.40
PSG0.8-62DL	2.94	£17.01	PSG0.8-62PK	4.01	£86.15
PSG0.8-65DL	3.10	£18.22	PSG0.8-65PK	4.22	£92.32
PSG0.8-68DL	3.26	£19.17	PSG0.8-68PK	4.45	£97.07
PSG0.8-70DL	3.37	£19.57	PSG0.8-70PK	4.59	£99.08
PSG0.8-72DL	3.48	£19.99	PSG0.8-72PK	4.74	£101.22
PSG0.8-75DL	3.64	£21.32	PSG0.8-75PK	4.97	£107.98
PSG0.8-78DL	3.81	£21.65	PSG0.8-78PK	5.19	£109.61
PSG0.8-80DL	3.92	£22.09	PSG0.8-80PK	5.35	£111.84
PSG0.8-82DL	4.03	£22.40	PSG0.8-82PK	5.50	£113.42
PSG0.8-85DL	4.20	£22.87	PSG0.8-85PK	5.72	£115.86
PSG0.8-90DL	4.47	£23.62	PSG0.8-90PK	6.10	£119.59
PSG0.8-95DL	4.75	£26.14	PSG0.8-95PK	6.48	£132.39
PSG0.8-100DL	5.02	£26.49	PSG0.8-100PK	6.85	£134.15
PSG0.8-110DL	5.56	£33.16	PSG0.8-110PK	7.59	£167.94
PSG0.8-120DL	6.11	£37.50	PSG0.8-120PK	8.33	£189.91

+44 (0)1246 455500
+44 (0)1246 455522

ondrives

sales@ondrives.com
www.ondrives.com

Product information updated 1st April 2011 and subject to change. Please contact Sales for the latest prices and availability.

PSG-DL
PSG-PK
1.0m_n

PRECISION GEARS

1.0 Module Plastic Spur Gear α 20° PA

Quality Grade 8e25 DIN 3961/3967 (AGMA Q9)

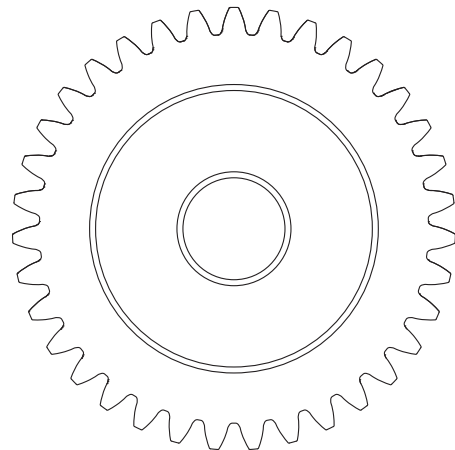
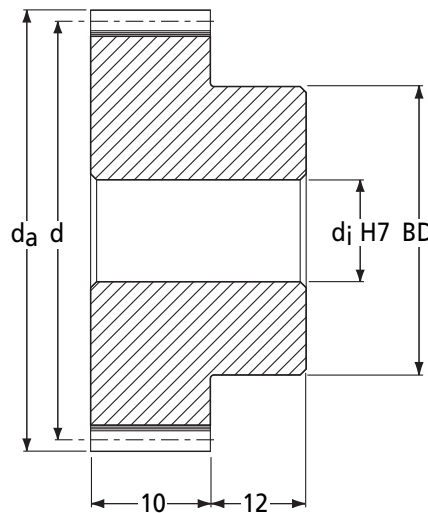
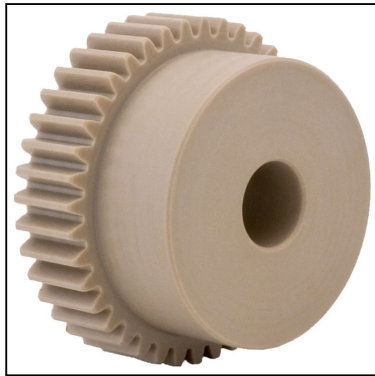

DIN 3967 Tooth Thickness tol.

Part Number	No. of Teeth <i>z</i>	Ref. Dia. <i>d</i>	Tip Dia. <i>d_a</i>	Bore H7 <i>d_j</i>	Max. Bore H7 <i>d_j</i>	Hub Dia. <i>BD</i>	Backlash (mm)		I Inertia <i>I</i> (kgm ² Delrin)	Mass <i>M</i> (kg Delrin)
							<i>j_{t,e}</i> (max)	<i>j_{t,i}</i> (min)		
PSG1.0-18DL	18	18	20	5	8	15	0.127	-0.053	2.33 x 10 ⁻⁷	0.006
PSG1.0-19DL	19	19	21	5	8	15	0.128	-0.052	2.68 x 10 ⁻⁷	0.006
PSG1.0-20DL	20	20	22	5	8	15	0.128	-0.052	3.09 x 10 ⁻⁷	0.007
PSG1.0-21DL	21	21	23	5	8	15	0.128	-0.052	3.57 x 10 ⁻⁷	0.007
PSG1.0-22DL	22	22	24	5	8	15	0.128	-0.052	4.12 x 10 ⁻⁷	0.008
PSG1.0-23DL	23	23	25	5	8	15	0.128	-0.052	4.75 x 10 ⁻⁷	0.008
PSG1.0-24DL	24	24	26	6	10	20	0.128	-0.052	7.26 x 10 ⁻⁷	0.011
PSG1.0-25DL	25	25	27	6	10	20	0.128	-0.052	8.07 x 10 ⁻⁷	0.011
PSG1.0-26DL	26	26	28	6	10	20	0.128	-0.052	8.98 x 10 ⁻⁷	0.012
PSG1.0-27DL	27	27	29	6	10	20	0.128	-0.052	1.00 x 10 ⁻⁶	0.012
PSG1.0-28DL	28	28	30	6	10	20	0.128	-0.052	1.12 x 10 ⁻⁶	0.013
PSG1.0-29DL	29	29	31	8	12	25	0.128	-0.052	1.62 x 10 ⁻⁶	0.016
PSG1.0-30DL	30	30	32	8	12	25	0.128	-0.052	1.76 x 10 ⁻⁶	0.017
PSG1.0-32DL	32	32	34	8	12	25	0.129	-0.051	2.09 x 10 ⁻⁶	0.018
PSG1.0-35DL	35	35	37	8	12	25	0.129	-0.051	2.71 x 10 ⁻⁶	0.020
PSG1.0-38DL	38	38	40	10	18	34	0.129	-0.051	5.06 x 10 ⁻⁶	0.029
PSG1.0-40DL	40	40	42	10	18	34	0.129	-0.051	5.71 x 10 ⁻⁶	0.030
PSG1.0-42DL	42	42	44	10	18	34	0.129	-0.051	6.47 x 10 ⁻⁶	0.032
PSG1.0-45DL	45	45	47	10	18	34	0.129	-0.051	7.82 x 10 ⁻⁶	0.035
PSG1.0-48DL	48	48	50	10	18	34	0.129	-0.051	9.48 x 10 ⁻⁶	0.038
PSG1.0-50DL	50	50	52	10	18	34	0.129	-0.051	1.08 x 10 ⁻⁵	0.040
PSG1.0-52DL	52	52	54	10	22	40	0.171	-0.069	1.43 x 10 ⁻⁵	0.049
PSG1.0-55DL	55	55	57	10	22	40	0.171	-0.069	1.68 x 10 ⁻⁵	0.052
PSG1.0-58DL	58	58	60	10	22	40	0.171	-0.069	1.98 x 10 ⁻⁵	0.056
PSG1.0-60DL	60	60	62	10	22	40	0.171	-0.069	2.20 x 10 ⁻⁵	0.058
PSG1.0-62DL	62	62	64	10	22	40	0.171	-0.069	2.45 x 10 ⁻⁵	0.061
PSG1.0-65DL	65	65	67	10	28	50	0.171	-0.069	3.49 x 10 ⁻⁵	0.077
PSG1.0-68DL	68	68	70	10	28	50	0.171	-0.069	3.97 x 10 ⁻⁵	0.082
PSG1.0-70DL	70	70	72	10	28	50	0.171	-0.069	4.33 x 10 ⁻⁵	0.085
PSG1.0-72DL	72	72	74	10	28	50	0.171	-0.069	4.73 x 10 ⁻⁵	0.088
PSG1.0-75DL	75	75	77	10	28	50	0.171	-0.069	5.38 x 10 ⁻⁵	0.093
PSG1.0-78DL	78	78	80	10	35	60	0.171	-0.069	7.23 x 10 ⁻⁵	0.112
PSG1.0-80DL	80	80	82	10	35	60	0.171	-0.069	7.78 x 10 ⁻⁵	0.116
PSG1.0-82DL	82	82	84	10	35	60	0.173	-0.067	8.36 x 10 ⁻⁵	0.119
PSG1.0-85DL	85	85	87	10	35	60	0.173	-0.067	9.32 x 10 ⁻⁵	0.125
PSG1.0-90DL	90	90	92	10	35	60	0.173	-0.067	1.12 x 10 ⁻⁴	0.135
PSG1.0-95DL	95	95	97	10	35	60	0.173	-0.067	1.33 x 10 ⁻⁴	0.145
PSG1.0-100DL	100	100	102	14	40	70	0.173	-0.067	1.77 x 10 ⁻⁴	0.171
PSG1.0-110DL	110	110	112	14	40	70	0.173	-0.067	2.41 x 10 ⁻⁴	0.194
PSG1.0-120DL	120	120	122	14	40	70	0.173	-0.067	3.25 x 10 ⁻⁴	0.219

PRECISION GEARS

PSG-DL
PSG-PK
1.0m_n

1.0 Module Plastic Spur Gear α 20° PA

Quality Grade 8e25 DIN 3961/3967 (AGMA Q9)

Standard Part **PSG** **1.0** **50** **DL**
Modified Part **PSG** **1.0** **50** **PK** **12** **K** **T**

PSG - Precision Spur Gear
Quality Grade 8e25 DIN 3961/3967
Other Quality Grades available.
See page 291

m_n Module - Cut with DIN 867 1.25/0.20/1.0
Ref. Tooth Profile Topping WD = 2.25 x m_n

Number of Teeth z

DL = Delrin POM (White)
PK = PEEK GF30® (Light Brown)

T = 1 x Tapped hole 2T = 2 x Tapped holes.
P = 1 x Pin Hole PT = 1 x Pin Hole thru.
All threads metric as standard,
refer to page 308 for sizes and prices.

K- Keyway supplied to
DIN 6885 - Js9 tolerance.
For prices see page 308

To specify different bore enter size required
Example: 12 = 12mm H7 etc
For prices see page 308

η Efficiency approx. 98%

Discounts: 6+ -5% 19+ -10%

Part Number	Delrin POM		Part Number	PEEK GF30®	
	T ₂ Nm n ₂ 100min ⁻¹	Price Each 1 - 5		T ₂ Nm n ₂ 100min ⁻¹	Price Each 1 - 5
PSG1.0-18DL	0.92	£9.28	PSG1.0-18PK	1.04	£47.00
PSG1.0-19DL	1.03	£9.42	PSG1.0-19PK	1.17	£47.72
PSG1.0-20DL	1.16	£9.72	PSG1.0-20PK	1.31	£49.25
PSG1.0-21DL	1.29	£9.78	PSG1.0-21PK	1.46	£49.58
PSG1.0-22DL	1.43	£9.93	PSG1.0-22PK	1.61	£50.29
PSG1.0-23DL	1.54	£9.97	PSG1.0-23PK	1.78	£50.51
PSG1.0-24DL	1.63	£10.02	PSG1.0-24PK	1.96	£50.78
PSG1.0-25DL	1.73	£10.44	PSG1.0-25PK	2.15	£52.91
PSG1.0-26DL	1.83	£10.82	PSG1.0-26PK	2.34	£54.80
PSG1.0-27DL	1.92	£11.04	PSG1.0-27PK	2.55	£55.93
PSG1.0-28DL	2.02	£11.29	PSG1.0-28PK	2.75	£57.19
PSG1.0-29DL	2.11	£11.59	PSG1.0-29PK	2.88	£58.68
PSG1.0-30DL	2.21	£11.78	PSG1.0-30PK	3.02	£59.67
PSG1.0-32DL	2.40	£12.08	PSG1.0-32PK	3.27	£61.20
PSG1.0-35DL	2.68	£12.49	PSG1.0-35PK	3.66	£63.27
PSG1.0-38DL	2.98	£12.99	PSG1.0-38PK	4.06	£65.84
PSG1.0-40DL	3.18	£13.48	PSG1.0-40PK	4.33	£68.28
PSG1.0-42DL	3.37	£13.58	PSG1.0-42PK	4.59	£68.77
PSG1.0-45DL	3.66	£13.77	PSG1.0-45PK	4.99	£69.76
PSG1.0-48DL	3.96	£13.89	PSG1.0-48PK	5.40	£70.35
PSG1.0-50DL	4.17	£15.34	PSG1.0-50PK	5.68	£77.66
PSG1.0-52DL	4.36	£15.79	PSG1.0-52PK	5.95	£79.96
PSG1.0-55DL	4.66	£16.45	PSG1.0-55PK	6.36	£83.29
PSG1.0-58DL	4.97	£16.94	PSG1.0-58PK	6.77	£85.81
PSG1.0-60DL	5.17	£17.33	PSG1.0-60PK	7.05	£87.79
PSG1.0-62DL	5.36	£17.91	PSG1.0-62PK	7.31	£90.69
PSG1.0-65DL	5.66	£19.19	PSG1.0-65PK	7.72	£97.18
PSG1.0-68DL	5.95	£20.18	PSG1.0-68PK	8.12	£102.18
PSG1.0-70DL	6.15	£20.60	PSG1.0-70PK	8.39	£104.29
PSG1.0-72DL	6.35	£21.04	PSG1.0-72PK	8.66	£106.55
PSG1.0-75DL	6.65	£22.44	PSG1.0-75PK	9.07	£113.66
PSG1.0-78DL	6.96	£22.78	PSG1.0-78PK	9.49	£115.38
PSG1.0-80DL	7.16	£23.24	PSG1.0-80PK	9.76	£117.73
PSG1.0-82DL	7.37	£23.58	PSG1.0-82PK	10.05	£119.39
PSG1.0-85DL	7.67	£24.08	PSG1.0-85PK	10.45	£121.97
PSG1.0-90DL	8.17	£24.86	PSG1.0-90PK	11.14	£125.88
PSG1.0-95DL	8.67	£27.53	PSG1.0-95PK	11.83	£139.36
PSG1.0-100DL	9.17	£27.88	PSG1.0-100PK	12.50	£141.21
PSG1.0-110DL	10.16	£34.91	PSG1.0-110PK	13.86	£176.77
PSG1.0-120DL	11.16	£39.48	PSG1.0-120PK	15.21	£199.91

+44 (0)1246 455500
+44 (0)1246 455522

ondrives

sales@ondrives.com
www.ondrives.com

Product information updated 1st April 2011 and subject to change. Please contact Sales for the latest prices and availability.

PSG-DL
PSG-PK
1.25m_n

PRECISION GEARS

1.25 Module Plastic Spur Gear α 20° PA

Quality Grade 8e25 DIN 3961/3967 (AGMA Q9)

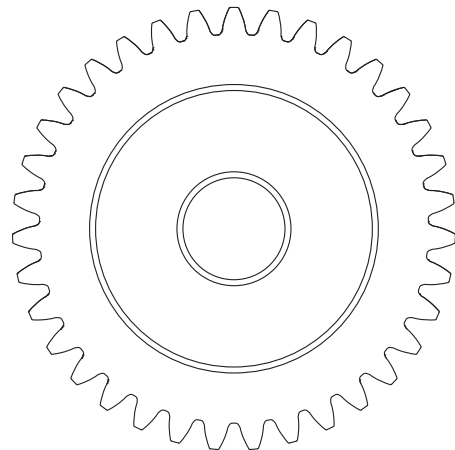
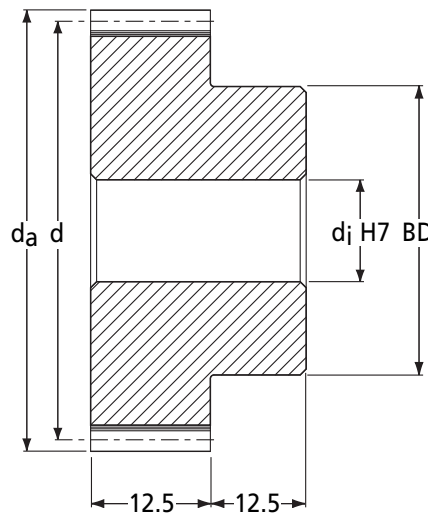

DIN 3967 Tooth Thickness tol.

Part Number	No. of Teeth z	Ref. Dia. d	Tip Dia. d _a	Bore H7 d _j	Max. Bore H7 d _j	Hub Dia. BD	Backlash (mm)		I Inertia kgm ² (Delrin)	Mass kg (Delrin)
							j _{t,e} (max)	j _{t,i} (min)		
PSG1.25-18DL	18	22.50	25.00	6	8	15	0.128	-0.052	5.43 x 10 ⁻⁷	0.009
PSG1.25-19DL	19	23.75	26.25	6	8	15	0.128	-0.052	6.50 x 10 ⁻⁷	0.010
PSG1.25-20DL	20	25.00	27.50	6	8	15	0.128	-0.052	7.76 x 10 ⁻⁷	0.011
PSG1.25-21DL	21	26.25	28.75	8	12	20	0.128	-0.052	1.10 x 10 ⁻⁶	0.013
PSG1.25-22DL	22	27.50	30.00	8	12	20	0.128	-0.052	1.27 x 10 ⁻⁶	0.014
PSG1.25-23DL	23	28.75	31.25	8	12	20	0.128	-0.052	1.46 x 10 ⁻⁶	0.015
PSG1.25-24DL	24	30.00	32.50	8	12	22	0.128	-0.052	1.81 x 10 ⁻⁶	0.017
PSG1.25-25DL	25	31.25	33.75	8	12	22	0.129	-0.051	2.06 x 10 ⁻⁶	0.018
PSG1.25-26DL	26	32.50	35.00	8	12	22	0.129	-0.051	2.33 x 10 ⁻⁶	0.020
PSG1.25-27DL	27	33.75	36.25	8	12	22	0.129	-0.051	2.65 x 10 ⁻⁶	0.021
PSG1.25-28DL	28	35.00	37.50	8	15	25	0.129	-0.051	3.27 x 10 ⁻⁶	0.024
PSG1.25-29DL	29	36.25	38.75	8	15	25	0.129	-0.051	3.65 x 10 ⁻⁶	0.025
PSG1.25-30DL	30	37.50	40.00	8	15	25	0.129	-0.051	4.08 x 10 ⁻⁶	0.026
PSG1.25-32DL	32	40.00	42.50	8	15	25	0.129	-0.051	5.08 x 10 ⁻⁶	0.029
PSG1.25-35DL	35	43.75	46.25	10	18	30	0.129	-0.051	7.68 x 10 ⁻⁶	0.036
PSG1.25-38DL	38	47.50	50.00	10	18	30	0.129	-0.051	1.01 x 10 ⁻⁵	0.041
PSG1.25-40DL	40	50.00	52.50	10	18	30	0.129	-0.051	1.21 x 10 ⁻⁵	0.044
PSG1.25-42DL	42	52.50	55.00	10	18	30	0.171	-0.069	1.44 x 10 ⁻⁵	0.048
PSG1.25-45DL	45	56.25	58.75	10	18	30	0.171	-0.069	1.86 x 10 ⁻⁵	0.053
PSG1.25-48DL	48	60.00	62.50	10	25	40	0.171	-0.069	2.66 x 10 ⁻⁵	0.069
PSG1.25-50DL	50	62.50	65.00	10	25	40	0.171	-0.069	3.06 x 10 ⁻⁵	0.073
PSG1.25-52DL	52	65.00	67.50	10	25	40	0.171	-0.069	3.50 x 10 ⁻⁵	0.077
PSG1.25-55DL	55	68.75	71.25	10	25	40	0.171	-0.069	4.27 x 10 ⁻⁵	0.084
PSG1.25-58DL	58	72.50	75.00	10	25	40	0.171	-0.069	5.18 x 10 ⁻⁵	0.092
PSG1.25-60DL	60	75.00	77.50	10	30	50	0.171	-0.069	6.51 x 10 ⁻⁵	0.109
PSG1.25-62DL	62	77.50	80.00	10	30	50	0.171	-0.069	7.27 x 10 ⁻⁵	0.114
PSG1.25-65DL	65	81.25	83.75	10	30	50	0.173	-0.067	8.56 x 10 ⁻⁵	0.123
PSG1.25-68DL	68	85.00	87.50	10	30	50	0.173	-0.067	1.00 x 10 ⁻⁴	0.131
PSG1.25-70DL	70	87.50	90.00	10	30	50	0.173	-0.067	1.11 x 10 ⁻⁴	0.137
PSG1.25-72DL	72	90.00	92.50	10	30	50	0.173	-0.067	1.23 x 10 ⁻⁴	0.143
PSG1.25-75DL	75	93.75	96.25	10	35	60	0.173	-0.067	1.55 x 10 ⁻⁴	0.168
PSG1.25-78DL	78	97.50	100.00	10	35	60	0.173	-0.067	1.78 x 10 ⁻⁴	0.178
PSG1.25-80DL	80	100.00	102.50	10	35	60	0.173	-0.067	1.94 x 10 ⁻⁴	0.185
PSG1.25-82DL	82	102.50	105.00	10	35	60	0.173	-0.067	2.12 x 10 ⁻⁴	0.192
PSG1.25-85DL	85	106.25	108.75	10	35	60	0.173	-0.067	2.41 x 10 ⁻⁴	0.203
PSG1.25-90DL	90	112.50	115.00	10	40	65	0.173	-0.067	3.06 x 10 ⁻⁴	0.230
PSG1.25-95DL	95	118.75	121.25	10	40	65	0.173	-0.067	3.72 x 10 ⁻⁴	0.250
PSG1.25-100DL	100	125.00	127.50	14	40	65	0.175	-0.065	4.50 x 10 ⁻⁴	0.268
PSG1.25-110DL	110	137.50	140.00	14	40	70	0.227	-0.097	6.56 x 10 ⁻⁴	0.323
PSG1.25-120DL	120	150.00	152.50	14	40	70	0.227	-0.097	9.12 x 10 ⁻⁴	0.373

+44 (0)1246 455500
+44 (0)1246 455522

ondrives

sales@ondrives.com
www.ondrives.com

Product information updated 1st April 2011 and subject to change. Please contact Sales for the latest prices and availability.

PRECISION GEARS

PSG-DL
PSG-PK
1.25m_n

1.25 Module Plastic Spur Gear α 20° PA

Quality Grade 8e25 DIN 3961/3967 (AGMA Q9)

Standard Part **PSG** **1.25** **50** **DL**
Modified Part **PSG** **1.25** **50** **PK** **12** **K** **T**

PSG - Precision Spur Gear
Quality Grade 8e25 DIN 3961/3967
Other Quality Grades available.
See page 291

m_n Module - Cut with DIN 867 1.25/0.20/1.0
Ref. Tooth Profile Topping WD = 2.25 x m_n

Number of Teeth z

DL = Delrin POM (White)
PK = PEEK GF30® (Light Brown)

T = 1 x Tapped hole 2T = 2 x Tapped holes.
P = 1 x Pin Hole PT = 1 x Pin Hole thru.
All threads metric as standard,
refer to page 308 for sizes and prices.

K- Keyway supplied to
DIN 6885 - Js9 tolerance.
For prices see page 308

To specify different bore enter size required
Example: 12 = 12mm H7 etc
For prices see page 308

η Efficiency approx. 98%

Discounts: 6+ -5% 19+ -10%

Part Number	Delrin POM		Part Number	PEEK GF30®	
	T ₂ Nm n ₂ 100min ⁻¹	Price Each 1 - 5		T ₂ Nm n ₂ 100min ⁻¹	Price Each 1 - 5
PSG1.25-18DL	1.37	£11.60	PSG1.25-18PK	1.55	£58.78
PSG1.25-19DL	1.54	£11.78	PSG1.25-19PK	1.75	£59.67
PSG1.25-20DL	1.73	£11.95	PSG1.25-20PK	1.96	£60.56
PSG1.25-21DL	1.92	£12.33	PSG1.25-21PK	2.18	£62.46
PSG1.25-22DL	2.13	£12.51	PSG1.25-22PK	2.41	£63.37
PSG1.25-23DL	2.35	£12.56	PSG1.25-23PK	2.66	£63.65
PSG1.25-24DL	2.59	£12.64	PSG1.25-24PK	2.93	£64.00
PSG1.25-25DL	2.83	£13.16	PSG1.25-25PK	3.21	£66.66
PSG1.25-26DL	3.09	£13.63	PSG1.25-26PK	3.50	£69.06
PSG1.25-27DL	3.37	£13.91	PSG1.25-27PK	3.81	£70.47
PSG1.25-28DL	3.65	£14.22	PSG1.25-28PK	4.13	£72.06
PSG1.25-29DL	3.87	£14.60	PSG1.25-29PK	4.47	£73.93
PSG1.25-30DL	4.05	£14.84	PSG1.25-30PK	4.83	£75.19
PSG1.25-32DL	4.39	£15.22	PSG1.25-32PK	5.59	£77.12
PSG1.25-35DL	4.91	£15.75	PSG1.25-35PK	6.70	£79.73
PSG1.25-38DL	5.45	£16.39	PSG1.25-38PK	7.43	£82.96
PSG1.25-40DL	5.81	£16.98	PSG1.25-40PK	7.93	£86.04
PSG1.25-42DL	6.17	£17.11	PSG1.25-42PK	8.41	£86.66
PSG1.25-45DL	6.71	£17.36	PSG1.25-45PK	9.14	£87.91
PSG1.25-48DL	7.26	£17.50	PSG1.25-48PK	9.89	£88.65
PSG1.25-50DL	7.63	£19.32	PSG1.25-50PK	10.40	£97.85
PSG1.25-52DL	7.99	£19.89	PSG1.25-52PK	10.89	£100.75
PSG1.25-55DL	8.54	£20.72	PSG1.25-55PK	11.64	£104.95
PSG1.25-58DL	9.09	£21.35	PSG1.25-58PK	12.40	£108.12
PSG1.25-60DL	9.47	£21.85	PSG1.25-60PK	12.91	£110.63
PSG1.25-62DL	9.82	£22.56	PSG1.25-62PK	13.39	£114.26
PSG1.25-65DL	10.36	£24.18	PSG1.25-65PK	14.13	£122.44
PSG1.25-68DL	10.90	£25.43	PSG1.25-68PK	14.87	£128.75
PSG1.25-70DL	11.27	£25.95	PSG1.25-70PK	15.36	£131.41
PSG1.25-72DL	11.63	£26.51	PSG1.25-72PK	15.86	£134.26
PSG1.25-75DL	12.18	£28.28	PSG1.25-75PK	16.61	£143.23
PSG1.25-78DL	12.74	£28.71	PSG1.25-78PK	17.37	£145.39
PSG1.25-80DL	13.11	£29.29	PSG1.25-80PK	17.88	£148.34
PSG1.25-82DL	13.49	£29.71	PSG1.25-82PK	18.40	£150.45
PSG1.25-85DL	14.04	£30.35	PSG1.25-85PK	19.14	£153.68
PSG1.25-90DL	14.96	£31.33	PSG1.25-90PK	20.40	£158.61
PSG1.25-95DL	15.88	£34.68	PSG1.25-95PK	21.66	£175.61
PSG1.25-100DL	16.79	£35.14	PSG1.25-100PK	22.89	£177.93
PSG1.25-110DL	18.61	£43.99	PSG1.25-110PK	25.37	£222.74
PSG1.25-120DL	20.43	£49.74	PSG1.25-120PK	27.85	£251.88

+44 (0)1246 455500
+44 (0)1246 455522

ondrives

sales@ondrives.com
www.ondrives.com

Product information updated 1st April 2011 and subject to change. Please contact Sales for the latest prices and availability.

PSG-DL
PSG-PK
1.5m_n

PRECISION GEARS

1.5 Module Plastic Spur Gear α 20° PA

Quality Grade 8e25 DIN 3961/3967 (AGMA Q9)

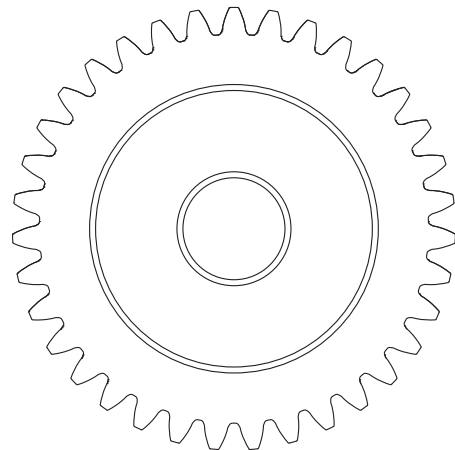
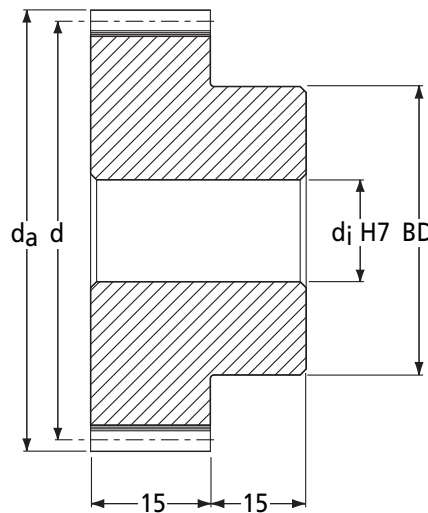
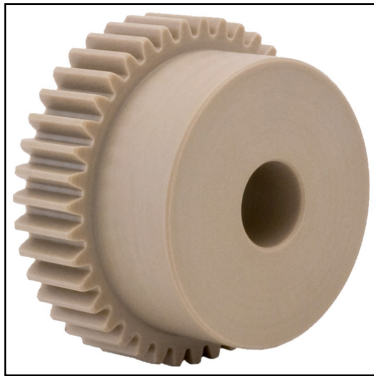

DIN 3967 Tooth Thickness tol.

Part Number	No. of Teeth z	Ref. Dia. d	Tip Dia. d _a	Bore H7 d _j	Max. Bore H7 d _j	Hub Dia. BD	Backlash (mm)		I Inertia kgm ² (Delrin)	Mass kg (Delrin)
							j _{t,e} (max)	j _{t,i} (min)		
PSG1.5-18DL	18	27.0	30.0	6	12	22	0.128 - 0.052	1.63 x 10 ⁻⁶	0.019	
PSG1.5-19DL	19	28.5	31.5	6	12	22	0.128 - 0.052	1.89 x 10 ⁻⁶	0.020	
PSG1.5-20DL	20	30.0	33.0	6	12	22	0.128 - 0.052	2.21 x 10 ⁻⁶	0.022	
PSG1.5-21DL	21	31.5	34.5	8	14	25	0.129 - 0.051	2.88 x 10 ⁻⁶	0.025	
PSG1.5-22DL	22	33.0	36.0	8	14	25	0.129 - 0.051	3.30 x 10 ⁻⁶	0.026	
PSG1.5-23DL	23	34.5	37.5	8	14	25	0.129 - 0.051	3.78 x 10 ⁻⁶	0.028	
PSG1.5-24DL	24	36.0	39.0	8	14	25	0.129 - 0.051	4.32 x 10 ⁻⁶	0.030	
PSG1.5-25DL	25	37.5	40.5	8	14	25	0.129 - 0.051	4.93 x 10 ⁻⁶	0.031	
PSG1.5-26DL	26	39.0	42.0	8	14	25	0.129 - 0.051	5.63 x 10 ⁻⁶	0.033	
PSG1.5-27DL	27	40.5	43.5	8	14	25	0.129 - 0.051	6.41 x 10 ⁻⁶	0.035	
PSG1.5-28DL	28	42.0	45.0	8	14	25	0.129 - 0.051	7.27 x 10 ⁻⁶	0.037	
PSG1.5-29DL	29	43.5	46.5	10	20	35	0.129 - 0.051	1.05 x 10 ⁻⁵	0.048	
PSG1.5-30DL	30	45.0	48.0	10	20	35	0.129 - 0.051	1.16 x 10 ⁻⁵	0.050	
PSG1.5-32DL	32	48.0	51.0	10	20	35	0.129 - 0.051	1.41 x 10 ⁻⁵	0.055	
PSG1.5-35DL	35	52.5	55.5	10	20	35	0.171 - 0.069	1.88 x 10 ⁻⁵	0.062	
PSG1.5-38DL	38	57.0	60.0	12	25	45	0.171 - 0.069	3.02 x 10 ⁻⁵	0.082	
PSG1.5-40DL	40	60.0	63.0	12	25	45	0.171 - 0.069	3.52 x 10 ⁻⁵	0.088	
PSG1.5-42DL	42	63.0	66.0	12	25	45	0.171 - 0.069	4.09 x 10 ⁻⁵	0.094	
PSG1.5-45DL	45	67.5	70.5	12	25	45	0.171 - 0.069	5.12 x 10 ⁻⁵	0.104	
PSG1.5-48DL	48	72.0	75.0	12	25	45	0.171 - 0.069	6.38 x 10 ⁻⁵	0.114	
PSG1.5-50DL	50	75.0	78.0	14	30	55	0.171 - 0.069	8.40 x 10 ⁻⁵	0.136	
PSG1.5-52DL	52	78.0	81.0	14	30	55	0.171 - 0.069	9.51 x 10 ⁻⁵	0.144	
PSG1.5-55DL	55	82.5	85.5	14	30	55	0.173 - 0.067	1.14 x 10 ⁻⁴	0.156	
PSG1.5-58DL	58	87.0	90.0	14	30	55	0.173 - 0.067	1.37 x 10 ⁻⁴	0.169	
PSG1.5-60DL	60	90.0	93.0	14	30	55	0.173 - 0.067	1.54 x 10 ⁻⁴	0.177	
PSG1.5-62DL	62	93.0	96.0	14	30	55	0.173 - 0.067	1.73 x 10 ⁻⁴	0.186	
PSG1.5-65DL	65	97.5	100.5	14	30	55	0.173 - 0.067	2.05 x 10 ⁻⁴	0.201	
PSG1.5-68DL	68	102.0	105.0	16	40	65	0.173 - 0.067	2.60 x 10 ⁻⁴	0.233	
PSG1.5-70DL	70	105.0	108.0	16	40	65	0.173 - 0.067	2.87 x 10 ⁻⁴	0.244	
PSG1.5-72DL	72	108.0	111.0	16	40	65	0.173 - 0.067	3.17 x 10 ⁻⁴	0.254	
PSG1.5-75DL	75	112.5	115.5	16	40	65	0.173 - 0.067	3.67 x 10 ⁻⁴	0.271	
PSG1.5-78DL	78	117.0	120.0	16	40	65	0.173 - 0.067	4.23 x 10 ⁻⁴	0.288	
PSG1.5-80DL	80	120.0	123.0	16	40	65	0.173 - 0.067	4.64 x 10 ⁻⁴	0.300	
PSG1.5-82DL	82	123.0	126.0	16	40	65	0.175 - 0.065	5.08 x 10 ⁻⁴	0.312	
PSG1.5-85DL	85	127.5	130.5	16	40	65	0.227 - 0.097	5.81 x 10 ⁻⁴	0.330	
PSG1.5-88DL	88	132.0	135.0	16	40	65	0.227 - 0.097	6.63 x 10 ⁻⁴	0.350	
PSG1.5-90DL	90	135.0	138.0	16	40	65	0.227 - 0.097	7.21 x 10 ⁻⁴	0.363	
PSG1.5-92DL	92	138.0	141.0	16	40	65	0.227 - 0.097	7.84 x 10 ⁻⁴	0.376	
PSG1.5-95DL	95	142.5	145.5	16	40	65	0.227 - 0.097	8.87 x 10 ⁻⁴	0.397	
PSG1.5-98DL	98	147.0	150.0	16	40	65	0.227 - 0.097	1.00 x 10 ⁻³	0.419	

+44 (0)1246 455500
+44 (0)1246 455522

ondrives

sales@ondrives.com
www.ondrives.com

Product information updated 1st April 2011 and subject to change. Please contact Sales for the latest prices and availability.

PRECISION GEARS

PSG-DL
PSG-PK
1.5m_n

1.5 Module Plastic Spur Gear α 20° PA

Quality Grade 8e25 DIN 3961/3967 (AGMA Q9)

Standard Part **PSG** **1.5** **50** **DL**
Modified Part **PSG** **1.5** **50** **PK** **20** **K** **T**

PSG - Precision Spur Gear
Quality Grade 8e25 DIN 3961/3967
Other Quality Grades available.
See page 291

m_n Module - Cut with DIN 867 1.25/0.20/1.0
Ref. Tooth Profile Topping WD = 2.25 x m_n

Number of Teeth z

DL = Delrin POM (White)
PK = PEEK GF30® (Light Brown)

T = 1 x Tapped hole 2T = 2 x Tapped holes.
P = 1 x Pin Hole PT = 1 x Pin Hole thru.
All threads metric as standard,
refer to page 308 for sizes and prices.

K- Keyway supplied to
DIN 6885 - Js9 tolerance.
For prices see page 308

To specify different bore enter size required
Example: 20 = 20mm H7 etc
For prices see page 308

η Efficiency approx. 98%

Discounts: 6+ -5% 19+ -10%

Part Number	Delrin POM		Part Number	PEEK GF30®	
	T ₂ Nm n ₂ 100min ⁻¹	Price Each 1 - 5		T ₂ Nm n ₂ 100min ⁻¹	Price Each 1 - 5
PSG1.5-18DL	1.90	£12.15	PSG1.5-18PK	2.15	£61.56
PSG1.5-19DL	2.14	£12.61	PSG1.5-19PK	2.43	£63.87
PSG1.5-20DL	2.40	£13.25	PSG1.5-20PK	2.71	£67.11
PSG1.5-21DL	2.67	£13.35	PSG1.5-21PK	3.02	£67.65
PSG1.5-22DL	2.96	£13.51	PSG1.5-22PK	3.35	£68.42
PSG1.5-23DL	3.27	£13.76	PSG1.5-23PK	3.70	£69.68
PSG1.5-24DL	3.59	£13.89	PSG1.5-24PK	4.06	£70.35
PSG1.5-25DL	3.93	£14.61	PSG1.5-25PK	4.45	£74.00
PSG1.5-26DL	4.30	£15.30	PSG1.5-26PK	4.86	£77.52
PSG1.5-27DL	4.67	£15.79	PSG1.5-27PK	5.29	£79.96
PSG1.5-28DL	5.07	£16.23	PSG1.5-28PK	5.74	£82.21
PSG1.5-29DL	5.49	£16.49	PSG1.5-29PK	6.21	£83.51
PSG1.5-30DL	5.93	£16.97	PSG1.5-30PK	6.70	£85.99
PSG1.5-32DL	6.86	£17.56	PSG1.5-32PK	7.76	£88.93
PSG1.5-35DL	7.98	£18.12	PSG1.5-35PK	9.51	£91.76
PSG1.5-38DL	8.86	£19.85	PSG1.5-38PK	11.47	£100.55
PSG1.5-40DL	9.45	£20.65	PSG1.5-40PK	12.89	£104.56
PSG1.5-42DL	10.03	£20.74	PSG1.5-42PK	13.67	£105.06
PSG1.5-45DL	10.90	£21.19	PSG1.5-45PK	14.86	£107.31
PSG1.5-48DL	11.79	£22.64	PSG1.5-48PK	16.08	£114.66
PSG1.5-50DL	12.40	£25.30	PSG1.5-50PK	16.91	£128.14
PSG1.5-52DL	12.99	£26.59	PSG1.5-52PK	17.71	£134.67
PSG1.5-55DL	13.88	£27.26	PSG1.5-55PK	18.92	£138.06
PSG1.5-58DL	14.78	£27.88	PSG1.5-58PK	20.15	£141.21
PSG1.5-60DL	15.39	£28.15	PSG1.5-60PK	20.98	£142.52
PSG1.5-62DL	15.97	£28.70	PSG1.5-62PK	21.77	£145.36
PSG1.5-65DL	16.84	£29.78	PSG1.5-65PK	22.97	£150.82
PSG1.5-68DL	17.72	£31.59	PSG1.5-68PK	24.17	£159.96
PSG1.5-70DL	18.31	£32.73	PSG1.5-70PK	24.97	£165.73
PSG1.5-72DL	18.91	£34.59	PSG1.5-72PK	25.78	£175.16
PSG1.5-75DL	19.80	£36.88	PSG1.5-75PK	27.00	£186.74
PSG1.5-78DL	20.71	£38.87	PSG1.5-78PK	28.23	£196.79
PSG1.5-80DL	21.31	£40.30	PSG1.5-80PK	29.06	£204.10
PSG1.5-82DL	21.93	£42.15	PSG1.5-82PK	29.91	£213.43
PSG1.5-85DL	22.82	£44.44	PSG1.5-85PK	31.12	£288.02
PSG1.5-88DL	23.72	£46.66	PSG1.5-88PK	32.34	£236.27
PSG1.5-90DL	24.31	£48.99	PSG1.5-90PK	33.16	£248.09
PSG1.5-92DL	24.91	£51.44	PSG1.5-92PK	33.97	£260.49
PSG1.5-95DL	25.82	£54.01	PSG1.5-95PK	35.21	£273.52
PSG1.5-98DL	26.73	£56.71	PSG1.5-98PK	36.45	£287.19

+44 (0)1246 455500
+44 (0)1246 455522

ondrives

sales@ondrives.com
www.ondrives.com

Product information updated 1st April 2011 and subject to change. Please contact Sales for the latest prices and availability.

PSG-DL
PSG-PK
2.0m_n

PRECISION GEARS

2.0 Module Plastic Spur Gear α 20° PA

Quality Grade 8e25 DIN 3961/3967 (AGMA Q9)

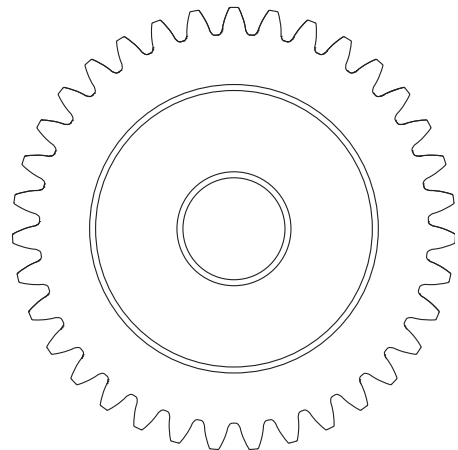
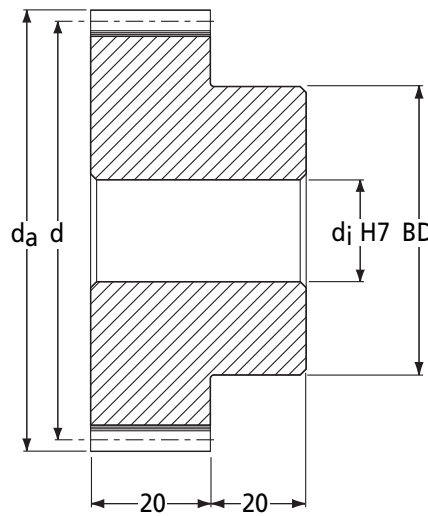

DIN 3967 Tooth Thickness tol.

Part Number	No. of Teeth <i>z</i>	Ref. Dia. <i>d</i>	Tip Dia. <i>d_a</i>	Bore H7 <i>d_j</i>	Max. Bore H7 <i>d_j</i>	Hub Dia. <i>BD</i>	Backlash (mm)		I Inertia <i>I</i> (Delrin) kgm ²	Mass <i>M</i> (Delrin) kg
							<i>j_{t,e}</i> (max)	<i>j_{t,i}</i> (min)		
PSG2.0-18DL	18	36	40	10	16	30	0.129 - 0.051	7.01 x 10 ⁻⁶	0.044	
PSG2.0-19DL	19	38	42	10	16	30	0.129 - 0.051	8.14 x 10 ⁻⁶	0.047	
PSG2.0-20DL	20	40	44	10	16	30	0.129 - 0.051	9.45 x 10 ⁻⁶	0.051	
PSG2.0-21DL	21	42	46	12	20	35	0.129 - 0.051	1.28 x 10 ⁻⁵	0.059	
PSG2.0-22DL	22	44	48	12	20	35	0.129 - 0.051	1.46 x 10 ⁻⁵	0.063	
PSG2.0-23DL	23	46	50	12	20	35	0.129 - 0.051	1.66 x 10 ⁻⁵	0.067	
PSG2.0-24DL	24	48	52	12	20	35	0.129 - 0.051	1.89 x 10 ⁻⁵	0.071	
PSG2.0-25DL	25	50	54	12	20	35	0.129 - 0.051	2.15 x 10 ⁻⁵	0.075	
PSG2.0-26DL	26	52	56	12	20	35	0.171 - 0.069	2.44 x 10 ⁻⁵	0.080	
PSG2.0-27DL	27	54	58	12	20	35	0.171 - 0.069	2.77 x 10 ⁻⁵	0.085	
PSG2.0-28DL	28	56	60	12	20	35	0.171 - 0.069	3.13 x 10 ⁻⁵	0.089	
PSG2.0-29DL	29	58	62	14	25	45	0.171 - 0.069	4.25 x 10 ⁻⁵	0.110	
PSG2.0-30DL	30	60	64	14	25	45	0.171 - 0.069	4.70 x 10 ⁻⁵	0.115	
PSG2.0-32DL	32	64	68	14	25	45	0.171 - 0.069	5.75 x 10 ⁻⁵	0.126	
PSG2.0-35DL	35	70	74	14	25	45	0.171 - 0.069	7.74 x 10 ⁻⁵	0.144	
PSG2.0-38DL	38	76	80	14	25	45	0.171 - 0.069	1.03 x 10 ⁻⁴	0.163	
PSG2.0-40DL	40	80	84	16	30	55	0.171 - 0.069	1.38 x 10 ⁻⁴	0.196	
PSG2.0-42DL	42	84	88	16	30	55	0.173 - 0.067	1.62 x 10 ⁻⁴	0.211	
PSG2.0-45DL	45	90	94	16	30	55	0.173 - 0.067	2.05 x 10 ⁻⁴	0.234	
PSG2.0-48DL	48	96	100	16	30	55	0.173 - 0.067	2.58 x 10 ⁻⁴	0.258	
PSG2.0-50DL	50	100	104	20	40	65	0.173 - 0.067	3.23 x 10 ⁻⁴	0.296	
PSG2.0-52DL	52	104	108	20	40	65	0.173 - 0.067	3.70 x 10 ⁻⁴	0.314	
PSG2.0-55DL	55	110	114	20	40	65	0.173 - 0.067	4.51 x 10 ⁻⁴	0.342	
PSG2.0-58DL	58	116	120	20	40	65	0.173 - 0.067	5.46 x 10 ⁻⁴	0.372	
PSG2.0-60DL	60	120	124	20	40	65	0.173 - 0.067	6.18 x 10 ⁻⁴	0.393	
PSG2.0-62DL	62	124	128	20	40	65	0.175 - 0.065	6.98 x 10 ⁻⁴	0.414	
PSG2.0-65DL	65	130	134	20	40	65	0.227 - 0.097	8.33 x 10 ⁻⁴	0.448	
PSG2.0-68DL	68	136	140	20	40	65	0.227 - 0.097	9.88 x 10 ⁻⁴	0.483	
PSG2.0-70DL	70	140	144	20	40	65	0.227 - 0.097	1.10 x 10 ⁻³	0.507	
PSG2.0-72DL	72	144	148	20	40	65	0.227 - 0.097	1.23 x 10 ⁻³	0.532	

PRECISION GEARS

PSG-DL
PSG-PK
2.0m_n

2.0 Module Plastic Spur Gear α 20° PA

Quality Grade 8e25 DIN 3961/3967 (AGMA Q9)

Standard Part **PSG** **2.0** **50** **DL**
Modified Part **PSG** **2.0** **50** **PK** **25** **K** **T**

PSG - Precision Spur Gear
Quality Grade 8e25 DIN 3961/3967
Other Quality Grades available.
See page 291

m_n Module - Cut with DIN 867 1.25/0.20/1.0
Ref. Tooth Profile Topping WD = 2.25 x m_n

Number of Teeth z

DL = Delrin POM (White)
PK = PEEK GF30® (Light Brown)

T = 1 x Tapped hole 2T = 2 x Tapped holes.
P = 1 x Pin Hole PT = 1 x Pin Hole thru.
All threads metric as standard,
refer to page 308 for sizes and prices.

K- Keyway supplied to
DIN 6885 - Js9 tolerance.
For prices see page 308

To specify different bore enter size required
Example: 25 = 25mm H7 etc
For prices see page 308

η Efficiency approx. 98%

Discounts: 6+ -5% 19+ -10%

Part Number	Delrin POM		Part Number	PEEK GF30®	
	T ₂ Nm n ₂ 100min ⁻¹	Price Each 1 - 5		T ₂ Nm n ₂ 100min ⁻¹	Price Each 1 - 5
PSG2.0-18DL	3.20	£18.27	PSG2.0-18PK	3.62	£92.49
PSG2.0-19DL	3.60	£18.67	PSG2.0-19PK	4.07	£94.60
PSG2.0-20DL	4.03	£19.06	PSG2.0-20PK	4.56	£96.54
PSG2.0-21DL	4.48	£19.57	PSG2.0-21PK	5.07	£99.11
PSG2.0-22DL	4.97	£19.87	PSG2.0-22PK	5.62	£100.64
PSG2.0-23DL	5.48	£20.29	PSG2.0-23PK	6.21	£102.76
PSG2.0-24DL	6.03	£20.73	PSG2.0-24PK	6.82	£105.02
PSG2.0-25DL	6.60	£21.90	PSG2.0-25PK	7.47	£110.87
PSG2.0-26DL	7.21	£22.60	PSG2.0-26PK	8.16	£114.44
PSG2.0-27DL	7.85	£23.40	PSG2.0-27PK	8.88	£118.50
PSG2.0-28DL	8.51	£23.90	PSG2.0-28PK	9.63	£121.06
PSG2.0-29DL	9.21	£24.50	PSG2.0-29PK	10.42	£124.08
PSG2.0-30DL	9.95	£25.05	PSG2.0-30PK	11.25	£126.83
PSG2.0-32DL	11.51	£27.20	PSG2.0-32PK	13.02	£137.75
PSG2.0-35DL	14.10	£30.03	PSG2.0-35PK	15.96	£152.04
PSG2.0-38DL	17.01	£32.97	PSG2.0-38PK	19.25	£166.91
PSG2.0-40DL	19.13	£34.35	PSG2.0-40PK	21.64	£173.94
PSG2.0-42DL	21.14	£35.40	PSG2.0-42PK	24.20	£179.25
PSG2.0-45DL	22.99	£36.94	PSG2.0-45PK	28.36	£187.06
PSG2.0-48DL	24.87	£39.78	PSG2.0-48PK	32.90	£201.44
PSG2.0-50DL	26.15	£42.59	PSG2.0-50PK	35.66	£215.68
PSG2.0-52DL	27.39	£44.17	PSG2.0-52PK	37.35	£223.66
PSG2.0-55DL	29.27	£49.88	PSG2.0-55PK	39.91	£252.55
PSG2.0-58DL	31.17	£52.89	PSG2.0-58PK	42.50	£267.83
PSG2.0-60DL	32.45	£54.24	PSG2.0-60PK	44.26	£274.64
PSG2.0-62DL	33.68	£55.57	PSG2.0-62PK	45.92	£281.35
PSG2.0-65DL	35.52	£57.54	PSG2.0-65PK	48.44	£288.54
PSG2.0-68DL	37.38	£59.27	PSG2.0-68PK	50.97	£301.99
PSG2.0-70DL	38.62	£61.05	PSG2.0-70PK	52.67	£303.21
PSG2.0-72DL	39.88	£62.88	PSG2.0-72PK	54.38	£310.73

+44 (0)1246 455500
+44 (0)1246 455522

ondrives

sales@ondrives.com
www.ondrives.com

Product information updated 1st April 2011 and subject to change. Please contact Sales for the latest prices and availability.

PSG-DL
PSG-PK
2.5m_n

PRECISION GEARS

2.5 Module Plastic Spur Gear α 20° PA

Quality Grade 8e25 DIN 3961/3967 (AGMA Q9)

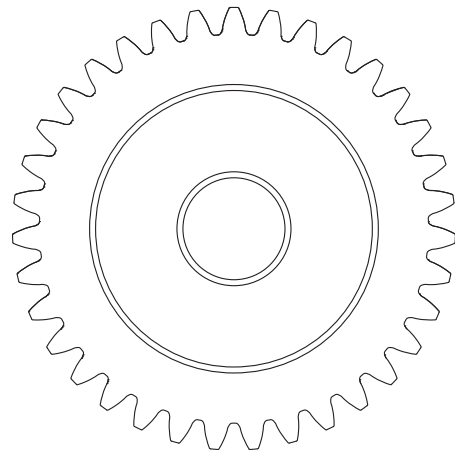
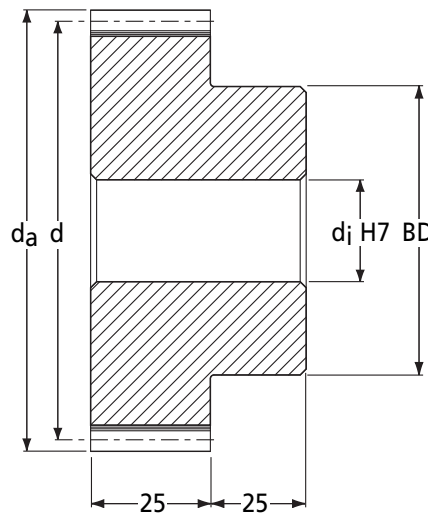

DIN 3967 Tooth Thickness tol.

Part Number	No. of Teeth <i>z</i>	Ref. Dia. <i>d</i>	Tip Dia. <i>d_a</i>	Bore H7 <i>d_j</i>	Max. Bore H7 <i>d_j</i>	Hub Dia. <i>BD</i>	Backlash (mm)		I Inertia <i>kgm² (Delrin)</i>	Mass <i>kg (Delrin)</i>
							<i>j_{t,e} (max)</i>	<i>j_{t,i} (min)</i>		
PSG2.5-18DL	18	45.0	50.0	14	18	35	0.129 - 0.051	1.96 x 10 ⁻⁵	0.078	
PSG2.5-19DL	19	47.5	52.5	14	18	35	0.129 - 0.051	2.31 x 10 ⁻⁵	0.085	
PSG2.5-20DL	20	50.0	55.0	14	18	35	0.129 - 0.051	2.71 x 10 ⁻⁵	0.091	
PSG2.5-21DL	21	52.5	57.5	14	18	35	0.171 - 0.069	3.18 x 10 ⁻⁵	0.098	
PSG2.5-22DL	22	55.0	60.0	14	18	35	0.171 - 0.069	3.71 x 10 ⁻⁵	0.106	
PSG2.5-23DL	23	57.5	62.5	16	25	45	0.171 - 0.069	5.21 x 10 ⁻⁵	0.132	
PSG2.5-24DL	24	60.0	65.0	16	25	45	0.171 - 0.069	5.91 x 10 ⁻⁵	0.140	
PSG2.5-25DL	25	62.5	67.5	16	25	45	0.171 - 0.069	6.70 x 10 ⁻⁵	0.149	
PSG2.5-26DL	26	65.0	70.0	16	25	45	0.171 - 0.069	7.59 x 10 ⁻⁵	0.157	
PSG2.5-27DL	27	67.5	72.5	16	25	45	0.171 - 0.069	8.59 x 10 ⁻⁵	0.167	
PSG2.5-28DL	28	70.0	75.0	16	25	45	0.171 - 0.069	9.71 x 10 ⁻⁵	0.176	
PSG2.5-29DL	29	72.5	77.5	18	35	55	0.171 - 0.069	1.27 x 10 ⁻⁴	0.210	
PSG2.5-30DL	30	75.0	80.0	18	35	55	0.171 - 0.069	1.40 x 10 ⁻⁴	0.220	
PSG2.5-32DL	32	80.0	85.0	18	35	55	0.171 - 0.069	1.72 x 10 ⁻⁴	0.241	
PSG2.5-35DL	35	87.5	92.5	18	35	55	0.173 - 0.067	2.33 x 10 ⁻⁴	0.276	
PSG2.5-38DL	38	95.0	100.0	20	40	70	0.173 - 0.067	3.62 x 10 ⁻⁴	0.361	
PSG2.5-40DL	40	100.0	105.0	20	40	70	0.173 - 0.067	4.26 x 10 ⁻⁴	0.388	
PSG2.5-42DL	42	105.0	110.0	20	40	70	0.173 - 0.067	5.00 x 10 ⁻⁴	0.416	
PSG2.5-45DL	45	112.5	117.5	20	40	70	0.173 - 0.067	6.32 x 10 ⁻⁴	0.461	
PSG2.5-48DL	48	120.0	125.0	20	40	70	0.173 - 0.067	7.94 x 10 ⁻⁴	0.509	
PSG2.5-50DL	50	125.0	130.0	20	40	70	0.175 - 0.065	9.20 x 10 ⁻⁴	0.543	
PSG2.5-52DL	52	130.0	135.0	20	40	70	0.227 - 0.097	1.06 x 10 ⁻³	0.578	
PSG2.5-55DL	55	137.5	142.5	20	40	70	0.227 - 0.097	1.31 x 10 ⁻³	0.633	
PSG2.5-58DL	58	145.0	150.0	20	40	70	0.227 - 0.097	1.60 x 10 ⁻³	0.691	

PRECISION GEARS

PSG-DL
PSG-PK
2.5m_n

2.5 Module Plastic Spur Gear α 20° PA

Quality Grade 8e25 DIN 3961/3967 (AGMA Q9)

Standard Part **PSG** **2.5** **50** **DL**
Modified Part **PSG** **2.5** **50** **PK** **25** **K** **T**

PSG - Precision Spur Gear
Quality Grade 8e25 DIN 3961/3967
Other Quality Grades available.
See page 291

m_n Module - Cut with DIN 867 1.25/0.20/1.0
Ref. Tooth Profile Topping WD = 2.25 x m_n

Number of Teeth z

DL = Delrin POM (White)
PK = PEEK GF30® (Light Brown)

T = 1 x Tapped hole 2T = 2 x Tapped holes.
P = 1 x Pin Hole PT = 1 x Pin Hole thru.
All threads metric as standard,
refer to page 308 for sizes and prices.

K- Keyway supplied to
DIN 6885 - Js9 tolerance.
For prices see page 308

To specify different bore enter size required
Example: 25 = 25mm H7 etc
For prices see page 308

η Efficiency approx. 98%

Discounts: 6+ -5% 19+ -10%

Part Number	Delrin POM		Part Number	PEEK GF30®	
	T ₂ Nm n ₂ 100min ⁻¹	Price Each 1 - 5		T ₂ Nm n ₂ 100min ⁻¹	Price Each 1 - 5
PSG2.5-18DL	4.78	£24.58	PSG2.5-18PK	5.40	£124.44
PSG2.5-19DL	5.38	£25.24	PSG2.5-19PK	6.08	£127.78
PSG2.5-20DL	6.02	£26.16	PSG2.5-20PK	6.81	£132.47
PSG2.5-21DL	6.70	£26.79	PSG2.5-21PK	7.58	£135.66
PSG2.5-22DL	7.43	£27.76	PSG2.5-22PK	8.40	£140.54
PSG2.5-23DL	8.20	£28.46	PSG2.5-23PK	9.27	£144.10
PSG2.5-24DL	9.01	£29.28	PSG2.5-24PK	10.19	£148.29
PSG2.5-25DL	9.87	£30.88	PSG2.5-25PK	11.17	£156.36
PSG2.5-26DL	10.77	£32.44	PSG2.5-26PK	12.19	£164.30
PSG2.5-27DL	11.72	£33.12	PSG2.5-27PK	13.27	£167.71
PSG2.5-28DL	12.72	£33.98	PSG2.5-28PK	14.39	£172.09
PSG2.5-29DL	13.77	£35.10	PSG2.5-29PK	15.58	£177.72
PSG2.5-30DL	14.86	£36.30	PSG2.5-30PK	16.81	£183.82
PSG2.5-32DL	17.20	£38.49	PSG2.5-32PK	19.46	£194.90
PSG2.5-35DL	21.08	£40.78	PSG2.5-35PK	23.85	£206.48
PSG2.5-38DL	25.42	£44.82	PSG2.5-38PK	28.76	£226.95
PSG2.5-40DL	28.58	£46.59	PSG2.5-40PK	32.34	£235.92
PSG2.5-42DL	31.96	£48.44	PSG2.5-42PK	36.17	£245.29
PSG2.5-45DL	37.45	£50.16	PSG2.5-45PK	42.38	£254.00
PSG2.5-48DL	43.46	£53.73	PSG2.5-48PK	49.17	£272.07
PSG2.5-50DL	47.75	£56.71	PSG2.5-50PK	54.02	£287.12
PSG2.5-52DL	50.18	£60.38	PSG2.5-52PK	59.15	£299.96
PSG2.5-55DL	53.62	£64.00	PSG2.5-55PK	67.35	£314.96
PSG2.5-58DL	57.11	£67.84	PSG2.5-58PK	76.17	£330.70

PSG-DL
PSG-PK
3.0m_n

PRECISION GEARS

3.0 Module Plastic Spur Gear α 20° PA

Quality Grade 8e25 DIN 3961/3967 (AGMA Q9)

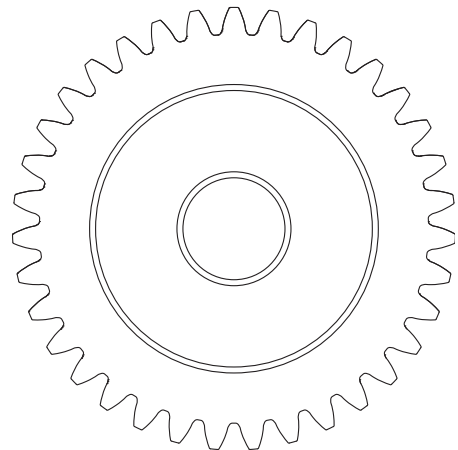
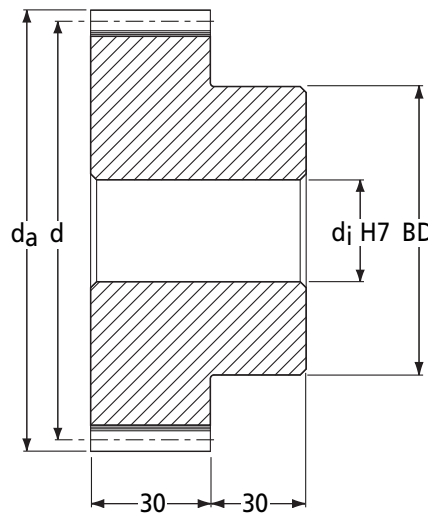
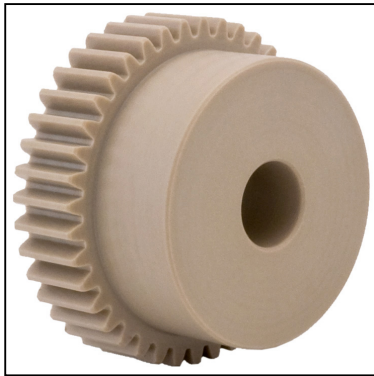

DIN 3967 Tooth Thickness tol.

Part Number	No. of Teeth <i>z</i>	Ref. Dia. <i>d</i>	Tip Dia. <i>d_a</i>	Bore H7 <i>d_j</i>	Max. Bore H7 <i>d_j</i>	Hub Dia. <i>BD</i>	Backlash (mm)		I Inertia <i>kgm² (Delrin)</i>	Mass <i>kg (Delrin)</i>
							<i>j_{t,e} (max)</i>	<i>j_{t,i} (min)</i>		
PSG3.0-18DL	18	54	60	14	25	45	0.171	-0.069	5.33 x 10 ⁻⁵	0.150
PSG3.0-19DL	19	57	63	14	25	45	0.171	-0.069	6.19 x 10 ⁻⁵	0.161
PSG3.0-20DL	20	60	66	14	25	45	0.171	-0.069	7.19 x 10 ⁻⁵	0.172
PSG3.0-21DL	21	63	69	16	30	55	0.171	-0.069	1.04 x 10 ⁻⁴	0.214
PSG3.0-22DL	22	66	72	16	30	55	0.171	-0.069	1.18 x 10 ⁻⁴	0.226
PSG3.0-23DL	23	69	75	16	30	55	0.171	-0.069	1.33 x 10 ⁻⁴	0.240
PSG3.0-24DL	24	72	78	16	30	55	0.171	-0.069	1.50 x 10 ⁻⁴	0.254
PSG3.0-25DL	25	75	81	16	30	55	0.171	-0.069	1.70 x 10 ⁻⁴	0.268
PSG3.0-26DL	26	78	84	16	30	55	0.171	-0.069	1.92 x 10 ⁻⁴	0.283
PSG3.0-27DL	27	81	87	16	30	55	0.173	-0.067	2.17 x 10 ⁻⁴	0.299
PSG3.0-28DL	28	84	90	16	30	55	0.173	-0.067	2.45 x 10 ⁻⁴	0.315
PSG3.0-29DL	29	87	93	18	40	70	0.173	-0.067	3.37 x 10 ⁻⁴	0.390
PSG3.0-30DL	30	90	96	18	40	70	0.173	-0.067	3.71 x 10 ⁻⁴	0.407
PSG3.0-32DL	32	96	102	18	40	70	0.173	-0.067	4.51 x 10 ⁻⁴	0.444
PSG3.0-35DL	35	105	111	18	40	70	0.173	-0.067	6.02 x 10 ⁻⁴	0.504
PSG3.0-38DL	38	114	120	18	40	70	0.173	-0.067	7.97 x 10 ⁻⁴	0.569
PSG3.0-40DL	40	120	126	18	40	70	0.173	-0.067	9.55 x 10 ⁻⁴	0.615
PSG3.0-42DL	42	126	132	18	40	80	0.227	-0.097	1.21 x 10 ⁻³	0.714
PSG3.0-45DL	45	135	141	18	40	80	0.227	-0.097	1.54 x 10 ⁻³	0.791
PSG3.0-48DL	48	144	150	18	40	80	0.227	-0.097	1.94 x 10 ⁻³	0.874

PRECISION GEARS

PSG-DL
PSG-PK
3.0m_n

3.0 Module Plastic Spur Gear α 20° PA

Quality Grade 8e25 DIN 3961/3967 (AGMA Q9)

Standard Part **PSG** **3.0** **40** **DL**

Modified Part **PSG** **3.0** **40** **PK** **25** **K** **T**

PSG - Precision Spur Gear
Quality Grade 8e25 DIN 3961/3967
Other Quality Grades available.
See page 291

m_n Module - Cut with DIN 867 1.25/0.20/1.0
Ref. Tooth Profile Topping WD = 2.25 x m_n

Number of Teeth z

DL = Delrin POM (White)
PK = PEEK GF30® (Light Brown)

T = 1 x Tapped hole 2T = 2 x Tapped holes.
P = 1 x Pin Hole PT = 1 x Pin Hole thru.
All threads metric as standard,
refer to page 308 for sizes and prices.

K- Keyway supplied to
DIN 6885 - Js9 tolerance.
For prices see page 308

To specify different bore enter size required
Example: 25 = 25mm H7 etc
For prices see page 308

η Efficiency approx. 98%

Discounts: 6+ -5% 19+ -10%

Part Number	Delrin POM		Part Number	PEEK GF30®	
	T ₂ Nm n ₂ 100min ⁻¹	Price Each 1 - 5		T ₂ Nm n ₂ 100min ⁻¹	Price Each 1 - 5
PSG3.0-18DL	6.63	£21.80	PSG3.0-18PK	7.50	£110.43
PSG3.0-19DL	7.46	£22.62	PSG3.0-19PK	8.45	£114.57
PSG3.0-20DL	8.35	£23.37	PSG3.0-20PK	9.45	£118.36
PSG3.0-21DL	9.30	£24.13	PSG3.0-21PK	10.53	£122.24
PSG3.0-22DL	10.31	£24.96	PSG3.0-22PK	11.67	£126.42
PSG3.0-23DL	11.38	£25.76	PSG3.0-23PK	12.88	£130.43
PSG3.0-24DL	12.51	£26.50	PSG3.0-24PK	14.15	£134.18
PSG3.0-25DL	13.70	£28.10	PSG3.0-25PK	15.50	£142.30
PSG3.0-26DL	14.96	£29.71	PSG3.0-26PK	16.92	£150.45
PSG3.0-27DL	16.28	£30.42	PSG3.0-27PK	18.42	£154.06
PSG3.0-28DL	17.66	£31.27	PSG3.0-28PK	19.99	£158.34
PSG3.0-29DL	19.12	£32.56	PSG3.0-29PK	21.63	£164.84
PSG3.0-30DL	20.63	£33.73	PSG3.0-30PK	23.35	£170.79
PSG3.0-32DL	23.88	£36.18	PSG3.0-32PK	27.01	£183.18
PSG3.0-35DL	29.26	£41.91	PSG3.0-35PK	33.11	£212.21
PSG3.0-38DL	35.30	£44.98	PSG3.0-38PK	39.93	£227.76
PSG3.0-40DL	39.69	£46.25	PSG3.0-40PK	44.90	£234.17
PSG3.0-42DL	44.38	£47.72	PSG3.0-42PK	50.21	£241.63
PSG3.0-45DL	52.00	£49.15	PSG3.0-45PK	58.84	£248.88
PSG3.0-48DL	60.33	£50.62	PSG3.0-48PK	68.26	£256.35