

**PHG**  
**3.0m<sub>n</sub>**

# PRECISION GEARS

## 3.0 Module 15° Parallel Helical Gear α 20° PA

Quality Grade 7e25 DIN 3961/3967 (AGMA Q10)

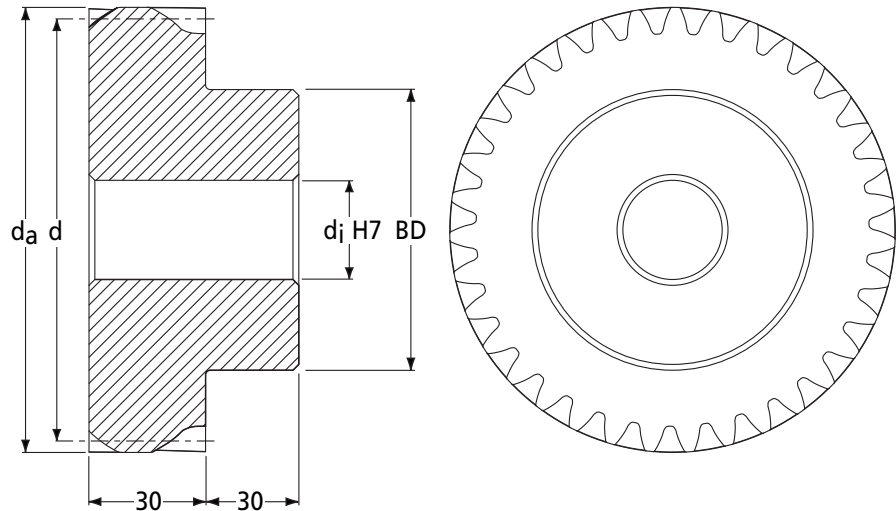

DIN 3967 Tooth Thickness tol.

Part Number	No. of Teeth <i>z</i>	Ref. Dia. <i>d</i>	Tip Dia. <i>d<sub>a</sub></i>	Bore H7 <i>d<sub>j</sub></i>	Max. Bore H7 <i>d<sub>j</sub></i>	Hub Dia. <i>BD</i>	Backlash (mm)		I Inertia <i>kgm<sup>2</sup></i>	Mass <i>kg</i>
							<i>j<sub>t,e</sub></i> (max)	<i>j<sub>t,i</sub></i> (min)		
PHG3.0-15R	15	46.59	52.59	14	20	38	0.134 - 0.053	1.62 x 10 <sup>-4</sup>	0.592	
PHG3.0-16R	16	49.69	55.69	14	20	38	0.134 - 0.053	1.94 x 10 <sup>-4</sup>	0.646	
PHG3.0-17R	17	52.80	58.80	14	20	38	0.177 - 0.072	2.33 x 10 <sup>-4</sup>	0.704	
PHG3.0-18R	18	55.90	61.90	14	20	38	0.177 - 0.072	2.80 x 10 <sup>-4</sup>	0.766	
PHG3.0-19R	19	59.01	65.01	14	20	38	0.177 - 0.072	3.34 x 10 <sup>-4</sup>	0.831	
PHG3.0-20R	20	62.12	68.12	14	20	38	0.177 - 0.072	3.98 x 10 <sup>-4</sup>	0.900	
PHG3.0-21R	21	65.22	71.22	14	20	38	0.177 - 0.072	4.72 x 10 <sup>-4</sup>	0.972	
PHG3.0-22R	22	68.33	74.33	16	30	55	0.177 - 0.072	7.20 x 10 <sup>-4</sup>	1.318	
PHG3.0-23R	23	71.43	77.43	16	30	55	0.177 - 0.072	8.17 x 10 <sup>-4</sup>	1.397	
PHG3.0-24R	24	74.54	80.54	16	30	55	0.177 - 0.072	9.28 x 10 <sup>-4</sup>	1.480	
PHG3.0-25R	25	77.65	83.65	16	30	55	0.179 - 0.070	1.05 x 10 <sup>-3</sup>	1.567	
PHG3.0-26R	26	80.75	86.75	16	30	55	0.179 - 0.070	1.20 x 10 <sup>-3</sup>	1.657	
PHG3.0-27R	27	83.86	89.86	16	30	55	0.179 - 0.070	1.36 x 10 <sup>-3</sup>	1.751	
PHG3.0-28R	28	86.96	92.96	16	30	55	0.179 - 0.070	1.53 x 10 <sup>-3</sup>	1.848	
PHG3.0-29R	29	90.07	96.07	20	40	70	0.179 - 0.070	2.07 x 10 <sup>-3</sup>	2.240	
PHG3.0-30R	30	93.17	99.17	20	40	70	0.179 - 0.070	2.29 x 10 <sup>-3</sup>	2.350	
PHG3.0-32R	32	99.39	105.39	20	40	70	0.179 - 0.070	2.80 x 10 <sup>-3</sup>	2.570	
PHG3.0-35R	35	108.70	114.70	20	40	70	0.179 - 0.070	3.76 x 10 <sup>-3</sup>	2.920	
PHG3.0-38R	38	118.02	124.02	20	40	70	0.179 - 0.070	5.01 x 10 <sup>-3</sup>	3.310	
PHG3.0-40R	40	124.23	130.23	20	40	70	0.181 - 0.069	6.02 x 10 <sup>-3</sup>	3.590	

# PRECISION GEARS

## 3.0 Module 15° Parallel Helical Gear α 20° PA

Quality Grade 7e25 DIN 3961/3967 (AGMA Q10)

**PHG**  
**3.0m<sub>n</sub>**

Standard Part PHG 3.0-40 R

Modified Part PHG 3.0-40 L H 30 K T

PHG - Precision Helical Gear  
Quality Grade 7e25 DIN 3961/3967  
Other Quality Grades available.  
See page 293

m<sub>n</sub> Module - Cut with DIN 867 1.25/0.20/1.0  
Ref. Tooth Profile Topping WD = 2.25 x m<sub>n</sub>

Number of Teeth z

Right Hand Helix (R) runs with  
Left Hand Helix (L)

Standard Material = 817M40T (28HRC)  
H = 805M20 Case Hardened (58HRC)

T = 1 x Tapped hole 2T = 2 x Tapped holes.  
P = 1 x Pin Hole PT = 1 x Pin Hole thru.  
All threads metric as standard,  
refer to page 308 for sizes and prices.

K- Keyway supplied to  
DIN 6885 - Js9 tolerance.  
For prices see page 308

To specify different bore enter size required  
Example: 30 = 30mm H7 etc  
For prices see page 308

# Quality Grades and Tolerances stated prior to heat treatment processes.

η Efficiency approx. 98%

**Discounts: 6+ -5% 19+ -10%**

Part Number	817M40T (28HRC)		Case Hardened 805M20 (58HRC)#		
	T <sub>2</sub> Nm n <sub>2</sub> 100min <sup>-1</sup>	Price Each 1 - 5	Part Number	T <sub>2</sub> Nm n <sub>2</sub> 100min <sup>-1</sup>	Price Each 1 - 5
PHG3.0-15R	30.26	£40.12	PHG3.0-15RH	110.96	£66.20
PHG3.0-16R	32.28	£41.62	PHG3.0-16RH	118.36	£68.67
PHG3.0-17R	34.30	£42.93	PHG3.0-17RH	125.76	£70.84
PHG3.0-18R	36.31	£44.39	PHG3.0-18RH	133.15	£73.24
PHG3.0-19R	38.33	£45.93	PHG3.0-19RH	140.55	£75.79
PHG3.0-20R	51.35	£47.35	PHG3.0-20RH	188.30	£78.13
PHG3.0-21R	53.92	£48.73	PHG3.0-21RH	197.71	£80.40
PHG3.0-22R	56.49	£51.63	PHG3.0-22RH	207.13	£85.20
PHG3.0-23R	59.06	£54.48	PHG3.0-23RH	216.54	£89.91
PHG3.0-24R	61.62	£55.86	PHG3.0-24RH	225.96	£92.16
PHG3.0-25R	64.19	£57.50	PHG3.0-25RH	235.37	£94.88
PHG3.0-26R	84.00	£59.24	PHG3.0-26RH	308.00	£97.74
PHG3.0-27R	87.23	£61.37	PHG3.0-27RH	319.85	£101.28
PHG3.0-28R	90.46	£65.86	PHG3.0-28RH	331.70	£108.67
PHG3.0-29R	93.69	£76.29	PHG3.0-29RH	343.54	£125.88
PHG3.0-30R	110.47	£81.91	PHG3.0-30RH	405.05	£135.15
PHG3.0-32R	117.83	£84.16	PHG3.0-32RH	432.05	£138.87
PHG3.0-35R	128.88	£86.69	PHG3.0-35RH	472.56	£143.06
PHG3.0-38R	139.93	£123.29	PHG3.0-38RH	513.06	£203.42
PHG3.0-40R	188.49	£126.67	PHG3.0-40RH	656.36	£209.01

+44 (0)1246 455500

+44 (0)1246 455522

**ondrives**

sales@ondrives.com

www.ondrives.com

Product information updated 1st April 2011 and subject to change. Please contact Sales for the latest prices and availability.