

PBG

**CAD
Drawings
Available
On Request**

PRECISION GEARS

Straight Cut Bevel Gears $\alpha 20^\circ$ PA

1:1 Ratio - Quality Grade 7f24 DIN 3985

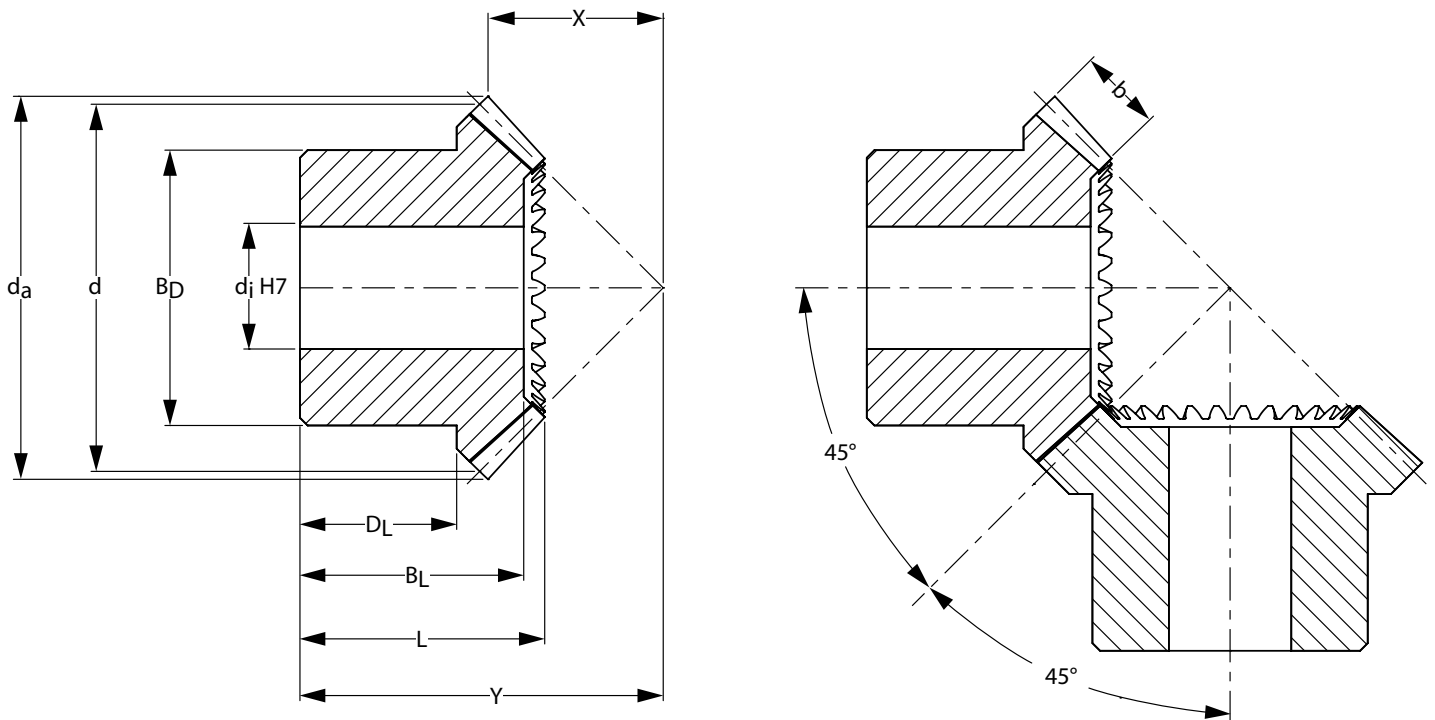

DIN 3967 Tooth Thickness tol.

Part Number		Module	No. of Teeth	Pitch Dia.	Outside Dia.	Mounting Distance	Face Width	Bore H7	Length	Length	Boss Dia.	Boss Length	Pitch Apex to Crown
817M40T	303 Stainless	m_n	z	d	d_a	Y	b	d_j	B_L	L	B_D	D_L	X
PBG0.6-30	PBG0.6-30S	0.6	30	18	18.85	20	4.0	6	13.0	14.0	12	9	8.58
PBG0.8-30	PBG0.8-30S	0.8	30	24	25.13	25	5.5	8	16.0	17.0	18	10	11.43
PBG1.0-30	PBG1.0-30S	1.0	30	30	31.41	30	7.0	8	18.5	20.0	22	12	14.29
PBG1.5-30	PBG1.5-30S	1.5	30	45	47.12	40	10.0	10	23.0	25.0	35	14	21.44
PBG2.0-30	PBG2.0-30S	2.0	30	60	62.83	50	13.5	12	28.0	30.5	40	15	28.59
PBG4.0-17	PBG4.0-17S	4.0	17	68	73.66	60	16.0	25	34.5	39.0	50	20	31.17



+44 (0)1246 455500



+44 (0)1246 455522

ondrives



sales@ondrives.com



www.ondrives.com

Product information updated March 2017 and subject to change. Please click the product links for prices and availability.

PBG**CAD
Drawings
Available
On Request**

PRECISION GEARS

Straight Cut Bevel Gears α 20° PA

1:1 Ratio - Quality Grade 7f24 DIN 3985

Standard Part **PBG 0.8 30**Modified Part **PBG 0.8 30 S 1:1 K T**

PBG - Precision Straight Tooth Bevel Gear
Quality Grade 7f24 DIN 3985
Other Quality Grades available.
See Technical

m_n Module - Cut with DIN 867 1.25/0.20/1.0

Number of Teeth **z**

Standard Material = 817M40T
S = 303 Stainless Steel

T = 1 x Tapped hole **2T** = 2 x Tapped holes
P = 1 x Pin Hole **PT** = 1 x Pin Hole through
All threads metric as standard.
See Technical

K- Keyway supplied to
DIN 6885 - Js9 tolerance.
See Technical

Ratio

η Efficiency approx. 88%.

805M20 case hardened and 2:1 ratio available, P.O.A.

Mass and inertia values are for individual gear without keyway or tapped/pin hole.

Part Number 817M40T	Inertia kgm^2	Mass kg	Torque T_2 Nm n_2 100 Rpm	Part Number 303 Stainless	Inertia kgm^2	Mass kg	Torque T_2 Nm n_2 100 Rpm
PBG0.6-30	3.50×10^{-7}	0.012	0.69	PBG0.6-30S	3.60×10^{-7}	0.012	0.41
PBG0.8-30	1.71×10^{-6}	0.030	1.56	PBG0.8-30S	1.75×10^{-6}	0.031	0.94
PBG1.0-30	4.77×10^{-6}	0.057	2.95	PBG1.0-30S	4.89×10^{-6}	0.059	1.77
PBG1.5-30	3.48×10^{-5}	0.181	8.94	PBG1.5-30S	3.57×10^{-5}	0.186	5.36
PBG2.0-30	1.16×10^{-4}	0.354	20.14	PBG2.0-30S	1.19×10^{-4}	0.363	12.08
PBG4.0-17	1.79×10^{-4}	0.419	24.62	PBG4.0-17S	1.83×10^{-4}	0.430	14.77



+44 (0)1246 455500



+44 (0)1246 455522



sales@ondrives.com



www.ondrives.com

Product information updated March 2017 and subject to change. Please click the product links for prices and availability.