

MR
MMR

COMMERCIAL GEARS

Spur Gear Racks $\alpha 20^\circ$ PA

1 - 6 Module • Metric Toothed Rack Section

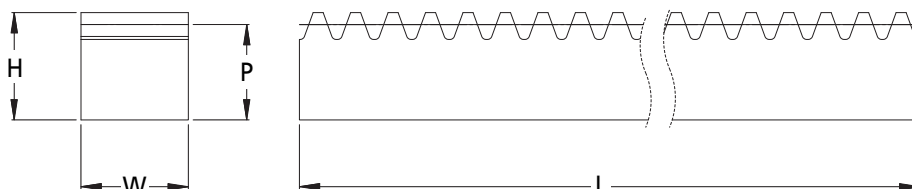
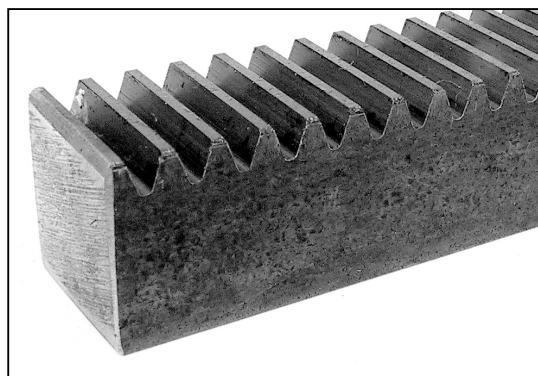

Discounts: 6+ -10% 10+ -20% 20+ -30% 30+ -40%

Part Number	Module m_n	Width W	Height H	Ref. Height P	Length L	Price Each 1 - 5
MR1-1000	1.00	10	10	9.00	999	£35.24
MR1.25-1000	1.25	15	15	13.75	1001	£28.35
MR1.25-2000	1.25	15	15	13.75	1997	£64.02
MR1.5-1000	1.50	15	15	13.50	997	£28.35
MR1.5-2000	1.50	15	15	13.50	1997	£64.02
MR1.75-2000	1.75	15	15	13.25	2002	£64.02
MR2-1000	2.00	20	20	18.00	999	£24.05
MR2-2000	2.00	20	20	18.00	1997	£48.13
MR2.5-1000	2.50	25	25	22.50	997	£34.37
MR2.5-2000	2.50	25	25	22.50	2002	£68.77
MR3-1000	3.00	30	30	27.00	999	£44.26
MR3-2000	3.00	30	30	27.00	1997	£88.56
MMR4-1000	4.00	40	25	21.00	1005	£73.06
MMR4-2000	4.00	40	25	21.00	2002	£162.14
MMR5-1000	5.00	50	30	25.00	1005	£120.37
MMR5-2000	5.00	50	30	25.00	2010	£240.79
MMR6-1000	6.00	60	40	34.00	999	£182.74
MMR6-2000	6.00	60	40	34.00	1997	£365.49

Material

Steel 080M40.
MR = Square section
MMR = Rectangular section

Options

Other lengths available subject to a minimum order quantity of 10 pieces.

Other Info.

Max. Length 1800mm or 400mm depending on module.
Usable end to end.

+44 (0)1246 455500
+44 (0)1246 455522

ondrives

sales@ondrives.com
www.ondrives.com

Product information updated 1st April 2011 and subject to change. Please contact Sales for the latest prices and availability.

COMMERCIAL GEARS

CR

Spur Gear Racks α 20° PA

0.8 - 5.0 Module

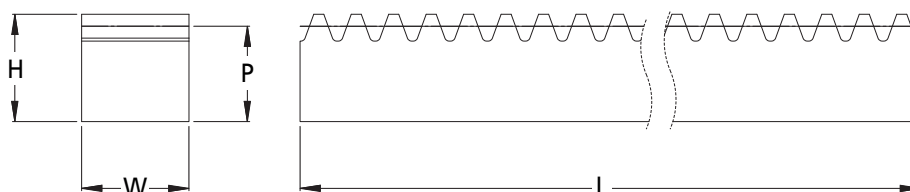
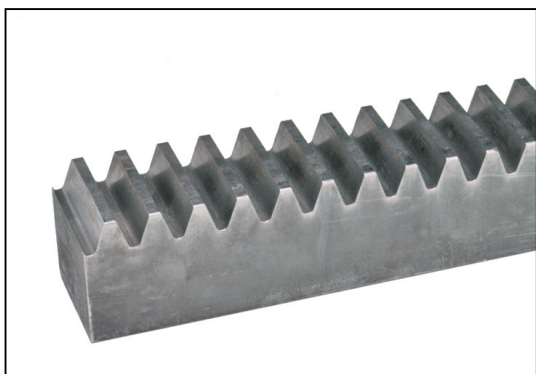

Discounts: 6+ -5% 20+ -10%

Part Number	Module m_n	Ref. Height P	Width W	Height H	Length L	Price Each 1 - 5
CR0.8-1000	0.80	8.72	9.52	9.52	1000	£51.51
CR0.8-1800	0.80	8.72	9.52	9.52	1828	£83.53
CR1-1000	1.00	11.70	12.70	12.70	1000	£53.26
CR1-1800	1.00	11.70	12.70	12.70	1828	£86.37
CR1.25-1000	1.25	11.45	12.70	12.70	1000	£57.35
CR1.25-1800	1.25	11.45	12.70	12.70	1828	£92.98
CR1.5-1000	1.50	17.55	19.05	19.05	1000	£61.53
CR1.5-1800	1.50	17.55	19.05	19.05	1828	£99.77
CR1.75-1000	1.75	17.30	19.05	19.05	1000	£62.74
CR1.75-1800	1.75	17.30	19.05	19.05	1828	£101.75
CR2-1000	2.00	17.05	19.05	19.05	1000	£64.74
CR2-1800	2.00	17.05	19.05	19.05	1828	£104.98
CR2.5-1000	2.50	22.90	25.40	25.40	1000	£79.34
CR2.5-1800	2.50	22.90	25.40	25.40	1828	£128.67
CR3-1000	3.00	28.75	31.75	31.75	1000	£82.26
CR3-1800	3.00	28.75	31.75	31.75	1828	£133.37
CR4-1000	4.00	34.10	38.10	38.10	1000	£114.92
CR4-1800	4.00	34.10	38.10	38.10	1828	£186.34
CR5-1000	5.00	45.80	50.80	50.80	1000	£147.73
CR5-1800	5.00	45.80	50.80	50.80	1828	£263.85

Material

Steel 080M40.

Performance

Max Pitch Error: 0.1mm/300mm

Options

Other lengths available subject to a minimum order quantity of 10 pieces.

Other Info.

Max. Length 1800mm.

Usable end to end for 1m lengths.

+44 (0)1246 455500

+44 (0)1246 455522

ondrives

sales@ondrives.com

www.ondrives.com

Product information updated 1st April 2011 and subject to change. Please contact Sales for the latest prices and availability.

**SR
SRC**

COMMERCIAL GEARS

Spur Gear Racks α 20° PA

0.25 - 2 Module • Toothed Rack

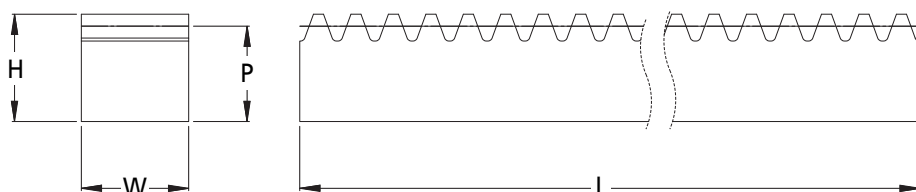
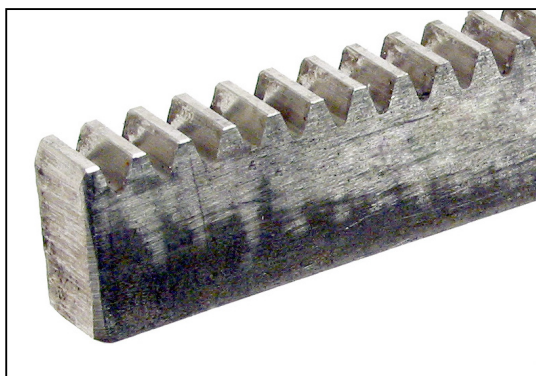

Discounts: 6+ -5% 20+ -10%

Part Number	Module m_n	Ref. Height P	Width W	Height H	Length L	Price Each 1 - 5
SR0.25-400	0.25	8.75	4.00	9.00	400	£87.46
SR0.4-400	0.40	11.60	6.00	12.00	400	£85.28
SR0.5-400	0.50	11.50	6.00	12.00	400	£88.21
SR0.7-400	0.70	11.30	6.00	12.00	400	£91.04
SR0.8-400	0.80	11.20	6.00	12.00	400	£93.84
SR1-400	1.00	14.00	8.00	15.00	400	£100.63
SR1.25-400	1.25	13.75	8.00	15.00	400	£104.34
SR1.5-400	1.50	16.50	18.00	18.00	400	£119.46
SR1.75-400	1.75	16.25	18.00	18.00	400	£120.83
SR2-400	2.00	16.00	18.00	18.00	400	£124.72
SRC1-400	1mm CP	11.67	6.00	12.00	400	£86.74
SRC2-400	2mm CP	11.36	6.00	12.00	400	£91.65

Material

Stainless Steel 303S21.

Options

Other lengths available.

Performance

Max Pitch Error: 0.1mm/300mm

+44 (0)1246 455500
+44 (0)1246 455522

ondrives

sales@ondrives.com
www.ondrives.com

Product information updated 1st April 2011 and subject to change. Please contact Sales for the latest prices and availability.

COMMERCIAL GEARS

ZR
ZRR
ZRC

Spur Gear Racks $\alpha 20^\circ$ PA

0.4 - 2 Module • Delrin

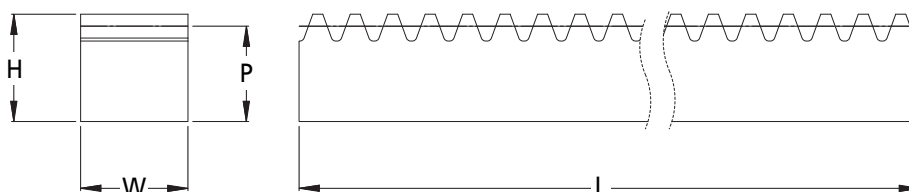
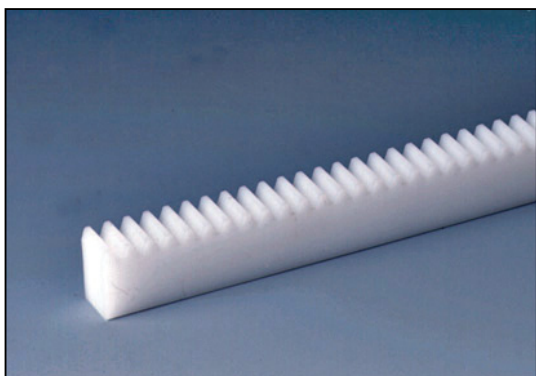

Discounts: 6+ -5% 20+ -10%

Part Number	Module m_n	Ref. Height P	Width W	Height H	Length L	Price Each 1 - 5
ZR0.4-400	0.40	11.60	6.00	12.00	400	£31.17
ZR0.5-400	0.50	11.50	6.00	12.00	400	£31.74
ZR0.7-400	0.70	11.30	6.00	12.00	400	£33.45
ZR0.8-400	0.80	11.20	6.00	12.00	400	£33.86
ZR1-400	1.00	14.00	8.00	15.00	400	£34.99
ZR1.25-400	1.25	13.75	10.00	15.00	400	£37.60
ZRR1.5-400	1.50	16.50	12.00	18.00	400	£39.52
ZRR2-400	2.00	18.00	15.00	20.00	400	£44.04
ZRC1-400	1mm CP	11.67	6.00	12.00	400	£27.30
ZRC2-400	2mm CP	11.36	6.00	12.00	400	£31.74

Material

Delrin
Machined Teeth

Options

Other lengths available up to maximum length of 400mm.
Subject to a minimum order quantity of 10 pieces.

Performance

Max Pitch Error: 0.1mm/300mm

+44 (0)1246 455500
+44 (0)1246 455522

ondrives

sales@ondrives.com
www.ondrives.com

Product information updated 1st April 2011 and subject to change. Please contact Sales for the latest prices and availability.

**TR
TRC**

COMMERCIAL GEARS

Circular Spur Gear Racks $\alpha 20^\circ$ PA

0.25 - 1.5 Module

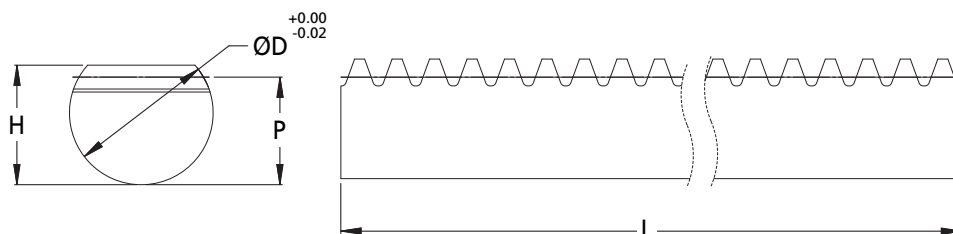
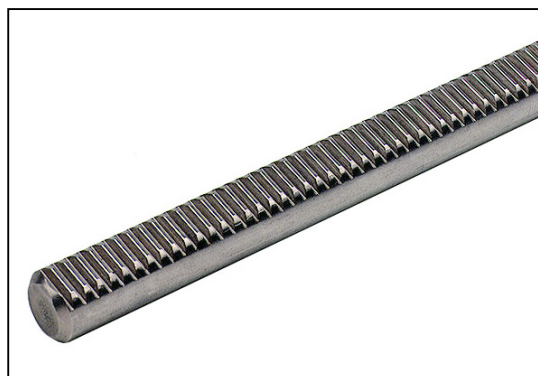

Discounts: 6+ -5% 20+ -10%

Part Number	Module m_n	Ref. Height P	Dia. $\varnothing D$	Height H	Length L	Price Each 1 - 5
TR0.25-400	0.25	5.30	6.00	5.55	400	£49.92
TR0.4-400	0.40	8.80	10.00	9.20	400	£46.31
TR0.5-400	0.50	8.70	10.00	9.20	400	£53.64
TR0.7-400	0.70	9.80	12.00	10.50	400	£55.11
TR0.8-400	0.80	9.70	12.00	10.50	400	£56.83
TR1-400	1.00	9.50	12.00	10.50	400	£62.40
TR1.25-400	1.25	11.75	15.00	13.00	400	£67.99
TR1.5-400	1.50	16.00	20.00	17.50	400	£154.74
TRC1-400	1mm CP	8.88	10.00	9.20	400	£49.92
TRC2-400	2mm CP	8.56	10.00	9.20	400	£51.04

Material

Stainless Steel 303S21

Options

Other lengths available.

Performance

Max Pitch Error: 0.1mm/300mm

+44 (0)1246 455500
+44 (0)1246 455522

ondrives

sales@ondrives.com
www.ondrives.com

Product information updated 1st April 2011 and subject to change. Please contact Sales for the latest prices and availability.

COMMERCIAL GEARS

TRM

Circular Spur Gear Racks $\alpha 20^\circ$ PA

1 - 6 Module

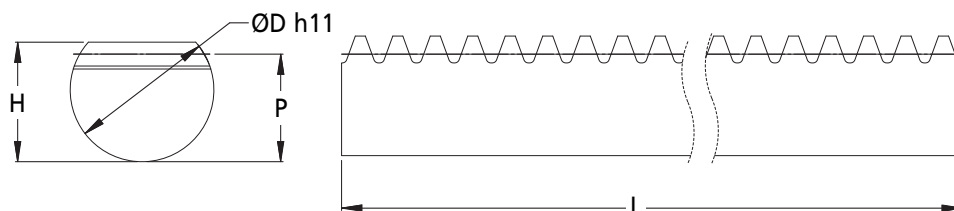

Discounts: 6+ -12%

Part Number	Module m_n	Ref. Height P	Dia. ØD	Height H	Length L	Price Each 1 - 5
TRM1-1000	1.0	9.00	10.00	-	999	£74.37
TRM1.5-1000	1.5	13.50	15.00	-	999	£109.16
TRM2-1000	2.0	18.00	20.00	-	999	£106.77
TRM2.5-1000	2.5	22.50	25.00	-	997	£135.56
TRM3-1000	3.0	27.50	30.00	-	999	£137.36
TRM4-1000	4.0	36.00	40.00	-	1005	£170.96
TRM5-1000	5.0	45.00	50.00	-	1005	£214.17
TRM6-1000	6.0	54.00	60.00	-	999	£288.58

Material

Steel 080M40 Drawn Bar.

MRS

COMMERCIAL GEARS

Metric Toothed Racks α 20° PA

1 - 3 Module • Usable End to End

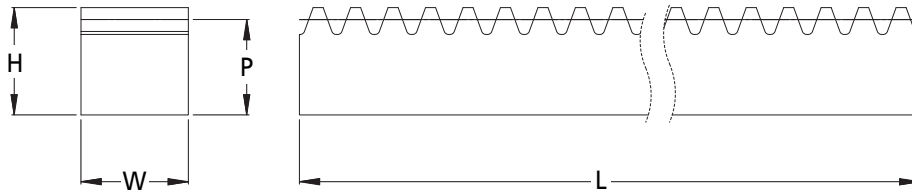
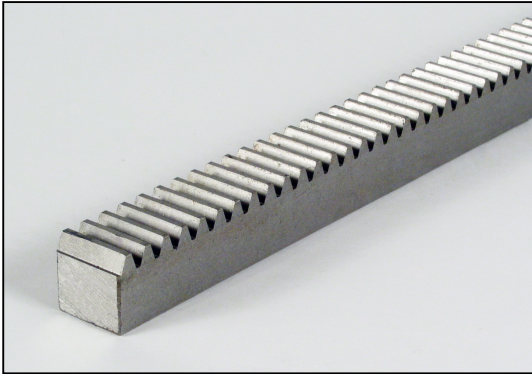
**Discounts: 6+ -12%**

Part Number	Module m_n	Width W	Height H	Ref. Height P	Length L	Price Each 1 - 5
MRS1-1000	1.0	10	10	9.00	999	£83.96
MRS1.5-1000	1.5	15	15	13.50	999	£140.70
MRS2-1000	2.0	20	20	18.00	999	£153.80
MRS2.5-1000	2.5	25	25	22.50	999	£218.16
MRS3-1000	3.0	30	30	27.00	999	£269.98

Material

Stainless Steel 304 drawn bar.

Options

Other lengths available subject to a minimum order quantity of 10 pieces.

+44 (0)1246 455500
+44 (0)1246 455522

ondrives

sales@ondrives.com
www.ondrives.com

Product information updated 1st April 2011 and subject to change. Please contact Sales for the latest prices and availability.

COMMERCIAL GEARS

R
RR
RC

Toothed Racks $\alpha 20^\circ$ PA

0.25 - 2.0 Module

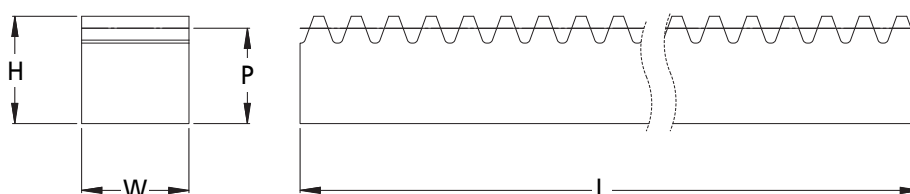

Discounts: 6+ -5% 20+ -10%

Part Number	Module m_n	Ref. Height P	Width W	Height H	Length L	Price Each 1 - 5
R0.25-400	0.25	8.75	4	9	400	£36.64
R0.4-400	0.40	11.60	6	12	400	£37.86
R0.5-400	0.50	11.50	6	12	400	£39.19
R0.7-400	0.70	11.30	6	12	400	£40.41
R0.8-1000	0.80	11.20	6	12	1000	£94.00
R0.8-1800	0.80	11.20	6	12	1828	£156.68
R1-1000	1.00	14.00	8	15	1000	£88.77
R1-1800	1.00	14.00	8	15	1828	£159.41
R1.25-1000	1.25	13.75	8	15	1000	£104.90
R1.25-1800	1.25	13.75	8	15	1828	£171.68
RR1.5-1000	1.50	16.50	18	18	1000	£102.55
RR1.5-1800	1.50	16.50	18	18	1828	£177.12
RR1.75-1000	1.75	16.25	18	18	1000	£115.81
RR1.75-1800	1.75	16.25	18	18	1828	£188.03
RR2-1000	2.00	16.00	18	18	1000	£115.81
RR2-1800	2.00	16.00	18	18	1828	£194.83
RC1-400	1mm CP	11.67	6	12	400	£36.64
RC2-400	2mm CP	11.36	6	12	400	£38.71

Material

Steel 080M40.

Performance

Max Pitch Error: 0.1mm/300mm

Options

Other lengths available subject to a minimum order quantity of 10 pieces.

Other Info.

Max. Length 1800mm or 400mm depending on module.
Usable end to end for 1m lengths.

+44 (0)1246 455500
+44 (0)1246 455522

ondrives

sales@ondrives.com
www.ondrives.com

Product information updated 1st April 2011 and subject to change. Please contact Sales for the latest prices and availability.

ZRM

COMMERCIAL GEARS

Plastic Racks with Moulded Teeth α 20° PA

0.5 - 3 Module • Hostaform

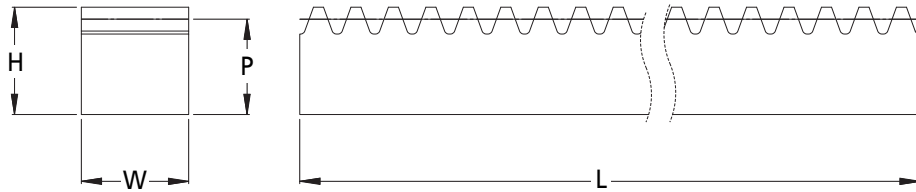
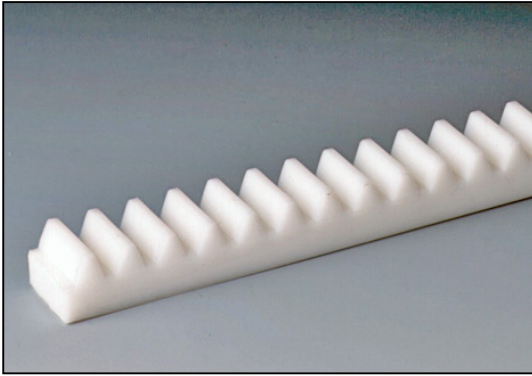
**Discounts: 10+ -10% 50+ -25% 100+ -35%**

Part Number	Module m_n	Ref. Height P	Width W	Height H	Length L	Price Each 1 - 9
ZRM0.5-A250	0.50	4.00	4.50	4.00	250	£3.45
ZRM0.5-B250	0.50	5.50	6.00	4.00	250	£3.89
ZRM0.7-250	0.70	6.00	6.70	6.00	250	£7.79
ZRM1-250	1.00	8.00	9.00	9.00	250	£9.80
ZRM1.5-250	1.50	10.50	12.00	12.00	250	£15.35
ZRM2-250	2.00	9.00	11.00	15.40	250	£25.04
ZRM3-250	3.00	12.00	15.00	19.40	250	£32.56

Material

Hostaform. Moulded lengths.

+44 (0)1246 455500

+44 (0)1246 455522

ondrives

sales@ondrives.com

www.ondrives.com

Product information updated 1st April 2011 and subject to change. Please contact Sales for the latest prices and availability.