

COMMERCIAL GEARS

B

Machined Bevel Gears α 20° PA

1:1 Ratio - Steel 080M40

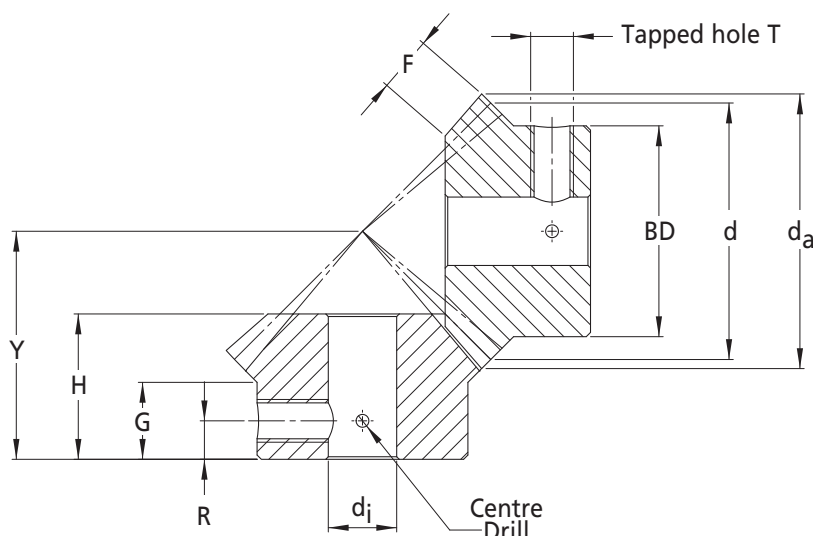

Discounts: 6+ -6% 20+ -10% 40+ -15% 60+ -20% 100+ -25%

Part Number	Module m_n	No. of Teeth Z	Ref. Dia. d	Mounting Distance Y	Tip Dia. d_a	Bore Dia. d_i	Hub Dia. BD	Total Height H	Hub Height G	Face Width F	Tapped Hole T	R	Price Each 1 - 5
B0.8-16	0.80	16	12.80	20.00	13.93	6.00	10.00	16.00	12.20	3.00	M3	7.00	£18.33
B0.8-20	0.80	20	16.00	20.00	17.13	6.00	13.00	14.76	10.50	3.40	M3	6.00	£19.17
B0.8-25	0.80	25	20.00	20.00	21.13	6.00	16.00	13.35	8.00	4.24	M3	5.00	£19.88
B0.8-30	0.80	30	24.00	20.00	25.13	6.00	20.00	11.96	6.00	5.09	M3	4.00	£21.49
B1-20	1.00	20	20.00	25.00	21.41	8.00	18.00	18.45	14.00	4.24	M4	8.00	£21.89
B1-25	1.00	25	25.00	25.00	26.41	8.00	22.00	16.68	10.80	5.28	M4	6.00	£23.34
B1-30	1.00	30	30.00	25.00	31.41	8.00	26.00	14.95	8.00	6.35	M4	5.00	£24.90
B1.25-20	1.25	20	25.00	23.00	26.70	8.00	22.00	15.27	9.00	6.00	M4	3.00	£22.97
B1.25-25	1.25	25	31.25	28.00	33.00	8.00	25.00	17.87	9.20	7.00	M4	3.00	£25.87
B1.25-30	1.25	30	37.50	36.00	39.30	10.00	30.00	23.47	13.50	8.00	M4	5.00	£26.07
B1.5-20	1.50	20	30.00	35.00	32.12	10.00	26.00	25.17	18.00	6.35	M4	10.00	£23.70
B1.5-25	1.50	25	37.50	35.00	39.62	10.00	32.00	22.57	13.50	8.00	M4	7.00	£27.55
B1.5-30	1.50	30	45.00	35.00	47.12	10.00	38.00	19.92	9.00	9.50	M4	5.00	£29.21
B2-20	2.00	20	40.00	42.00	43.00	12.00	34.00	29.00	19.00	8.50	M5	10.00	£27.78
B2-25	2.00	25	50.00	42.00	52.83	12.00	40.00	25.52	12.00	10.60	M5	7.00	£30.99
B2-30	2.00	30	60.00	42.00	63.00	12.00	50.00	21.87	7.00	12.70	M5	4.00	£34.79
B2.5-16	2.50	16	40.00	50.00	43.50	15.00	35.00	36.80	27.50	8.00	M5	15.00	£28.40
B2.5-20	2.50	20	50.00	50.00	54.00	15.00	40.00	33.50	20.00	10.60	M5	12.00	£35.38
B2.5-25	2.50	25	62.50	50.00	66.00	15.00	55.00	30.50	15.00	15.00	M5	8.00	£40.20
B3-16	3.00	16	48.00	44.00	52.24	15.00	40.00	29.08	16.00	11.00	M5	8.00	£47.71
B3-19	3.00	19	57.00	49.00	61.24	16.00	50.00	31.01	17.02	13.00	M5	9.00	£60.51
B3-26	3.00	26	78.00	65.00	82.24	18.00	64.00	40.03	19.03	18.00	M6	10.00	£81.14
B3-30	3.00	30	90.00	68.50	94.24	20.00	76.00	39.65	16.51	21.00	M6	8.00	£87.76
B4-16	4.00	16	64.00	55.50	69.66	15.00	50.00	35.81	16.49	15.00	M5	8.00	£68.25
B4-19	4.00	19	76.00	65.00	81.66	18.00	62.50	41.43	20.24	18.00	M6	10.00	£81.20
B4-26	4.00	26	104.00	82.00	109.66	22.00	85.00	48.69	20.50	24.00	M6	10.00	£96.30
B4-30	4.00	30	120.00	90.00	125.66	25.00	102.00	51.51	21.00	28.00	M8	11.00	£105.08
B5-16	5.00	16	80.00	70.00	87.10	18.00	60.00	46.13	20.00	20.00	M8	11.00	£110.57
B5-20	5.00	20	100.00	80.00	107.10	20.00	80.00	49.04	21.50	24.00	M8	12.00	£117.52
B5-25	5.00	25	125.00	100.00	132.10	25.00	80.00	59.47	24.00	28.00	M10	14.00	£124.42
B5-30	5.00	30	150.00	114.00	157.10	30.00	100.00	65.87	26.00	35.00	M10	15.00	£130.84
B6-16	6.00	16	96.00	80.00	104.52	25.00	75.00	50.10	22.00	22.00	M10	12.00	£135.83
B6-20	6.00	20	120.00	90.00	128.52	30.00	96.00	52.32	18.50	28.00	M10	12.00	£142.05
B6-25	6.00	25	150.00	115.00	158.52	35.00	100.00	67.29	24.00	35.00	M10	14.00	£148.36
B6-30	6.00	30	180.00	130.00	188.52	35.00	120.00	72.24	28.00	42.00	M10	16.00	£157.63

Material

Steel 080M40 (EN8)

Note: Two complementary bevel gears are required to form 1 pair

Options

Different number of teeth
Other material
Other bores, fixings, etc.

+44 (0)1246 455500
+44 (0)1246 455522

ondrives

sales@ondrives.com
www.ondrives.com

Product information updated 22nd September 2011 and subject to change. Please contact Sales for the latest prices and availability.