

# FASTENERS

SM

## Stainless Hexagon Socket Set Screws

With Cup Point, DIN 916 - A2 : M2 - M16

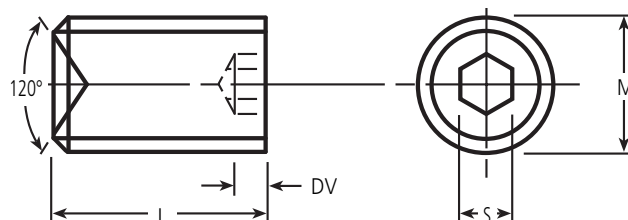
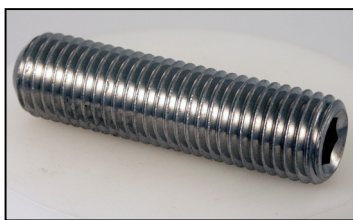

**Discounts:** 10+ -10%   40+ -20%   100+ -30%   200+ -40%   500+ -50%   1000+ -55%   2000+ -60%   3000+ -65%

Part Number	M	Nom. L	Pitch	DV	S	Price Each 1 - 9	Part Number	M	Nom. L	Pitch	DV	S	Price Each 1 - 9
SM2-3	M2	3	0.40	1.00	0.90	£0.32	SM6-10	M6	10	1.00	3.00	3.00	£0.12
SM2-4	M2	4	0.40	1.00	0.90	£0.32	SM6-12	M6	12	1.00	3.00	3.00	£0.13
SM2-5	M2	5	0.40	1.00	0.90	£0.26	SM6-16	M6	16	1.00	3.00	3.00	£0.16
SM2-6	M2	6	0.40	1.00	0.90	£0.29	SM6-20	M6	20	1.00	3.00	3.00	£0.31
SM2-8	M2	8	0.40	1.00	0.90	£0.37	SM6-25	M6	25	1.00	3.00	3.00	£0.39
SM2-10	M2	10	0.40	1.00	0.90	£0.48	SM6-30	M6	30	1.00	3.00	3.00	£0.46
SM2-12	M2	12	0.40	1.00	0.90	£0.51	SM6-35	M6	35	1.00	3.00	3.00	£0.76
SM2.5-3	M2.5	3	0.45	1.20	1.30	£0.28	SM6-40	M6	40	1.00	3.00	3.00	£0.68
SM2.5-4	M2.5	4	0.45	1.20	1.30	£0.27	SM6-45	M6	45	1.00	3.00	3.00	£1.18
SM2.5-5	M2.5	5	0.45	1.20	1.30	£0.28	SM6-50	M6	50	1.00	3.00	3.00	£1.22
SM2.5-6	M2.5	6	0.45	1.20	1.30	£0.29	SM8-8	M8	8	1.25	5.00	4.00	£0.15
SM2.5-8	M2.5	8	0.45	1.20	1.30	£0.29	SM8-10	M8	10	1.25	5.00	4.00	£0.15
SM2.5-10	M2.5	10	0.45	1.20	1.30	£0.31	SM8-12	M8	12	1.25	5.00	4.00	£0.25
SM2.5-12	M2.5	12	0.45	1.20	1.30	£0.32	SM8-16	M8	16	1.25	5.00	4.00	£0.25
SM3-3	M3	3	0.50	1.40	1.50	£0.10	SM8-20	M8	20	1.25	5.00	4.00	£0.35
SM3-4	M3	4	0.50	1.40	1.50	£0.08	SM8-25	M8	25	1.25	5.00	4.00	£0.48
SM3-5	M3	5	0.50	1.40	1.50	£0.08	SM8-30	M8	30	1.25	5.00	4.00	£0.65
SM3-6	M3	6	0.50	1.40	1.50	£0.08	SM8-35	M8	35	1.25	5.00	4.00	£0.79
SM3-8	M3	8	0.50	1.40	1.50	£0.09	SM8-40	M8	40	1.25	5.00	4.00	£0.85
SM3-10	M3	10	0.50	1.40	1.50	£0.10	SM8-50	M8	50	1.25	5.00	4.00	£1.17
SM3-12	M3	12	0.50	1.40	1.50	£0.13	SM10-10	M10	10	1.50	6.00	5.00	£0.19
SM3-16	M3	16	0.50	1.40	1.50	£0.27	SM10-12	M10	12	1.50	6.00	5.00	£0.22
SM3-20	M3	20	0.50	1.40	1.50	£0.32	SM10-16	M10	16	1.50	6.00	5.00	£0.26
SM4-4	M4	4	0.70	2.00	2.00	£0.11	SM10-20	M10	20	1.50	6.00	5.00	£0.29
SM4-5	M4	5	0.70	2.00	2.00	£0.08	SM10-25	M10	25	1.50	6.00	5.00	£0.53
SM4-6	M4	6	0.70	2.00	2.00	£0.09	SM10-30	M10	30	1.50	6.00	5.00	£0.61
SM4-8	M4	8	0.70	2.00	2.00	£0.11	SM10-35	M10	35	1.50	6.00	5.00	£0.70
SM4-10	M4	10	0.70	2.00	2.00	£0.10	SM10-40	M10	40	1.50	6.00	5.00	£0.81
SM4-12	M4	12	0.70	2.00	2.00	£0.11	SM10-50	M10	50	1.50	6.00	5.00	£1.26
SM4-16	M4	16	0.70	2.00	2.00	£0.21	SM12-12	M12	12	1.75	8.00	6.00	£0.30
SM4-20	M4	20	0.70	2.00	2.00	£0.31	SM12-16	M12	16	1.75	8.00	6.00	£0.43
SM4-25	M4	25	0.70	2.00	2.00	£0.58	SM12-20	M12	20	1.75	8.00	6.00	£0.48
SM4-30	M4	30	0.70	2.00	2.00	£0.70	SM12-25	M12	25	1.75	8.00	6.00	£0.61
SM5-5	M5	5	0.80	2.50	2.50	£0.10	SM12-30	M12	30	1.75	8.00	6.00	£0.74
SM5-6	M5	6	0.80	2.50	2.50	£0.09	SM12-35	M12	35	1.75	8.00	6.00	£0.99
SM5-8	M5	8	0.80	2.50	2.50	£0.11	SM12-40	M12	40	1.75	8.00	6.00	£1.05
SM5-10	M5	10	0.80	2.50	2.50	£0.10	SM12-50	M12	50	1.75	8.00	6.00	£1.22
SM5-12	M5	12	0.80	2.50	2.50	£0.14	SM12-60	M12	60	1.75	8.00	6.00	£2.13
SM5-16	M5	16	0.80	2.50	2.50	£0.22	SM16-16	M16	16	2.00	10.00	8.00	£1.11
SM5-20	M5	20	0.80	2.50	2.50	£0.26	SM16-20	M16	20	2.00	10.00	8.00	£1.39
SM5-25	M5	25	0.80	2.50	2.50	£0.44	SM16-25	M16	25	2.00	10.00	8.00	£1.86
SM5-30	M5	30	0.80	2.50	2.50	£0.55	SM16-30	M16	30	2.00	10.00	8.00	£2.00
SM5-35	M5	35	0.80	2.50	2.50	£0.79	SM16-35	M16	35	2.00	10.00	8.00	£2.35
SM5-40	M5	40	0.80	2.50	2.50	£0.82	SM16-40	M16	40	2.00	10.00	8.00	£2.81
SM6-6	M6	6	1.00	3.00	3.00	£0.12	SM16-50	M16	50	2.00	10.00	8.00	£3.28
SM6-8	M6	8	1.00	3.00	3.00	£0.12	SM16-60	M16	60	2.00	10.00	8.00	£4.88

### Material

Stainless Steel Grade A2-70. Manufactured from A2 302/304 18-8 grade stainless steel to DIN 916. Available in A4/316 material - Please ask for a quote

### Performance

Maximum Working Temperature: +430°C.

+44 (0)1246 455500  
+44 (0)1246 455522

**ondrives**

sales@ondrives.com  
www.ondrives.com

Product information updated 1st April 2011 and subject to change. Please contact Sales for the latest prices and availability.