

COUPLINGS

Flexible Disc Coupling

High Torque Backlash Free, Clamp Fixing : 2.8 - 38Nm, 6 - 25mm Bores

e-cad
Drawings
Available

MHS-C
MHW-C



MHS-C Type Single Disc

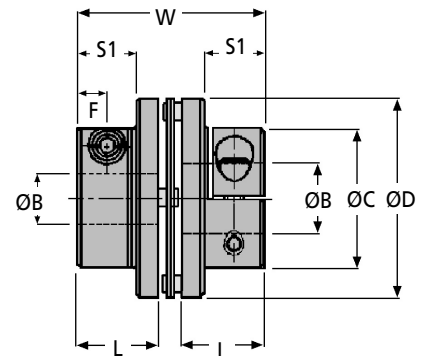
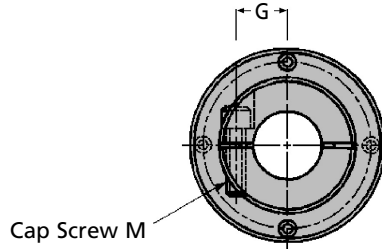

MHW-C Type Double Disc

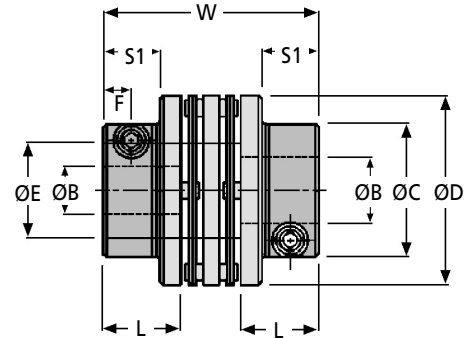
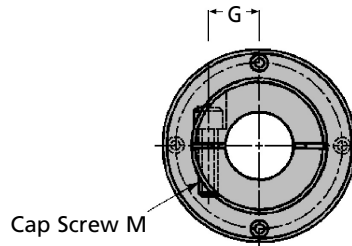

Discounts: 6+ -10% 16+ -15% 41+ -20% 100+ -25%

Part Number	Max. Rpm	Mass g	Moment of Inertia kg·m ²	Static Torsional Stiffness Nm/rad	Max. Eccentricity	Max. Angularity	Max. Axial Play
SINGLE DISC							
MHS-32C	4800	38	4.5 x 10 ⁻⁶	1300	-	1°	±0.20
MHS-40C	3800	66	1.2 x 10 ⁻⁵	2800	-	1°	±0.20
MHS-50C	3100	120	3.7 x 10 ⁻⁵	3700	-	1°	±0.20
MHS-63C	2400	190	8.4 x 10 ⁻⁵	5000	-	1°	±0.20
DOUBLE DISC							
MHW-32C	4800	48	6.2 x 10 ⁻⁶	1000	0.15	2°	±0.40
MHW-40C	3800	81	1.6 x 10 ⁻⁵	1500	0.20	2°	±0.50
MHW-50C	3100	150	4.6 x 10 ⁻⁵	2000	0.20	2°	±0.60
MHW-63C	2400	230	1.1 x 10 ⁻⁴	2500	0.30	2°	±0.80

Part Number	ØD	Bore Both Ends ØB	Max. Bore ØB	ØE	F	L	W	ØC	S1	M	G	Rated Torque Nm	Max. Torque Nm	Price Each 1 - 5
SINGLE DISC														
MHS-32C	32	6.00	10	-	4	13.70	32	22	9	M3	8.00	2.8	5.6	£64.01
MHS-40C	40	8.00	14	-	6	16.50	38	28	12	M4	10.50	6.0	12.0	£69.51
MHS-50C	50	12.00	20	-	7	19.40	44	39	15	M5	14.75	12.0	24.0	£84.04
MHS-63C	63	16.00	25	-	8	22.30	50	45	18	M6	17.00	19.0	38.0	£117.35
DOUBLE DISC														
MHW-32C	32	6.00	10	15	4	13.70	40	22	9	M3	8.00	2.8	5.60	£76.14
MHW-40C	40	8.00	14	25	6	16.50	46	28	12	M4	10.50	6.0	12.00	£85.38
MHW-50C	50	12.00	20	25	7	19.40	52	39	15	M5	14.75	12.0	24.00	£102.70
MHW-63C	63	16.00	25	32	8	22.30	58	45	18	M6	17.00	19.0	38.00	£145.46

Material Hub: Aluminium (A2017) **Spacer:** Aluminium (A2011) **Pin:** Stainless Steel (SUS301) **Disc:** Stainless Steel (SUS303)

Performance Maximum Temperature: +100°C Approx.

Extras Boring Out: upto 25mm £4.84 per end. Add bore size required to end of part number eg. **MHS-32C-8/10** (bored Ø8mm & Ø10mm).

Pin Hole: Any Size £4.84 each. **Tapped Holes:** upto M8 incl. £7.17 each, over M8 £11.39 each. **Keyways:** Available subject to a minimum order quantity of 5 pieces P.O.A. due to being pre-formed prior to assembly. Keyways may be slotted after assembly but Ondrives Ltd. do not offer this service.

Other Info. Identical clockwise & anti-clockwise rotational characteristics. High torsional stiffness and high response.

Zero backlash. Double stainless steel discs completely absorb eccentricity, angularity and end play. Maintenance free, excellent resistance to oil and chemicals.

+44 (0)1246 455500
+44 (0)1246 455522

ondrives

sales@ondrives.com
www.ondrives.com

Product information updated 1st April 2011 and subject to change. Please contact Sales for the latest prices and availability.