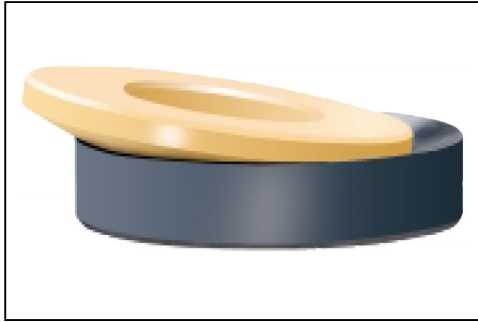
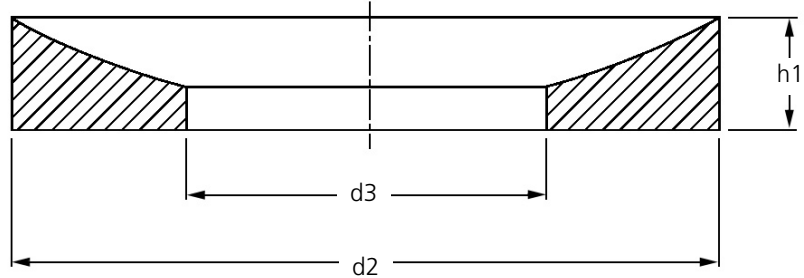
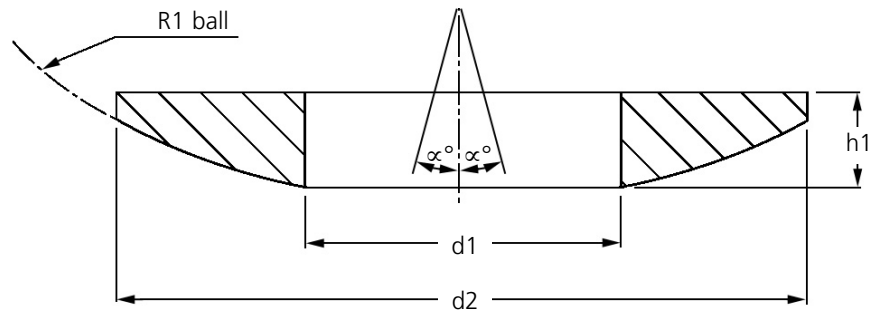

SAM

BEARINGS

igubal® Spherical Thrust Bearings

Plastic Self Aligning : To Suit 5 - 20mm Shaft

**HOUSING PAD****SPHERICAL WASHER****Discounts:** 20+ -10% 50+ -20% 100+ -30%

Part Number	Maximum Static Axial Tensile Strength	
	Short Term (N)	Long Term (N)
SAM-05	4,000	2,000
SAM-06	5,000	2,500
SAM-08	8,000	4,000
SAM-10	10,000	5,000
SAM-12	12,000	6,000
SAM-16	17,000	8,500
SAM-20	22,000	11,000

Part Number	d1 Housing Pad	d3 Spherical Wash	d2	h1 Ball Socket	h2 Spherical Disk	H Total Height	R Radius	Allowable Movement α°	Total Weight (g)	Price per set/pair 1 - 19
SAM-05	5.2	7.0	15.0	3.0	3.5	4.7	15.0	3°	0.9	£6.72
SAM-06	6.2	7.5	16.0	3.0	4.0	5.3	16.0	3°	1.1	£7.08
SAM-08	8.2	10.0	20.0	4.0	5.0	6.8	20.0	2°	2.2	£7.45
SAM-10	10.2	12.0	24.0	4.5	5.5	7.5	24.0	2°	3.4	£7.87
SAM-12	12.5	14.5	30.0	5.0	6.0	8.0	32.0	2°	5.9	£8.43
SAM-16	16.5	19.0	36.0	5.5	6.5	8.1	40.0	2°	8.5	£9.77
SAM-20	20.2	23.0	44.0	6.0	7.0	8.6	45.0	2°	13.1	£10.77

Material

W300 Iglidur®

Other Info.

Available as standard in dimensions from 5 to 20mm.

+44 (0)1246 455500
+44 (0)1246 455522

ondrives

sales@ondrives.com
www.ondrives.com

Product information updated 1st April 2011 and subject to change. Please contact Sales for the latest prices and availability.

BEARINGS

igubal® Spherical Thrust Bearings Plastic Self Aligning

The self aligning igubal spherical thrust bearings are very easy to install and help to compensate for alignment errors and prevent edge loads.

The housing pad is manufactured from the impact resistant, thermoplastic composite material igumid®G. The spherical washer is made from the iglidur® W300 plain bearing material. This combination gives exceptionally good friction and wear properties.

Loads

The loading capacity of igubal® spherical thrust bearings is very high for standard ambient temperatures. For high continuous loads and high temperatures, the loading capacity of the thrust bearings should be tested in an experiment that simulates the application.

Coefficients of Friction and Speeds

Taking into account the radial load, maximum surface speeds up to 0.5m/s rotating are possible.

Installation

The housing pad is installed so that it is countersunk and secured. The spherical washer is loosely fit in the socket and is held in place by the shaft that is placed into the bearing.

Product Range

igubal® spherical thrust bearings are available as standard in dimensions from 5 to 20mm Please contact our technical department if you need other dimensions.

Structure for part numbers of igubal® spherical thrust bearings

The part numbers of igubal spherical thrust bearings are designed according to the following system:

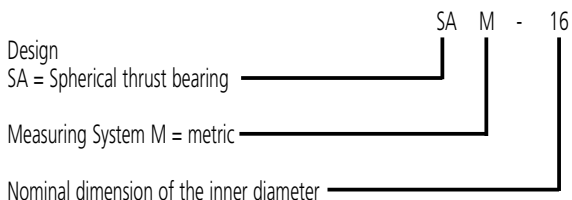

The example shows a spherical thrust bearing with metric dimensions and an inner diameter of 16mm.

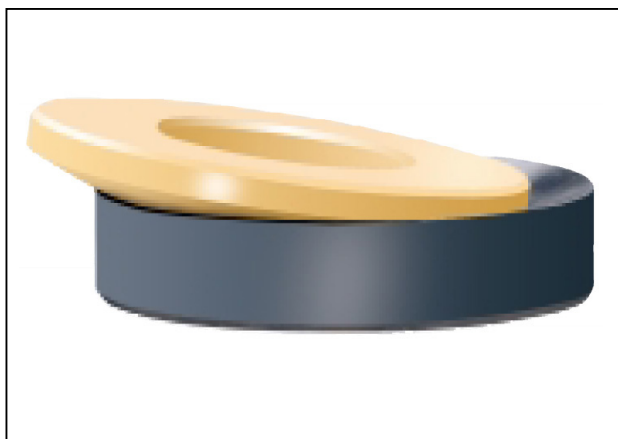

THE
C
I
N
H
C
E
T